

Acct ID: 536582 MTL: 093W30A001000 Date: 1/10/24 Appr: MDL Prop Class: 401 RMV Prop Class: 401  
 Situs: 13364 MARLATT RD S JEFFERSON OR 97352 MaSaNh: 07 06 000 Unit: 23886 Year: 2024

Last Date Appraised: 07/20/2018 Appraiser: MATT LORD Retag: Y N Tag info: 2024 - NEW CONSTRUCTION (Outbuilding)

Owner: JANICE A JENNEY TR Roll Type: R

Cycle Tag Sales Verification Other: \_\_\_\_\_ Inspection level: 1 2 3 4 LCB TTO INSP AV: 408450

RMV Land: 255650 RMV Imp: 325740 RMV Total: 581390 MAV: 408450 MSAV: 0 SAV: 0

Comment: 23-006085 20x16 outbuilding Exception

Notations MP 100% complete

No notation data available.

OSDs

Count	Code	Description	RMV	Code Area	Exception
1	MKTA	OSD - AVERAGE	45000	14530	0

Land

Site: 1 Code Area: 14530 Size: 2.50 Acres Use Code: 004 Zone: NREST SAV Use: Exception: 0  
 Class: Value Source: Rural at MKT Description: RMV: 210650 Exception: Y N  
 Adjustment(s): Fire Patrol: Description:  
 Comments: 03-04: REAPPRAISAL 04-05: RECALC PROJECT, LAND SCHEDULE CHANGES.

Improvements - Residence / Manufactured Structures

Bldg: 1 Code Area: 14530 Stat Class: 142 Year Blt: 1994 Eff Year Blt: 1994 Sq.Ft: 2048 % Complete: 100  
 Desc: Multi Story above grade Dimensions: RMV: 279630  
 Func Obsc: 100 Econ %: 100 Other %: 100 Exception: 0 Adjust: Adjust RMV: 0

Floors

Type	Class	Display Group	Floor Size	Beds	Baths	Yr Blt	Eff Yr Blt	Inventory	Exception
First Floor	4	Finished	1084	0	FB-1/ HB-1	1994	1994	ROOF, HVAC+, KIT+, BTH - 1	Exception: Y N
Second Floor	4	Finished	964	4	FB-2	1994	1994	HVAC+, BATH - 2	Exception: Y N
Garage Attached	4	Finished	462	0	0	1994	1994	ROOF <u>462 SF</u>	Exception: Y N

Accessories

Description	Class	Size SqFt	Eff Yr Blt	RMV	Quantity
No accessory data available					

Bldg: 3 Code Area: 14530 Stat Class: 107 Year Blt: Eff Year Blt: Sq.Ft: 0 % Complete: 100  
 Desc: Yard Improvements Dimensions: RMV: 15750  
 Func Obsc: 100 Econ %: 100 Other %: 100 Exception: 0 Adjust: Adjust RMV: 0

Floors

Type	Class	Display Group	Floor Size	Beds	Baths	Yr Blt	Eff Yr Blt	Inventory	Exception
No floor data available									

Accessories

Description	Class	Size SqFt	Eff Yr Blt	RMV	Quantity
YARD IMPROVEMENTS AVERAGE	4	0	<u>20 1994</u>	15750	1
Exception: Y <u>N</u>					

Improvements - Accessory Buildings

Bldg: 2 Code Area: 14530 Stat Class: 351 Year Blt: 2003 Eff Year Blt: 2006 Sq.Ft: 1440 % Complete: 100  
 Desc: General Purpose Building (GB) Dimensions: 24x30 RMV: 30360  
 Func Obsc: 100 Econ %: 100 Other %: 100 Exception: 0 Adjust: Adjust RMV: 0

Floors

Type	Class	Display Group	Floor Size	Beds	Baths	Yr Blt	Eff Yr Blt	Inventory	Exception
General Purpose Bldg	6	Finished	720	0	FB-1/ HB-1	2003	2006	BTH - 1	Exception: Y N
<del>Finished Office</del>	<del>6</del>	<del>Finished</del>	<del>720</del>	<del>0</del>	<del>0</del>	<del>2006</del>	<del>2006</del>	<del>FAIR</del>	<del>Exception: Y <u>N</u></del>

Accessories

Description	Class	Size SqFt	Eff Yr Blt	RMV	Quantity
No accessory data available					

MP 5 20x16 2023 AUB Exception New

# SKETCH/AREA TABLE ADDENDUM

## SUBJECT INFO

File No.: 536582 Parcel No.: 093W30A 01000  
 Property Address: 13364 MARLATT RD S  
 City: JEFFERSON County: MARION State: OR ZipCode: 97352  
 Owner:  
 Client: Client Address:  
 Appraiser Name: Inspection Date:

## SKETCH

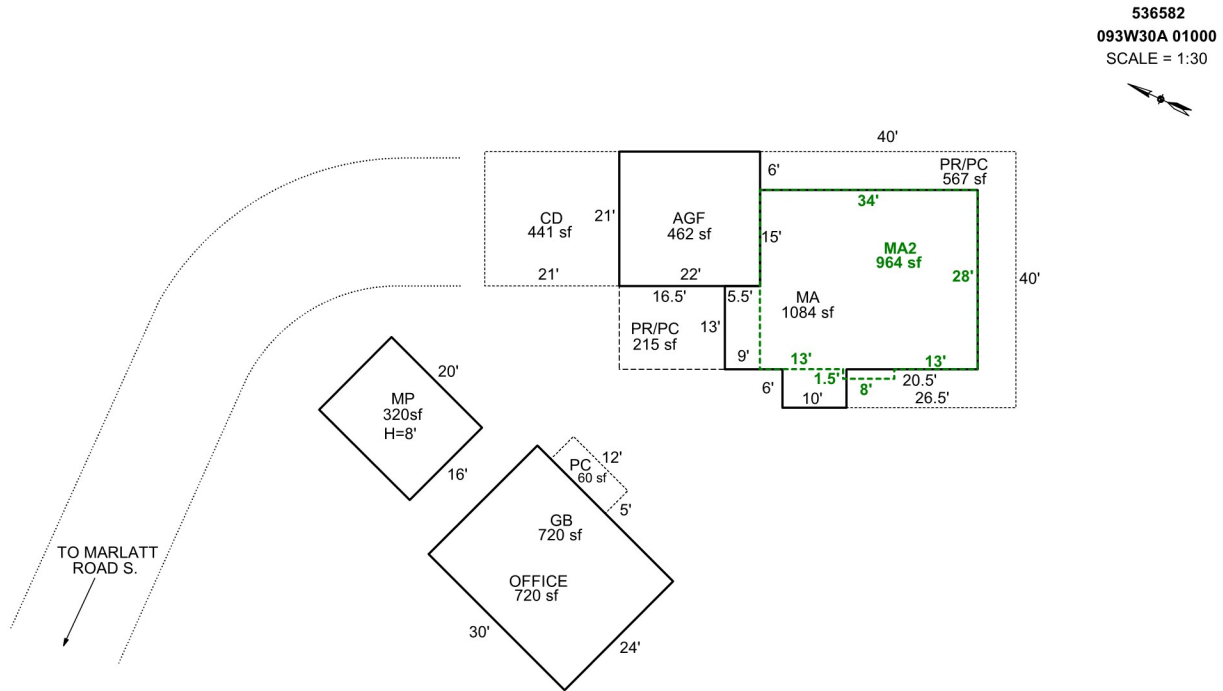

### AREA CALCULATIONS SUMMARY

Code	Description	Factor	Net Size	Perimeter	Net Totals
GBA1	GB	1.0	720.0	108.0	
	MP	1.0	320.0	72.0	1040.0
GLA1	MA	1.0	1083.5	147.0	1083.5
GLA2	MA2	1.0	964.0	127.0	964.0
GAR	AGF	1.0	462.0	86.0	462.0
OTH	OFFICE	1.0	720.0	108.0	720.0
P/P	PR/PC	1.0	214.5	59.0	
	PR/PC	1.0	567.0	201.0	
	PC	1.0	60.0	34.0	
	CD	1.0	441.0	84.0	1282.5
	Net LIVABLE	cnt	2 (rounded)		2,048
	Net BUILDING	cnt	2 (rounded)		1,040

### COMMENT TABLE 1

UPDATED BY JRONDEMA 7/23/18  
 UPDATED BY CJURAN 10/03/2023 23-006085 MP

### COMMENT TABLE 2

*MDL 1/8/24*

### COMMENT TABLE 3

*Tab L2*



R36582  
GB,OFF,GS

7/20/18



R36582  
MA,MA2,AGF SIDE

7/20/18





1/8/24

ACCOUNT # 536582 DATE: 1/8/24 RMV CLASS 401 PROP CLASS 401  
 MTL 093W 30A 100 APPR MDL TAG Y N

COMMENTS: \_\_\_\_\_

RESIDENCE / MANUFACTURED STRUCTURES

ACCESSORY IMPROVEMENTS / OUTBUILDINGS

STAT \_\_\_\_\_ QLTY + - FLOOR \_\_\_\_\_  
 AREA \_\_\_\_\_ EFF AREA \_\_\_\_\_ BED \_\_\_\_\_  
 ROOF + HVAC +  
 BATH PKG: \_\_\_\_\_ BATH \_\_\_\_\_ BATH + \_\_\_\_\_ 1/2 BTH  
 FIREPLACE: \_\_\_\_\_  
 KITCHEN - +  
 YR BLT \_\_\_\_\_ EFF YR \_\_\_\_\_ ECON \_\_\_\_\_  
 % COMP \_\_\_\_\_ % GOOD \_\_\_\_\_ FUNC \_\_\_\_\_  
 EXCEPT Y N LUMP SUM: \_\_\_\_\_  
 MISC: \_\_\_\_\_  
 YI CLASS \_\_\_\_\_ F G A E  
 SKIRT + LIN FT \_\_\_\_\_  
 COMMENT: \_\_\_\_\_

STAT \_\_\_\_\_ QLTY + - FLOOR \_\_\_\_\_  
 AREA \_\_\_\_\_ EFF AREA \_\_\_\_\_ BED \_\_\_\_\_  
 ROOF + HVAC +  
 BATH PKG: \_\_\_\_\_ BATH \_\_\_\_\_ BATH + \_\_\_\_\_ 1/2 BTH  
 FIREPLACE: \_\_\_\_\_  
 KITCHEN - +  
 YR BLT \_\_\_\_\_ EFF YR \_\_\_\_\_ ECON \_\_\_\_\_  
 % COMP \_\_\_\_\_ % GOOD \_\_\_\_\_ FUNC \_\_\_\_\_  
 EXCEPT Y N LUMP SUM: \_\_\_\_\_  
 MISC: \_\_\_\_\_  
 YI CLASS \_\_\_\_\_ F G A E  
 SKIRT + LIN FT \_\_\_\_\_  
 COMMENT: \_\_\_\_\_

STAT \_\_\_\_\_ QLTY + - FLOOR \_\_\_\_\_  
 AREA \_\_\_\_\_ EFF AREA \_\_\_\_\_ BED \_\_\_\_\_  
 ROOF + HVAC +  
 BATH PKG: \_\_\_\_\_ BATH \_\_\_\_\_ BATH + \_\_\_\_\_ 1/2 BTH  
 FIREPLACE: \_\_\_\_\_  
 KITCHEN - +  
 YR BLT \_\_\_\_\_ EFF YR \_\_\_\_\_ ECON \_\_\_\_\_  
 % COMP \_\_\_\_\_ % GOOD \_\_\_\_\_ FUNC \_\_\_\_\_  
 EXCEPT Y N LUMP SUM: \_\_\_\_\_  
 MISC: \_\_\_\_\_  
 YI CLASS \_\_\_\_\_ F G A E  
 SKIRT + LIN FT \_\_\_\_\_  
 COMMENT: \_\_\_\_\_

TYPE MP  
 STAT / CLASS 4  
 SIZE 320  
16x20  
 FAIR  
~~AVERAGE~~  
 GOOD  
 EXCELLENT  
 BATH \_\_\_\_\_  
 YR BLT 2023  
 EFF YR 2023  
 % COMP 100  
 EXCEPT N  
 MISC: \_\_\_\_\_  
 COMMENT: \_\_\_\_\_

TYPE \_\_\_\_\_  
 STAT / CLASS \_\_\_\_\_  
 SIZE \_\_\_\_\_  
 FAIR  
 AVERAGE  
 GOOD  
 EXCELLENT  
 BATH \_\_\_\_\_  
 YR BLT \_\_\_\_\_  
 EFF YR \_\_\_\_\_  
 % COMP \_\_\_\_\_  
 EXCEPT Y N  
 MISC: \_\_\_\_\_  
 COMMENT: \_\_\_\_\_

TYPE \_\_\_\_\_  
 STAT / CLASS \_\_\_\_\_  
 SIZE \_\_\_\_\_  
 FAIR  
 AVERAGE  
 GOOD  
 EXCELLENT  
 BATH \_\_\_\_\_  
 YR BLT \_\_\_\_\_  
 EFF YR \_\_\_\_\_  
 % COMP \_\_\_\_\_  
 EXCEPT Y N  
 MISC: \_\_\_\_\_  
 COMMENT: \_\_\_\_\_

TYPE \_\_\_\_\_  
 STAT / CLASS \_\_\_\_\_  
 SIZE \_\_\_\_\_  
 FAIR  
 AVERAGE  
 GOOD  
 EXCELLENT  
 BATH \_\_\_\_\_  
 YR BLT \_\_\_\_\_  
 EFF YR \_\_\_\_\_  
 % COMP \_\_\_\_\_  
 EXCEPT Y N  
 MISC: \_\_\_\_\_  
 COMMENT: \_\_\_\_\_