

Summary

Lead Appr: WW Clerk: _____ Lead Clerk: _____ Appr: MDL

Print Date: 7/31/2023

Acct ID: 606652 MTL: 092W06B003500 Date: 1/3/24 Appr: MDL Prop Class: 400 RMV Prop Class: 400

Situs: _____ MaSaNh: 07 06 000 Unit: 147236 Year: 2023

_____ Retag: Y N Tag info: 2024 - NEW CONSTRUCTION (Residence)

_____ Last Date Appraised: _____ Appraiser: MATT LORD _____

Owner: TRAPSE, JENNIFER L _____ Roll Type: R

Cycle Tag Sales Verification _____ Other: _____ Inspection level: 1 2 3 4 LCB TTO INSP AV: 146670

RMV Land: 146670 RMV Imp: 0 RMV Total: 146670 MAV: 0 MSAV: 0 SAV: 0

Comment: _____

Notations 24-25: NSF 23-000507

No notation data available.

OSDs OSD H

No OSD data available.

Land

Site: 2 Code Area: 05590 Size: 2.00 Acres Use Code: 004 Zone: NREST SAV Use: _____ Exception: 146670

Class: 4HD Value Source: Rural at MKT Description: FOUR HILL DRY RMV: 146670 Exception: Y N

Adjustment(s): _____ Fire Patrol: _____ Description: _____

Comments: Liability year - 1971, STF - 2004 / 500190: 02-03: (F)0080: COMBINED R61302 AND R61306, DELETED R61306, SEPE INTO R330154,R330155 //04-05: STF APPLICATION APPROVED

Improvements - Residence / Manufactured Structures

No residence or manufactured structure improvement data available.

Improvements - Accessory Buildings

No improvement data available for all other stat class types.



1/3/24



SKETCH/AREA TABLE ADDENDUM

SUBJECT INFO

File No.: 606652	Parcel No.: 092W06B003400		
Property Address: 9341 DONALD LANE SE			
City: TURNER	County:	State: OR	ZipCode: 97392
Owner:			
Client:		Client Address:	
Appraiser Name:		Inspection Date:	

SKETCH

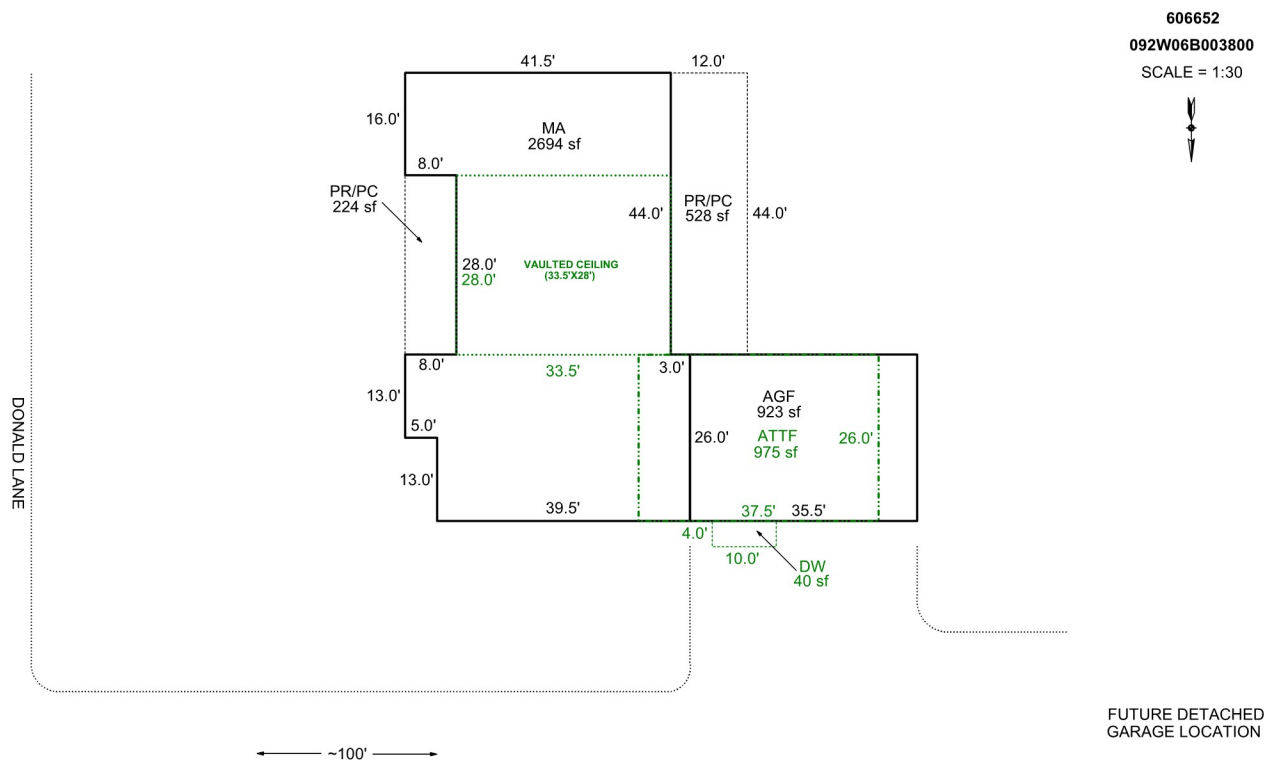

Sketch by Apex Sketch

[illegible]

ACCOUNT # 606652 DATE: 1/3/24 RMV CLASS 401 PROP CLASS 40
MTL 092W 6B 3400 APPR MDL TAG Y N
COMMENTS: _____

RESIDENCE / MANUFACTURED STRUCTURES

ACCESSORY IMPROVEMENTS / OUTBUILDINGS

STAT 5 QLTY + - FLOOR MA
AREA 2694 EFF AREA 2694 BED 2
ROOF + HVAC +
BATH PKG: 2 BATH 1 BATH+ 1 1/2 BTH
FIREPLACE: _____
KITCHEN A - +
YR BLT 2023 EFF YR 2023 ECON _____
% COMP 45 % GOOD _____ FUNC _____
EXCEPT Y N LUMP SUM: _____
MISC: _____
YI CLASS _____ F G A E
SKIRT + LIN FT _____
COMMENT: _____

STAT 5 QLTY + - FLOOR APF
AREA 975 EFF AREA 975 BED 2
ROOF + HVAC +
BATH PKG: 1 BATH _____ BATH+ _____ 1/2 BTH
FIREPLACE: _____
KITCHEN - +
YR BLT 2023 EFF YR 2023 ECON _____
% COMP 45 % GOOD _____ FUNC _____
EXCEPT Y N LUMP SUM: _____
MISC: _____
YI CLASS _____ F G A E
SKIRT + LIN FT _____
COMMENT: _____

STAT _____ QLTY + - FLOOR _____
AREA _____ EFF AREA _____ BED _____
ROOF + HVAC +
BATH PKG: _____ BATH _____ BATH+ _____ 1/2 BTH
FIREPLACE: _____
KITCHEN - +
YR BLT _____ EFF YR _____ ECON _____
% COMP _____ % GOOD _____ FUNC _____
EXCEPT Y N LUMP SUM: _____
MISC: _____
YI CLASS _____ F G A E
SKIRT + LIN FT _____
COMMENT: _____

TYPE ALF
STAT / CLASS 5
SIZE 923

FAIR
AVERAGE
GOOD
EXCELLENT

BATH _____

YR BLT 2023
EFF YR 2023
% COMP 45
EXCEPT Y N

MISC: _____
ROOF ALF
COMMENT: _____

TYPE _____
STAT / CLASS _____
SIZE _____

FAIR
AVERAGE
GOOD
EXCELLENT

BATH _____

YR BLT _____
EFF YR _____
% COMP _____
EXCEPT Y N
MISC: _____

COMMENT: _____

TYPE ALF
STAT / CLASS _____
SIZE _____

FAIR
AVERAGE
GOOD
EXCELLENT

BATH _____

YR BLT 2023
EFF YR 2023
% COMP 45
EXCEPT Y N

MISC: _____
COMMENT: _____

TYPE _____
STAT / CLASS _____
SIZE _____

FAIR
AVERAGE
GOOD
EXCELLENT

BATH _____

YR BLT _____
EFF YR _____
% COMP _____
EXCEPT Y N
MISC: _____

COMMENT: _____

Percent Complete Form

Account # 606657

Additions

New Homes

		No Basement		Basement	
% Item	% Sum	% Item	% Sum	% Item	% Sum
3%	0%	Plans/Survey	3%	3%	0%
2%		Excavation	2%	4%	
3%		Foundation	3%	10%	
35%	45%	Framing	14%	20%	35%
8%	50%	Trusses	7%	30%	40%
7%	60%	Roofing	7%	35%	45%
7%	65%	Windows/Ext Doors	7%	45%	55%
5%	70%	Siding	5%	50%	60%
4%	75%	Plumbing Rough-In	4%	3%	
3%		Electrical Rough-In	3%	2%	65%
2%	80%	Heating Rough-In	2%	1%	
		Heating Unit	1%	1%	
3%		Insulation	3%	2%	
5%	85%	Drywall (Finished)	5%	65%	70%
2%	90%	Paint Interior	2%	70%	75%
2%		Paint Exterior	2%	2%	
		Cabinets	6%	75%	80%
2%	95%	Electrical Fixtures	3%	80%	
2%		Plumbing Fixtures	4%	85%	85%
3%	100%	Floor Coverings & Countertops	7%	90%	90%
2%		Interior Trim Carpentry	7%	95%	95%
		Porch/Entry/Stoop	2%	100%	100%
		Finish Grade	1%	1%	

APPR MN

Date 1/3/24

YR For 24-25

% COMP 45

APPR

Date

YR For

% COMP

APPR

Date

YR For

% COMP

APPR

Date

YR For

% COMP

Percent Complete Form

Account # _____

Gut & Remodels

Interior Trim Carpentry	7%	90%
Floor Coverings & Countertops	7%	85%
Plumbing Fixtures	4%	80%
Electrical Fixtures	3%	80%
Cabinets	6%	75%
Drywall (Finished)	5%	70%
Insulation	3%	65%

APPR

Date

YR For

% COMP

APPR

Date

YR For

% COMP

APPR

Date

YR For

% COMP

APPR

Date

YR For

% COMP

Outbuilding Type: _____

	% Item	% Sum
Excavation/Foundation	10%	40%
Floor - Concrete/Wood	30%	
Walls - Framing	10%	65%
Walls - Covering/Siding	15%	
Roof - Framing/Trusses	15%	95%
Roof - Sheathing	5%	
Roof - Cover	10%	
Doors & Windows	5%	100%

APPR

Date

YR For

% COMP

APPR

Date

YR For

% COMP

APPR

Date

YR For

% COMP

APPR

Date

YR For

% COMP