

SKETCH/AREA TABLE ADDENDUM

SUBJECT INFO

File No.: 128925 Parcel No.: 091W04C001500
 Property Address: 9874 GOLF CLUB RD SE #50
 City: STAYTON County: State: OR ZipCode: 97383
 Owner:
 Client: Client Address:
 Appraiser Name: Inspection Date:

SKETCH

128925

091W04C001500

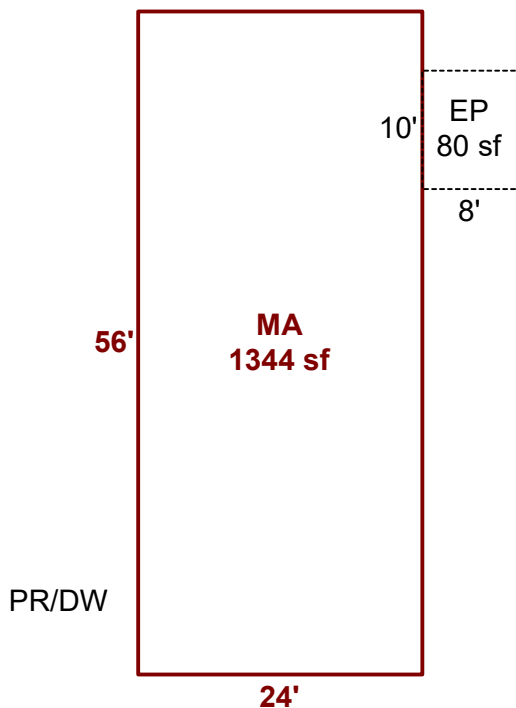

Sketch by ApexSketch

AREA CALCULATIONS SUMMARY

Code	Description	Factor	Net Size	Perimeter	Net Totals
MFH	MA	1.0	1344.0	160.0	1344.0
PR	EP	1.0	80.0	36.0	80.0

COMMENT TABLE 1

APEXED BY LK 8-8-24

COMMENT TABLE 2

2-9-24 SV TS

COMMENT TABLE 3

Net LIVABLE cnt 1 (rounded) 1,344