

SKETCH/AREA TABLE ADDENDUM

SUBJECT INFO

File No.: 130639 Parcel No.: 091W04C001500
 Property Address: 9874 GOLF CLUB RD SE #45
 City: STAYTON County: State: OR ZipCode: 97383
 Owner:
 Client: Client Address:
 Appraiser Name: Inspection Date:

SKETCH

130639

091W04C001500

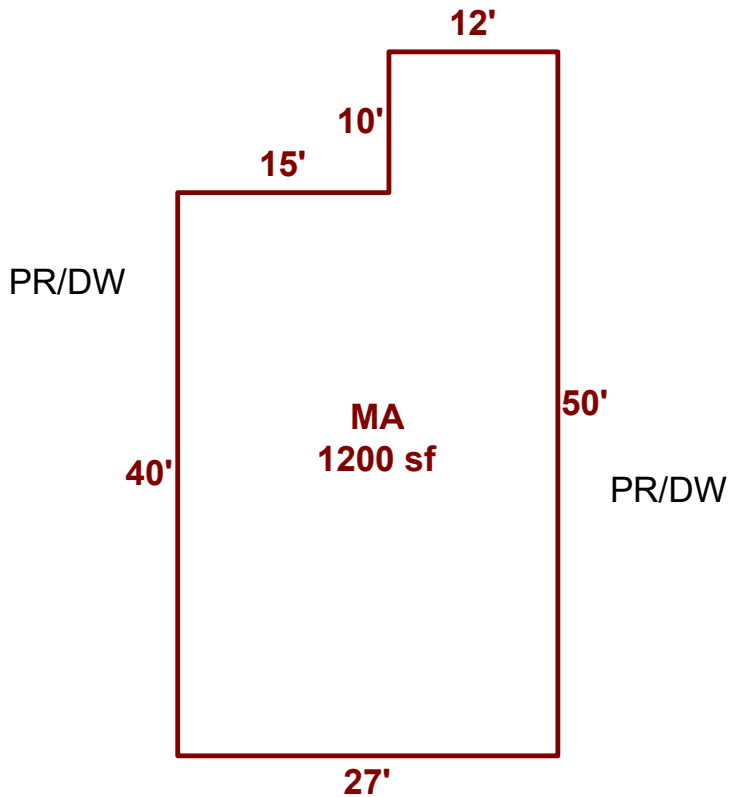

Sketch by ApexSketch

AREA CALCULATIONS SUMMARY						COMMENT TABLE 1	
Code	Description	Factor	Net Size	Perimeter	Net Totals		
MFH	MA	1.0	1200.0	154.0	1200.0	APEXED BY LK 8-8-24	
						COMMENT TABLE 2	COMMENT TABLE 3
						2-9-24 SV TS	
	Net LIVABLE	cnt	1	(rounded)	1,200		