

# SKETCH/AREA TABLE ADDENDUM

## SUBJECT INFO

File No.: 132529 Parcel No.: 083W23A002200  
 Property Address: 2120 ROBINS LN SE #175  
 City: SALEM County: State: OR ZipCode: 97306  
 Owner:  
 Client: Client Address:  
 Appraiser Name: Inspection Date:

## SKETCH

**132529**

**083W23A002200**

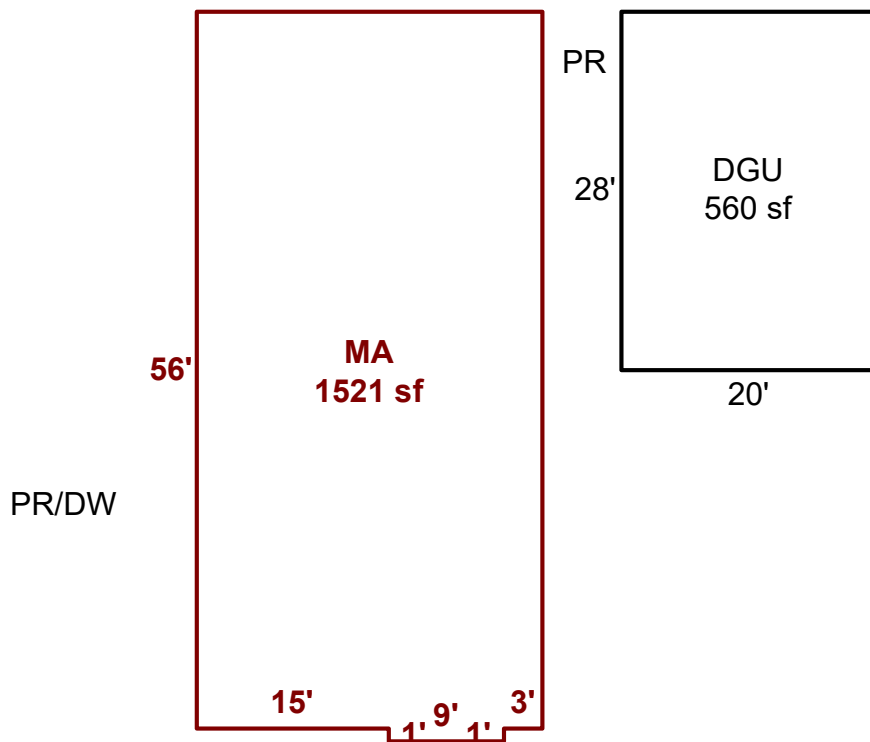

Sketch by ApexSketch

AREA CALCULATIONS SUMMARY						COMMENT TABLE 1	
Code	Description	Factor	Net Size	Perimeter	Net Totals		
GAR	DGU	1.0	560.0	96.0	560.0	APEXED BY LK 8-8-24	
MFH	MA	1.0	1521.0	168.0	1521.0		
						COMMENT TABLE 2	COMMENT TABLE 3
						2-6-24 SV TS	
Net LIVABLE		cnt	1	(rounded)	1,521		