

Acct ID: 529654 MTL: 082W10C000800 Date: 7/9/24 Appr: GRH Prop Class: 401 RMV Prop Class: 401
 Situs: 6576 JOSEPH ST SE SALEM OR 97317 MaSaNh: 07 06 000 Unit: 79327 Year: 2024
 Last Date Appraised: 12/01/2017 Appraiser: MATT LORD Retag: Y N Tag info:
 Owner: KAMSTRA, CHAD A Roll Type: R
 Cycle Tag Sales Verification Other: request Inspection level: 1 2 3 4 LCB TTO INSP AV: 192330
 RMV Land: 185850 RMV Imp: 22667 AV Total: 412520 MAV: 192330 MSAV: 0 SAV: 0
 Comment:

Notations Deferred maintenance on all improvements
 No notation data available. INPUT GRH 07.11.24

OSDs

Count	Code	Description	RMV	Code Area	Exception
1	MKTA	OSD - AVERAGE	45000	05410	0

Land
 Site: 1 Code Area: 05410 Size: 0.58 Acres Use Code: 004 Zone: NREST SAV Use: Exception: 0
 Class: Value Source: Rural at MKT Description: RMV: 140850 Exception: Y N
 Adjustment(s): Fire Patrol: Description:
 Comments: 2002-03 REAPPRAISAL.

Improvements - Residence / Manufactured Structures 1875
 Bldg: 1 Code Area: 05410 Stat Class: 132 Year Blt: 1875 Eff Year Blt: 1937 Sq.Ft: 1232 % Complete: 100
 Desc: Multi Story above grade Dimensions: RMV: 140850
 Func Obsc: 100 Econ %: 100 Other %: 100 Exception: 0 Adjust: Adjust RMV: 0

Floors

Type	Class	Display Group	Floor Size	Beds	Baths	Yr Blt	Eff Yr Blt	Inventory	Exception
First Floor	3	Finished	784	0	FB-1	1875	1937	BATH - 1, KIT, ROOF, HVAC+, FP - 1	Y N
Second Floor	3	Finished	448	2	0	1875	1937	HVAC+	Y N

Accessories part of YI's

Description	Class	Size SqFt	Eff Yr Blt	RMV	Quantity	Exception
CONCRETE DRIVEWAY	<u>3</u>	720	1988	1942	1	Y N
ENCLOSED PORCH	3	112	1937	2083	1	Y N
YARD IMPROVEMENTS AVERAGE	3	1	1937	10379	1	Y N

no value on PR/DW - must be replaced

Bldg: 2 Code Area: 05410 Stat Class: 138 Year Blt: 1988 Eff Year Blt: 1976 Sq.Ft: 352 % Complete: 100
 Desc: Res other improvements Dimensions: RMV: 82860
 Func Obsc: 100 Econ %: 100 Other %: 100 Exception: 0 Adjust: Adjust RMV: 0

Floors History had attic used as office.

Type	Class	Display Group	Floor Size	Beds	Baths	Yr Blt	Eff Yr Blt	Inventory	Exception
Attic	3	Finished	352	X	FB-1	1999	1999	BATH - 1, HVAC	Y N
Garage Detached	3	Unfinished	576	0	0	1988	1988	ROOF	Y N

Accessories deferred maintenance

Description	Class	Size SqFt	Eff Yr Blt	RMV	Quantity	Exception
No accessory data available						

Improvements - Accessory Buildings 1993
 Bldg: 3 Code Area: 05410 Stat Class: 353 Year Blt: 2005 Eff Year Blt: 2005 Sq.Ft: 264 % Complete: 100
 Desc: Machine Shed (MS) chg to mp Dimensions: 11x24 RMV: 2960
 Func Obsc: 100 Econ %: 100 Other %: 100 Exception: 0 Adjust: Adjust RMV: 0

Floors deferred maintenance siding; part of structure is on blocks to hold wall

Type	Class	Display Group	Floor Size	Beds	Baths	Yr Blt	Eff Yr Blt	Inventory	Exception
Machine Shed	<u>5</u>	Finished	264	0	0	2005	2005	<u>Fair</u>	Y N

Accessories class 4

Description	Class	Size SqFt	Eff Yr Blt	RMV	Quantity	Exception
No accessory data available						

07.09.24

During my visit to the property the following were found

- deferred maintenance windows and siding on house and detached garage
- Roof is in need of repair
- Yard improvements porch roof and deck wood are falling apart
- Gutter are not properly installed
- Garage door is in poor condition

Interior: no recent updates, appeared to be updated once . I did not go inside.

APEX UPDATED

R29654
082W10C 00800
SCALE=1:20

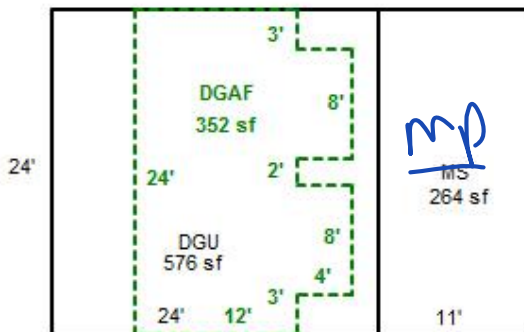
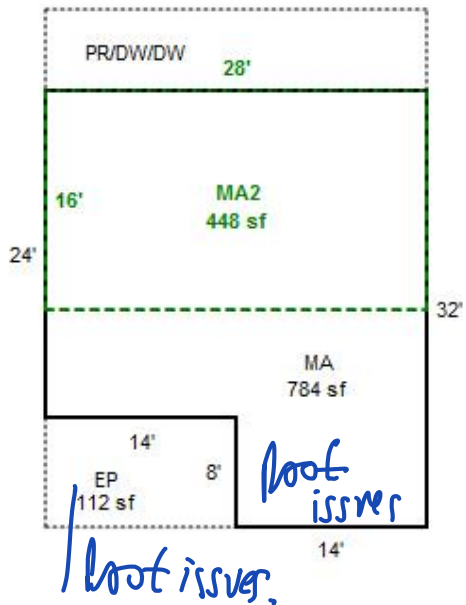
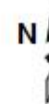

GRH 7/12/24
cycle L2



MA MA2



MA MA2



MA MA2



DG



DG



BACK MA



DG



NV



MP DG



MP



Overview

R29654
01/18/2017



MA - Rear

R29654

01/18/2017



MA

R29654

01/18/2017



MA - Front

R29654
01/18/2017



DGF

R29654

01/18/2017



MS 11x24

R29654
01/18/2017

