

Summary

Lead Appr: _____ Clerk: **Chris 10/23/23** Lead Clerk: _____ Appr: _____

5-26-23 WW

Acct ID: 533158 MTL: 083W28BA00600 Date: _____ Appr: _____ Prop Class: 641 RMV Prop Class: 401
 Situs: 6984 BATES RD S SALEM OR 97306 MaSaNh: 06 06 000 Unit: 34350 Year: 2023

Last Date Appraised: 02/27/2013 Appraiser: _____ Retag: Y N Tag info: _____

Owner: GOLDBERG, JEFFREY A & GOLDBERG, DEIDRE L Roll Type: R

Cycle Tag Sales Verification Other: **FPV** Inspection level: 1 2 3 **4** LCB TTO INSP AV: 311595

RMV Land: 239020 RMV Imp: 323670 RMV Total: 562690 MAV: 310840 MSAV: 755 SAV: 1174

Comment:

DFL OK review aerial 2025 due to past free to grow concerns

Notations

RP/MS	Code	Description
RP	411	SEE ACCOUNT NOTES - 411
RP	DFL	DESIGNATED FORESTLAND

OSDs

Count	Code	Description	RMV	Code Area	Exception
1	MKTA	OSD - AVERAGE	45000	92430	0

Land

Site: 1 Code Area: 92430 Size: 1.00 Acres Use Code: 005 Zone: NREST SAV Use: _____ Exception: 0
 Class: Value Source: Market Homesite Description: _____ RMV: 80840 Exception: Y N

Adjustment(s): **4 HD** Fire Patrol: _____ Description: _____
 Comments: 02400230/13-14: TAXLOT QUALIFIES DUE TO ADJACENT TAX LOT R33175 /09-10: HOMESITE NOT SPEC ASS'D DUE TO UNZONED FOREST DEFERRAL///00-01; SEPERATED INCREMENT FROM HOMESITE /01-02; REAPPRAISAL

Site: 2 Code Area: 92430 Size: 1.40 Acres Use Code: 005 Zone: NREST SAV Use: 011 Exception: 0
 Class: DFLC Value Source: Designated Forest Land Description: DESIG FOREST FC0 RMV: 113180 Exception: Y N

Adjustment(s): _____ Fire Patrol: _____ Description: _____
 Comments: Liability year - 1992 / 2400230: 01-02; REAPPRAISAL

Improvements - Residence / Manufactured Structures

Bldg: 1 Code Area: 92430 Stat Class: 142 Year Blt: 1979 Eff Year Blt: 1979 Sq.Ft: 2512 % Complete: 100
 Desc: Multi Story above grade Dimensions: _____ RMV: 323670
 Func Obsc: 100 Econ %: 100 Other %: 100 Exception: 0 Adjust: _____ Adjust RMV: 0

Floors

Type	Class	Display Group	Floor Size	Beds	Baths	Yr Blt	Eff Yr Blt	Inventory	Exception: Y N
First Floor	4	Finished	984	0	FB-1/ HB-1	1979	1979	BTH - 1, KIT+, HVAC+, FP, ROOF	Exception: Y N
Second Floor	4	Finished	1528	4	FB-2	1979	1979	BATH - 2, HVAC+	Exception: Y N
Garage Attached	4	Finished	528	0	0	1979	1979	ROOF	Exception: Y N

Accessories

Description	Class	Size SqFt	Eff Yr Blt	RMV	Quantity	Exception: Y N
YARD IMPROVEMENTS AVERAGE	4	1	1979	22397	1	Exception: Y N

Improvements - Accessory Buildings

No improvement data available for all other stat class types.

SKETCH/AREA TABLE ADDENDUM

SUBJECT INFO

File No.: 533158 Parcel No.: 083W28BA00600
 Property Address: 6984 BATES RD S
 City: SALEM County: State: OR ZipCode: 97306
 Owner:
 Client: Client Address:
 Appraiser Name: Inspection Date:

SKETCH

083W28BA00600
533158
 SCALE=1:30

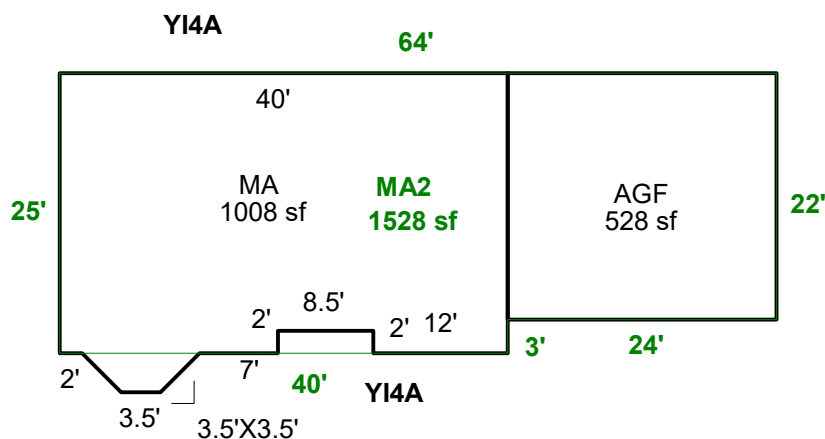

Sketch by ApexSketch

AREA CALCULATIONS SUMMARY						COMMENT TABLE 1		
Code	Description	Factor	Net Size	Perimeter	Net Totals			
GLA1	MA	1.0	1007.5	136.9	1007.5	APEXED BY NRC 04/09/2009		
GLA2	MA2	1.0	1528.0	178.0	1528.0			
GAR	AGF	1.0	528.0	92.0	528.0			
Net LIVABLE						cnt	2 (rounded)	2,536
						COMMENT TABLE 2	COMMENT TABLE 3	
						04/22/20 #06 05/26/23 WW	FF FF L4	