

Summary

Lead Appr: ^{input} NW 2/21/24 Clerk: _____ Lead Clerk: _____ Appr: _____

Print Date: 12/14/2023

Acct ID: 533320 MTL: 083W29D000800 Date: 2-13-24 Appr: WW Prop Class: 551 RMV Prop Class: ~~551~~ 501
Situs: 7905 TWIN FIR LN S SALEM OR 97306 MaSaNh: 06 06 000 Unit: 81235 Year: 2024

Last Date Appraised: 03/29/2018 Appraiser: WENDY WILLIAMS Retag: Y N Tag info: 2024 - NEW CONSTRUCTION (Residence)

Owner: SMITH, MATTHEW L Roll Type: R

Cycle Tag Sales Verification Other: _____ Inspection level: 1 2 3 4 LCB TTO INSP AV: 39392

RMV Land: 664210 RMV Imp: 20490 RMV Total: 684700 MAV: 9410 MSAV: 29982 SAV: 48414

Comment:

MA @ 55% add SAOSD +
homesite

23-004377 NSFD 3
BDRM 4 BATH
INSULATION 12/9

Notations

RP/MS	Code	Description
RP	ZONED	FARM EFU ZONED

FARM USE: vinyl good
appointment

OSDs SA OSDN

No OSD data available.

Land CREATE HOMESITE

Site: 1 Code Area: 92430 Size: 25.53 Acres Use Code: 005 Zone: REST SAV Use: 011 Exception: 0
 Class: 4HD Value Source: Farm Use - EFU Description: FOUR HILL DRY RMV: 469860 Exception: Y N
 Adjustment(s): GSOIL Fire Patrol: Description:

Comments: Liability year - 1981 / 02400230: 01-02; COMBINED LAND SEGGS, SAME SOIL CLASS, SAME LIAB YEAR, 35.13 ACRES TOTAL .01-02: REAPP

Site: 2 Code Area: 92430 Size: 9.60 Acres Use Code: 005 Zone: REST SAV Use: 011 Exception: 0
 Class: 2HD Value Source: Farm Use - EFU Description: TWO HILL DRY RMV: 194350 Exception: Y N
 Adjustment(s): GSOIL Fire Patrol: Description:

Comments: Liability year - 1981

Improvements - Residence / Manufactured Structures

No residence or manufactured structure improvement data available.

Improvements - Accessory Buildings

Bldg: 1 Code Area: 92430 Stat Class: 351 Year Blt: 2017 Eff Year Blt: 2017 Sq.Ft: 1080 % Complete: 100
 Desc: General Purpose Building (GB) Dimensions: 30x36 RMV: 20490
 Func Obsc: 100 Econ %: 100 Other %: 100 Exception: 0 Adjust: Adjust RMV: 0

Floors

Type	Class	Display Group	Floor Size	Beds	Baths	Yr Blt	Eff Yr Blt	Inventory	Exception: Y N
General Purpose Bldg	5	Finished	1080	0	0	2017	2017	FAIR	Y N

Accessories

Description	Class	Size SqFt	Eff Yr Blt	RMV	Quantity
No accessory data available					

151-
1ST FP-2, BTH-1,
BATH-2, BED-3, KIT
+, HVAC, ROOF
2ND ATTU
AGF BATH, ROOF
H2







SKETCH/AREA TABLE ADDENDUM

SUBJECT INFO

File No.: 533320 Parcel No.: 083W29D 00800
 Property Address: 7895 TWIN FIR LN S
 City: SALEM County: MARION State: OR ZipCode: 97306
 Owner:
 Client: Client Address:
 Appraiser Name: Inspection Date:

SKETCH

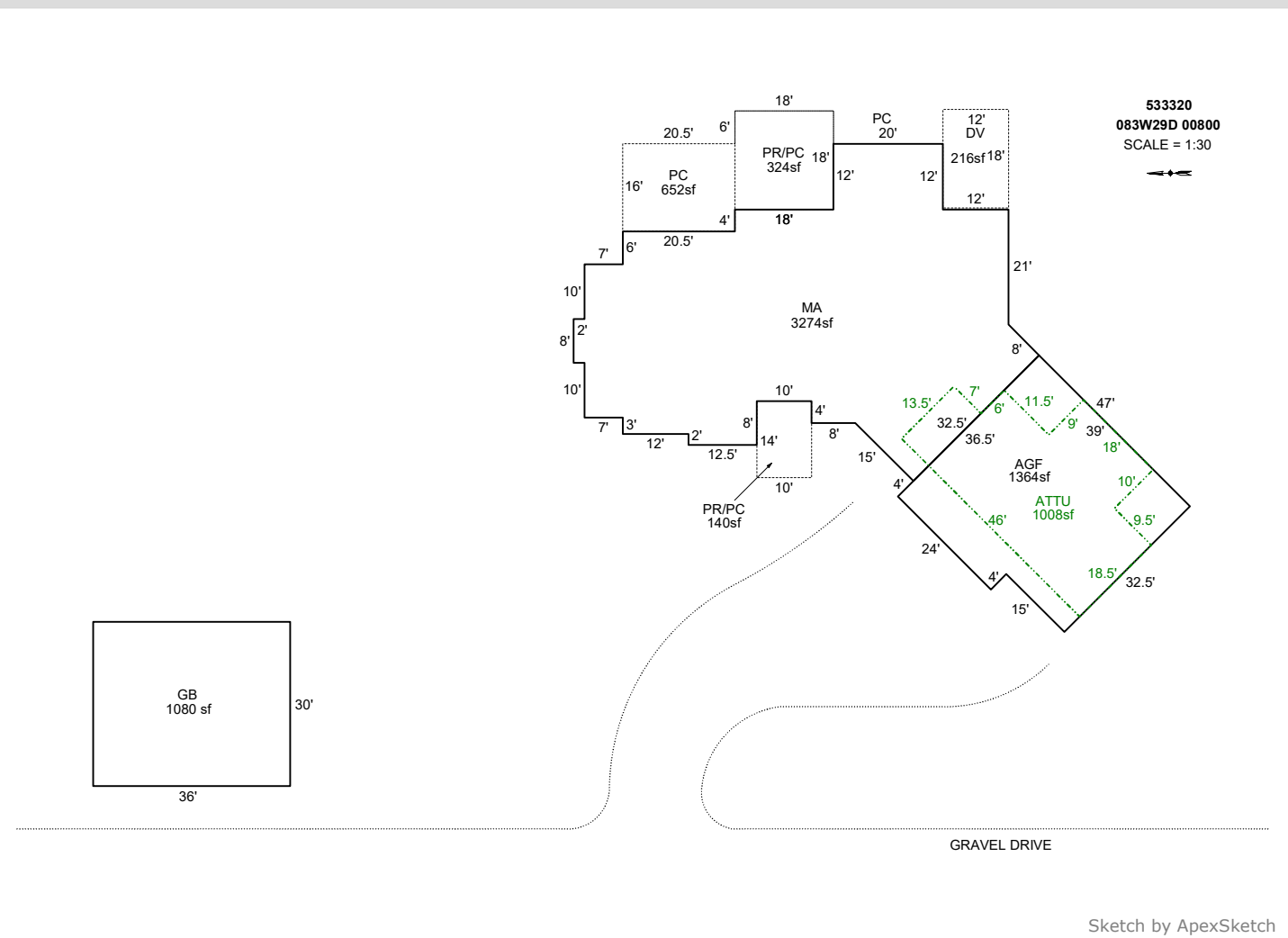

AREA CALCULATIONS SUMMARY						COMMENT TABLE 1	
Code	Description	Factor	Net Size	Perimeter	Net Totals		
GBA1	GB	1.0	1080.0	132.0	1080.0	DRAWN BY JRONDEMA 5/2/17 UPDATED BY CJURAN 08/15/2023 555-23-004377 UPDATED BY WWILLIAMS 2/21/24	
GLA1	MA	1.0	3274.3	286.4	3274.3		
GLA2	ATTU	1.0	1007.5	149.0	1007.5		
GAR	AGF	1.0	1363.5	151.0	1363.5		
P/P	PR/PC	1.0	140.0	48.0			
	PC	1.0	652.0	121.0			
	PR/PC	1.0	324.0	72.0			
	DV	1.0	216.0	60.0	1332.0	COMMENT TABLE 2	COMMENT TABLE 3
						WW 02.13.24	TAGS L1
	Net LIVABLE	cnt	2	(rounded)	4,282		
	Net BUILDING	cnt	1	(rounded)	1,080		

Percent Complete Form

Account # _____

Additions

New Homes

<u>Additions</u>		<u>New Homes</u>				
% Item	% Sum		No Basement		Basement	
			% Item	% Sum	% Item	% Sum
3%		Plans/Survey	3%		3%	
2%	0%	Excavation	2%	0%	4%	0%
3%		Foundation	3%		10%	
35%	45%	Framing	14%	20%	16%	35%
8%	50%	Trusses	7%	30%	7%	40%
7%	60%	Roofing	7%	35%	7%	45%
7%	65%	Windows/Ext Doors	7%	45%	6%	55%
5%	70%	Siding	5%		5%	
4%	75%	Plumbing Rough-In	4%	50%	3%	60%
3%		Electrical Rough-In	3%	55%	2%	
2%	80%	Heating Rough-In	2%		1%	65%
		Heating Unit	1%	60%	1%	
3%		Insulation	3%		2%	
5%	85%	Drywall (Finished)	5%	65%	4%	70%
2%	90%	Paint Interior	2%	70%	2%	75%
2%		Paint Exterior	2%		2%	
		Cabinets	6%	75%	5%	80%
2%	95%	Electrical Fixtures	3%	80%	2%	
2%		Plumbing Fixtures	4%	85%	3%	85%
3%		Floor Coverings & Countertops	7%	90%	6%	90%
2%	100%	Interior Trim Carpentry	7%	95%	6%	95%
		Porch/Entry/Stoop	2%	100%	2%	100%
		Finish Grade	1%		1%	

APPR WW Date 2.14.23 YR For 24-25 % COMP 55
 APPR _____ Date _____ YR For _____ % COMP _____
 APPR _____ Date _____ YR For _____ % COMP _____
 APPR _____ Date _____ YR For _____ % COMP _____

ACCOUNT # _____ DATE: _____ RMV CLASS _____ PROP CLASS _____
 MTL _____ APPR _____ TAG Y N _____
 COMMENTS: _____

RESIDENCE / MANUFACTURED STRUCTURES

ACCESSORY IMPROVEMENTS / OUTBUILDINGS

STAT 152 QLTY + 0 FLOOR MA
 AREA 3274 EFF AREA _____ BED 3
 ROOF + HVAC +
 BATH PKG: 0 BATH _____ BATH + 1 1/2 BTH
 FIREPLACE: 2
 KITCHEN - +
 YR BLT 23 EFF YR 23 ECON _____
 % COMP 55 % GOOD _____ FUNC _____
 EXCEPT Y N LUMP SUM: _____
 MISC: _____
 YI CLASS 5 F G A E
 SKIRT + LIN FT _____
 COMMENT: _____

TYPE _____
 STAT / CLASS _____
 SIZE _____
 FAIR
 AVERAGE
 GOOD
 EXCELLENT
 BATH _____
 YR BLT _____
 EFF YR _____
 % COMP _____
 EXCEPT Y N
 MISC: _____
 COMMENT: _____

TYPE _____
 STAT / CLASS _____
 SIZE _____
 FAIR
 AVERAGE
 GOOD
 EXCELLENT
 BATH _____
 YR BLT _____
 EFF YR _____
 % COMP _____
 EXCEPT Y N
 MISC: _____
 COMMENT: _____

STAT _____ QLTY + - FLOOR altu
 AREA 1008 EFF AREA _____ BED _____
 ROOF + HVAC +
 BATH PKG: _____ BATH _____ BATH + _____ 1/2 BTH
 FIREPLACE: _____
 KITCHEN - +
 YR BLT 23 EFF YR 23 ECON _____
 % COMP 55 % GOOD _____ FUNC _____
 EXCEPT Y N LUMP SUM: _____
 MISC: _____
 YI CLASS _____ F G A E
 SKIRT + LIN FT _____
 COMMENT: _____

TYPE _____
 STAT / CLASS _____
 SIZE _____
 FAIR
 AVERAGE
 GOOD
 EXCELLENT
 BATH _____
 YR BLT _____
 EFF YR _____
 % COMP _____
 EXCEPT Y N
 MISC: _____
 COMMENT: _____

TYPE _____
 STAT / CLASS _____
 SIZE _____
 FAIR
 AVERAGE
 GOOD
 EXCELLENT
 BATH _____
 YR BLT _____
 EFF YR _____
 % COMP _____
 EXCEPT Y N
 MISC: _____
 COMMENT: _____

STAT _____ QLTY + - FLOOR agb
 AREA 1364 EFF AREA _____ BED _____
 ROOF + HVAC +
 BATH PKG: _____ BATH _____ BATH + 1 1/2 BTH
 FIREPLACE: _____
 KITCHEN - +
 YR BLT 23 EFF YR 23 ECON _____
 % COMP 55 % GOOD _____ FUNC _____
 EXCEPT Y N LUMP SUM: _____
 MISC: _____
 YI CLASS _____ F G A E
 SKIRT + LIN FT _____
 COMMENT: _____

TYPE _____
 STAT / CLASS _____
 SIZE _____
 FAIR
 AVERAGE
 GOOD
 EXCELLENT
 BATH _____
 YR BLT _____
 EFF YR _____
 % COMP _____
 EXCEPT Y N
 MISC: _____
 COMMENT: _____

TYPE _____
 STAT / CLASS _____
 SIZE _____
 FAIR
 AVERAGE
 GOOD
 EXCELLENT
 BATH _____
 YR BLT _____
 EFF YR _____
 % COMP _____
 EXCEPT Y N
 MISC: _____
 COMMENT: _____



R33320

GB

3-29-18



R33320
VINEYARD

3-29-18