

Summary

Lead Appr: Clerk: Lead Clerk: Appr:

Print Date:

6/6/2024

Acct ID: 128543 MTL: 082W06DA00500P1 Date: 7/10/23 Appr: 02 Prop Class: 019 RMV Prop Class: 019

Situs: 4378 ESSEX ST SE SALEM, OR 97317 MaSaNh: 17 05 000 Unit: 141496 Year: 2024

Last Date Appraised: 08/05/2016 Appraiser: THERESA SWEARINGEN Retag: Y N Tag info:

Owner: FRITTS, KATHYLEEN

Roll Type: MS

Cycle Tag Sales Verification Other: Inspection level: 1 2 3 4 LCB TTO INSP

AV: 33500

RMV Land: 0 RMV Imp: 33500 RMV Total: 33500 MAV: 37990 MSAV: 0

SAV: 0

Comment: 23-24 Uncoded Accessory Project

Notations

update Inv & EY B I/O

No notation data available.

OSDs

No OSD data available.

Land

No land data available.

Improvements - Residence / Manufactured Structures

Bldg: 1 Code Area: 24010 Stat Class: 466 Year Blt: 1978 Eff Year Blt: 1978 Sq.Ft: 1440 % Complete: 100
Desc: MANUF STRUCT, CLASS 6, 24' WIDE DOUBLE Dimensions: 60x24 RMV: 33500
Func Obsc: 100 Econ %: 100 Other %: 100 Exception: 0 Adjust: Adjust RMV: 0

Floors

Table with columns: Type, Class, Display Group, Floor Size, Beds, Baths, Yr Blt, Eff Yr Blt, Inventory, Exception. Row 1: First Floor, 6, Finished, 1440, 2, FB-2, 1978, 1978, BATH - 2, KIT, HVAC+, ROOF+, SKIRT, Exception: Y N

Accessories

Table with columns: Description, Class, Size SqFt, Eff Yr Blt, RMV, Quantity, Exception. Rows: DECK (6, 147, 1978, 647, 0, Exception: Y N), GARDEN SHED (6, 120, 1988, 428, 0, Exception: Y N), ROOF EXTENSION OR PATIO COVER (6, 320, 1978, 1856, 0, Exception: Y N)

Improvements - Accessory Buildings

No improvement data available for all other stat class types.



Handwritten notes: 'mcs Kit Redone 2000', 'Awards - new kitchen w/m.'

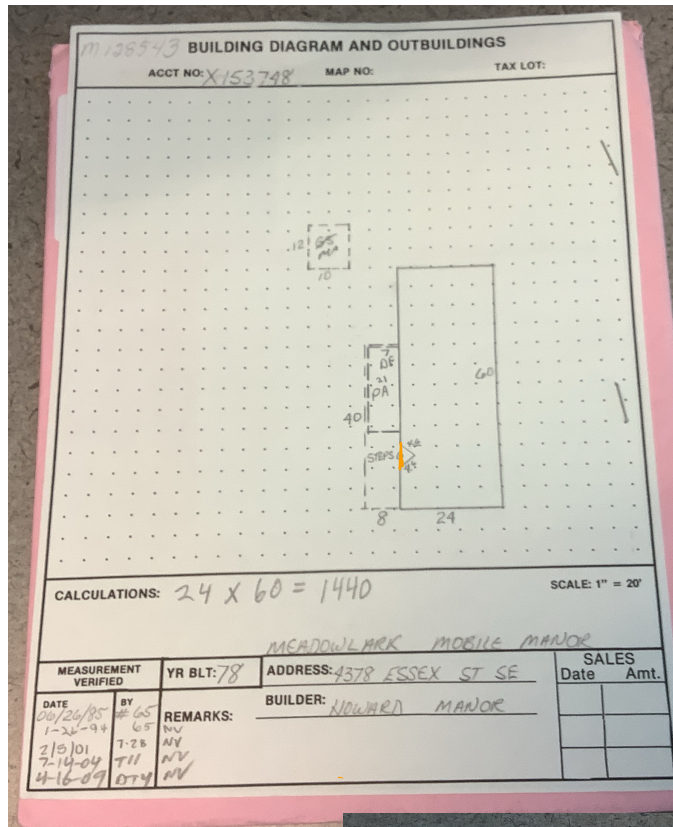

M128543 082W06DA00500 Appr: DTY Date 8-5-16 Prop Class 019 Prop Code T66
 Situs Address 4378 ESSEX ST SE Franchise Code 04 Year For: 2016-2017
 Owner BLADE, JESSICA R

Notes: No chg Tags Cycle Sales Verification Other: _____

RMV Imp: 16,850 RMV Total: 16,850 MSO Total: 16,850

Seg. Type MA	Seg. # 1.1	Method M04	Class 6D	Area 1440	Eff Area 1440	Length 60	Width 24
Make: SILVER CREST	Mode: HOWARD MANOR	Int. Comp: CKTP, OVEN-S, DW, DSP	Bedrooms: 2	Roof Cover BKENAM	Plumbing BATH2	Heat AC	Fireplace:
Year Built 1978	Eff. Year Built 1978	Cond. P F A G E	% Comp	Func	Econ	RMV 13,640	
Adj Codes MSLCMD	Qty <u>6</u>	% Comp	Func	Econ	RMV 13,640		
Lump Sum	Except Code/Year	Comments					

Accessory Improvements

Seg. Type PA	MFD STRUCT	Seg. # 1.3	Method: R05	Class	Area 320	Eff Area 320
Length 40	Width 8	Foundation	Ex. Wall	Plumbing	Roof Cover	
Year Built	Eff. Year Built: 1978	Cond. P F A G E	% Comp	Econ	RMV: 1,230	
Lump Sum	Except Code/Year	Comments				

Seg. Type DF	MFD STRUCT	Seg. # 1.4	Method: R05	Class	Area 147	Eff Area 147
Length 21	Width 7	Foundation	Ex. Wall	Plumbing	Roof Cover	
Year Built	Eff. Year Built: 1978	Cond. P F A G E	% Comp	Econ	RMV: 380	
Lump Sum	Except Code/Year	Comments				

Out Buildings and Skirting

Seg. Type MHSK	MFD STRUCT	Seg. # 1.2	Method: M04	Class	Area 168	Eff Area 168
Length	Width	Foundation	Ex. Wall METAL	Roof Cover		
Year Built	Eff. Year Built: 1978	Cond. P F A G E	% Comp	Func	Econ	RMV: 190
Lump Sum	Except Code/Year	Comments				

Seg. Type GS	RESIDENTIAL	Seg. # 2.1	Method: R05	Class	Area 120	Eff Area 120
Length 12	Width 10	Foundation	Ex. Wall 8FT; PLYWD	Roof Cover COMP		
Year Built	Eff. Year Built: 1988	Cond. P F A G E	% Comp	Func	Econ	RMV: 1,410
Lump Sum	Except Code/Year	Comments				



08-05-16 M128543



Marion County
OREGON
ASSESSOR'S OFFICE

Date Printed: 6/6/2024

Appraiser Sales Verification From

Primary Acct: 128543
MTL: 082W06DA00500
MaSaNh/P.Class: 1705000/019
Appraiser: THERESA
MS Acct: SWEARINGEN
128543

Situs: 4378 ESSEX ST SE SALEM, OR 97317

Grantor:
BLADE, JESSICA R

Grantee:
FRITTS, KATHYLEEN

Deed: MS
Accts In Sale: 1
Sale Date: 2/23/2024
Sale Price: 40,000
Code: 00
Ratio: 84

Total Sale RMV:
Land:
OSD:
Imp:
Grand Total: 33500

Attempt	Date/Time	Reason
1 st	7/10/25 12:15	LCB
2 nd		

Contact: Bob Fritts Phone/email: _____

- Was the property listed on the open market? Days: 51 MLS: 812245 Y N
- Was property other than real estate included in the sale? Y N
Describe: _____ Est. \$: _____
- Did the seller pay closing costs or make other concessions? \$ _____ Y N
- Was the sale between related parties? (business or family) Y N
- Was this a distressed sale? E.g. foreclosure, short, court order, etc... Y N
- Condition at time of sale: | Poor | Fair | Avg. | Good | Exc. | Y N
Describe: _____

- Have any improvements been made since the time of sale? Y N
If yes, describe: wiring issues
Felt paid Fair price

Comments: Looking at another Home in part

Appraiser: 02 Date: 7/17/24