

Summary Lead Appr: _____ Clerk: _____ Lead Clerk: _____ Appr: _____ Print Date: _____

Acct ID: 330375 MTL: 072W30DA00100P1 Date: 7/10/24 Appr: 02 ts 8-5-24 6/6/2024
Prop Class: 019 RMV Prop Class: 019

Situs: 4730 AUBURN RD NE # 50 SALEM, OR 97301 MaSaNh: 14 05 003 Unit: 330375 Year: 2024

Last Date Appraised: 05/27/2010 Appraiser: THERESA SWEARINGEN Retag: Y N Tag info:
Owner: VINCENT, CHRISTOPHER Roll Type: MS
Cycle Tag Sales Verification Other: _____ Inspection level: 1 2 3 4 LCB TTO INSP AV: 70590
RMV Land: 0 RMV Imp: 84570 RMV Total: 84570 MAV: 70590 MSAV: 0 SAV: 0
Comment: SALEM GREENE ESTATES, SPACE #50, MS SERIAL # ORFL248A28593, X # X00255483, PERSONAL MS

Notations

No notation data available.

update roof JTD
+ ZNW

OSDs

No OSD data available.

Land

No land data available.

Improvements - Residence / Manufactured Structures

Bldg: 1 Code Area: 24622 Stat Class: 457 Year Blt: 2002 Eff Year Blt: 2002 Sq.Ft: 1539 % Complete: 100
Desc: MANUF STRUCT, CLASS 5, 26' THROUGH 28' WIDE DOUBLE Dimensions: 57x27 RMV: 84570
Func Obsc: 100 Econ %: 100 Other %: 100 Exception: 0 Adjust: Adjust RMV: 0

Floors

Type	Class	Display Group	Floor Size	Beds	Baths	Yr Blt	Eff Yr Blt	Inventory	Exception: Y N
First Floor	5	Finished	1539	3	FB-2	2002	2002	BATH - 2, KIT, HVAC+, ROOF, SKRT+	Y N

Accessories

Description	Class	Size SqFt	Eff Yr Blt	RMV	Quantity	Exception: Y N
ROOF EXTENSION OR PATIO COVER	5	100	2002	1595	0	Y N
ROOF EXTENSION OR PATIO COVER	5	120	2002	1914	0	Y N
ROOF EXTENSION OR PATIO COVER	5	210	2002	3350	0	Y N

Improvements - Accessory Buildings

No improvement data available for all other stat class types.



new roof
MLS
new floors
AC

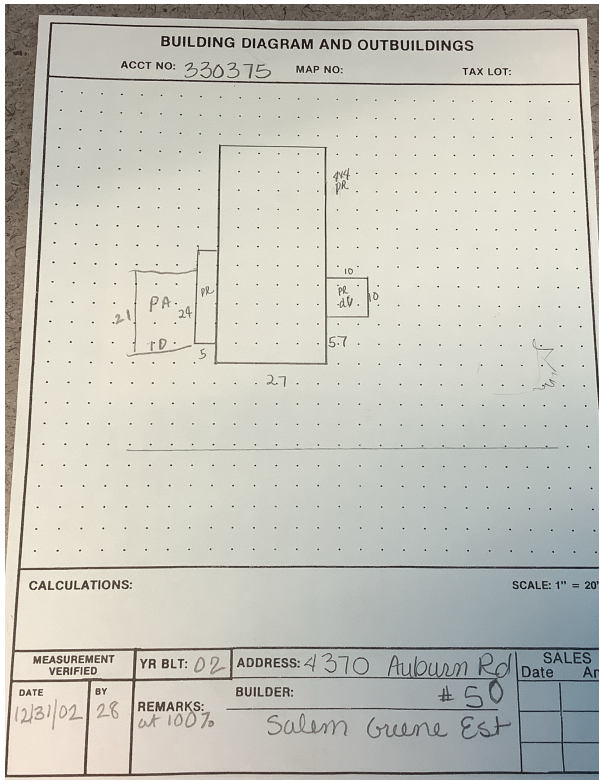

M330375 072W30DA00100 Appr #: DT4 Date 5-27-10 Prop Class 019 Prop Code 107T57
 Situs Address 4730 AUBURN RD NE, #50 Franchise Code 04 Year For: 2010-2011
 Owner MARGARET E PAULSEN RT &

Notes: change as noted (class, micro, DC is PA) SEE BELOW

RMV Imp: 53,880 RMV Total: 53,880 M50 Total: 37,000

Seg.Type MA	Seg. # 1.1	Method M04	Class <u>5D</u>	Area 1539	Eff Area 1539	Length 57	Width 27
Make: FLEETWOOD	Model:		Infinish: DRYWL		Roof Cover COMP		
Plumbing BATH2	Heat AC	Fireplace	Inter. Comp: DSP, DW, H&F		<u>Micro</u>	Bedrooms 3	
Year Built 2002	Eff. Year Built 2002		Cond. P F (A) G E				
Adj Code MSLCMD;MSD;OLTY	Qty <u>5</u>		% Comp ___ Func ___ Econ ___		RMV 45,350		
Lump Sum ___	Except Code/Year ___		Comments <u>white cabinets listed for 49,900</u>				

Accessory Improvements

Seg.Type PF	Seg. # 1.3	Method: R05	Class	Area 120	Eff Area 120
Length 24	Width 5				
Year Built	Eff. Year Built: 2002		Cond. P F A G E	% Comp ___ Econ ___	RMV: 1,590
Lump Sum ___	Except Code/Year ___		Comments		

Seg.Type PF	Seg. # 1.4	Method: R05	Class	Area 100	Eff Area 100
Length 10	Width 10				
Year Built	Eff. Year Built: 2002		Cond. P F A G E	% Comp ___ Econ ___	RMV: 1,320
Lump Sum ___	Except Code/Year ___		Comments		

Out Buildings and Skirting

Seg.Type MHSK	Seg. # 1.2	Method: M04	Class	Area 168	Eff Area 168
Length	Width	Foundation	Ex. Wall CBLOCK	Roof Cover	
Roof Style		Floor	Plumbing		
Heat	Int. Comp.		Elect.	Yr. Blt. 2002	Eff. Yr. Blt: 2002
Cond. P F A G E	Adj. Codes		% Comp ___ Func ___ Econ ___		RMV: 1,730
Lump Sum ___	Except Code/Year ___		Comments		

Seg.Type <u>DEPA</u>	Seg. # 1.5	Method: R05	Class <u>3</u>	Area 200	Eff Area 200
Length 20	Width 10	Foundation	Ex. Wall	Roof Cover METAL	
Roof Style GABLE		Floor DIRT	Plumbing		
Heat	Int. Comp.		Elect.	Yr. Blt. 2002	Eff. Yr. Blt: 2002
Cond. P F A G E	Adj. Codes <u>RECM3</u>		% Comp ___ Func ___ Econ ___		RMV: 3,890
Lump Sum ___	Except Code/Year ___		Comments		





Marion County
OREGON
ASSESSOR'S OFFICE

Date Printed: 6/6/2024

Appraiser Sales Verification From

Primary Acct: 330375
MTL: 072W30DA00100
MaSaNh/P.Class: 1405003/019
Appraiser: THERESA
MS Acct: SWEARINGEN
330375

Situs: 4730 AUBURN RD NE # 50 SALEM, OR 97301

Grantor:
NOONAN, PATRICIA J

Grantee:
VINCENT, CHRISTOPHER

Deed: MS
Accts In Sale: 1
Sale Date: 3/20/2024
Sale Price: 120,000
Code: 00
Ratio: 70

Total Sale RMV:
Land:
OSD:
Imp:
Grand Total: 84570

Attempt	Date/Time	Reason
1 st		
2 nd		

Contact: _____ Phone/email: _____

- Was the property listed on the open market? Days: 72 MLS: 812382 Y N
- Was property other than real estate included in the sale? Y N
Describe: _____ Est. \$: _____
- Did the seller pay closing costs or make other concessions? \$ _____ Y N
- Was the sale between related parties? (business or family) Y N
- Was this a distressed sale? E.g. foreclosure, short, court order, etc... Y N
- Condition at time of sale: | Poor | Fair | Avg. | Good | Exc. | Y N
Describe: _____

- Have any improvements been made since the time of sale? Y N
If yes, describe: _____

Comments:

Sent in letter

Appraiser: 02 Date: 7/10/24