

LAK 8.21.24

Summary Lead Appr: \_\_\_\_\_ Clerk: \_\_\_\_\_ Lead Clerk: \_\_\_\_\_ Appr: \_\_\_\_\_ Print Date: 8/5/2024

Acct ID: 124804 MTL: 061W33A001000P1 Date: 8/13/24 Appr: 02 Prop Class: 019 RMV Prop Class: 019

Situs: 1732 PINE ST NE # 20 SILVERTON, OR 97381 MaSaNh: 12 05 002 Unit: 140171 Year: 2024

Last Date Appraised: 08/08/2022 Appraiser: THERESA SWEARINGEN Retag: Y N Tag info:

Owner: MCALLISTER, ALEC Roll Type: MS

Cycle Tag Sales Verification Other: \_\_\_\_\_ Inspection level: 1 2 3 4 LCB TTO INSP AV: 8870

RMV Land: 0 RMV Imp: 35270 RMV Total: 35270 MAV: 8870 MSAV: 0 SAV: 0

Comment: 22-23: L2, 8.8.22 TS//

Notations

update HVAC D/O

No notation data available.

OSDs

No OSD data available.

Land

No land data available.

Improvements - Residence / Manufactured Structures

Bldg: 1 Code Area: 04500 Stat Class: 443 Year Blt: 1973 Eff Year Blt: 1990 Sq.Ft: 804 % Complete: 100

Desc: MANUF STRUCT, CLASS 4, 12' WIDE SINGLE Dimensions: RMV: 35270

Func Obsc: 100 Econ %: 100 Other %: 100 Exception: 0 Adjust: Adjust RMV: 0

Floors

Type	Class	Display Group	Floor Size	Beds	Baths	Yr Blt	Eff Yr Blt	Inventory
First Floor	4	Finished	804	3	FB-1/ HB-1	1973	1990	BATH - 1, BTH - 1, KIT-, HVAC+, ROOF+, SKIRT Exception: Y N

Accessories

Description	Class	Size SqFt	Eff Yr Blt	RMV	Quantity
DECK	4	24	1990	137	0 Exception: Y N
DECK	4	64	1990	366	0 Exception: Y N
ROOF EXTENSION OR PATIO COVER	4	88	1990	664	0 Exception: Y N

Improvements - Accessory Buildings

No improvement data available for all other stat class types.

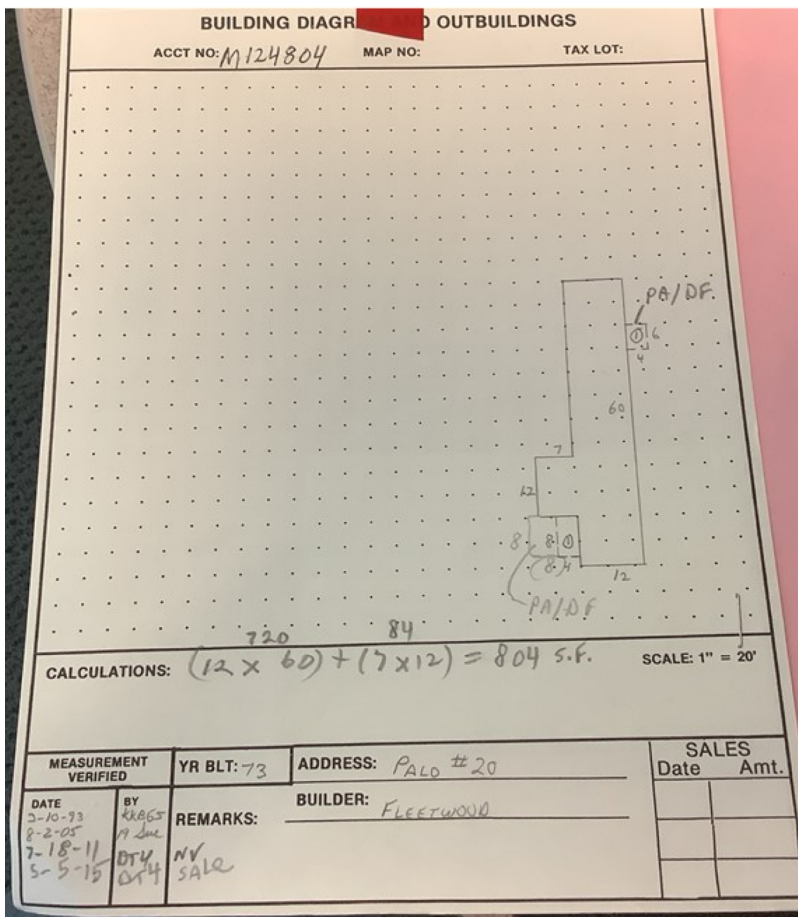

Mixed windows

SV 22-23 #2 L2 8-8-22

TTD  
MUS 787690  
P.J. ✓

# Improvement Detail

MARION County  
For Assessment Year 2022

**Account ID** 124804

<b>Map</b> 061W33A001000P1	<b>Appraiser</b> THERESA SWEARINGEN	<b>Inspected</b> 05/05/2015
<b>Mailing</b> SANCHEZ, DANIELA MCALLISTER, ALEC 1732 PINE ST # 20 SILVERTON OR 97381	<b>Appraisal Area</b> 03-05-002	
	<b>Stat Class</b> 443 - MANUF STRUCT, CLASS 4, 12' WIDE SINGLE	

**Situs** 1732 PINE ST NE #20 SILVERTON OR 97381

Bldg	Code Area	Year Built	Eff Year	Comp %	% Good	LCM	Value	RMV	Taxable		AV	Sqft	
									RMV	MAV Exception			
1	04500	1973	1990	100	26	194	Tabled	17,610	17,610	8,130	0	8,130	804

Rooms: 3 - BD, 1 - FB, 1 - HB

### Floor Segments

Description	Yr Blt	Eff Yr	% Good	Class	Comp %	OR %	Sqft	RCN
First Floor	1973	1990	26	4	100		804	57,981

### Improvement Inventory

F	Description	Qty/Size	RMV	F	Description	Qty/Size	RMV
1st	BATH - FULL	1	757	1st	HOOD & FAN	1	141
1st	BATH - HALF	1	504	1st	ROOF COVER - METAL	0	0
1st	DRYWALL	0	0	1st	SKIRTING - METAL	158	220
1st	FORCED AIR	0	0				

### Accessories

Description	Eff Yr	Size	Qty	RMV
ALUMINUM PATIO COVER	1990	88		412
WOOD DECK	1990	64		366
WOOD DECK	1990	24		137

### Totals

Description	RMV
First Floor	\$16,697
Inventory	\$0
Accessories	\$915
Trend	100.00 %
<b>Total RMV</b>	<b>\$17,610</b>

### Size Breakdown

Finished 804

**Comments** 15-16 INV UPDATE EYB// 14-15 S.V.// 11-12 CYCLE WORK 7/18/11 //06-07:RECALC SETUP; #19 8/2/05

update smv. 5/10

Input 8-16-22 mjw

input ok, closed the MJW 8-17-22

**BUILDING DIAGRAM** **OUTBUILDINGS**

ACCT NO: M124804 MAP NO: TAX LOT:

MEASUREMENT YEAR: YR. BLT: 73 ADDRESS: 9410 #20 SALES DATE Amt.

DATE: 5-5-15 BY: [signature] REMARKS: BLDG SALE

BUILDER: [signature]



*M/S*  
*New Floor*  
*Paint*  
*Pickup*  
*Windows*



M124804 061W31A 01000 Appr. Date: 5-5-15 Prop. Class: 019 Prop. Code: 143  
 Situs Address: 1732 PINE ST NE, 220 Franchise Code: 04 Year For: 2015-2016  
 Owner: HANSLER, DWIGHT W. Add'l. Sings. on bk of form

Notes: Inventory Update Cycle Sales Verification Other: Full Tag  
 RMV Imp: 3,810 RMV Total: 3,810 Mkt Total: 0

Seg. Type MA Seg. # 1.1 Method: M04 Class: 01 Area: 804 Eff. Area: 804 Length: Width: 20' 60'  
 Make: FLEETWOOD Mode: Inter. Comp: 1+1 Bedroom: 3  
 Plumbing: BATH: 5 Insulation: P/Water Roof Cover: METAL  
 Year Built: 1973 Eff. Year Built: 1973 Cond. P: F A G E  
 Adj. Codes: MSLCMS 44 % Comp: Func: Econ: RMV: 3,610  
 Lump Sum: Except Code/Year: 1973 Comments: updated carpet, recent interior window trim, sheetrocked walls

**Accessory Improvements**

Seg. Type PA Seg. # 1.3 Method: R05 Class: Area: 68 Eff. Area: 68  
 Length: Foundation: Ex. Wall: Roof Cover:  
 Roof Style: Floor: Plumbing:  
 Year Built: 1973 Eff. Year Built: 1973 Cond. P: F A G E % Comp: Econ: RMV: 110  
 Lump Sum: Except Code/Year: 1973 Comments: 4x6 porch, 6x8

**Out Buildings and Skirting**

Seg. Type MHSK Seg. # 1.2 Method: M04 Class: Area: 158 Eff. Area: 158  
 Length: Foundation: Ex. Wall: METAL: Roof Cover:  
 Roof Style: Floor: Plumbing:  
 Heat: Int. Comp. Yr. Blt: 1973 Eff. Yr. Blt: 1973  
 Cond. P: F A G E Adj. Codes: % Comp: Func: Econ: RMV: 98  
 Lump Sum: Except Code/Year: Comments:

M124804 061W31A 01000 Appr. Date: 5-5-15 Prop. Class: 019 Prop. Code: 143  
 Situs Address: 1732 PINE ST NE, 220 Franchise Code: 04 Year For: 2015-2016  
 Owner: HANSLER, DWIGHT W. Add'l. Sings. on bk of form

Notes: Inventory Update Cycle Sales Verification Other: Full Tag  
 RMV Imp: 3,810 RMV Total: 3,810 Mkt Total: 0

Segment: DF DF  
 Class: 9x8 4x6  
 Dim/Size: 9x8 4x6  
 Foundation:  
 Exter. Wall:  
 Wall Height:  
 Inter. Finish:  
 Roof Cover:  
 Roof Style:  
 Flooring:  
 Plumbing:  
 Electric:  
 Misc.:  
 Yr. Blt: 1990 1990  
 Eff. Yr: 1990 1990  
 Cond.:  
 % Good:  
 % Comp:  
 Lump Sum:  
 Except Code:

**Land Segments**

Seg. No. Description Schedule Acres Adjustment Codes: