

Acct ID: 128109 MTL: 062W17AD00200P1 Date: **6/14/24** Appr: **ZH** Prop Class: 019 RMV Prop Class: 019

Situs: 9195 PORTLAND RD NE # 12 SALEM, OR 97305 MaSaNh: 13 05 002 Unit: 141305 Year: 2024

Last Date Appraised: 08/24/2011 Appraiser: THERESA SWEARINGEN Retag: Y N Tag info:

Owner: CHAVEZ, SERVIN Roll Type: MS

cycle Tag Sales Verification Other: Inspection level: 1 2 **3** 4 LCB TTO INSP AV: 16140

RMV Land: 0 RMV Imp: 22260 RMV Total: 22260 MAV: 16140 MSAV: 0 SAV: 0

Comment: GREEN OAKS MOBILE PARK, SPACE #12, MS SERIAL # GDB01D38771274A, X # X00145943, Home ID 214221, PERSONAL MS

**NO
MLS#**

UPDATE INVENTORY + EYB w/o EXCEPTION

Notations

No notation data available.

OSDs

No OSD data available.

Land

No land data available.

Improvements - Residence / Manufactured Structures

1994 = GOMAR

Bldg: 1 Code Area: 02410 Stat Class: 454 Year Blt: 1977 Eff Year Blt: **1977** Sq.Ft: 938 % Complete: 100
Desc: MANUF STRUCT, CLASS 5, 14' WIDE SINGLE Dimensions: 67x14 RMV: 22260
Func Obsc: 100 Econ %: 100 Other %: 100 Exception: 0 Adjust: Adjust RMV: 0

Floors

Type	Class	Display Group	Floor Size	Beds	Baths	Yr Blt	Eff Yr Blt	Inventory
First Floor	5	Finished	938	2	FB-2	1977	1977	BATH - 2, KIT, WALLS +, ROOF+, SKIRT HVAC

Accessories

1994

Description	Class	Size SqFt	Eff Yr Blt	RMV	Quantity
ROOF EXTENSION OR PATIO COVER	5	256	1977	1485	0

Improvements - Accessory Buildings

No improvement data available for all other stat class types.

- CHECK HVAC
- ROOF METAL - CLEANED

NEWER

- SIDING
- WINDOWS
- EXT. PAINT

Year Built	Updated	Appraiser	Date
1977	Updated	ZH	6/17/2024

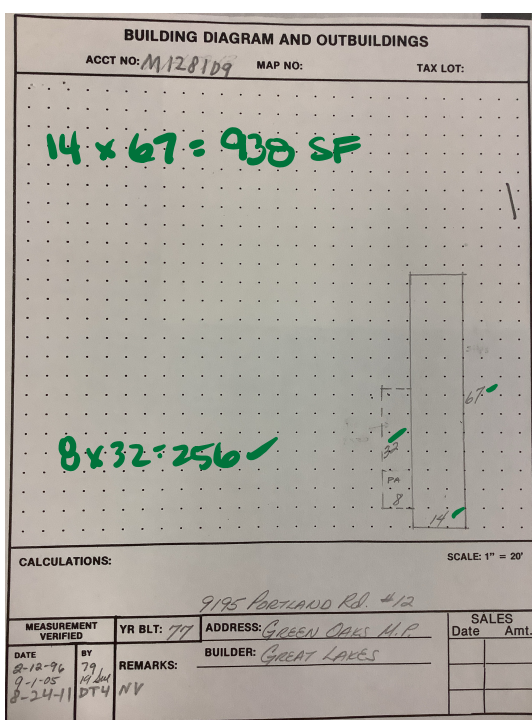

Seg.Type	MA	Seg.#	1.1	Method	M04	Class	5S	Area	938	Eff Area	938	Length	67	Width	14		
Make:	GUERDON	Model:	GREAT LAKES	Intfinish:	PANEL	Roof Cover:	METAL	Year Built:	1977	Eff. Year Built:	1977	Cond. P F A G E	% Comp	Func	Econ	RMV	5,130
Adj Codes:	MSLCMS	City:	5	% Comp	Func	Econ	RMV	5,820	MSO Total:	5,820	Notes:	spoke to owner (lady) outside					



