

LAK 8.21.24

Summary Lead Appr: \_\_\_\_\_ Clerk: \_\_\_\_\_ Lead Clerk: \_\_\_\_\_ Appr: \_\_\_\_\_ Print Date: 8/5/2024

Acct ID: 128852 MTL: 061W33A001000P1 Date: 8/13/24 Appr: 02 Prop Class: 019 RMV Prop Class: 019

Situs: 1732 PINE ST NE # 8 SILVERTON, OR 97381 MaSaNh: 12 05 002 Unit: 141615 Year: 2024

Last Date Appraised: 02/18/2022 Appraiser: THERESA SWEARINGEN Retag: Y N Tag info:

Owner: MADDEN, MICHAEL CHARLES

Roll Type: MS

Cycle Tag Sales Verification Other: \_\_\_\_\_ Inspection level: 1 2 3 4 LCB TTO INSP

AV: 23120

RMV Land: 0 RMV Imp: 92940 RMV Total: 92940 MAV: 23120 MSAV: 0

SAV: 0

Comment: 22-23: L2 2.18.22 TS

Notations

*update inv 5/0*

No notation data available.

OSDs

No OSD data available.

Land

No land data available.

Improvements - Residence / Manufactured Structures

Bldg: 1 Code Area: 04500 Stat Class: 454 Year Blt: 1979 Eff Year Blt: 2002 Sq.Ft: 924 % Complete: 100

Desc: MANUF STRUCT, CLASS 5, 14' WIDE SINGLE

Dimensions: 66x14 RMV: 92940

Func Obsc: 100 Econ %: 100 Other %: 100 Exception: 0 Adjust: Adjust RMV: 0

Floors

Type	Class	Display Group	Floor Size	Beds	Baths	Yr Blt	Eff Yr Blt	Inventory	Exception: Y N
First Floor	5	Finished	924	2	FB-2	1979	2002	BATH - 2, KIT-, HVAC, ROOF+, SKIRT	Y N

Accessories

Description	Class	Size SqFt	Eff Yr Blt	RMV	Quantity	Exception: Y N
DECK	5	<i>160</i>	2002	968	0	Y <u>N</u>
ROOF EXTENSION OR PATIO COVER	5	160	2002	2552	0	Y N

Improvements - Accessory Buildings

No improvement data available for all other stat class types.

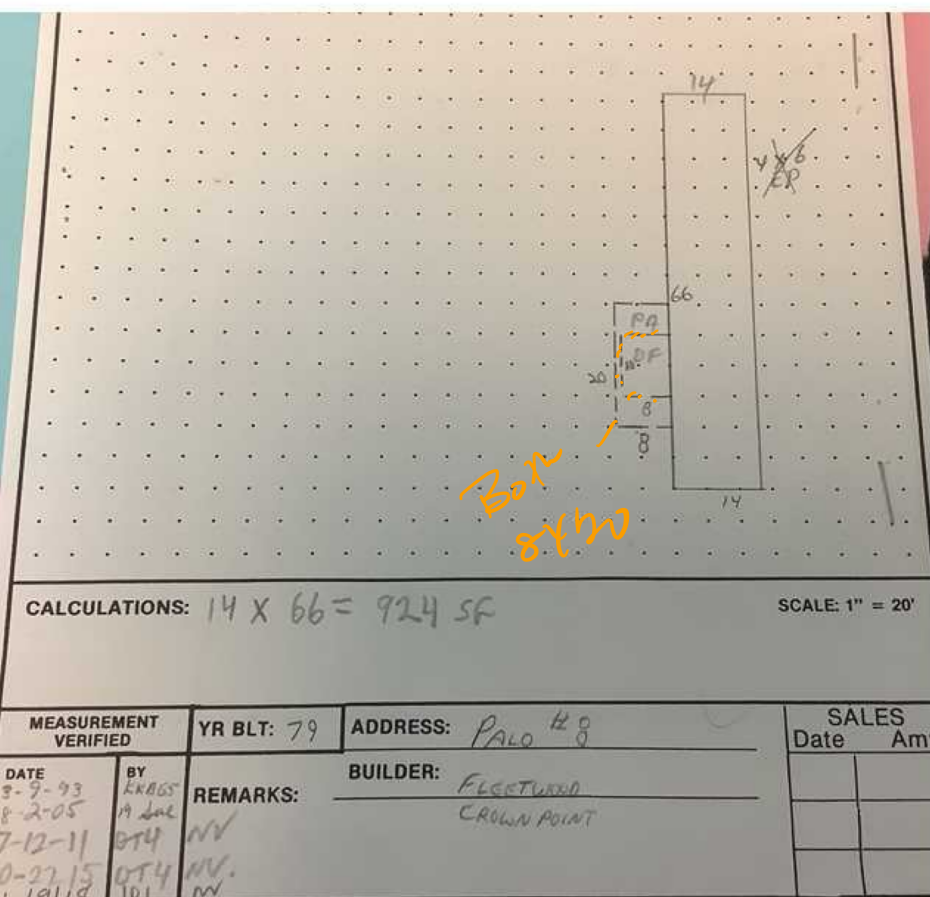

LV2

02 2-18-22

SV 22-23

MARION COUNTY ASSESSOR  
Manufactured Structure Assessment Report  
FOR ASSESSMENT YEAR 2022  
NOT OFFICIAL VALUES

1/26/2022 9:01:57 AM

Account # 128852

Code - Tax # 04500  
Mailing Address MADDEN, MICHAEL CHARLES  
1732 PINE ST #8  
SILVERTON OR 97381

TAX STATUS ASSESSABLE  
ACCT STATUS ACTIVE  
SUBTYPE PERSONAL  
HOME ID 224938  
X NUMBER X00160206

LCB  
MLS-21616633  
P.C.

SITUS ADDRESS 1732 PINE ST NE #8  
SITUS CITY SILVERTON

APPRAISER THERESA SWEARINGEN

VALUE SUMMARY

CODE AREA	RMV	MAV	AV	TREND %	RMV EXCEPTION	CPR %
04500	IMPR.	\$16,150	\$0	\$0	100%	IMPR.

Manufactured Structure Information

VIN #	WAFL1A906642736	STAT CLASS	454
BRAND	FLEETWOOD	QUALITY	100
MODEL	CROWNPOINTE	CONDITION	
YEAR BUILT	1979	MA / SA / NH	03 / 05 / 002 ✓
STICKER #		BEDROOMS / BATHS	2 / 1

Real Property Information

REAL ACCOUNT #	517008	MA / SA / NH	03 / 07 / 000
MAP	061W33A001000	PROP CLASS	707
UNIT	75110	RMV CLASS	707
PARK NAME	PALO MOBILE HOME PARK		
COMMENTS	REVIEWED 11.17.20 CF #91 // LEVEL 2 09.29.20 KB#14// 10.11.11 #29//		

FLOORS

DESCRIPTION	CLASS	SQFT	SIZE TYPE	TYPE OF HEAT	RMV
First Floor	5	924	S		15,050

DIMENSIONS: 14 X 66

INVENTORY

	Size/Qty	RMV		Size/Qty	RMV
SKIRTING - METAL	160	171	WOOD PANELING	1	0
BATH - FULL	1	582	HOOD & FAN	1	159
FORCED AIR	1	0	ROOF COVER - METAL	1	0
<b>Total Inventory RMV</b>					<b>912</b>

ACCESSORIES

DESCRIPTION	EFF YEAR BUILT	SQFT	QUANTITY	RMV
ALUMINUM PATIO COVER	1979	160		576
WOOD DECK	1979	80		352
<b>Total Accessories RMV</b>				<b>928</b>

EXEMPTIONS / SPECIAL ASSESSMENTS / POTENTIAL LIABILITY

TYPE	AMOUNT
SPECIAL ASSESSMENT(S): MFD COMMUNITIES RES CTR	\$10.00

COMMENTS: //2020-21 DELETE N/V EP, INV, 02. //18-19 TAG INV UPDATE EYB// 11-12 CYCLE WORK #4 7-12-11// 06-07:RECALC SETUP; #19 8/2/05

Send letter Ave end

# Improvement Detail

MARION County

For Assessment Year 2022

Account ID 128852

061W33A001000P1

Appraiser

THERESA SWEARINGEN

Inspected 01/09/2018

MADDEN, MICHAEL CHARLES  
1732 PINE ST #8  
SILVERTON OR 97381

Area

03-05-002

Stat Class

454 - MANUF STRUCT, CLASS 5, 14' WIDE SINGLE

Situs 1732 PINE ST NE #8 SILVERTON OR 97381

Bldg	Code	Year	Eff Yr	Comp %	% Good	LCM	Value	RMV	Taxable	MAV	Exception	AV	Sqft

Rooms: 2 - BD, 1 - FB

Description	Yr Blt	Eff Yr	% Good	Class	Comp %	OR %	Sqft	RCN
								7

Improvement Inventory		Description	Qty/Size	RMV	Description	Qty/Size	RMV
1st		FORCED AIR	924	25	SKIRTING - METAL	160	171
1st		HOOD & FAN	1	159	WOOD PANELING	0	0

Accessories		Description	Eff Yr	Size	Qty	RMV
		PATIO COVER				
		WOOD DECK	1979	80		352

Totals		Description	RMV
		Inventory	\$171
		Accessories	\$928
		Trend	100.00 %
		<b>Total RMV</b>	<b>\$16,150</b>

Size Breakdown		Finished	924
----------------	--	----------	-----

Comments //2020-21 DELETE N/V EP, INV, 02. //18-19 TAG INV UPDATE EYB// 11-12 CYCLE WORK #4 7-12-11// 06-07:RECALC SETUP; #19 8/2/05

Before to 1997  
update to 2002 - Exception  
INV & EYB

Input miw

ts 5-23-22

V. Windows  
new siding

RMCS  
new Floors  
Pictures  
new siding/windows  
Roof  
Eled FIP  
new Baths/Vanity/  
Shower  
new K cab/CT



