

Summary

Lead Appr: _____ Clerk: _____ **lak 8.21.24** Lead Clerk: _____ Appr: _____

Print Date:

8/5/2024

Acct ID: 349983

MTL: 061W33A001000P1

Date: **8/13/24** Appr: **02**

ts 8-26-24

Prop Class: 019

RMV Prop Class: 019

Situs: 1732 PINE ST NE # 26 SILVERTON, OR 97381

MaSaNh: 12 05 002

Unit: 349983

Year: 2024

Last Date Appraised: 03/26/2014 Appraiser: THERESA SWEARINGEN Retag: Y N Tag info:

Owner: ARBUCKLE, DAWN

Roll Type: MS

Cycle Tag Sales Verification Other: _____ Inspection level: 1 2 **3** 4 LCB TTO INSP

AV: 21210

RMV Land: 0 RMV Imp: 40760 RMV Total: 40760 MAV: 21210 MSAV: 0

SAV: 0

Comment: PALO MOBILE HOME PARK, SPACE #26, MS SERIAL # 11811946AB, Home ID 109836, PERSONAL MS

Notations

No notation data available.

update EFB F/D

OSDs

No OSD data available.

Land

No land data available.

Improvements - Residence / Manufactured Structures

Bldg: 1 Code Area: 04500 Stat Class: 457 Year Blt: 1985 Eff Year Blt: 1985 Sq.Ft: 1404 % Complete: 100

Desc: MANUF STRUCT, CLASS 5, 26' THROUGH 28' WIDE DOUBLE

Dimensions: 27x52 RMV: 40760

Func Obsc: 100

Econ %: 100

Other %: 100

Exception: 0

Adjust:

Adjust RMV: 0

Floors

Type	Class	Display Group	Floor Size	Beds	Baths	Yr Blt	Eff Yr Blt	Inventory	Exception: Y N
First Floor	5	Finished	1404	3	FB-2	1985	1985	BATH - 2, KIT-, HVAC+, ROOF+, SKIRT	N

1990

Accessories

Description	Class	Size SqFt	Eff Yr Blt	RMV	Quantity
No accessory data available					

Improvements - Accessory Buildings

No improvement data available for all other stat class types.



V. Wind.



BUILDING DIAGRAM AND OUTBUILDINGS

ACCT NO: M349983 MAP NO: 061W33A TAX LOT: 01000

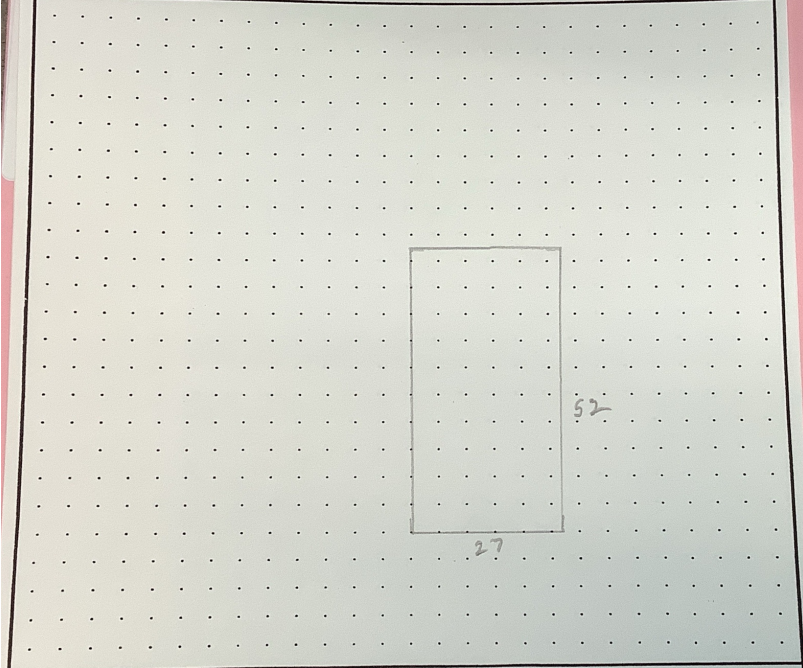

CALCULATIONS: 27 X 52 = 1404 SF. SCALE: 1" = 20'

Palo mobile Home PK.

MEASUREMENT VERIFIED	YR BLT: <u>'85</u>	ADDRESS: <u>1732 Pine (26</u>
DATE <u>3-26-14</u> BY <u>OT4</u>	REMARKS:	BUILDER: <u>Redman Granu</u>

ID# <u>M349983</u> MTL <u>061W33A</u> 01000 Pull TAG BRAND <u>Redman Granville</u> APP# <u>014</u> DATE <u>3-26-14</u>	PROP CLASS <u>019</u> PROP CODE <u>157</u> SITUS <u>1732 Pine St. NE #26</u> <u>Palo MHP - pic (grn 100%)</u>				
Segment <u>MA</u> Class <u>5D</u> Area <u>1404</u> Dimensions <u>27 X 52</u> Deduct _____ Inter Finish panel (<u>gypsum</u>) drywt Roof Cover arcmp bltup comp i/shake metal roll shake t/clay t/conc wood	Segment _____ Class _____ Area _____ Roof Cover arcmp bltup comp i/shake metal roll shake t/clay t/conc wood				
Plumbing <u>BA733</u> Heat AC BB Ceilg FA H-wtr HP SC ST Zonal	Plumbing _____ Heat AC BB Ceilg FA H-wtr HP SC S Zonal				
Fireplace Dbl e/p Encl e/p Hrth e/p Prefb e/p Sgl e/p Zerocl	Fireplace Dbl e/p Encl e/p Hrth e/p Prefb e/p Sgl e/p Zerocl				
Inter Comp Cktp e/p Dsp DW H&F Micro Rng Oven d/s Trash	Inter Comp Cktp e/p Dsp DW H&F Micro Rng Oven d/s Trash				
Bedrooms <u>3</u> Yr blt <u>1985</u> Eff yr <u>1985</u> Condition P F A G E %Good _____ Qty <u>5</u> %Comp <u>100</u> Func _____ Econ _____ Except Code <u>NMSP</u> Lump Sum _____ Comments <u>w/ app gypsum walls</u>	Bedrooms _____ Yr blt _____ Eff yr _____ Condition P F A G E %Good _____ Qty _____ %Comp _____ Func _____ Econ _____ Except Code _____ Lump Sum _____ Comments _____				
Segment <u>MHSK</u> Class _____ Lin Ft <u>158</u> Exter Wall metal wood (<u>vinyl</u>) fbrgl cblock brick	Segment _____ Class _____ Area _____ Roof Cover arcmp bltup comp i/shake metal roll shake t/clay t/conc wood				
Yr blt <u>2013</u> Eff yr <u>1985</u> Condition P F A G E %Good _____ Qty _____ %Comp <u>100</u> Func _____ Econ _____ Except Code <u>NMSP</u> Lump Sum _____ Comments <u>updated carpets - some maintenance \$21,000 - purchase price</u>	Plumbing _____ Heat AC BB Ceilg FA H-wtr HP SC S Zonal				
	Fireplace Dbl e/p Encl e/p Hrth e/p Prefb e/p Sgl e/p Zerocl				
	Inter Comp Cktp e/p Dsp DW H&F Micro Rng Oven d/s Trash				
	Bedrooms _____ Yr blt _____ Eff yr _____ Condition P F A G E %Good _____ Qty _____ %Comp _____ Func _____ Econ _____ Except Code _____ Lump Sum _____ Comments _____				
Segment					
Class					
Dim./Size					
Foundation					
Exter Wall					