

SKETCH/AREA TABLE ADDENDUM

SUBJECT INFO

File No.: 320698 Parcel No.: 092E15BB00404
 Property Address: 11075 MOBLEY LN SE
 City: Salem County: Marion State: OR ZipCode: 97358
 Owner:
 Client: Client Address:
 Appraiser Name: Inspection Date:

SKETCH

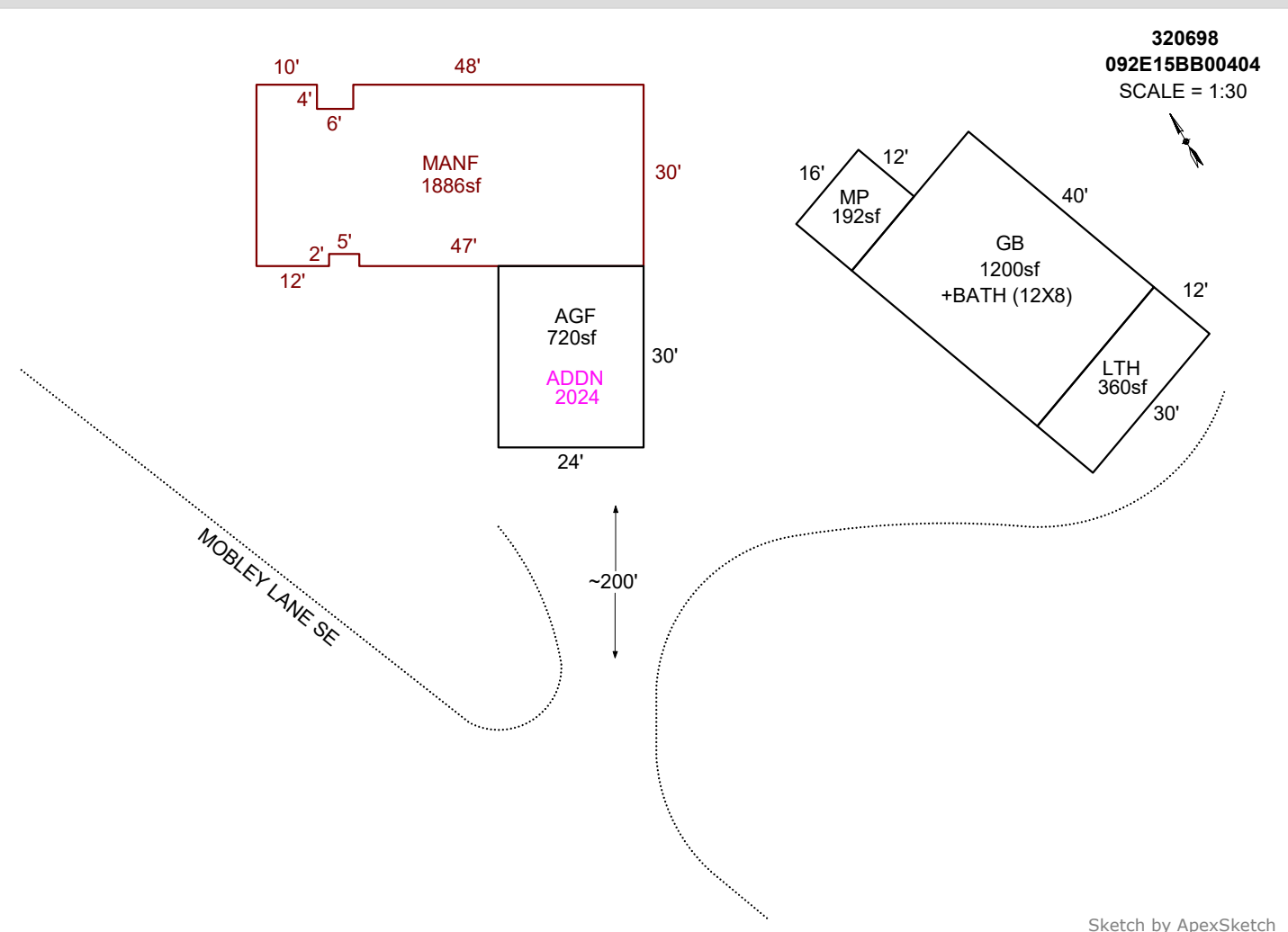

AREA CALCULATIONS SUMMARY

Code	Description	Factor	Net Size	Perimeter	Net Totals
GBA1	GB	1.0	1200.0	140.0	
	LTH	1.0	360.0	84.0	
	MP	1.0	192.0	56.0	1752.0
GLA	MANF	1.0	1886.0	200.0	1886.0
GAR	AGF	1.0	720.0	108.0	720.0
	Net LIVABLE	cnt	1 (rounded)		1,886
	Net BUILDING	cnt	3 (rounded)		1,752

COMMENT TABLE 1

DRAWN BY JRONDEMA 5/11/15
 UPDATED BY JRONDEMA 3/29/19
 UPDATED BY CJURAN 06/29/2021
 UPDATED BY CJURAN 12/08/2021 555-21-009623
 UPDATED BY CJURAN 03/08/2022 555-22-000285
 UPDATED BY CJURAN 05/11/2022 555-22-000285 REV1
 UPDATED BY CJURAN 07/17/2023 555-22-000285 REV2
 UPDATED BY CJURAN 11/27/2023
 UPDATED BY CLOBERG 09/13/24 24-004465 ADDN AGF

COMMENT TABLE 2

#36 DB 9.21.17
 WV #06 04/14/2021 AOG
 CL 10/26/2023

COMMENT TABLE 3

TAGS L2