

SKETCH/AREA TABLE ADDENDUM

SUBJECT INFO

File No.: 320444 Parcel No.: 083W23A000600
 Property Address: 2155 ROBINS LN SE #31
 City: SALEM County: State: OR ZipCode: 97306
 Owner:
 Client: Client Address:
 Appraiser Name: Inspection Date:

SKETCH

320444
083W23A000600

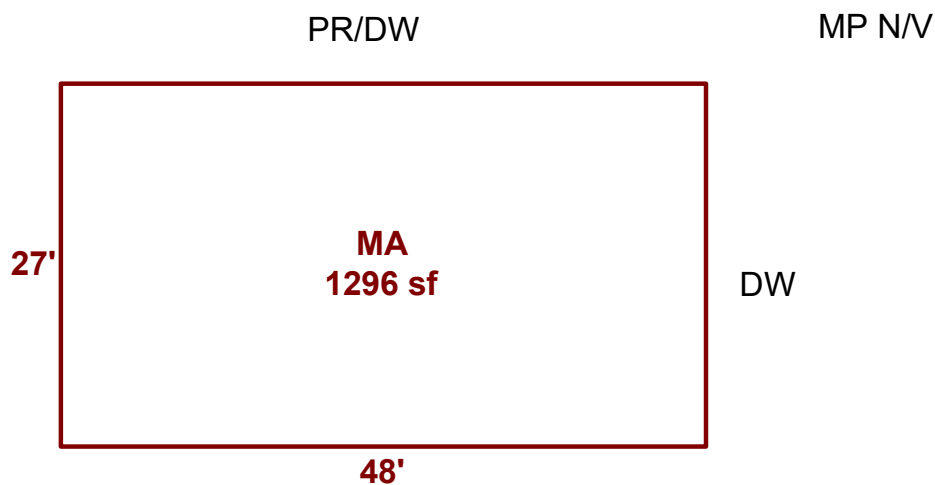

Sketch by ApexSketch

AREA CALCULATIONS SUMMARY						COMMENT TABLE 1	
Code	Description	Factor	Net Size	Perimeter	Net Totals	DRAWN BY LK 10.4.24	
MFH	MA	1.0	1296.0	150.0	1296.0		
						COMMENT TABLE 2	COMMENT TABLE 3
						10.1.24 CYCLE TS	
Net LIVABLE		cnt	1	(rounded)	1,296		