

SKETCH/AREA TABLE ADDENDUM

SUBJECT INFO

File No.: 320446 Parcel No.: 083W23A000600
 Property Address: 2155 ROBINS LN SE #9
 City: SALEM County: State: OR ZipCode: 97306
 Owner:
 Client: Client Address:
 Appraiser Name: Inspection Date:

SKETCH

320446
083W23A000600

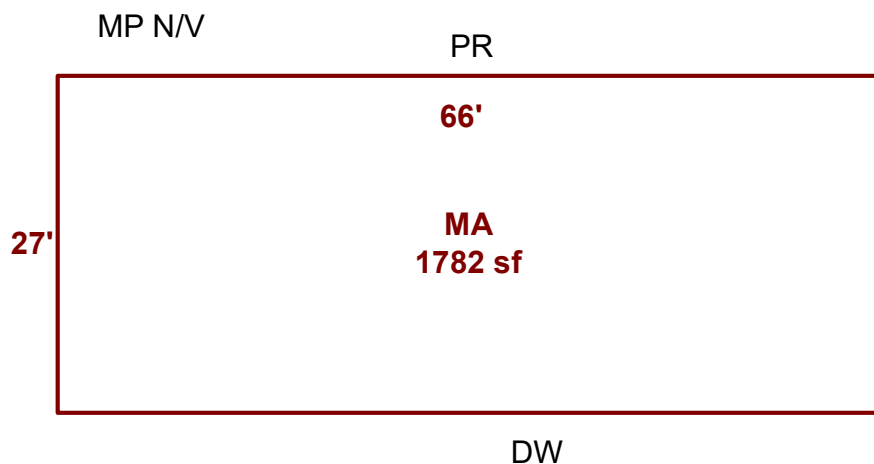

Sketch by ApexSketch

AREA CALCULATIONS SUMMARY						COMMENT TABLE 1	
Code	Description	Factor	Net Size	Perimeter	Net Totals		
MFH	MA	1.0	1782.0	186.0	1782.0		
						COMMENT TABLE 2	COMMENT TABLE 3
	Net LIVABLE	cnt	1 (rounded)		1,782		