

SKETCH/AREA TABLE ADDENDUM

SUBJECT INFO

File No.: 320473 Parcel No.: 083W23A000600
 Property Address: 2155 ROBINS LN SE #17
 City: SALEM County: State: OR ZipCode: 97306
 Owner:
 Client: Client Address:
 Appraiser Name: Inspection Date:

SKETCH

320473

083W23A000600

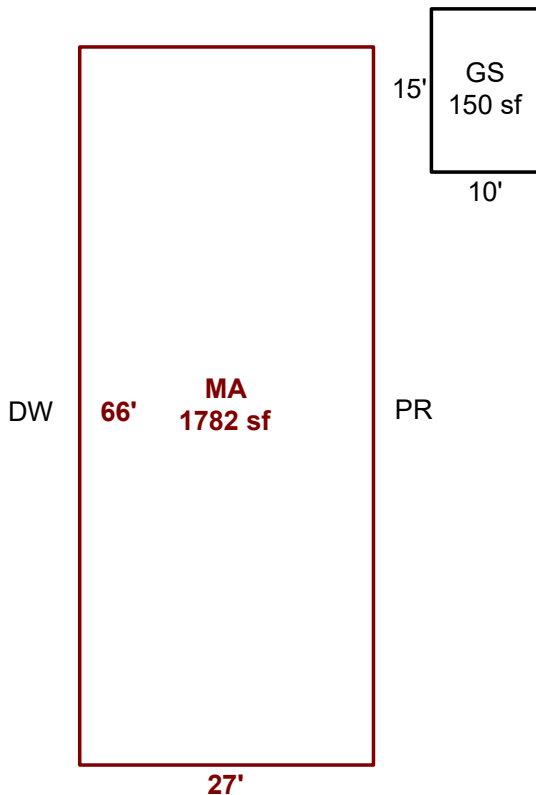

Sketch by ApexSketch

AREA CALCULATIONS SUMMARY

Code	Description	Factor	Net Size	Perimeter	Net Totals
GBA	GS	1.0	150.0	50.0	150.0
MFH	MA	1.0	1782.0	186.0	1782.0

COMMENT TABLE 1

DRAWN BY LK 10.7.24

COMMENT TABLE 2

10.1.24 CYCLE TS

COMMENT TABLE 3

Net LIVABLE	cnt	1	(rounded)		1,782
Net BUILDING	cnt	1	(rounded)		150