

# SKETCH/AREA TABLE ADDENDUM

## SUBJECT INFO

File No.: 320475 Parcel No.: 083W23A000600  
 Property Address: 2155 ROBINS LN SE #45  
 City: SALEM County: State: OR ZipCode: 97306  
 Owner:  
 Client: Client Address:  
 Appraiser Name: Inspection Date:

## SKETCH

**320475**  
**083W23A000600**

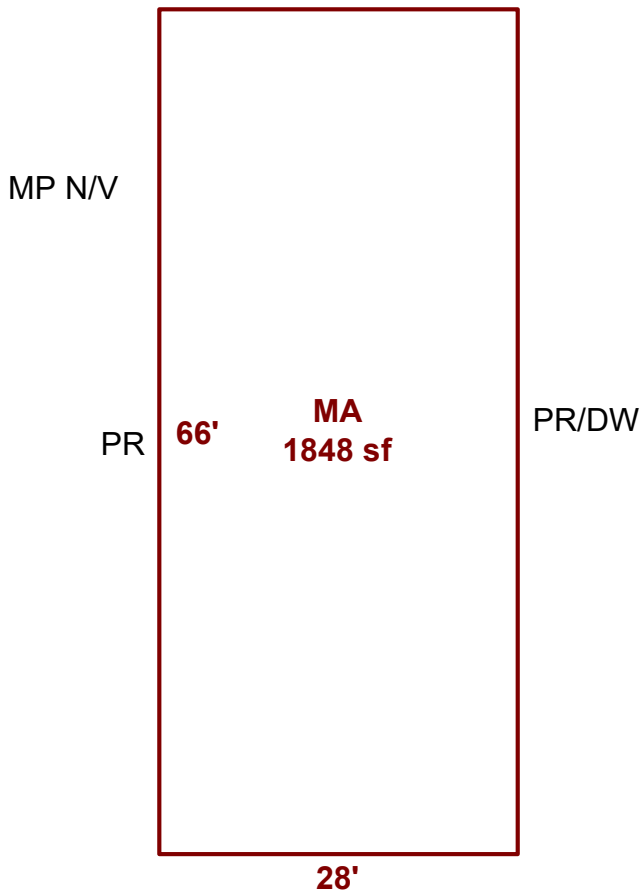

Sketch by ApexSketch

AREA CALCULATIONS SUMMARY						COMMENT TABLE 1	
Code	Description	Factor	Net Size	Perimeter	Net Totals		
MFH	MA	1.0	1848.0	188.0	1848.0	DRAWN BY LK 10.7.24	
						COMMENT TABLE 2	COMMENT TABLE 3
						10.1.24 CYCLE TS	
Net LIVABLE		cnt	1	(rounded)	1,848		