

Acct ID: 321648 MTL: 093W060000201 Date: **9-11-24** Appr: **WW** Prop Class: 551 RMV Prop Class: 551
 Situs: 3335 RIVERSIDE RD S SALEM OR 97306 MaSaNh: 06 06 000 Unit: 35027 Year: 2024

Last Date Appraised: 12/14/2022 Appraiser: WENDY WILLIAMS Retag: Y N Tag info:

Owner: JORDAN, PAUL C & JORDAN, PATRICIA K Roll Type: R

Cycle Tag Sales Verification Other: _____ Inspection level: 1 2 **3** 4 LCB TTO INSP AV: 253100

RMV Land: 603810 RMV Imp: 435480 RMV Total: 1039290 MAV: 232560 MSAV: 29468 SAV: 57057

Comment: 23-24: L3 12.14.22 MDL LEVEL 2 4.27.21 CL10

should be DFL since 21

update inv, addn to go

Notations

RP/MS	Code	Description
RP	411	SEE ACCOUNT NOTES - 411
RP	ZONED	FARM EFU ZONED

approval letter on file (2021) for 17.28 DFL 5.18 farm 1.0 homesite

OSDs **Chris 10/17/24**

Count	Code	Description	RMV	Code Area	Exception
1	SAA	SA OSD - AVERAGE	45000	14530	0

9-11-24 Spw CWO regarding missed dfl

Land **CWO DID ROLL CORR AND UPD SOILS 9/30/24 - 10/9/24**

Site: 1 Code Area: 14530 Size: 1.00 Acres Use Code: 005 Zone: REST SAV Use: 011 Exception: 0
 Class: Value Source: Farm Homesite Description: RMV: 23790 Exception: Y N
 Adjustment(s): GSOIL, FSOIL Fire Patrol: Description:
 Comments: Liability year - 2009 / 21-22: PER #10 CHG SOIL CLASSES / 03-04: REAPPRAISAL

Site: 2 Code Area: 14530 Size: 5.10 Acres Use Code: 005 Zone: REST SAV Use: 011 Exception: 0
 Class: 2BDS Value Source: Farm Use - EFU Description: TWO BENCH DRY SOUTH SPECIAL RMV: 133470 Exception: Y N
 S
 Adjustment(s): GSOIL, FSOIL Fire Patrol: Description:
 Comments: Liability year - 1982 / 81400130 //08-09: 8BENCH PROJECT - CHG OF 8BENCH TO 4BENCH AND MOVE 5 ACRES TO 6BENCH AND CORRECT ACREAGE OF 2BENCH AND CHG WOODLOT TO WOOD-M//

Site: 3 Code Area: 14530 Size: 3.90 Acres Use Code: 005 Zone: REST SAV Use: 011 Exception: 0
 Class: 4HD Value Source: Farm Use - EFU Description: FOUR HILL DRY RMV: 92790 Exception: Y N
 Adjustment(s): GSOIL, FSOIL Fire Patrol: Description:
 Comments: Liability year - 1982 / 81400130 / 01-02: COMBINED LAND SEGS - SAME SOIL CLASS, SAME LIAB YR, 14.0 TTL ACRES //05-06: PER #13, CHG OF SOIL CLASS FROM 8BENCH TO WOODLOT

Site: 4 Code Area: 14530 Size: 3.80 Acres Use Code: 005 Zone: REST SAV Use: 011 Exception: 0
 Class: WOOD Value Source: Woodlot Description: FARM WOODLOT RMV: 90410 Exception: Y N
 D
 Adjustment(s): GSOIL, FSOIL Fire Patrol: Description:
 Comments: Liability year - 1982 //08-09: Market woodlot study by GW39 - change from woodlot to woodlot-M// 81400130 / 01-02: COMBINED LAND SEGS - SAME SOIL CLASS, SAME LIAB YR, 14.0 TTL ACRES

Site: 5 Code Area: 14530 Size: 8.96 Acres Use Code: 005 Zone: REST SAV Use: 011 Exception: 0
 Class: 6H Value Source: Farm Use - EFU Description: SIX HILL RMV: 202520 Exception: Y N
 Adjustment(s): GSOIL, FSOIL Fire Patrol: Description:
 Comments: Liability year - 1982 / 81400130 / 01-02: COMBINED LAND SEGS - SAME SOIL CLASS, SAME LIAB YR, 14.0 TTL ACRES

Site: 7 Code Area: 14530 Size: 0.70 Acres Use Code: 005 Zone: REST SAV Use: 011 Exception: 0
 Class: Water Value Source: Pond Description: Ponds, rivers, creeks, streams, lakes RMV: 15830 Exception: Y N
 Adjustment(s): GSOIL, FSOIL Fire Patrol: Description:
 Comments: Liability year - 1982

Improvements - Residence / Manufactured Structures

Bldg: 1 Code Area: 14530 Stat Class: 142 Year Blt: 1921 Eff Year Blt: 1987 Sq.Ft: 2876 % Complete: 100
 Desc: Multi Story above grade Dimensions: RMV: 386080
 Func Obsc: 100 Econ %: 100 Other %: 100 Exception: 0 Adjust: Adjust RMV: 0

Floors

Type	Class	Display Group	Floor Size	Beds	Baths	Yr Blt	Eff Yr Blt	Inventory	Exception:
First Floor	4	Finished	1438	2	FB-1	1921	1987	BATH - 1, ROOF, HVAC, FP - 1, KIT-	Y N
Second Floor	4	Finished	1438	1	FB-1	2019	2019	HVAC, ROOF, BATH - 1	Y N
Garage Attached	4	Low Cost	624	0	0	1921	1987	ROOF	Y N

Accessories

overall exp per calc after addn 2005/10

Y14G

Description	Class	Size SqFt	Eff Yr Blt	RMV	Quantity	Exception: Y N
DECK	4	120	2019	2587	1	Exception: Y N
DECK	4	461	2019	9939	1	Exception: Y N
ROOF EXTENSION OR PATIO COVER	4	120	2019	3410	1	Exception: Y N
ROOF EXTENSION OR PATIO COVER	4	461	2019	13102	1	Exception: Y N

Improvements - Accessory Buildings

Bldg: 2 Code Area: 14530 Stat Class: 351 Year Blt: 1979 Eff Year Blt: 1979 Sq.Ft: 2940 % Complete: 100
 Desc: General Purpose Building (GB) *31a* Dimensions: 70x42 RMV: 8360
 Func Obsc: 100 Econ %: 100 Other %: 100 Exception: 0 Adjust: Adjust RMV: 0

Floors LEAVE AS GB - LOFT N/V

Type	Class	Display Group	Floor Size	Beds	Baths	Yr Blt	Eff Yr Blt	Inventory	Exception: Y N
General Purpose Bldg <i>LB</i>	4	Finished	2940	0	0	1979	1979	FAIR	Exception: Y <i>N</i>

Accessories

Description Class Size SqFt Eff Yr Blt RMV Quantity
 No accessory data available

Bldg: 3 Code Area: 14530 Stat Class: 351 Year Blt: 2002 Eff Year Blt: 2002 Sq.Ft: 3644 % Complete: 100
 Desc: General Purpose Building (GB) *2005* Dimensions: 50x70 RMV: 32360
 Func Obsc: 100 Econ %: 100 Other %: 100 Exception: 0 Adjust: Adjust RMV: 0

Type	Class	Display Group	Floor Size	Beds	Baths	Yr Blt	Eff Yr Blt	Inventory	Exception: Y N
General Purpose Bldg	4	Finished	3500	0	FB-1	2002	2002	FAIR, BATH - 1 <i>ext paint</i>	Exception: Y N
Finished Office	4	Finished	144	0	0	2002	2002		Exception: Y N

Accessories

Description Class Size SqFt Eff Yr Blt RMV Quantity
 No accessory data available

Bldg: 4 Code Area: 14530 Stat Class: 354 Year Blt: 2002 Eff Year Blt: 2002 Sq.Ft: 840 % Complete: 100
 Desc: Lean-to Light (LTL) *LTH* Dimensions: 12x70 RMV: 1970
 Func Obsc: 100 Econ %: 100 Other %: 100 Exception: 0 Adjust: Adjust RMV: 0

Type	Class	Display Group	Floor Size	Beds	Baths	Yr Blt	Eff Yr Blt	Inventory	Exception: Y N
Lean-to Light Duty	4	Finished	840	0	0	2002	2002		Exception: Y N

Accessories

Description Class Size SqFt Eff Yr Blt RMV Quantity
 No accessory data available

Bldg: 5 Code Area: 14530 Stat Class: 341 Year Blt: 1985 Eff Year Blt: 1985 Sq.Ft: 140 % Complete: 100
 Desc: Multi Purpose Shed (MP) Dimensions: 10x14 *172* RMV: 710
 Func Obsc: 100 Econ %: 100 Other %: 100 Exception: 0 Adjust: Adjust RMV: 0

Type	Class	Display Group	Floor Size	Beds	Baths	Yr Blt	Eff Yr Blt	Inventory	Exception: Y N
Multi-Purpose Bldg	4	Finished	140	0	0	1985	1985	AVG <i>ON MA</i>	Exception: Y <i>N</i>

Accessories

Description Class Size SqFt Eff Yr Blt RMV Quantity
 No accessory data available

Bldg: 6 Code Area: 14530 Stat Class: 905 Year Blt: 2022 Eff Year Blt: 2022 Sq.Ft: 0 % Complete: 100
 Desc: Rural Solar Panel/Array Dimensions: RMV: 6000
 Func Obsc: 100 Econ %: 100 Other %: 100 Exception: 0 Adjust: Adjust RMV: 0

Type	Class	Display Group	Floor Size	Beds	Baths	Yr Blt	Eff Yr Blt	Inventory
No floor data available								

Accessories

Description Class Size SqFt Eff Yr Blt RMV Quantity
 No accessory data available



SKETCH/AREA TABLE ADDENDUM

SUBJECT INFO

File No.: 321648 Parcel No.: 093W06 00201
 Property Address: 3335 RIVERSIDE RD S
 City: SALEM County: Marion State: OR ZipCode:
 Owner:
 Client: Client Address:
 Appraiser Name: Morrie Efseaff Inspection Date: 2012

SKETCH

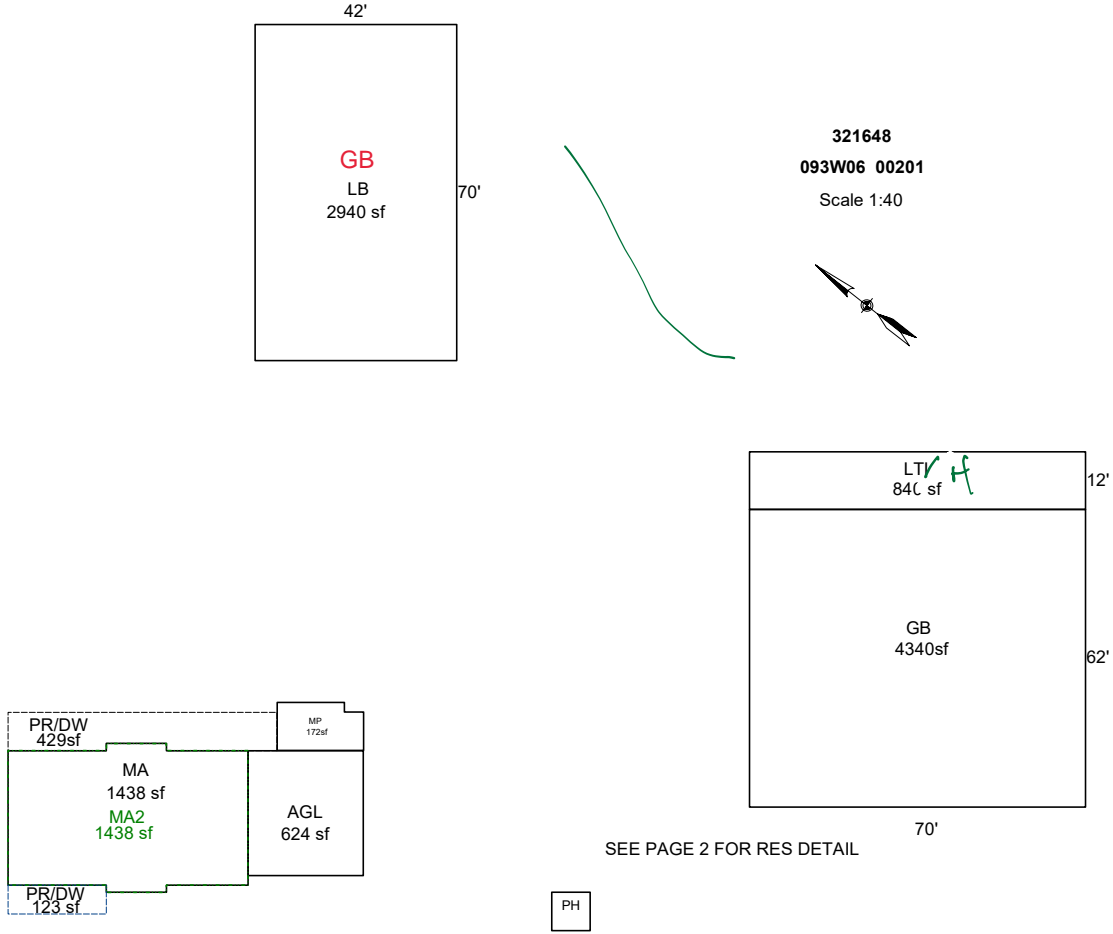

AREA CALCULATIONS SUMMARY

Code	Description	Factor	Net Size	Perimeter	Net Totals
GBA1	LB	1.0	2940.0	224.0	
	GB	1.0	4340.0	264.0	
	LTL	1.0	840.0	164.0	8120.0
GBA3	MP	1.0	172.0	56.0	172.0
GLA1	MA	1.0	1437.5	162.0	1437.5
GLA2	MA2	1.0	1437.5	162.0	1437.5
YI1	PR/DW	1.0	123.0	53.0	
	PR/DW	1.0	429.3	131.0	552.3
	Net LIVABLE	cnt	2 (rounded)		2,875
	Net BUILDING	cnt	4 (rounded)		8,292

COMMENT TABLE 1

APEX by AC 11/20/12
 UPD BY PH 02.26.20 ADDN-REM0D/18-003736
 UPD BY WW 5.1.24

COMMENT TABLE 2

COMMENT TABLE 3

SKETCH/AREA TABLE ADDENDUM

SUBJECT INFO

File No.: 321648 Parcel No.: 093W06 00201
 Property Address: 3335 RIVERSIDE RD S
 City: SALEM County: Marion State: OR ZipCode:
 Owner:
 Client: Client Address:
 Appraiser Name: Morrie Efeaff Inspection Date: 2012

SKETCH

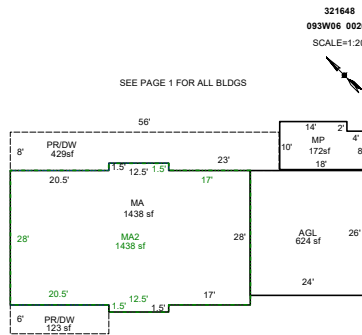

Sketch by ApexSketch

AREA CALCULATIONS SUMMARY

Code	Description	Factor	Net Size	Perimeter	Net Totals
GBA3	MP	1.0	172.0	56.0	172.0
GLA1	MA	1.0	1437.5	162.0	1437.5
GLA2	MA2	1.0	1437.5	162.0	1437.5
YI1	PR/DW	1.0	123.0	53.0	
	PR/DW	1.0	429.3	131.0	552.3

COMMENT TABLE 1

APEX by AC 11/20/12
 UPD BY PH 02.26.20 ADDN-REMOD/18-003736
 UPD BY WW 5.1.24

COMMENT TABLE 2

COMMENT TABLE 3

L2 apex
 WW
 9-10-24

Net LIVABLE	cnt	2	(rounded)	2,875
Net BUILDING	cnt	1	(rounded)	172

