

SKETCH/AREA TABLE ADDENDUM

SUBJECT INFO

File No.: 321174 Parcel No.: 082W01B 00401
 Property Address: 8570 MCCAMMON LN SE
 City: Salem County: State: OR ZipCode: 97317
 Owner:
 Client: Client Address:
 Appraiser Name: Inspection Date:

SKETCH

321174
082W01B 00401
SCALE=1:30

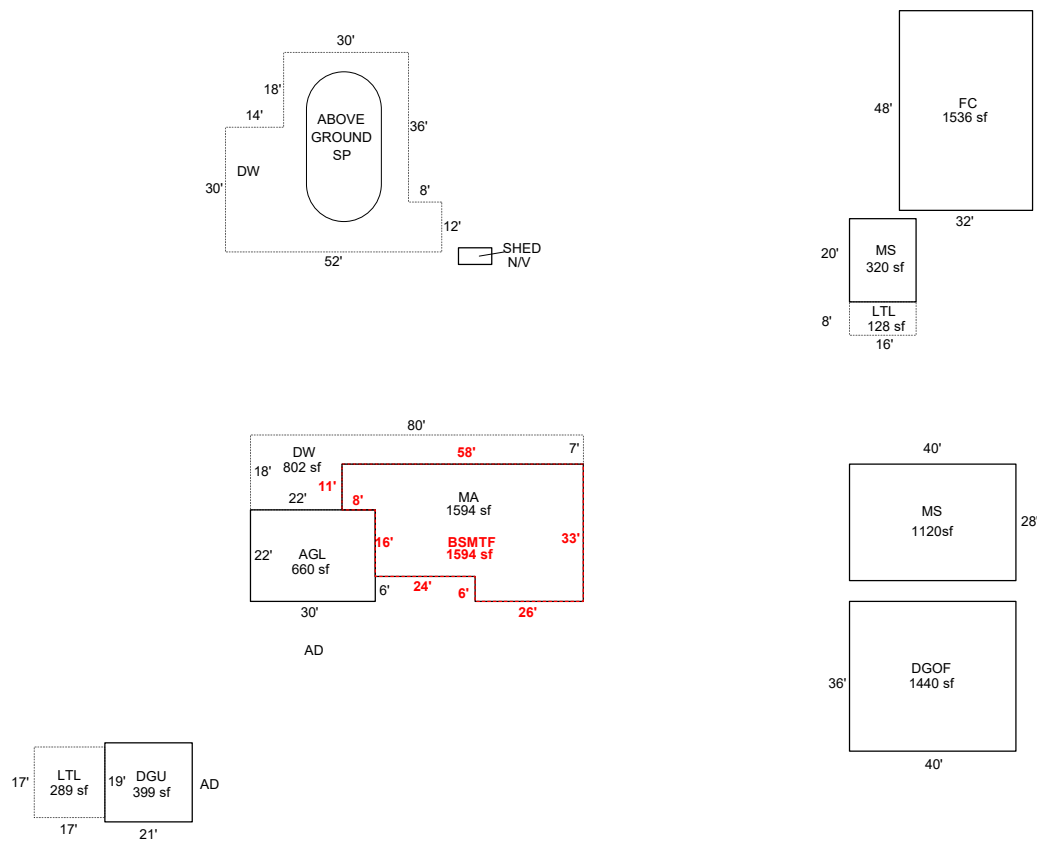

Sketch by ApexSketch

AREA CALCULATIONS SUMMARY						COMMENT TABLE 1					
Code	Description	Factor	Net Size	Perimeter	Net Totals						
GBA1	LTL	1.0	128.0	48.0		APEXED BY NRC 05/27/2009 UPDATED BY JRONDEMA 11/1/16 UPDATED BY CLOBERG 10/30/24					
	LTL	1.0	289.0	68.0							
	FC	1.0	1536.0	160.0							
GLA0	MS	1.0	1120.0	136.0	3073.0						
	BSMTF	1.0	1594.0	182.0	1594.0						
GLA1	MA	1.0	1594.0	182.0							
	MS	1.0	320.0	72.0	1914.0						
GAR	AGL	1.0	660.0	104.0							
	DGU	1.0	399.0	80.0							
	DGOF	1.0	1440.0	152.0	2499.0						
OTH	SP	1.0	578.5	92.5	578.5	<table border="1" style="width: 100%; border-collapse: collapse;"> <tr> <th style="width: 50%;">COMMENT TABLE 2</th> <th style="width: 50%;">COMMENT TABLE 3</th> </tr> <tr> <td>9/16/16 SR 94 CYCLE NV CLUKE 09/25/24</td> <td>TAGS SOLAR L4</td> </tr> </table>		COMMENT TABLE 2	COMMENT TABLE 3	9/16/16 SR 94 CYCLE NV CLUKE 09/25/24	TAGS SOLAR L4
COMMENT TABLE 2	COMMENT TABLE 3										
9/16/16 SR 94 CYCLE NV CLUKE 09/25/24	TAGS SOLAR L4										
P/P	DW	1.0	802.0	196.0	802.0						
	Net LIVABLE	cnt	2 (rounded)		3,508						
	Net BUILDING	cnt	4 (rounded)		3,073						