

Acct ID: 126314 MTL: 083W22DA01400P1 Date: **9/10/24** Appr: **AG** Prop Class: 019 RMV Prop Class: 019

Situs: 1207 NEWPORT DR SE SALEM, OR 97306 MaSaNh: 16 00 000 Unit: 140684 Year: 2024 **1/25**

Last Date Appraised: 05/15/2017 Appraiser: STEPHANIE HATFIELD Retag: Y N Tag info:

Owner: CAREY, GILBERT & CAREY, HANNAH Roll Type: MS

Cycle Tag Sales Verification Other: _____ Inspection level: 1 2 **3** 4 LCB TTO INSP AV: 2690

RMV Land: 0 RMV Imp: 12200 RMV Total: 12200 MAV: 2690 MSAV: 0 SAV: 0

Comment: MFD STRUCT SERIAL # 55APXDK023S2567, X # X00116694 ON REAL ACCT 083W22DA01400, PERSONAL MS

N/C

Notations

No notation data available.

OSDs

No OSD data available.

Land

No land data available.

ms is not showing up on land account. Maybe not linked properly?

Improvements - Residence / Manufactured Structures

Bldg: 1 Code Area: 24430 Stat Class: 452 Year Blt: 1960 Eff Year Blt: 1960 Sq.Ft: 510 % Complete: 100

Desc: MANUF STRUCT, CLASS 5, 10' WIDE SINGLE Dimensions: 51x10 RMV: 12200

Func Obsc: 100 Econ %: 100 Other %: 100 Exception: 0 Adjust: Adjust RMV: 0

Floors

Type	Class	Display Group	Floor Size	Beds	Baths	Yr Blt	Eff Yr Blt	Inventory	Exception: Y N
First Floor	5	Finished	510	1	FB-1	1960	1960	BATH - 1, KIT-, HVAC+, ROOF+, SKIRT	Y N

Accessories

Description Class Size SqFt Eff Yr Blt RMV Quantity

No accessory data available

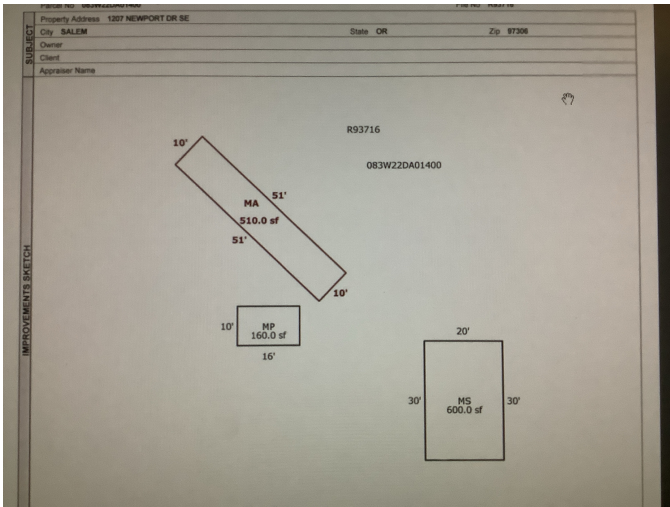

**Ufd on aerials
all imp's look in poor condition**