

Acct ID: 128591 MTL: 083W24B002500P1 Date: 9/30/24 Appr: SA Prop Class: 019

RMV Prop Class: 019

Situs: 2528 ROBINS LN SE SALEM, OR 97306

MaSaNh: 17 00 000

Unit: 141515

Year: 2024

2025

Last Date Appraised: 06/16/2020

Appraiser: GREG MARKLEY

Retag: Y N

Tag info:

Owner: EVARTS, DAVID W & EVARTS, LIDDY

Roll Type: MS

Cycle Tag Sales Verification Other: _____ Inspection level: 1 2 3 4 LCB TTO INSP

AV: 32290

RMV Land: 0 RMV Imp: 32290 RMV Total: 32290 MAV: 46180 MSAV: 0

SAV: 0 X

Comment: MFD STRUCT SERIAL # 09L12308XU, X # X00154537 ON REAL ACCT 083W24B 02500, PERSONAL MS

N/C

Notations

No notation data available.

OSDs

No OSD data available.

Land

No land data available.

Improvements - Residence / Manufactured Structures

Bldg: 1 Code Area: 24430 Stat Class: 446 Year Blt: 1978 Eff Year Blt: 1988 Sq.Ft: 1152 % Complete: 100

Desc: MANUF STRUCT, CLASS 4 24' WIDE DOUBLE

Dimensions: 48x24

RMV: 32290

Func Obsc: 100

Econ %: 100

Other %: 100

Exception: 0

Adjust:

Adjust RMV: 0

Floors

Type	Class	Display Group	Floor Size	Beds	Baths	Yr Blt	Eff Yr Blt	Inventory	Exception: Y N
First Floor	4	Finished	1152	3	FB-2	1978	1988	BATH - 2, KIT-, HVAC+, ROOF+, SKRT+	Y N

Accessories

Description	Class	Size SqFt	Eff Yr Blt	RMV	Quantity	Exception: Y N
DECK	4	243	1988	1230	0	Y N
DECK	4	434	1988	2196	0	Y N
ROOF EXTENSION OR PATIO COVER	4	243	1988	1621	0	Y N
ROOF EXTENSION OR PATIO COVER	4	434	1988	2895	0	Y N

Improvements - Accessory Buildings

No improvement data available for all other stat class types.



V win good paint

BUILDING DIAGRAM AND OUTBUILDINGS

ACCT NO: R32801

MAP NO: 83W-24B

TAX LOT: 2500

GS
NIV

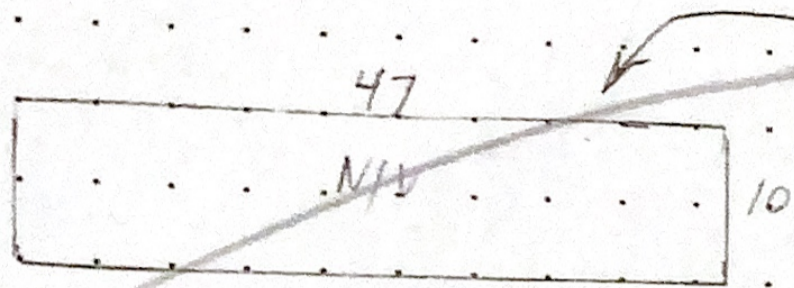

1966 BUILT
(GREAT LAKES/BELMONT)
M.124051

2016 gone ^{MP} NO VALUE

GS
NIV

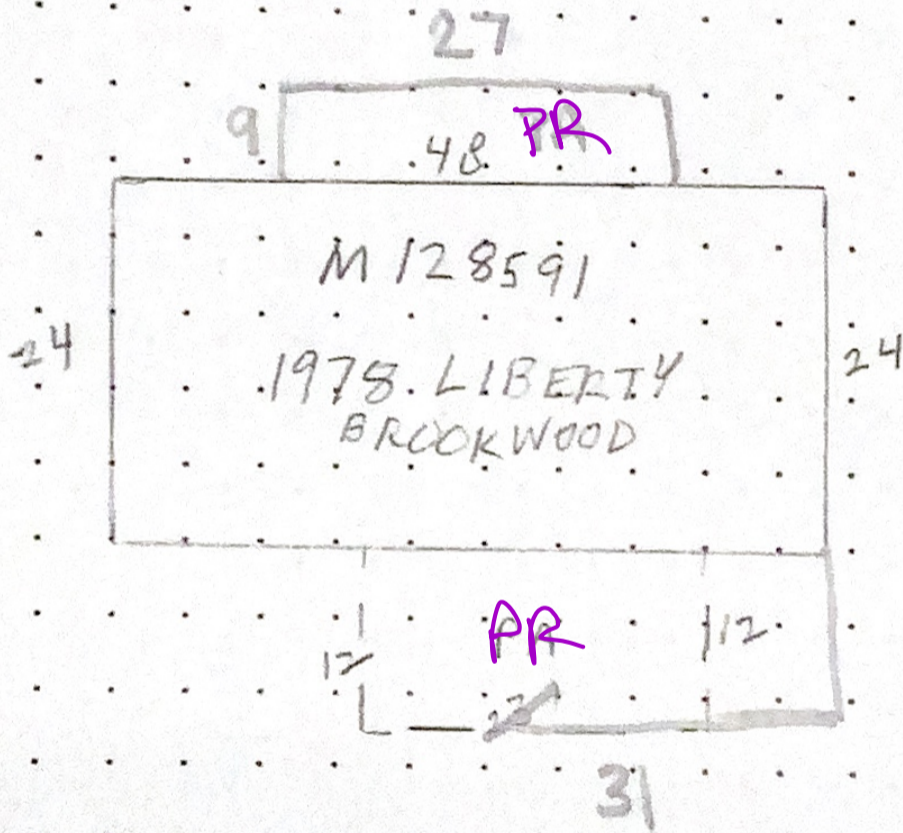

CALCULATIONS: 1978 LIBERTY - MOVED HERE IN 1996.

SCALE: 1" = 20'

(BUILDINGS DRAWN 7-12-00)

MEASUREMENT VERIFIED	YR BLT:	ADDRESS: 2528 ROBINS LN SE	SALES	
DATE: 7-12-2000	BY: DT/4	BUILDER: GREAT LAKES BELMONT	Date	Amt.
REMARKS: NIV 9/18/15 28				