

Summary Lead Appr: \_\_\_\_\_ Clerk: \_\_\_\_\_ Lead Clerk: \_\_\_\_\_ Appr: \_\_\_\_\_ Print Date: 9/24/2024

Acct ID: 133625 MTL: 083W23A002100P1 Date: 10/1/24 Appr: 02 Prop Class: 019 RMV Prop Class: 019

Situs: 2000 ROBINS LN SE # 7 SALEM, OR 97306 MaSaNh: 17 05 000 Unit: 133625 Year: 2024 2526

Last Date Appraised: 09/07/2022 Appraiser: THERESA SWEARINGEN Retag: Y N Tag info: \_\_\_\_\_  
 Owner: GOIN, BRIGIT Roll Type: MS  
 Cycle Tag Sales Verification Other: \_\_\_\_\_ Inspection level: 1 2 3 4 LCB TTO INSP AV: 66970  
 RMV Land: 0 RMV Imp: 110430 RMV Total: 110430 MAV: 66970 MSAV: 0 SAV: 0  
 Comment: 23-24: L2, 9.7.22, TS//

**Notations**  
 No notation data available. N/C

**OSDs**  
 No OSD data available.

**Land**  
 No land data available.

**Improvements - Residence / Manufactured Structures**  
 Bldg: 1 Code Area: 24010 Stat Class: 457 + Year Blt: 1997 Eff Year Blt: 1997 Sq.Ft: 1620 % Complete: 100  
 Desc: MANUF STRUCT, CLASS 5, 26' THROUGH 28' WIDE DOUBLE Dimensions: 60x27 RMV: 110430  
 Func Obsc: 100 Econ %: 100 Other %: 100 Exception: 0 Adjust: Adjust RMV: 0

**Floors**

Type	Class	Display Group	Floor Size	Beds	Baths	Yr Blt	Eff Yr Blt	Inventory	Exception: Y N
First Floor	5 +	Finished	1620	3	FB-2	1997	1997	BATH - 2, KIT-, HVAC+, ROOF+, SKIRT	Y N

**Accessories**

Description	Class	Size SqFt	Eff Yr Blt	RMV	Quantity	Exception: Y N
DECK	5	208	1997	1830	0	Y N
MULTI-PURPOSE BUILDING	5	80	1997	0	0	Y N
ROOF EXTENSION OR PATIO COVER	5	208	1997	2413	0	Y N
ROOF EXTENSION OR PATIO COVER	5	300	1997	3480	0	Y N

**Improvements - Accessory Buildings**  
 No improvement data available for all other stat class types.

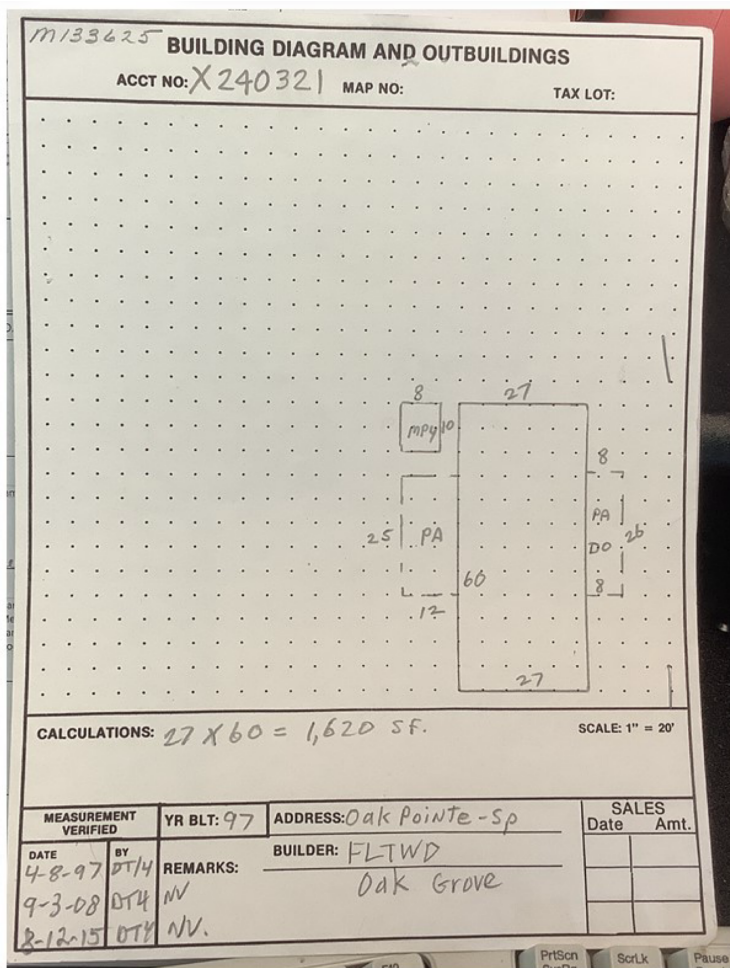

SV 23-24 #2 h2 9/1/22 LCB

Input mjlw 2-13-23, Update Invent, I/O

# Improvement Detail

MARION County  
For Assessment Year 2022

MLS -  
Pict ✓

**Account ID** 133625  
**Map** 083W23A002100P1  
**Mailing** GOIN, BRIGIT  
 251 GREGORY LN SE  
 SALEM OR 97302  
**Situs** 2000 ROBINS LN SE #7 SALEM OR 97306

**Appraiser** THERESA SWEARINGEN  
**Appraisal Area** 06-05-000  
**Stat Class** 457 - MANUF STRUCT, CLASS 5, 26' THROUGH 28'  
 WIDE DOUBLE

ts 2-13-23

Bldg	Code Area	Year Built	Eff Year	Comp %	% Good	LCM	Value	RMV	Taxable RMV	MAV	Exception	AV	Sqft
1	24010	1997	1997	100	40	194	Tabled	86,770	86,770	63,130	0	63,130	1,620

Rooms: 3 - BD, 2 - FB

Description	Floor Segments					Sqft	RCN
	Yr Blt	Eff Yr	% Good	Class	Comp %		
First Floor	1997	1997	40	5	100	1,620 ✓	106,892

Improvement Inventory							
F	Description	Qty/Size	RMV	F	Description	Qty/Size	RMV
1st	BATH - FULL	2	2,328	1st	HOOD & FAN	1	318
1st	DISHWASHER	1	559	1st	ROOF COVER - COMPOSITION	0 ✓	0
1st	DRYWALL	1,620 - 0	0	1st	SKIRTING - VINYL	174	1,044
1st	HEAT PUMP ✓	1,620	1,068				

Accessories				
Description	Eff Yr	Size	Qty	RMV
<del>UNCODED ACCESSORY</del>			0	0
ALUMINUM PATIO COVER ✓	1997	300 -	1	2,160
WOOD DECK ✓	1997	208 -	1	1,830
ALUMINUM PATIO COVER ✓	1997	208 -	1	1,498
MULTI-PURPOSE BUILDING	1997	80 -	1	672

Totals		Size Breakdown	
Description	RMV	Size	RMV
First Floor	\$48,073	Finished	1,620
Inventory	\$0		
Accessories	\$6,160		
Trend	160.00 %		
<b>Total RMV</b>	<b>\$86,770</b>		

**Comments** 15-16 CYCLE WORK INV UPDATE CLASS// 08-09 CYCLE WORK INVENTORY CHANGES PER #4 9-3-08 01-02: REAPPRAISAL

update class + RMV 2/0

**MARION COUNTY ASSESSOR**  
**Manufactured Structure Assessment Report**  
**FOR ASSESSMENT YEAR 2022**  
**NOT OFFICIAL VALUES**

8/16/2022 10:26:08 AM

<b>Account #</b>	133625	<b>Tax Status</b>	ASSESSABLE
<b>Code - Tax #</b>	24010	<b>Acct Status</b>	ACTIVE
<b>Mailing Address</b>	GOIN, BRIGIT 251 GREGORY LN SE SALEM OR 97302	<b>Subtype</b>	PERSONAL
		<b>Home ID</b>	286197
		<b>X Number</b>	X00240321

<b>Situs Address</b>	<b>Situs City</b>	<b>Tax Notation</b>	REMAILED STMT
2000 ROBINS LN SE #7	SALEM	<b>Appraiser</b>	THERESA SWEARINGEN

Value Summary						
Code Area	RMV	MAV	AV	Trend %	RMV Exception	CPR %
24010	IMPR.	\$86,770	\$63,130	\$63,130	160%	IMPR.

Manufactured Structure Information			
<b>VIN #</b>	ORFLT48AB235260G13	<b>Stat Class</b>	457
<b>Brand</b>	FLEETWOOD	<b>Quality</b>	100
<b>Model</b>	OAK GROVE	<b>Condition</b>	
<b>Year Built</b>	1997	<b>MA / SA / NH</b>	06 / 05 / 000
<b>Sticker #</b>		<b>Bedrooms / Baths</b>	3 / 2

Real Property Information			
<b>Real Account ID</b>	532686	<b>MA / SA / NH</b>	06 / 07 / 000
<b>Map</b>	083W23A002100	<b>Property Class</b>	707
<b>Unit</b>	75697	<b>RMV Class</b>	707
<b>Park Name</b>	OAK POINTE ESTATES		
<b>Comments</b>	LEVEL 2 LS89 092420//		

**Floors**

Description	Class	SQFT	Size Type	Type of Heat	RMV
First Floor	5	1,620	S		48,073
DIMENSIONS: 27 X 60					

**Inventory**

	Size/Qty	RMV		Size/Qty	RMV
BATH - FULL	2	2328	DISHWASHER	1	559
SKIRTING - VINYL	174	1044	HOOD & FAN	1	318
HEAT PUMP	1620	1068	ROOF COVER - COMPOSITION	1	0
DRYWALL	1	0			
<b>Total Inventory RMV</b>					5317

**Accessories**

Description	Eff Year Built	SQFT	Quantity	RMV
ALUMINUM PATIO COVER	1997	300		2160
ALUMINUM PATIO COVER	1997	208		1498
MULTI-PURPOSE BUILDING	1997	80		672
UNCODED ACCESSORY		0	1	0
WOOD DECK	1997	208		1830
<b>Total Accessories RMV</b>				6160

**Exemptions / Special Assessments / Potential Liability**

<b>Type</b>	SPECIAL ASSESSMENT(S):		
<b>TYPE</b>	MFD COMMUNITIES RES CTR	<b>Amount</b>	\$10.00

**Comments:**

15-16 CYCLE WORK INV UPDATE CLASS// 08-09 CYCLE WORK INVENTORY CHANGES PER #4 9-3-08 01-02: REAPPRAISAL

*V. Siding*

*Class = Same Des +  
W/m*

MIS3625		087621A-02100		Appt # 211		Date 3-12-15		Prop Class 119		Prop Code 118-25	
Site Address: 2008 BOBBINS LN SE, #7				Owner: BOYTA, SCILLARIO A				Franchise Code 04		Year For: 2013-2014	
Notes:		Tags: <i>Cybs</i>		Sales Verification:		Other:					
RWV Year: 25,150		RWV Total: 25,150		MIS Total: 25,150							
Sag Type MA		Sag # 1.1		Method 504		Class 150		Area 1623		Length 60	
Main: STEEPLY		Roof Style: Gable		Roof Cover: CLAD							
Year Built: 1997		ER Year Built: 1997		Cond. P F G O B		Econ		RWV: 29,300			
Lump Sum		Except Code/Year		Comments: <i>change to Appr. In Agreement</i>							
Sag Type PA		Sag # 1.3		Method 805		Class 300		Area 300		Length 300	
Main: STEEPLY		Roof Style: Flat		Roof Cover: METAL							
Year Built: 1997		ER Year Built: 1997		Cond. P F A G O B		% Comp		Econ		RWV: 2,268	
Lump Sum		Except Code/Year		Comments: <i>change to Appr. In Agreement</i>							
Sag Type DF		Sag # 1.4		Method 805		Class 208		Area 208		Length 208	
Main: STEEPLY		Roof Style: Flat		Roof Cover: METAL							
Year Built: 1997		ER Year Built: 1997		Cond. P F A G O B		% Comp		Econ		RWV: 1,848	
Lump Sum		Except Code/Year		Comments: <i>change to Appr. In Agreement</i>							
Sag Type PA		Sag # 1.5		Method 805		Class 208		Area 208		Length 208	
Main: STEEPLY		Roof Style: Flat		Roof Cover: METAL							
Year Built: 1997		ER Year Built: 1997		Cond. P F A G O B		% Comp		Econ		RWV: 1,500	
Lump Sum		Except Code/Year		Comments: <i>change to Appr. In Agreement</i>							
Sag Type MNK		Sag # 1.2		Method 154		Class 174		Area 174		Length 174	
Main: STEEPLY		Roof Style: Flat		Roof Cover: METAL							
Year Built: 1997		ER Year Built: 1997		Cond. P F A G O B		% Comp		Econ		RWV: 9	
Lump Sum		Except Code/Year		Comments: <i>white vinyl siding, v. windows</i>							

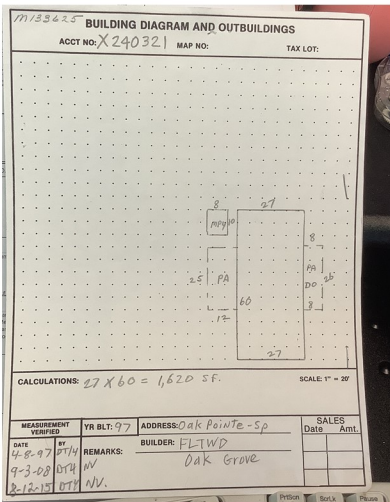



**Marion County**  
OREGON  
ASSESSOR'S OFFICE

**Appraiser Sales Verification From**

Primary Acct: 133625  
 MTL: 083W23A002100P  
 MaSaNh/P.Class: 1  
 MH Acct: All/019 -  
 MANUFACTURED  
 STRUCTURE; ON  
 RESIDENTIAL  
 PROPERTY  
 All

Date Printed: 6/28/2022

Situs: 2000 ROBINS LN SE #7 SALEM OR 97306

Grantor:  
AMARAL, JUAN D

Grantee:  
GOIN, BRIGIT

Deed: Total Sale RMV:  
 Accts In Sale: All Land:  
 Sale Date: 3/25/2022 OSD:  
 Sale Price: 109000 Imp: All  
 Code: 00 - UNCONFIRMED Grand Total: 54230  
 Ratio: 0.5

Attempt	Date/Time	Reason
1 <sup>st</sup>	9/7/22 10:56	LCB
2 <sup>nd</sup>		

Contact: Brogot Phone/email: \_\_\_\_\_

- Was the property listed on the open market? Days: \_\_\_\_\_ MLS: Craiglist Y N
- Was property other than real estate included in the sale? Y N  
Describe: \_\_\_\_\_ Est. \$: \_\_\_\_\_
- Did the seller pay closing costs or make other concessions? \$ 1,000 for repairs Y N
- Was the sale between related parties? (business or family) Y N
- Was this a distressed sale? E.g. foreclosure, short, court order, etc... Y N
- Condition at time of sale: | Poor | Fair | Avg. | Good | Exc. | Y N  
Describe: \_\_\_\_\_  
\_\_\_\_\_  
\_\_\_\_\_
- Have any improvements been made since the time of sale? Y N  
If yes, describe: \_\_\_\_\_  
\_\_\_\_\_ felt paid fair price \_\_\_\_\_  
\_\_\_\_\_

Comments:  
\_\_\_\_\_  
\_\_\_\_\_  
\_\_\_\_\_

Appraiser: 02 Date: 9/14/22  
02 9/19/22



9-7-22



7

9-7-22



M133625 8-12-15