

Prop ID # 608582
 MTL 072W06BA00800
 Tag? NO YES Date 7/26/24

Prop Class 019 Prop Code 019
 Situs 4882 LANCASTER DR NE #90
 Brand: Fleetwood - Sandpointe

Pull tag

ts 10-28-24

Segment
 Roof: Roof Roof+
 Heat: HVAC HVAC +
 Plumbing: Jettub Grdntub
 # of Fireplace(s):
 Interior comp: Cktp Crng Dsp DW
 H&F Oven s/d Micro BIREF Trash Other
 Bedrooms: Qty
 Yr Blt 2023 Eff Yr 2024 % Good
 % Comp 100 Func Econ
 Except Code new Lump Sum
 Comments single

444 616

Kit Ave

24

Segment
 Roof: Roof Roof +
 Heat: HVAC HVAC +
 Plumbing: Jettub Grdntub
 # of Fireplace(s):
 Interior comp: Cktp Crng Dsp DW
 H&F Oven s/d Micro BIREF Trash Other
 Bedrooms: Qty
 Yr Blt Eff Yr % Good
 % Comp Func Econ
 Except Code Lump Sum
 Comments

Segment MHSK Class Lin FT 116
 Skirting Wood Vinyl Fbrgl Metal
 Skirting + Cinder Block Brick
 Yr Blt 2024 Eff Yr 2024 % Good
 % Comp 100 Func Econ
 Except Code new Lump Sum
 Comments

Segment
 Roof: Roof Roof +
 Heat: HVAC HVAC +
 Plumbing: Jettub Grdntub
 # of Fireplace(s):
 Interior comp: Cktp Crng Dsp DW
 H&F Oven s/d Micro BIREF Trash Other
 Bedrooms: Qty
 Yr Blt Eff Yr % Good
 % Comp Func Econ
 Except Code Lump Sum
 Comments

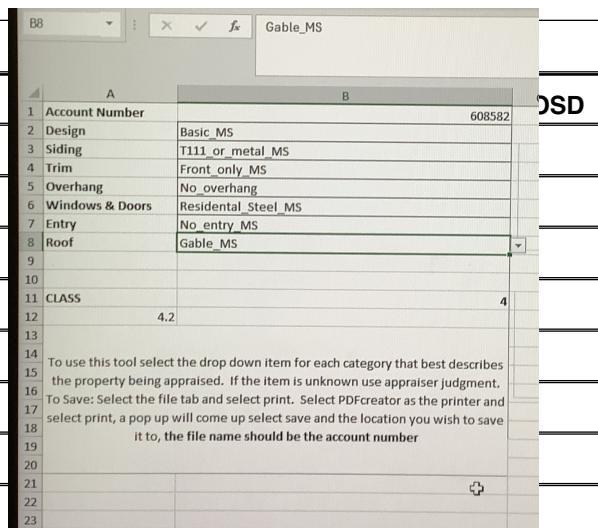
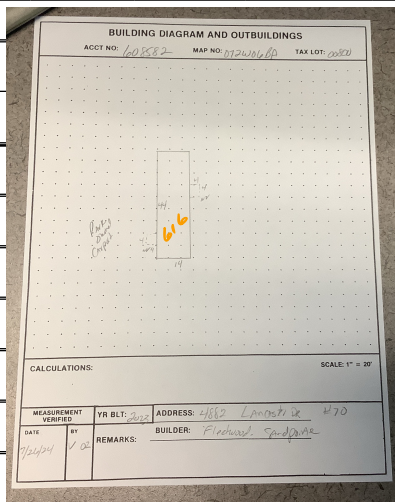

Segment
 Class
 Dimensions/Size
 Foundation
 Exterior Wall
 Interior Finish
 Roof Cover
 Roof Style
 Flooring
 Plumbing
 Heat
 Electric
 Misc.
 Year Built
 Eff. Year
 Condition
 % Complete
 Lump Sum
 Exception Code



Manufactured home

Account: 608582

Tag color ORF

561306

Exterior:

Overhang: Number of Sides: 1 2 3 4 Wide Average Narrow

Windows: Minimal Average Abundant

Recessed Entry: Y N Siding: T-111 Hardi Beveled with accents Hardi with masonry

Roof: Comp Arch Comp Metal Other Multiple Gables: 0 1 More

Doors: Res Steel Wooden Glass Slider Transom Sidelights

Trim: Front only All sides

Exterior Class: 4 5 6 7 + -

Heat: FA BB HP AC

Interior:

Walls: Panel T & T Gypsum Arches Plant shelves Built-ins Extra rooms

Kitchen:

Island: Y N Cabinets: Wrapped vinyl Wood doors Wood

Pantry: Y N Counters: Granite Tile Laminate Other:

Components: Dishwasher Hood Fan Range Oven Microwave Cooktop Double oven Garbage Disposal

Floors: Vinyl Tile Wood Laminate Other:

Kitchen Class: 4 5 6 7 + -

Bath:

Number:

Master: Sinks: 1 2 Shower Tub Combo Cabinets: Y N Floors: Tile Vinyl Other

Other: Sinks: 1 2 Shower Tub Combo Cabinets: Y N Floors: Tile Vinyl Other

Bath Class: 4 5 6 7 + -

Utility: Cabinets Sink Other:

Overall Class: 4 5 6 7 + -

MANUFACTURER'S STATEMENT OR CERTIFICATE OF ORIGIN TO A MANUFACTURED HOME

MANUFACTURER: Fleetwood Homes

ADDRESS: 2655 Progress Way, Woodburn, OR 97071

Street, City, State, and Zip

COPY

The undersigned MANUFACTURER hereby certifies that the new manufactured home described below, the property of said MANUFACTURER, has been transferred

this 27th day of April, 2023 on Invoice No 202372198000

To: JO PROPERTY GROUP LLC

Distributor, Dealer, Etc.

Whose Address is: 1700 ADAMS AVENUE SUITE 212

Street

COSTA MESA, CA 92626

City, State, and Zip

Trade Name: 210SP-Sandpointe-14441A Model Year: 2023

Model No: 210SP14441A Body Width Ft: 18' 8"

Body Length Ft: 48' 0" / Ft: 44' 0"

Including Hitch

Excluding Hitch

Square Feet: 601 Date of Manufacture: 04/24/2023

Manufacturer's ID No: FLE210OR23-23251A Weight: 18,540

Manufacturer's ID No: _____ Weight: _____

Manufacturer's ID No: _____ Weight: _____

Manufacturer's ID No: _____ Weight: _____

Manufacturer's ID No: _____ Weight: _____

Manufacturer's ID No: _____ Weight: _____

The CORPORATION further Certifies that this was the first transfer of such new manufactured home in ordinary trade and commerce.

Fleetwood Homes

Corporation

By: _____

Sign Name

Title or Position

Accounting Staff

2655 Progress Way, Woodburn, OR 97071

Office Address of Signatory (City & State)

FIRST ASSIGNMENT

For Value Received, the undersigned hereby transfers this Statement of Origin and the manufactured home described therein to: _____

Address: _____
and certifies that the home is new and has not been registered in this or any other state; he also warrants the title of said home at time of delivery, subject to the liens and encumbrances, if any, as set out below

Amt. Of Lien	Date	To Whom Due	Address

Dated _____ at _____
By: _____

Transferor (Firm Name)

Sign Here

Position

Dealer License (Permit) No. _____

Before me personally appeared _____ who by me being

duly sworn upon oath says that the statements set forth above are true and correct.

Subscribed and sworn to before me this _____ day of _____,

Notary Public for _____ County, State of _____

Notary Seal

SECOND ASSIGNMENT

For Value Received, the undersigned hereby transfers this Statement of Origin and the manufactured home described therein to: _____

Address: _____
and certifies that the home is new and has not been registered in this or any other state; he also warrants the title of said home at time of delivery, subject to the liens and encumbrances, if any, as set out below

Amt. Of Lien	Date	To Whom Due	Address

Dated _____ at _____
By: _____

Transferor (Firm Name)

Sign Here

Position

Dealer License (Permit) No. _____

Before me personally appeared _____ who by me being

duly sworn upon oath says that the statements set forth above are true and correct.

Subscribed and sworn to before me this _____ day of _____,

Notary Public for _____ County, State of _____

Notary Seal

THIRD ASSIGNMENT

For Value Received, the undersigned hereby transfers this Statement of Origin and the manufactured home described therein to: _____

Address: _____
and certifies that the home is new and has not been registered in this or any other state; he also warrants the title of said home at time of delivery, subject to the liens and encumbrances, if any, as set out below

Amt. Of Lien	Date	To Whom Due	Address

Dated _____ at _____
By: _____

Transferor (Firm Name)

Sign Here

Position

Dealer License (Permit) No. _____

Before me personally appeared _____ who by me being

duly sworn upon oath says that the statements set forth above are true and correct.

Subscribed and sworn to before me this _____ day of _____,

Notary Public for _____ County, State of _____

Notary Seal

COPY

70

Per Community
Home not on
site
1-1-24

