

Summary Lead Appr: WW Clerk: Lead Clerk: Appr: MDL Print Date: 7/31/2023

Acct ID: 531056 MTL: 082W320000500 Date: 12/1/23 Appr: MDL Prop Class: 551 RMV Prop Class: 451
Situs: 8621 WIPPER RD SE TURNER OR 97392 MaSaNh: 07 06 000 Unit: 38849 Year: 2023 2024
Last Date Appraised: 01/03/2023 Appraiser: MATT LORD Retag: Y N Tag info:
Owner: RIFFLE, SCOTT R Roll Type: R
Cycle Tag Sales Verification Other: Inspection level: 1 2 3 4 LCB TTO INSP AV: 388587
RMV Land: 392490 RMV Imp: 697570 RMV Total: 1090060 MAV: 327970 MSAV: 21547 SAV: 60203
Comment: 23-24: L2 1.3.23 MDL INPUT 12/1/23 MDL WW

Notations Farm use OK Cancel TAG
Table with 3 columns: RP/MS, Code, Description
RP 505 SEE ACCOUNT NOTES - 505
RP ZONED FARM EFU ZONED

OSDs
Table with 6 columns: Count, Code, Description, RMV, Code Area, Exception
1 SAA SA OSD - AVERAGE 45000 05595 0

Land Chris 3/20/24 Amy 4-3-24

Site: 2 Code Area: 05595 Size: 1.00 Acres Use Code: 005 Zone: REST SAV Use: 011 Exception: 0
Class: 2BD Value Source: Farm Homesite Description: TWO BENCH DRY RMV: 77640 Exception: Y N
Adjustment(s): VWVGR, GSOIL Fire Patrol: Description:
Comments: Liability year - 2009 / 11-12: CYCLE WORK PER #42 ADD VIEW ADJ// 05-06: ROLL 26 ACRES OF LAND INTO WETLANDS PROGRAM,BALANCE OF LAND WILL REMAIN UNDER FARM DEFERRAL//

Site: 3 Code Area: 05595 Size: 11.15 Acres Use Code: 005 Zone: REST SAV Use: 011 Exception: 0
Class: 2BD Value Source: Farm Use - EFU Description: TWO BENCH DRY RMV: 252360 Exception: Y N
Adjustment(s): VWVGR, GSOIL Fire Patrol: Description:
Comments: Liability year - 1980 / 05-06: ROLL 26 ACRES OF LAND INTO WETLANDS PROGRAM,BALANCE OF LAND WILL REMAIN UNDER FARM DEFERRAL.

Site: 4 Code Area: 05595 Size: 0.85 Acres Use Code: 005 Zone: REST SAV Use: 011 Exception: 0
Class: WOOD 2BDSS Value Source: Woodlot Description: FARM WOODLOT RMV: 17490 Exception: Y N
Adjustment(s): VWVGR, GSOIL Fire Patrol: Description:
Comments: Liability year - 1980 / 05-06: ROLL 26 ACRES OF LAND INTO WETLANDS PROGRAM,BALANCE OF LAND WILL REMAIN UNDER FARM DEFERRAL.

Improvements - Residence / Manufactured Structures

Bldg: 1 Code Area: 05595 Stat Class: 141 + Year Blt: 1966 Eff Year Blt: 1980 Sq.Ft: 2368 % Complete: 100
Desc: One Story Only Dimensions: RMV: 355250
Func Obsc: 100 Econ %: 100 Other %: 100 Exception: 39070 Adjust: Adjust RMV: 0

Floors

Table with 10 columns: Type, Class, Display Group, Floor Size, Beds, Baths, Yr Blt, Eff Yr Blt, Inventory, Exception
First Floor 4 + Finished 2368 5 FB-2 1966 1980 BATH - 2, KIT-, ROOF, HVAC, FP Exception: Y N

Accessories

Table with 6 columns: Description, Class, Size SqFt, Eff Yr Blt, RMV, Quantity
YARD IMPROVEMENTS AVERAGE 4 0 1980 22397 1 Exception: Y N

Bldg: 6 Code Area: 05595 Stat Class: 148 Year Blt: 1980 Eff Year Blt: 1980 Sq.Ft: 0 % Complete: 100
Desc: Res other improvements Dimensions: RMV: 52380
Func Obsc: 100 Econ %: 100 Other %: 100 Exception: 0 Adjust: Adjust RMV: 0

Floors

Table with 10 columns: Type, Class, Display Group, Floor Size, Beds, Baths, Yr Blt, Eff Yr Blt, Inventory, Exception
Garage Detached 4 Unfinished 572 0 0 1980 1980 ROOF Exception: Y N

Accessories

Table with 6 columns: Description, Class, Size SqFt, Eff Yr Blt, RMV, Quantity
No accessory data available

Improvements - Accessory Buildings

Bldg: 2 Code Area: 05595 Stat Class: 351 Year Blt: 1970 Eff Year Blt: 1970 Sq.Ft: 1300 % Complete: 100
Desc: General Purpose Building (GB) Dimensions: 50x26 RMV: 4090
Func Obsc: 100 Econ %: 100 Other %: 100 Exception: 0 Adjust: Adjust RMV: 0

Floors

Type	Class	Display Group	Floor Size	Beds	Baths	Yr Blt	Eff Yr Blt	Inventory
General Purpose Bldg	4	Finished	1300	0	0	1970	1970	Exception: Y N

Accessories

Description	Class	Size SqFt	Eff Yr Blt	RMV	Quantity
No accessory data available					

Bldg: 3	Code Area: 05595	Stat Class: 341	Year Blt: 2000	Eff Year Blt: 2000	Sq.Ft: 80	% Complete: 100
Desc: Multi Purpose Shed (MP)			Dimensions: 10x8		RMV: 220	
Func Obsc: 100	Econ %: 100	Other %: 100	Exception: 0	Adjust:	Adjust RMV: 0	

Floors

Type	Class	Display Group	Floor Size	Beds	Baths	Yr Blt	Eff Yr Blt	Inventory
Multi-Purpose Bldg	4	Finished	80	0	0	2000	2000	FAIR Exception: Y N

Accessories

Description	Class	Size SqFt	Eff Yr Blt	RMV	Quantity
No accessory data available					

Bldg: 4	Code Area: 05595	Stat Class: 321	Year Blt: 1966	Eff Year Blt: 1966	Sq.Ft: 1300	% Complete: 100
Desc: Hay Cover (HC)			Dimensions: 50x26		RMV: 2460	
Func Obsc: 100	Econ %: 100	Other %: 100	Exception: 0	Adjust:	Adjust RMV: 0	

Floors

Type	Class	Display Group	Floor Size	Beds	Baths	Yr Blt	Eff Yr Blt	Inventory
Hay Cover	5	Finished	1300	0	0	1966	1966	Exception: Y N

Accessories

Description	Class	Size SqFt	Eff Yr Blt	RMV	Quantity
No accessory data available					

Bldg: 5	Code Area: 05595	Stat Class: 311	Year Blt: 2001	Eff Year Blt: 2001	Sq.Ft: 2304	% Complete: 100
Desc: Feeder Barn (FB)			Dimensions: 48x48		RMV: 16920	
Func Obsc: 100	Econ %: 100	Other %: 100	Exception: 0	Adjust:	Adjust RMV: 0	

Floors

Type	Class	Display Group	Floor Size	Beds	Baths	Yr Blt	Eff Yr Blt	Inventory
Feeder Barn	5	Finished	2304	0	0	2001	2001	Exception: Y N

Accessories

Description	Class	Size SqFt	Eff Yr Blt	RMV	Quantity
No accessory data available					

Bldg: 7	Code Area: 05595	Stat Class: 316	Year Blt: 2018	Eff Year Blt: 2018	Sq.Ft: 12960	% Complete: 100
Desc: Arenas (HA)			Dimensions: 72x180		RMV: 223600	
Func Obsc: 100	Econ %: 100	Other %: 100	Exception: 0	Adjust:	Adjust RMV: 0	

Floors

Type	Class	Display Group	Floor Size	Beds	Baths	Yr Blt	Eff Yr Blt	Inventory
Horse Arena	5	Finished	12960	0	0	2018	2018	FAIR Exception: Y N

Accessories

Description	Class	Size SqFt	Eff Yr Blt	RMV	Quantity
No accessory data available					

Bldg: 8	Code Area: 05595	Stat Class: 355	Year Blt: 2018	Eff Year Blt: 2018	Sq.Ft: 4680	% Complete: 100
Desc: Lean-to Heavy (LTH)			Dimensions:		RMV: 42650	
Func Obsc: 100	Econ %: 100	Other %: 100	Exception: 0	Adjust:	Adjust RMV: 0	

Floors

Type	Class	Display Group	Floor Size	Beds	Baths	Yr Blt	Eff Yr Blt	Inventory
Lean-to Heavy Duty	5	Finished	4680	0	0	2018	2018	FAIR Exception: Y N

Accessories

Description	Class	Size SqFt	Eff Yr Blt	RMV	Quantity
No accessory data available					

R31056
082W32 00500
SCALE=1:60

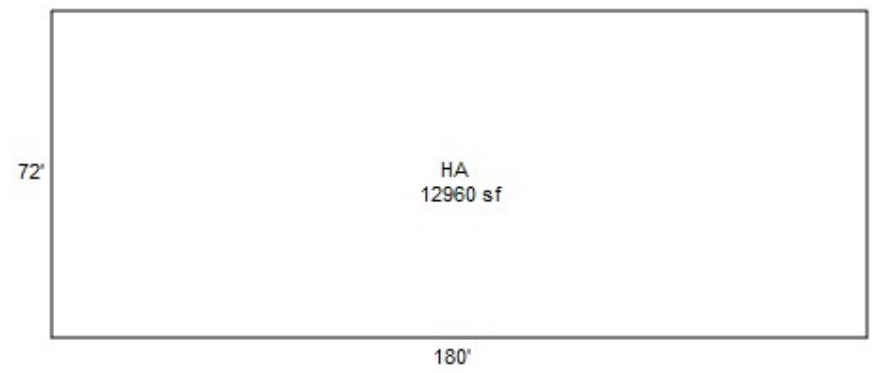
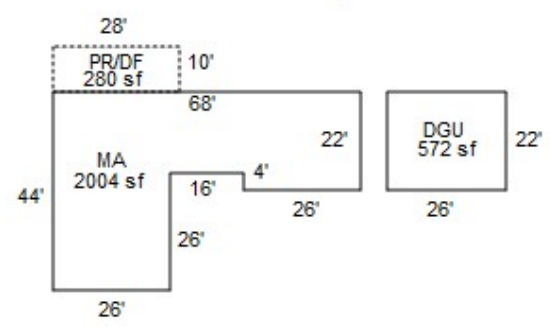
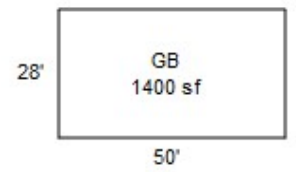
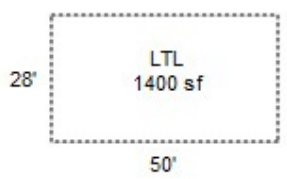
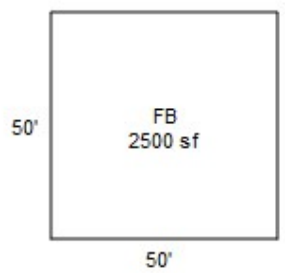

R31056
082W32 00500
SCALE=1:60

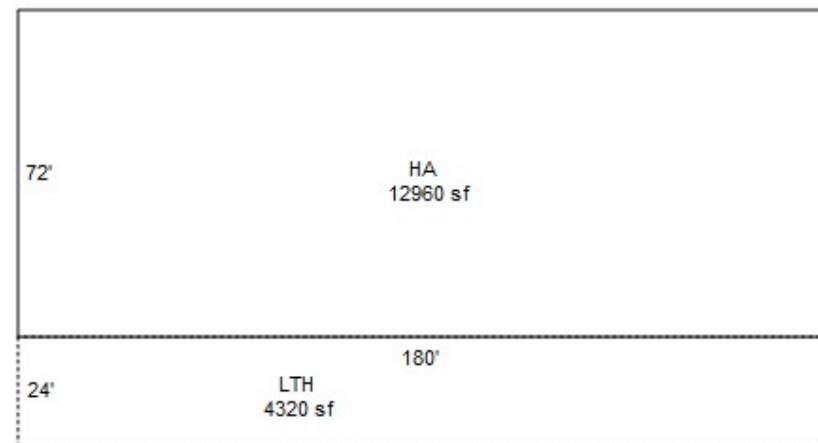
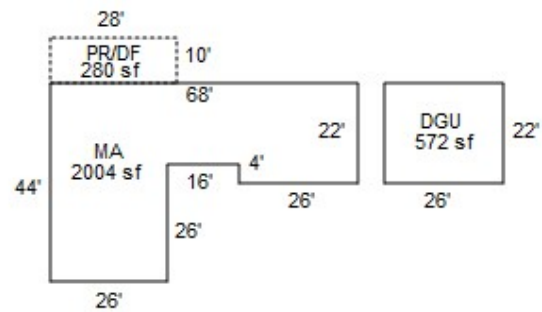
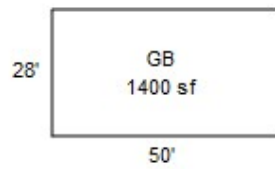
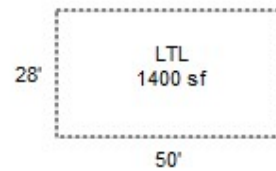
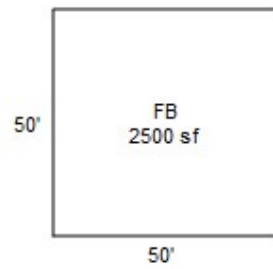

R31056
082W32 00500



See Page 2 for Res Dimensions

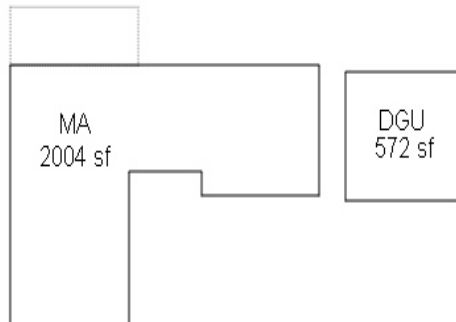
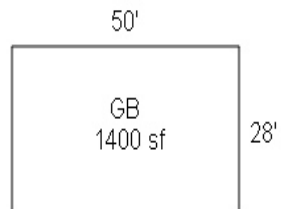
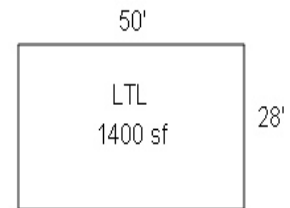
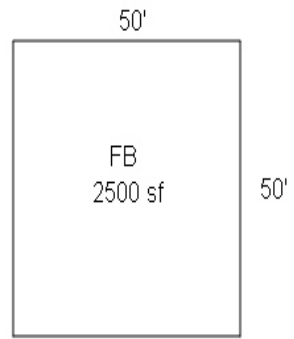

R31056
082W32 00500



See Page 1 for All Bldgs

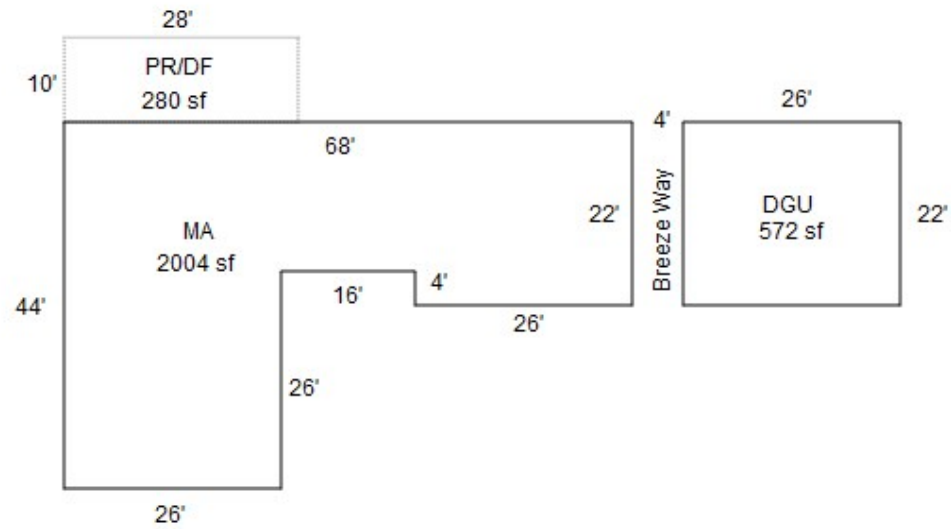

R31056
082W32 00500



See Page 1 for All Bldgs

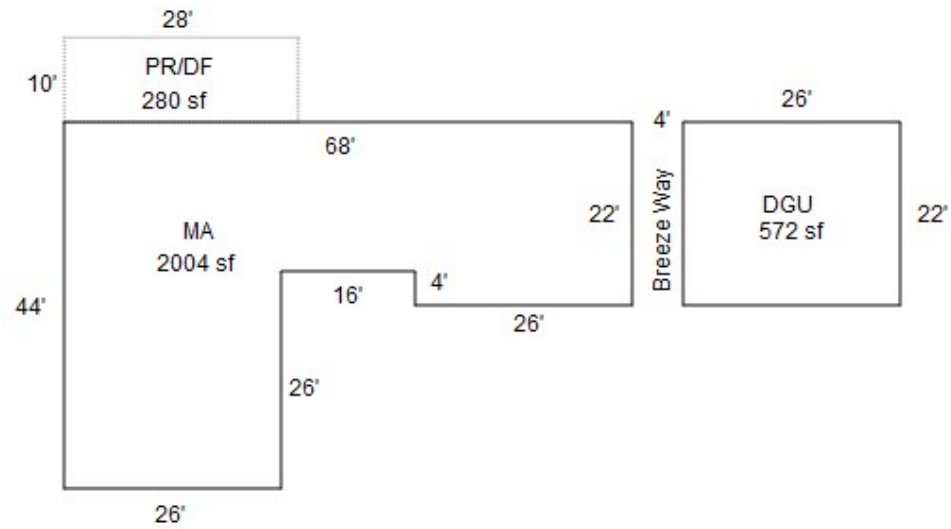

R31056
082W32 00500



See Page 1 for All Bldgs

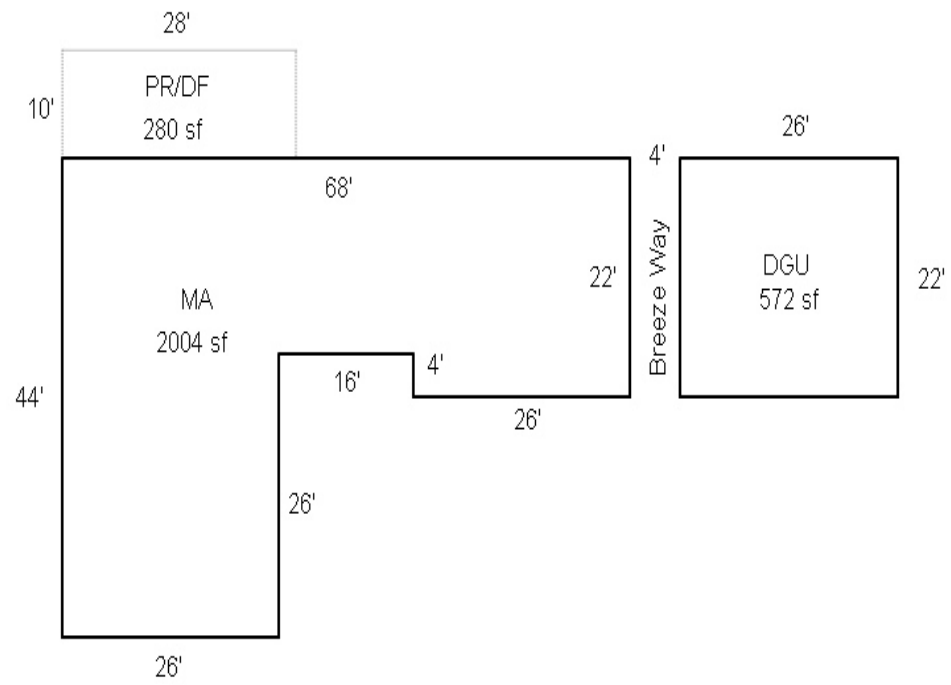

SKETCH/AREA TABLE ADDENDUM

SUBJECT INFO

File No.: 531056 Parcel No.: 082W32 00500
 Property Address: 8621 WIPPER RD SE
 City: TURNER County: MARION State: OR ZipCode: 97392
 Owner:
 Client: Client Address:
 Appraiser Name: Inspection Date:

SKETCH

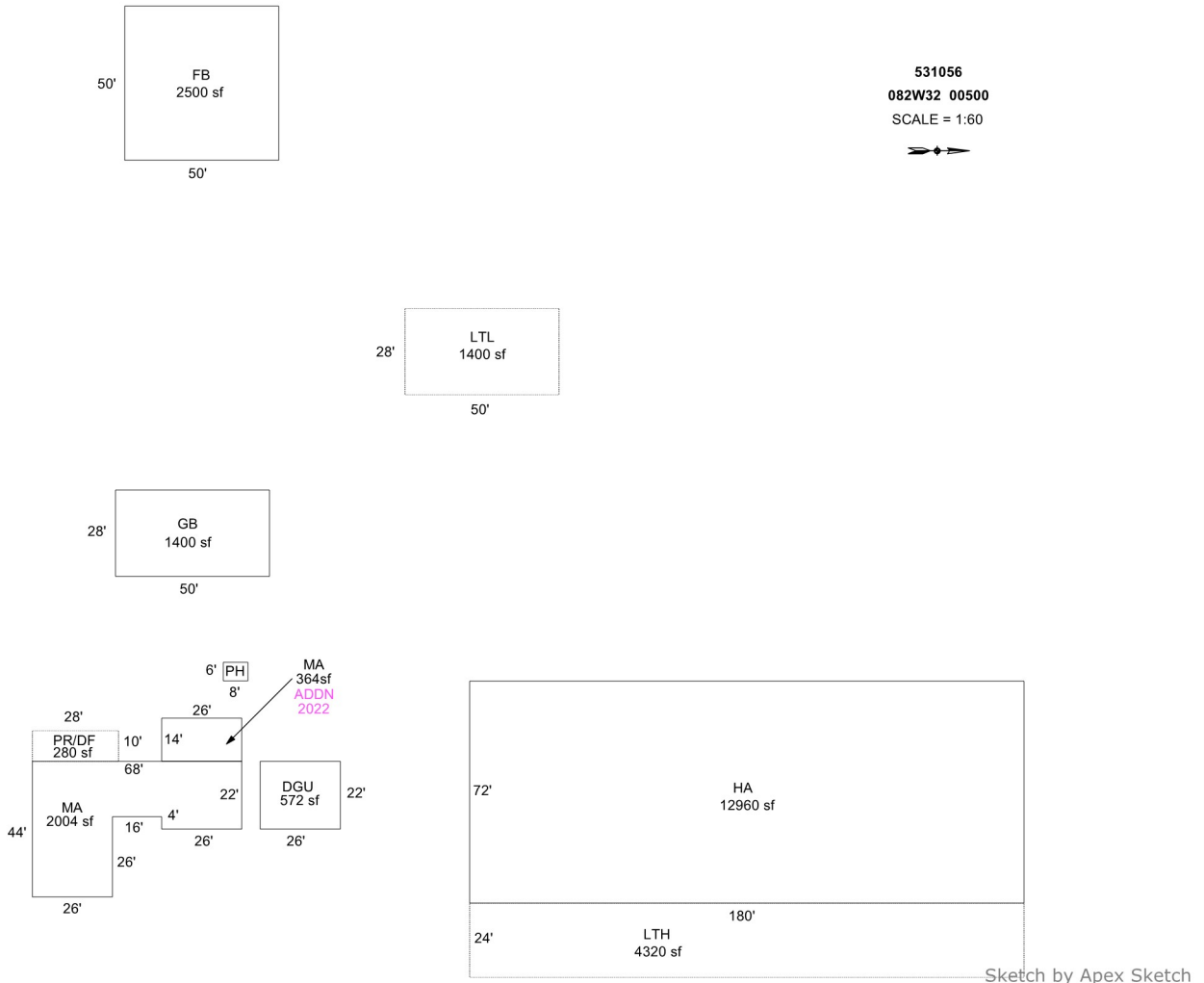

AREA CALCULATIONS SUMMARY

Code	Description	Factor	Net Size	Perimeter	Net Totals
GBA1	FB	1.0	2500.0	200.0	
	HA	1.0	12960.0	504.0	
	LTH	1.0	4320.0	408.0	19780.0
GLA1	MA	1.0	2004.0	232.0	
	MA	1.0	364.0	80.0	2368.0
GAR	DGU	1.0	572.0	96.0	572.0
OTH	PH	1.0	48.0	28.0	
	LTL	1.0	1400.0	156.0	
P/P	GB	1.0	1400.0	156.0	2848.0
	PR/DF	1.0	280.0	76.0	280.0
	Net LIVABLE	cnt	2 (rounded)		2,368
	Net BUILDING	cnt	3 (rounded)		19,780

COMMENT TABLE 1

Apex by JA 12/17/08
 Del LB, Conv LTL & GB to FB - CE 5/19/11
 UPDATED BY JRONDEMA 2/21/19
 UPDATED BY CJURAN 09/28/2022 555-22-005234

COMMENT TABLE 2

COMMENT TABLE 3



R31056 GB SIDE 2019 07 02



R31056 GB WINDOW DMG 2019 07 02



R31056 HC FRONT 2019 07 02



R31056 HC REAR 2019 07 02



R31056 MA FRONT N 2019 07 02



R31056 MA FRONT S 2019 07 02



R31056 MA REAR 2019 07 02



R31056 FB 48x48 2019 07 02



R31056 GB DMG 1 2019 07 02



R31056 GB DMG 2 2019 07 02



R31056 GB FRONT 2019 07 02



R31056 GB REAR 2019 07 02



R31056 GB ROOF 2019 07 02



R31056 GB 12.06.18



R31056 HA 12.06.18



R31056 MP 12.06.18











