

Acct ID: 522900 MTL: 072W13CB00900 Date: **9/13/23** Appr: **GRH** Prop Class: 401 RMV Prop Class: 401
 Situs: 8725 SUNNYVIEW RD NE SALEM OR 97305 MaSaNh: 04 06 000 Unit: 70610 Year: **2023**

Last Date Appraised: **01/06/2023** Appraiser: GERARDO RAMIREZ HERNANDEZ Retag: **Y N** Tag info: 2024 - Tags/Permit (Completion) **2024**

Owner: KUENZI, GLENDA Roll Type: R
 Cycle **Tag** Sales Verification Other: _____ Inspection level: **1 2 3 4** LCB TTO INSP AV: 152810
 RMV Land: 131020 RMV Imp: 174350 RMV Total: 305370 MAV: 93490 MSAV: 0 SAV: 0
 Comment: 23-24: L2 01.06.23 MLH **Close Permit Amy 12-28-23**

FINALED 06/20/23
Addn @ 100%
INPUT GRH 11/16/23
ww

OSDs

Count	Code	Description	RMV	Code Area	Exception
1	MKTA	OSD - AVERAGE	45000	40410	0

Land Chris 12/7/23

Site: 1 Code Area: 40410 Size: 14375 Sqft Use Code: 004 Zone: NREST SAV Use: Exception: 0
 Class: 2BD Value Source: Rural at MKT Description: TWO BENCH DRY RMV: 86020 Exception: Y N
 Adjustment(s): GSOIL Fire Patrol: Description:
 Comments: 05-06: RECALC SETUP; T19 05-14-04

Improvements - Residence / Manufactured Structures 1962 M/M

Bldg: 1 Code Area: 40410 Stat Class: 131 Year Blt: 1935 Eff Year Blt: **1961** Sq.Ft: **1481 / 1336** % Complete: 100
 Desc: One Story Only Dimensions: RMV: 174350
 Func Obsc: 100 Econ %: 100 Other %: 100 Exception: 59320 Adjust: Adjust RMV: 0

Floors

Type	Class	Display Group	Floor Size	Beds	Baths	Yr Blt	Eff Yr Blt	Inventory	Exception
First Floor	3	Finished	856 I/O 1001	1	FB-2	1935	1961	HVAC, ROOF, KIT, BATH - 2	Exception: Y N
First Floor	3	Finished	480	0	0	1935	1961	Addn @ 100% m/m	Exception: Y N
Garage Attached	3	Finished	576	0	0	2022	2022	ROOF 100% COMPLETE M/M	Exception: Y N

Accessories

Description	Class	Size SqFt	Eff Yr Blt	RMV	Quantity	Exception
ENCLOSED PORCH	3	120	1961	2556	1	Exception: Y N

DELETE
Add YL's as Average I/O

Improvements - Accessory Buildings

No improvement data available for all other stat class types.



AGF 09.13.23 L2



REAR MA 09.13.23 L2



REAR AGF 09.13.23 L2



BACK MA AGF 09.13.23 L2



REAR MA WEST 09.13.23 L2

SKETCH/AREA TABLE ADDENDUM

SUBJECT INFO

File No.: 522900 Parcel No.: 072W13CB00900
 Property Address: 8725 SUNNYVIEW RD NE
 City: SALEM County: MARION State: OR ZipCode:
 Owner:
 Client: Client Address:
 Appraiser Name: Sue Smith Inspection Date: 2012

SKETCH

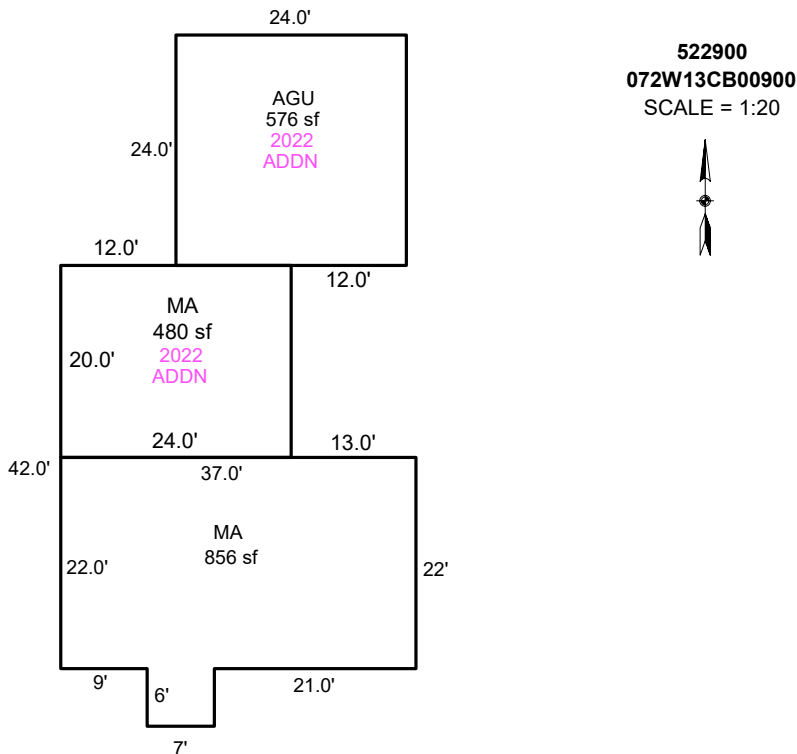

AREA CALCULATIONS SUMMARY

Code	Description	Factor	Net Size	Perimeter	Net Totals
GLA1	MA	1.0	856.0	130.0	
	MA	1.0	480.0	88.0	1336.0
AGU	AGU	1.0	576.0	96.0	576.0

COMMENT TABLE 1

APEX by AC 10/18/12
 UPDATED BY CJURAN 07/25/2022 555-22-003663
 UPDATED BY CJURAN 02/27/2023
 UPDATED BY CJURAN 10/018/2023

COMMENT TABLE 2

MLH 01/06/2023
 GRH 09/13/2023

COMMENT TABLE 3

TAGS L2
 TAGS L2

Net LIVABLE cnt 2 (rounded) 1,336

SKETCH/AREA TABLE ADDENDUM

SUBJECT INFO

File No.: 522900 Parcel No.: 072W13CB00900
 Property Address: 8725 SUNNYVIEW RD NE
 City: SALEM County: MARION State: OR ZipCode:
 Owner:
 Client: Client Address:
 Appraiser Name: Sue Smith Inspection Date: 2012

SKETCH

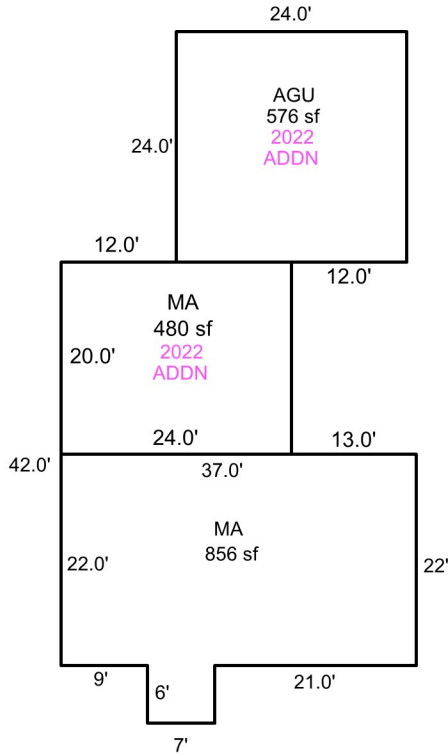

522900
072W13CB00900
 SCALE = 1:20



Sketch by Apex Sketch

AREA CALCULATIONS SUMMARY

Code	Description	Factor	Net Size	Perimeter	Net Totals
GLA1	MA	1.0	856.0	130.0	
	MA	1.0	480.0	88.0	1336.0
AGU	AGU	1.0	576.0	96.0	576.0

COMMENT TABLE 1

APEX by AC 10/18/12
 UPDATED BY CJURAN 07/25/2022 555-22-003663
 UPDATED BY CJURAN 02/27/2023

COMMENT TABLE 2

MLH 01/06/2023

COMMENT TABLE 3

TAGS L2

Net LIVABLE cnt 2 (rounded) 1,336

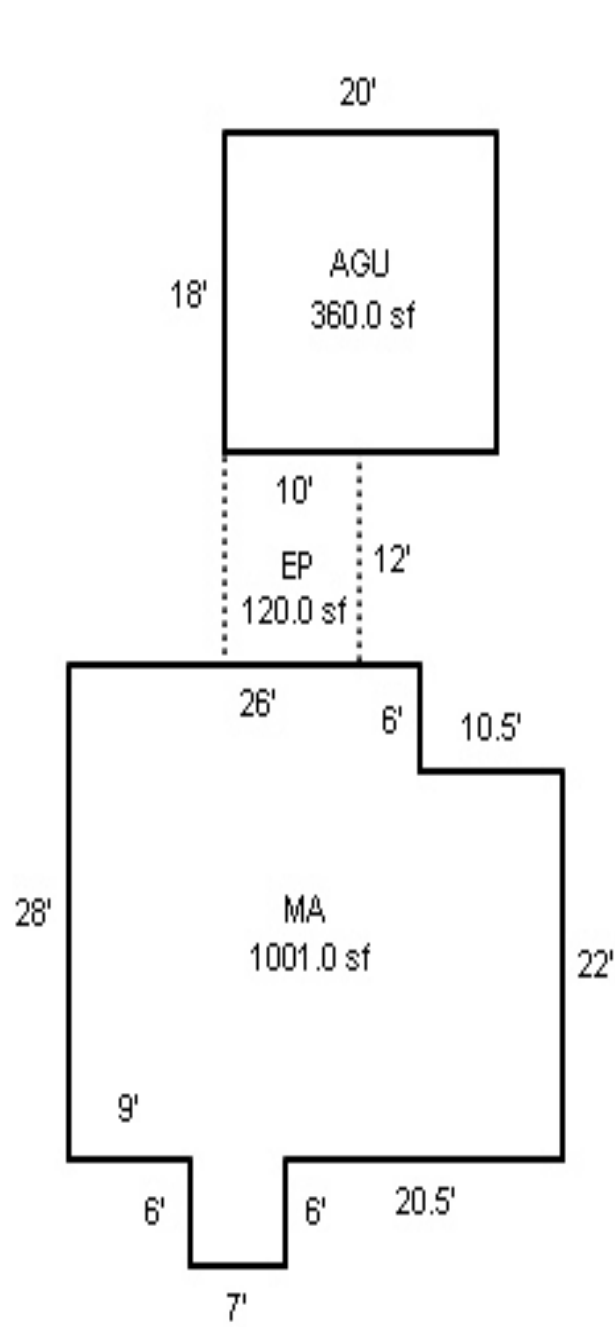

R22900
072W13CB00900



SKETCH/AREA TABLE ADDENDUM

SUBJECT INFO

File No.: 522900 Parcel No.: 072W13CB00900
 Property Address: 8725 SUNNYVIEW RD NE
 City: SALEM County: Marion State: OR ZipCode:
 Owner:
 Client: Client Address:
 Appraiser Name: Sue Smith Inspection Date: 2012

SKETCH

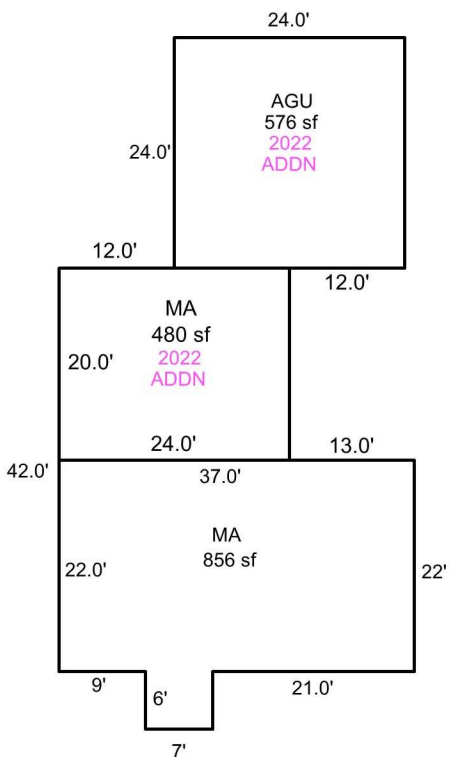

522900
072W13CB00900
 SCALE = 1:20



Sketch by Apex Sketch

AREA CALCULATIONS SUMMARY

Code	Description	Factor	Net Size	Perimeter	Net Totals
GLA1	MA	1.0	856.0	130.0	
	MA	1.0	480.0	88.0	1336.0
AGU	AGU	1.0	576.0	96.0	576.0

COMMENT TABLE 1

APEX by AC 10/18/12
 UPDATED BY CJURAN 07/25/2022 555-22-003663

COMMENT TABLE 2

COMMENT TABLE 3

Net LIVABLE cnt 2 (rounded) 1,336



09/25/2012



09/25/2012