

Acct ID: 524709 MTL: 072W36B000400 Date: **8-29-24** Appr: **Level** Prop Class: 401 RMV Prop Class: 401
 Situs: 375 HOWELL PRAIRIE RD SE SALEM OR 97317 MaSaNh: 01 06 006 Unit: 87604 Year: 2024
 Last Date Appraised: 03/03/2022 Appraiser: CLINT LUKE Retag: Y N Tag info: _____
 Owner: KROKER, JASON B Roll Type: R
 Cycle Tag **Sales Verification** Other: _____ Inspection level: 1 2 3 **4** LCB TTO INSP AV: 399810
 RMV Land: 283080 RMV Imp: 577080 RMV Total: 860160 MAV: 399810 MSAV: 0 SAV: 0
 Comment: 22-23 L3 03/03/22 MLH// LEVEL 3 7.1.21 JS29

CODED 9-3-24 Level
INPUT 10-18-24
30

Notations
 No notation data available.

307040 178 DAYS WITHDRAWN TOTAL LP 945K
314010 54 DAYS SOLD / 232 DAYS LP 749K SP 715,000 CONV.

OSDs

Count	Code	Description	RMV	Code Area	Exception
1	MKTA	OSD - AVERAGE	45000	92410	0

NE

Land

Site: 1 Code Area: 92410 Size: 2.31 Acres Use Code: 004 Zone: NREST SAV Use: Exception: 0
 Class: Value Source: Rural at MKT Description: **.77 4BD** RMV: 238080 Exception: Y N
 Adjustment(s): **1.54 2 BD** Fire Patrol: Description:
 Comments: 00-01 COMBINED LAND SEGMENTS NO SPECIAL ASSESSMENTS//03-04 ALN: HARDSHIP MH ORD. NO.02-57//05-06: RECALC SETUP; APPR36,06/03/04. //07-08: PER KLEHTO, CARTOGRAPHER, CHG OF ACREAGE FROM 2.5 TO 2.31

Improvements - Residence / Manufactured Structures

Bldg: 1 Code Area: 92410 Stat Class: 143 Year Blt: 1963 Eff Year Blt: 2000 Sq.Ft: 2732 % Complete: 100
 Desc: One Story with basement Dimensions: RMV: 495490
 Func Obsc: 100 Econ %: 100 Other %: 100 Exception: 0 Adjust: Adjust RMV: 0

Floors

Type	Class	Display Group	Floor Size	Beds	Baths	Yr Blt	Eff Yr Blt	Inventory	Exception
First Floor	4	Finished	1458	3	FB-1/ HB-1	1963	2000	BATH - 1, BTH - KIT+, HVAC, FP - 2, ROOF	Y N
Basement	4	Finished	1274	1	FB-1	1963	2000	BATH - 1, HVAC	Y N
Garage Attached	4	Finished	602	0	0	1963	2000	ROOF	Y N

AVE EXCEPT KIT

Accessories

Description	Class	Size SqFt	Eff Yr Blt	RMV	Quantity	Exception
ASPHALT DRIVEWAY	4	6000	2000	13350	1	Y N
PATIO	4	48	2000	335	0	Y N
PATIO	4	600	2000	2937	0	Y N
ROOF EXTENSION OR PATIO COVER	4	48	2000	1239	0	Y N

NE

> 114G

Improvements - Accessory Buildings

Bldg: 2 Code Area: 92410 Stat Class: 354 Year Blt: 1986 Eff Year Blt: 1986 Sq.Ft: 288 % Complete: 100
 Desc: Lean-to Light (LTL) Dimensions: 24x12 RMV: 300
 Func Obsc: 100 Econ %: 100 Other %: 100 Exception: 0 Adjust: Adjust RMV: 0

Floors

Type	Class	Display Group	Floor Size	Beds	Baths	Yr Blt	Eff Yr Blt	Inventory	Exception
Lean-to Light Duty	4	Finished	288	0	0	1986	1986		Y N

NC

Accessories

Description	Class	Size SqFt	Eff Yr Blt	RMV	Quantity
No accessory data available					

Bldg: 3 Code Area: 92410 Stat Class: 351 Year Blt: 2000 Eff Year Blt: 2000 Sq.Ft: 900 % Complete: 100
 Desc: General Purpose Building (GB) Dimensions: 30x30 RMV: 11190
 Func Obsc: 100 Econ %: 100 Other %: 100 Exception: 0 Adjust: Adjust RMV: 0

Floors

Type	Class	Display Group	Floor Size	Beds	Baths	Yr Blt	Eff Yr Blt	Inventory	Exception
General Purpose Bldg	5	Finished	900	0	0	2000	2000	FAIR	Y N

60%

2004

Accessories

Description	Class	Size SqFt	Eff Yr Blt	RMV	Quantity
No accessory data available					

Bldg: 4 Code Area: 92410 Stat Class: 351 Year Blt: 2014 Eff Year Blt: 2014 Sq.Ft: 1840 % Complete: 100
 Desc: General Purpose Building (GB) Dimensions: 46x40 RMV: 35520
 Func Obsc: 100 Econ %: 100 Other %: 100 Exception: 0 Adjust: Adjust RMV: 0

NSU

Floors

Type	Class	Display Group	Floor Size	Beds	Baths	Yr Blt	Eff Yr Blt	Inventory	Exception: Y N
General Purpose Bldg	5	Finished	1840	0	0	2014	2014	AVG	

Accessories

Description	Class	Size SqFt	Eff Yr Blt	RMV	Quantity
No accessory data available					

Bldg: 5 Code Area: 92410 Stat Class: 351 Year Blt: 2021 Eff Year Blt: 2021 Sq.Ft: 1728 % Complete: 100
 Desc: General Purpose Building (GB) Dimensions: 36x48 RMV: 34580
 Func Obsc: 100 Econ %: 100 Other %: 100 Exception: 0 Adjust: Adjust RMV: 0

Floors

Type	Class	Display Group	Floor Size	Beds	Baths	Yr Blt	Eff Yr Blt	Inventory	Exception: Y N
General Purpose Bldg	5	Finished	1728	0	0	2021	2021	FAIR	

2021

FAIR

Yo

Accessories

Description	Class	Size SqFt	Eff Yr Blt	RMV	Quantity
No accessory data available					

SKETCH/AREA TABLE ADDENDUM

SUBJECT INFO

File No.: 524709 Parcel No.: 072W36B 00400
 Property Address: 375 HOWELL PRAIRIE RD SE
 City: SALEM County: State: OR ZipCode: 97317
 Owner:
 Client: Client Address:
 Appraiser Name: Inspection Date:

SKETCH

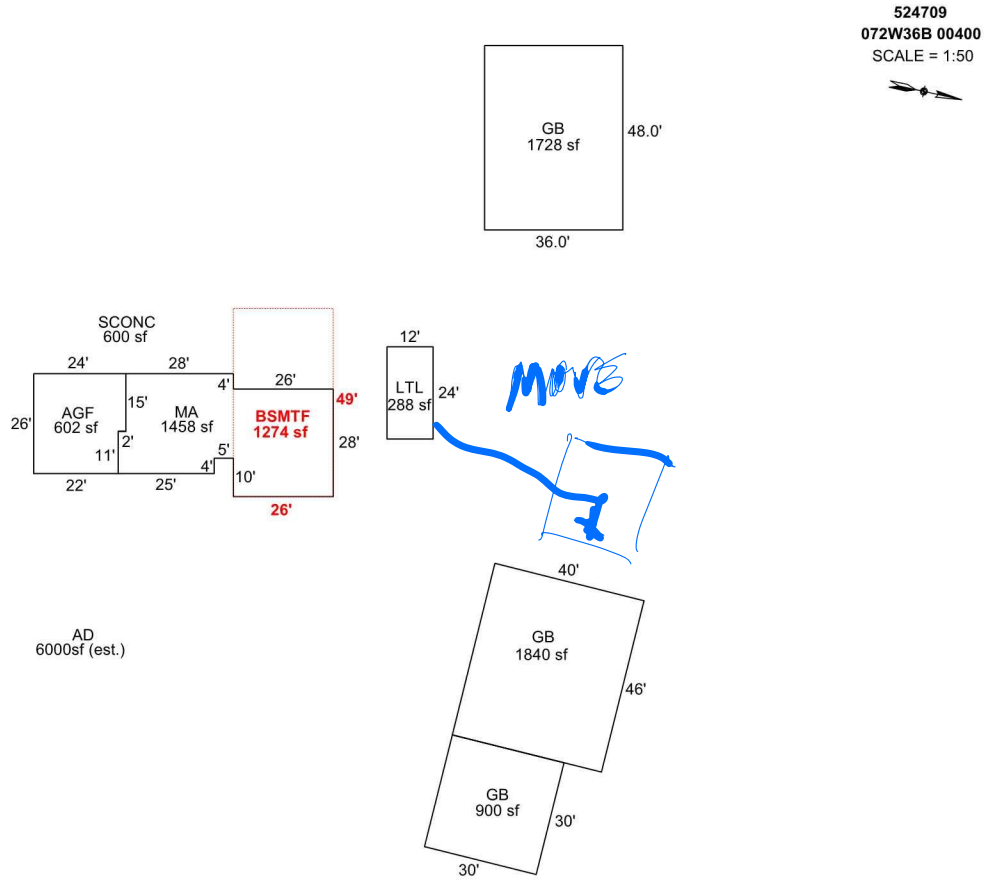

Sketch by Apex Sketch

AREA CALCULATIONS SUMMARY

Code	Description	Factor	Net Size	Perimeter	Net Totals
GBA1	LTL	1.0	288.0	72.0	
	GB	1.0	1840.0	172.0	
	GB	1.0	900.0	120.0	
	GB	1.0	1728.0	168.0	4756.0
GLA1	MA	1.0	1458.0	184.0	1458.0
BSMT	BSMTF	1.0	1274.0	150.0	1274.0
GAR	AGF	1.0	602.0	100.0	602.0

COMMENT TABLE 1

Updated by CW 2/2/15
 UPDATED BY CJURAN 07/13/2021 555-21-004766
 UPDATED BY CJURAN 12/23/2021

COMMENT TABLE 2

KH 90 01/07/2015
 #29 JS 07/01/2021

COMMENT TABLE 3

TAGS
 SV L3

Net LIVABLE	cnt	1	(rounded)	1,458
Net BUILDING	cnt	4	(rounded)	4,756

TAKE
 SV L4
 8-29-24