

Acct ID: 528290 MTL: 081W180001000 Date: 11/7/23 Appr: MDL Prop Class: 559 RMV Prop Class: ~~559~~ **509**  
 Situs: 10173 KEENE LN SE AUMSVILLE OR 97325 MaSaNh: 07 06 000 Unit: 50780 Year: ~~2023~~ **2024**  
 Last Date Appraised: 09/15/2016 Appraiser: MATT LORD Retag: Y  Tag info: \_\_\_\_\_  
 Owner: SILBERNAGEL, IVAN P & Roll Type: R  
 Cycle  Tag Sales Verification Other: \_\_\_\_\_ Inspection level: 1 2 3  4 LCB TTO INSP AV: 72467  
 RMV Land: 235940 RMV Imp: 46500 RMV Total: 282440 MAV: 109420 MSAV: 26177 SAV: 37133  
 Comment: \_\_\_\_\_

INPUT 11/30/23 MDL

Notations 24-25: Expiring adjudication / Next Appraisal should be 11/25

RP/MS	Code	Description
MS	ADJ	ADJUDICATION
MS	ZONED	FARM EFU ZONED

Corrected permit

\*\* 24-25 SPLIT MA/MA2 ADDN ON MFG TO OWN STAT PORPORTION ENTERED VALUE TO MAINTAIN ADJUDICATION WW

OSDs

Count	Code	Description	RMV	Code Area	Exception
1	SAN	SA OSD - NO LANDSCAPE	30000	05558	0

Land

Site: 1	Code Area: 05558	Size: 1.00 Acres	Use Code: 005	Zone: REST	SAV Use: 011	Exception: 0
Class: <b>2HD</b>	Value Source: Farm Homesite	Description:			RMV: 10870	Exception: Y N
Adjustment(s):	GSOIL, WASTE	Fire Patrol:		Description:		
Comments: Liability year - 2009 / 17-18: REV #T16-66 CHG OSD AND SOIL CLASS// 02-03: REAPPRAISAL						
Site: 2	Code Area: 05558	Size: 10.45 Acres	Use Code: 005	Zone: REST	SAV Use: 011	Exception: 0
Class: 4HD	Value Source: Farm Use - EFU	Description: FOUR HILL DRY			RMV: 113550	Exception: Y N
Adjustment(s):	GSOIL, WASTE	Fire Patrol:		Description:		
Comments: Liability year - 1989 / 560050: 01-02; CHANGED SOIL CLASS FROM 3 HILL DRY TO 4 HILL DRY						
Site: 3	Code Area: 05558	Size: <del>15.74</del> <b>14.44</b> Acres	Use Code: 005	Zone: REST	SAV Use: 011	Exception: 0
Class: WST	Value Source: Farm Use - EFU	Description: Rural WASTELAND			RMV: 5030	Exception: Y N
Adjustment(s):	GSOIL, WASTE	Fire Patrol:		Description:		
Comments: Liability year - 1989 <b>1.0 Water WST (pond)</b>						
Site: 4	Code Area: 05558	Size: 6.40 Acres	Use Code: 005	Zone: REST	SAV Use: 011	Exception: 0
Class: 2HD	Value Source: Farm Use - EFU	Description: TWO HILL DRY			RMV: 76490	Exception: Y N
Adjustment(s):	GSOIL, WASTE	Fire Patrol:		Description:		
Comments: Liability year - 1989						

Improvements - Residence / Manufactured Structures

Bldg: 2	Code Area: 05558	Stat Class: 444	Year Blt: 1991	Eff Year Blt: 1991	Sq.Ft: 2244	% Complete: 100
Desc: MANUF STRUCT, CLASS 4, 14' WIDE SINGLE			Dimensions:		RMV: 33800	
Func Obsc: 100	Econ %: 100	Other %: 100	Exception: 0	Adjust:	Adjust RMV: 0	

Floors

Type	Class	Display Group	Floor Size	Beds	Baths	Yr Blt	Eff Yr Blt	Inventory	Exception
First Floor	4	Finished	1584	1	FB-1	1991	1991	FP, SKRT+, ROOF, HVAC, KIT-, BATH - 1	Y N
Second Floor	4	Finished	660	1	0	1991	1900		Y N

Accessories

Description	Class	Size SqFt	Eff Yr Blt	RMV	Quantity	Exception
YARD IMPROVEMENTS AVERAGE	4	1	1991	9842	1	Y N

Improvements - Accessory Buildings

Bldg: 1	Code Area: 05558	Stat Class: 341	Year Blt: 1973	Eff Year Blt: 1973	Sq.Ft: 480	% Complete: 100
Desc: Multi Purpose Shed (MP)			Dimensions: 24x20		RMV: 800	
Func Obsc: 100	Econ %: 100	Other %: 100	Exception: 0	Adjust:	Adjust RMV: 0	

Floors

Type	Class	Display Group	Floor Size	Beds	Baths	Yr Blt	Eff Yr Blt	Inventory	Exception
Multi-Purpose Bldg	5	Finished	480	0	0	1973	1973	FAIR	Y N

Accessories

Description	Class	Size SqFt	Eff Yr Blt	RMV	Quantity	Exception
No accessory data available						

Bldg: 3	Code Area: 05558	Stat Class: 301	Year Blt:	Eff Year Blt:	Sq.Ft: 36	% Complete: 100
Desc: Accessory Improvements & Misc.			Dimensions: 6x6		RMV: 0	

Func Obsc: 100

Econ %: 100

Other %: 100

Exception: 0

Adjust:

Adjust RMV: 0

**Floors**

Type	Class	Display Group	Floor Size	Beds	Baths	Yr Blt	Eff Yr Blt	Inventory	Exception: Y N
Pump House	0	Finished	36	0	0	0	0		

**Accessories**

Description	Class	Size SqFt	Eff Yr Blt	RMV	Quantity
No accessory data available					

Bldg: 4    Code Area: 05558    Stat Class: 352    Year Blt: 2001    Eff Year Blt: 1973    Sq.Ft: 2400    % Complete: 100  
 Desc: Utility Building (UB)    Dimensions: 40x60    RMV: 5900  
 Func Obsc: 100    Econ %: 100    Other %: 100    Exception: 0    Adjust:    Adjust RMV: 0

**Floors**

Type	Class	Display Group	Floor Size	Beds	Baths	Yr Blt	Eff Yr Blt	Inventory	Exception: Y N
Utility Building	5	Finished	2400	0	0	2001	1973	FAIR	

**Accessories**

Description	Class	Size SqFt	Eff Yr Blt	RMV	Quantity
No accessory data available					

Bldg: 5    Code Area: 05558    Stat Class: 351    Year Blt: 2005    Eff Year Blt: 2005    Sq.Ft: 864    % Complete: 100  
 Desc: General Purpose Building (GB)    Dimensions: 24x36    RMV: 6000  
 Func Obsc: 100    Econ %: 100    Other %: 100    Exception: 0    Adjust:    Adjust RMV: 0

**Floors**

Type	Class	Display Group	Floor Size	Beds	Baths	Yr Blt	Eff Yr Blt	Inventory	Exception: Y N
General Purpose Bldg	6	Finished	864	0	0	2005	2005	FAIR	

**Accessories**

Description	Class	Size SqFt	Eff Yr Blt	RMV	Quantity
No accessory data available					

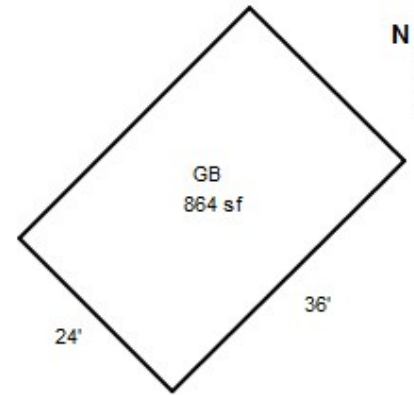

↑  
APPROX 1600' BETWEEN GB AND UB  
GB IS LOCATED AT THE NORTHERN EDGE OF THE LOT  
↓

PH  
6X6  
NAV

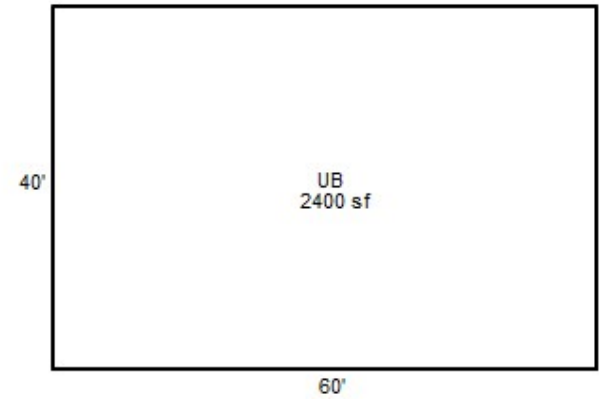
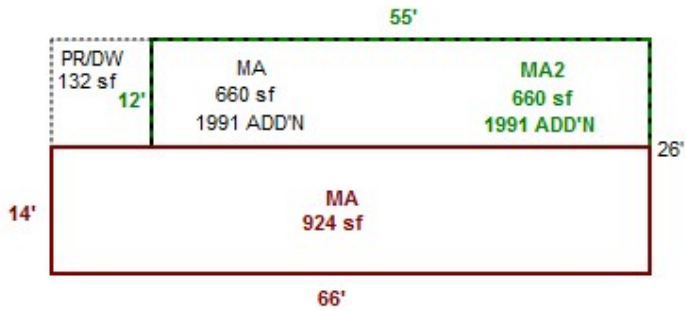



R28290

MA & MA2 S.SIDE

5/20/16



R28290

UB 40X60 & MP 24X20 N.SIDE

5/20/16



R28290  
MA & MA2 N.SIDE

5/20/16



R28290  
PH N/V

5/20/16



R28290  
PR/DW

5/20/16



R28290  
MA & MA2 W.SIDE

5/20/16



R28290

GB 36X24

11/8/16



R28290

MP 24X20

11/8/16