

Acct ID: 528702 MTL: 081W31B002500 Date: 2/2/24 Appr: MDL Prop Class: 409 RMV Prop Class: 409
 Situs: 8410 HOLMQUIST RD SE AUMSVILLE OR 97325 MaSaNh: 07 06 000 Unit: 89904 Year: ~~2023~~ 2024
 Last Date Appraised: 07/13/2021 Appraiser: MATT LORD Retag: Y N Tag info: 2024 - NEW CONSTRUCTION (Garage/Carport)
 Owner: ROWLAND, VICTOR C Roll Type: R
 Cycle: Tag Sales Verification Other: _____ Inspection level: 1 2 3 4 LCB TTO INSP AV: 180160
 RMV Land: 183160 RMV Imp: 494681 RMV Total: 677841 MAV: 180160 MSAV: 0 6ated SAV: 0
 Comment: LEVEL 4 7.13.21 CL10

Notations 24-25: (23-001661) 24x36 ~~DBF~~ 100% complete

OSDs

Count	Code	Description	RMV	Code Area	Exception
1	MKTA	OSD - AVERAGE	45000	05555	0

Land

Site: 1	Code Area: 05555	Size: 1.00 Acres	Use Code: 004	Zone: NREST	SAV Use:	Exception: 0
Class: 48D	Value Source: Rural at MKT	Description: FOUR BENCH DRY			RMV: 83230	Exception: Y N
Adjustment(s):		Fire Patrol:		Description:		
Comments:	22-23: Disq farm use 2002-03 REAPPRAISAL; 2003-04 MODIFIED LAND TABLE KKB65 10/02					
Site: 3	Code Area: 05555	Size: 0.66 Acres	Use Code: 004	Zone: NREST	SAV Use:	Exception: 0
Class: 48D	Value Source: Rural at MKT	Description: FOUR BENCH DRY			RMV: 54930	Exception: Y N
Adjustment(s):		Fire Patrol:		Description:		
Comments:						

Improvements - Residence / Manufactured Structures

Bldg: 1	Code Area: 05555	Stat Class: 468	Year Blt: 2014	Eff Year Blt: 2014	Sq.Ft: 2316	% Complete: 100
Desc: MANUF STRUCT, CLASS 6, 36' WIDE TRIPLE/QUAD					Dimensions:	RMV: 479461
Func Obsc: 100	Econ %: 100	Other %: 240	Exception: 0	Adjust:	Adjust RMV: 0	

Floors

Type	Class	Display Group	Floor Size	Beds	Baths	Yr Blt	Eff Yr Blt	Inventory	Exception
First Floor	6	Finished	2316	4	FB-3	2014	2014	SKRT+, HVAC+, KIT-, BATH - 3, ROOF	Y N

Accessories

Description	Class	Size SqFt	Eff Yr Blt	RMV	Quantity	Exception
DECK	6	84	2014	3770	0	Y N
ROOF EXTENSION OR PATIO COVER	6	84	2014	4969	0	Y N

Improvements - Accessory Buildings

Bldg: 1	Code Area: 05555	Stat Class: 351	Year Blt: 1990	Eff Year Blt: 1990	Sq.Ft: 1296	% Complete: 100
Desc: General Purpose Building (GB)					Dimensions: 36x36	RMV: 5550
Func Obsc: 100	Econ %: 100	Other %: 100	Exception: 0	Adjust:	Adjust RMV: 0	

Floors

Type	Class	Display Group	Floor Size	Beds	Baths	Yr Blt	Eff Yr Blt	Inventory	Exception
General Purpose Bldg	4	Finished	1296	0	0	1990	1990		Y <u>N</u>

Accessories

Description	Class	Size SqFt	Eff Yr Blt	RMV	Quantity	Exception
No accessory data available						

Bldg: 2	Code Area: 05555	Stat Class: 341	Year Blt: 2005	Eff Year Blt: 2005	Sq.Ft: 396	% Complete: 100
Desc: Multi Purpose Shed (MP)					Dimensions: 18x22	RMV: 9670
Func Obsc: 100	Econ %: 100	Other %: 100	Exception: 0	Adjust:	Adjust RMV: 0	

Floors

Type	Class	Display Group	Floor Size	Beds	Baths	Yr Blt	Eff Yr Blt	Inventory	Exception
Multi-Purpose Bldg	6	Finished	396	0	0	2005	2005	FAIR	Y N

Accessories

Description	Class	Size SqFt	Eff Yr Blt	RMV	Quantity	Exception
No accessory data available						

ACCOUNT # 528702 DATE: 2/2/24 RMV CLASS 401 PROP CLASS 409
 MTL 01W 31B 2500 APPR MN TAG Y N
 COMMENTS: _____

RESIDENCE / MANUFACTURED STRUCTURES

ACCESSORY IMPROVEMENTS / OUTBUILDINGS

STAT _____ QLTY + - FLOOR _____
 AREA _____ EFF AREA _____ BED _____
 ROOF + HVAC +
 BATH PKG: _____ BATH _____ BATH + _____ 1/2 BTH
 FIREPLACE: _____
 KITCHEN - +
 YR BLT _____ EFF YR _____ ECON _____
 % COMP _____ % GOOD _____ FUNC _____
 EXCEPT Y N LUMP SUM: _____
 MISC: _____
 YI CLASS _____ F G A E
 SKIRT + LIN FT _____
 COMMENT: _____

TYPE DBF
 STAT / CLASS 4
 SIZE 864
24x36
 FAIR
AVERAGE
 GOOD
 EXCELLENT
 BATH _____
 YR BLT 2023
 EFF YR 2023
 % COMP 100
 EXCEPT Y N
 MISC: _____
 COMMENT: _____

TYPE _____
 STAT / CLASS _____
 SIZE _____
 FAIR
 AVERAGE
 GOOD
 EXCELLENT
 BATH _____
 YR BLT _____
 EFF YR _____
 % COMP _____
 EXCEPT Y N
 MISC: _____
 COMMENT: _____

STAT _____ QLTY + - FLOOR _____
 AREA _____ EFF AREA _____ BED _____
 ROOF + HVAC +
 BATH PKG: _____ BATH _____ BATH + _____ 1/2 BTH
 FIREPLACE: _____
 KITCHEN - +
 YR BLT _____ EFF YR _____ ECON _____
 % COMP _____ % GOOD _____ FUNC _____
 EXCEPT Y N LUMP SUM: _____
 MISC: _____
 YI CLASS _____ F G A E
 SKIRT + LIN FT _____
 COMMENT: _____

TYPE _____
 STAT / CLASS _____
 SIZE _____
 FAIR
 AVERAGE
 GOOD
 EXCELLENT
 BATH _____
 YR BLT _____
 EFF YR _____
 % COMP _____
 EXCEPT Y N
 MISC: _____
 COMMENT: _____

TYPE _____
 STAT / CLASS _____
 SIZE _____
 FAIR
 AVERAGE
 GOOD
 EXCELLENT
 BATH _____
 YR BLT _____
 EFF YR _____
 % COMP _____
 EXCEPT Y N
 MISC: _____
 COMMENT: _____

STAT _____ QLTY + - FLOOR _____
 AREA _____ EFF AREA _____ BED _____
 ROOF + HVAC +
 BATH PKG: _____ BATH _____ BATH + _____ 1/2 BTH
 FIREPLACE: _____
 KITCHEN - +
 YR BLT _____ EFF YR _____ ECON _____
 % COMP _____ % GOOD _____ FUNC _____
 EXCEPT Y N LUMP SUM: _____
 MISC: _____
 YI CLASS _____ F G A E
 SKIRT + LIN FT _____
 COMMENT: _____

TYPE _____
 STAT / CLASS _____
 SIZE _____
 FAIR
 AVERAGE
 GOOD
 EXCELLENT
 BATH _____
 YR BLT _____
 EFF YR _____
 % COMP _____
 EXCEPT Y N
 MISC: _____
 COMMENT: _____

TYPE _____
 STAT / CLASS _____
 SIZE _____
 FAIR
 AVERAGE
 GOOD
 EXCELLENT
 BATH _____
 YR BLT _____
 EFF YR _____
 % COMP _____
 EXCEPT Y N
 MISC: _____
 COMMENT: _____

SKETCH/AREA TABLE ADDENDUM

SUBJECT INFO

File No.: 528702 / 353712 Parcel No.: 081W31B 02500
 Property Address: 8410 HOLMQUIST RD SE
 City: AUMSVILLE County: MARION State: OR ZipCode: 97325
 Owner:
 Client: Client Address:
 Appraiser Name: Inspection Date:

SKETCH

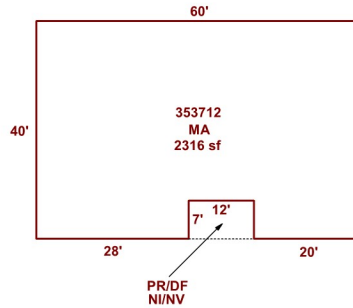
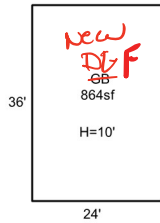
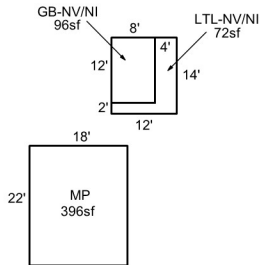
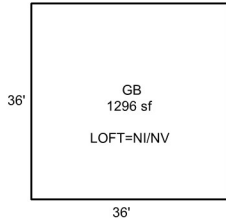

528702 / 353712
 081W31B 02500
 SCALE = 1:30

APEX UPDATED

Sketch by Apex Sketch

AREA CALCULATIONS SUMMARY

Code	Description	Factor	Net Size	Perimeter	Net Totals
GBA1	GB	1.0	1296.0	144.0	
	GB-NV/NI	1.0	96.0	40.0	
	LTL-NV/NI	1.0	72.0	52.0	
	MP	1.0	396.0	80.0	
GLA1	GB	1.0	864.0	120.0	2724.0
	MA	1.0	2316.0	214.0	2316.0
Net LIVABLE		cnt	1 (rounded)		2,316
Net BUILDING		cnt	5 (rounded)		2,724

COMMENT TABLE 1

DRAWN BY JRONDEMA 2/7/17
 UPDATED BY CJURAN 01/06/2021
 UPDATED BY CJURAN 04/04/2023 555-23-001661

COMMENT TABLE 2

#36 01/27/2017
 #10 CL 07/13/2021

MSL 2/2/24

COMMENT TABLE 3

TAGS
 SV L4
 L3 TAB





2/2/24