

# SKETCH/AREA TABLE ADDENDUM

## SUBJECT INFO

File No.: 597111 Parcel No.: 073W25AD10900  
 Property Address: 514 ILLINOIS AVE NE  
 City: SALEM County: State: OR ZipCode: 97301  
 Owner:  
 Client: Client Address:  
 Appraiser Name: Inspection Date:

## SKETCH

**597111**  
**073W25AD10900**

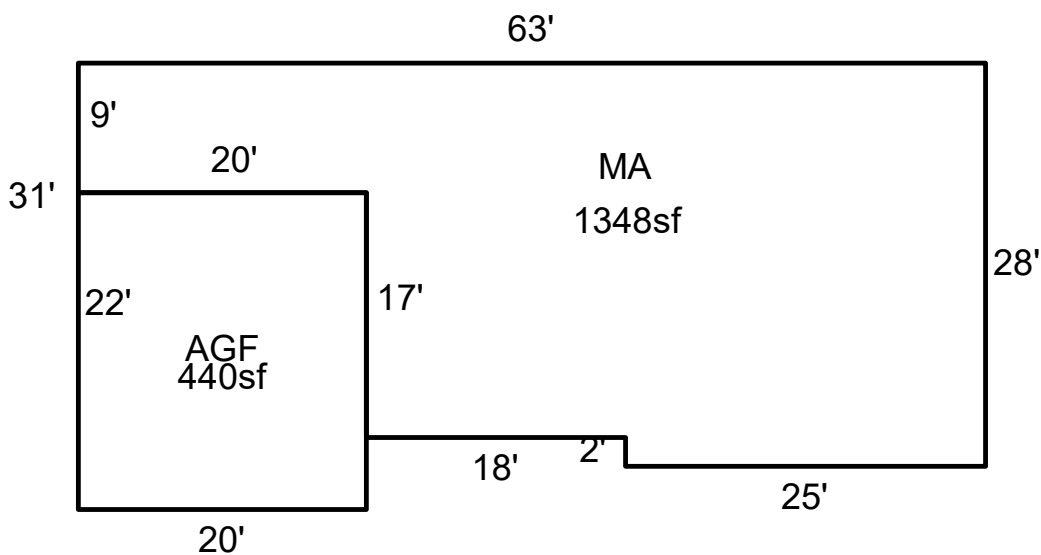

Sketch by ApexSketch

### AREA CALCULATIONS SUMMARY

Code	Description	Factor	Net Size	Perimeter	Net Totals
GLA1	MA	1.0	1348.0	182.0	1348.0
GARAGE	AGF	1.0	440.0	84.0	440.0

### COMMENT TABLE 1

DRAWN BY TJS 11-30-10  
 UPDATED BY LK 11.18.24

### COMMENT TABLE 2

10-7-24 TAG TS

### COMMENT TABLE 3

Net LIVABLE                      cnt                      0      (rounded)                      1,348