

lak 11.21.24

Summary

Lead Appr: _____ Clerk: _____ Lead Clerk: _____ Appr: _____

Print Date:

10/2/2024

Acct ID: 132152

MTL: 083W09DC00100P1

Date: 11/5/24 Appr: 02

ts 12-16-24

Prop Class: 019

RMV Prop Class: 019

Situs: 205 BOONE RD SE # 11 SALEM, OR 97306

MaSaNh: 16 05 000

Unit: 132152

Year: 2024

11.5.26

Last Date Appraised: 03/10/2017 Appraiser: THERESA SWEARINGEN Retag: Y N Tag info:

Owner: PIERCE, DOUGLAS

Roll Type: MS

Cycle Tag Sales Verification Other: _____ Inspection level: 1 2 3 4 LCB TTO INSP

AV: 52000

RMV Land: 0 RMV Imp: 67690 RMV Total: 67690 MAV: 52000 MSAV: 0

SAV: 0

Comment: BRISTOL PARK, SPACE #11, MS SERIAL # 1R910527EAB, X # X00216696, PERSONAL MS

Notations

update ENV I/O

No notation data available.

OSDs

No OSD data available.

Land

No land data available.

Improvements - Residence / Manufactured Structures

Bldg: 1 Code Area: 24010 Stat Class: 457 Year Blt: 1992 Eff Year Blt: 1992 Sq.Ft: 1404 % Complete: 100

Desc: MANUF STRUCT, CLASS 5, 26' THROUGH 28' WIDE DOUBLE

Dimensions: RMV: 67690

Func Obsc: 100 Econ %: 100 Other %: 100 Exception: 0 Adjust: Adjust RMV: 0

Floors

Type	Class	Display Group	Floor Size	Beds	Baths	Yr Blt	Eff Yr Blt	Inventory
First Floor	5	Finished	1374	2	FB-2	1992	1992	BATH - 2, KIT, HVAC, ROOF, SKIRT

Accessories

Description	Class	Size SqFt	Eff Yr Blt	RMV	Quantity
DECK	5	48	1992	306	0
MULTI-PURPOSE BUILDING	4	80	1992	0	0
ROOF EXTENSION OR PATIO COVER	5	408	1992	3431	0

Improvements - Accessory Buildings

No improvement data available for all other stat class types.

DW 30 I/O
PR 30 I/O



new roof
w/ new paint
new windows

M132152 083W09DC00100 Appr # 074 Date 3-10-17 Prop Class 019 Prop Code T57
 Situs Address 205 BOONE RD SE, #11 Franchise Code 04 Year For: 2017-2018
 Owner HAYS, SANDRA J &
 Notes: No change Tags Cycle Sales Verification Other: _____

RMV Imp: 18,070 RMV Total: 18,070 MSO Total: 18,070

Seg. Type	MA	Seg. #	1.1	Method	M04	Class	SD	Area	1404	Eff Area	1404	Length	Width
Make:	SKYLINE	Model:	SPRINGVIEW	Intfinish:	DRYWL	Roof Cover:	COMP						
Plumbing:	BATH2	Heat:	FA	Fireplace:		Inter. Comp:	H&F,DW,DSP	Bedrooms:	2				
Year Built:	1992	Eff. Year Built:	1992	Cond. P	F	A	G	E					
Adj Codes:	MSLCMD	Qty:	5	% Comp		Func		Econ		RMV	15,400		
Lump Sum		Except Code/Year		Comments									

Accessory Improvements

Seg. Type	PA	MFD STRUCT	Seg. #	1.3	Method:	R05	Class	Area	408	Eff Area	408
Length	34	Width	12	Foundation	Ex. Wall	Roof Cover					
Roof Style		Floor		Plumbing							
Year Built:		Eff. Year Built:	1992	Cond. P	F	A	G	E	% Comp	Econ	RMV: 2,030
Lump Sum		Except Code/Year		Comments							

Seg. Type	DF	MFD STRUCT	Seg. #	1.4	Method:	R05	Class	Area	48	Eff Area	48
Length	8	Width	6	Foundation	Ex. Wall	Roof Cover					
Roof Style		Floor		Plumbing							
Year Built:		Eff. Year Built:	1992	Cond. P	F	A	G	E	% Comp	Econ	RMV: 160
Lump Sum		Except Code/Year		Comments							

Out Buildings and Skirting

Seg. Type	MHSK	MFD STRUCT	Seg. #	1.2	Method:	M04	Class	Area	158	Eff Area	158
Length		Width		Foundation	Ex. Wall	WOOD	Roof Cover				
Roof Style		Floor		Plumbing							
Heat		Int. Comp.		Elect.	Yr. Bilt:	1992	Eff. Yr. Bilt:	1992			
Cond. P	F	A	G	E	Adj. Codes	% Comp	Func	Econ	RMV:	480	
Lump Sum		Except Code/Year		Comments							

Seg. Type	MP	MULTI/MISC PUR	Seg. #	2.1	Method:	F,N	Class	4	Area	80	Eff Area	80
Length	10	Width	8	Foundation	Ex. Wall	Roof Cover						
Roof Style		Floor	DIRT	Plumbing								
Heat		Int. Comp.		Elect.	Yr. Bilt:	1992	Eff. Yr. Bilt:	1992				
Cond. P	F	A	G	E	Adj. Codes	% Comp	Func	Econ	RMV:	0		
Lump Sum		Except Code/Year		Comments								

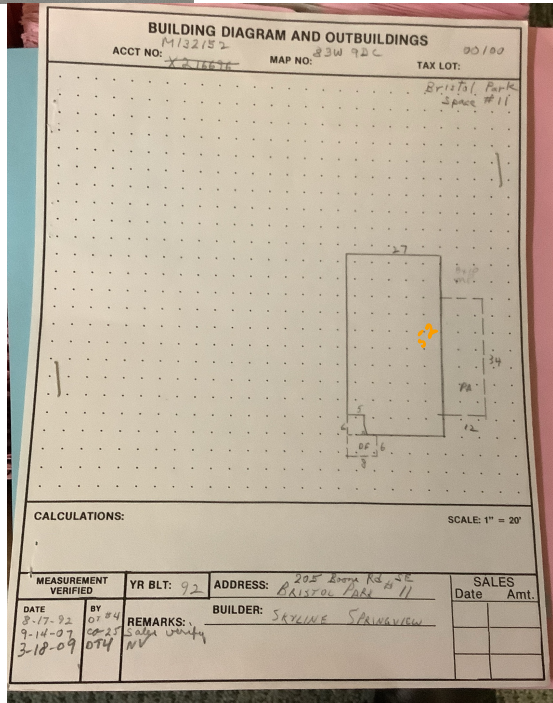



5-11-16 M132152



Marion County
OREGON
ASSESSOR'S OFFICE

Date Printed: 10/2/2024

Appraiser Sales Verification From

Primary Acct: 132152
MTL: 083W09DC00100
MaSaNh/P.Class: 1605000/019
Appraiser: THERESA
MS Acct: SWEARINGEN
132152

Situs: 205 BOONE RD SE # 11 SALEM, OR 97306

Grantor:
HAYS, SANDRA J & TURNER, OTIS E

Grantee:
PIERCE, DOUGLAS

Deed: MS
Accts In Sale: 1
Sale Date: 6/3/2024
Sale Price: 60,000
Code: 00
Ratio: 113

Total Sale RMV:
Land:
OSD:
Imp:
Grand Total: 67690

Attempt	Date/Time	Reason
1 st		
2 nd		

Contact: DOUGLAS Phone/email: FS on

- Was the property listed on the open market? Days: _____ MLS: — FS by Julie Y N
- Was property other than real estate included in the sale?
Describe: _____ Est. \$: _____ Y N
- Did the seller pay closing costs or make other concessions? \$ 3500 Repairs Q Y N
- Was the sale between related parties? (business or family) Y N
- Was this a distressed sale? E.g. foreclosure, short, court order, etc... Y N
- Condition at time of sale: | Poor | Fair | Avg. | Good | Exc. | Y N
Describe: _____
- Have any improvements been made since the time of sale? Y N
If yes, describe: over paid for condition

Comments: Dry Rot on Siding skirting

HAD INSPECTOR
WH / Fu.

Appraiser: 02 Date: 11/5/24