

Acct ID: 528112 MTL: 071W310000900 Date: **12-12-24** Appr: **CLUKE** Prop Class: 581 RMV Prop Class: 451  
 Situs: 9683 EDMUNSON DR SE SALEM OR 97317 MaSaNh: 01 06 000 Unit: 147073 Year: 2024  
 Last Date Appraised: 05/15/2024 Appraiser: CLINT LUKE Retag: Y **N** Tag info: 2025 - Tags/Permit (TAGS/PERMIT)  
 Owner: SPROUL, DOUGLAS W Roll Type: R  
 Cycle **0** Sales Verification Other: \_\_\_\_\_ Inspection level: 1 2 3 **4** LCB TTO INSP AV: 1425357  
 RMV Land: 310100 RMV Imp: 1806370 RMV Total: 2116470 MAV: 1396760 MSAV: 28597 SAV: 49017  
 Comment: 24-25 L4 5/15/24 CLUKE  
 23-24 L4 05.09.23 MLH

**FINISHED 10-18-24**

**Notations** **24-004748 EXPANDING 2 UPSTAIRS BEDROOMS**  
**NO MAIN FLOOR FOOTPRINT CHANGE**  
**2ND FLOOR EXPANDED**

**OSDs** **Chris 12/18/24**

Count	Code	Description	RMV	Code Area	Exception
1	SAE	SA OSD - EXCELLENT	65000	92410	0

**PUR TAG**

**Land**

Site: 1 Code Area: 92410 Size: 1.30 Acres Use Code: 005 Zone: REST SAV Use: 011 Exception: 0  
 Class: 4HD Value Source: Farm Homesite Description: FOUR HILL DRY RMV: 42520 Exception: Y N  
 Adjustment(s): H2OGR, WASTE Fire Patrol: Description:  
 Comments: Liability year - 2024 (was 1974)  
 24-25: Update land classes, enlarge homesite.  
 18-19: REINSTATE STF / 18-19: DISQ STF  
 04-05: PART TOTALS UPDATED 05-06: RECALC SETUP

Site: 2 Code Area: 92410 Size: 7.26 Acres Use Code: 005 Zone: REST SAV Use: 011 Exception: 0  
 Class: STFX Value Source: Small Tract Forest land Description: SMALL TRACT FORESTLAND X RMV: 7120 Exception: Y N  
 Adjustment(s): H2OGR, WASTE Fire Patrol: Description:  
 Comments: Liability year - 1978, STF - 2004  
 Pond

Site: 3 Code Area: 92410 Size: 1.00 Acres Use Code: 005 Zone: REST SAV Use: 011 Exception: 0  
 Class: 4HD Value Source: Farm Homesite Description: FOUR HILL DRY RMV: 147700 Exception: Y N  
 Adjustment(s): H2OGR, WASTE Fire Patrol: Description:  
 Comments: Liability year - 2009  
 22-23 CHANGED WATER ADJUSTMENT TO GOOD  
 99-2000: NEW HOMESITE 07-08: #31, ADD WATER ADJ

Site: 5 Code Area: 92410 Size: 1.39 Acres Use Code: 005 Zone: REST SAV Use: 011 Exception: 0  
 Class: 4HD Value Source: Farm Use - EFU Description: FOUR HILL DRY RMV: 45460 Exception: Y N  
 Adjustment(s): H2OGR, WASTE Fire Patrol: Description:  
 Comments: Liability year - 1978

Site: 6 Code Area: 92410 Size: 2.34 Acres Use Code: 005 Zone: REST SAV Use: 011 Exception: 0  
 Class: WST Value Source: WASTE RURAL Description: Rural WASTELAND RMV: 2300 Exception: Y N  
 Adjustment(s): H2OGR, WASTE Fire Patrol: Description:  
 Comments: Liability year - 1978

**Improvements - Residence / Manufactured Structures**

Bldg: 1 Code Area: 92410 Stat Class: 164 + Year Blt: 1976 Eff Year Blt: 1980 Sq.Ft: 5643 % Complete: 100  
 Desc: Multi Story above grade with basement Dimensions: RMV: 1237550  
 Func Obsc: 100 Econ %: 100 Other %: 100 Exception: 0 Adjust: Adjust RMV: 0

**Floors**

Type	Class	Display Group	Floor Size	Beds	Baths	Yr Blt	Eff Yr Blt	Inventory	Exception
First Floor	6 +	Finished	3206	2	FB-1/ HB-1	1976	1980	BATH - 1, BTH - 1, KIT-, HVAC, FP - 4, ROOF	Exception: Y N
Second Floor	6 +	Finished	<b>2030</b>	3	FB-2	1976	1980	BATH - 2, HVAC	Exception: <b>0</b> N
Basement	6 +	Finished	632	2	0	1976	1980	HVAC	Exception: Y N
Basement	6 +	Unfinished	1430	0	0	1976	1980		Exception: Y N
Carport Detached	6	Unfinished	1210	0	0	1976	1976	ROOF	Exception: Y N

**Accessories**

Description	Class	Size SqFt	Eff Yr Blt	RMV	Quantity	
YARD IMPROVEMENTS EXCELLENT	6	0	1980	50837	1	Exception: Y N

Bldg: 8 Code Area: 92410 Stat Class: 141 Year Blt: 2007 Eff Year Blt: 2007 Sq.Ft: 593 % Complete: 100  
 Desc: One Story Only Dimensions: RMV: 153340  
 Func Obsc: 100 Econ %: 100 Other %: 100 Exception: 0 Adjust: Adjust RMV: 0

*AK*

**Floors**

Type	Class	Display Group	Floor Size	Beds	Baths	Yr Blt	Eff Yr Blt	Inventory	
First Floor	4	Finished	593	0	FB-1	2007	2007	BATH - 1, KIT-, ROOF, HVAC	Exception: Y N

**Accessories**

Description	Class	Size SqFt	Eff Yr Blt	RMV	Quantity	
YARD IMPROVEMENTS FAIR	4	0	2007	15401	1	Exception: Y N

Bldg: 10 Code Area: 92410 Stat Class: 108 Year Blt: 2008 Eff Year Blt: 2008 Sq.Ft: 0 % Complete: 100  
 Desc: Residential Other Improvements Dimensions: RMV: 32660  
 Func Obsc: 100 Econ %: 100 Other %: 100 Exception: 0 Adjust: Adjust RMV: 0

*NC*

**Floors**

Type	Class	Display Group	Floor Size	Beds	Baths	Yr Blt	Eff Yr Blt	Inventory	
No floor data available									

**Accessories**

Description	Class	Size SqFt	Eff Yr Blt	RMV	Quantity	
PATIO	1	5234	2008	26772	1	Exception: Y N

Bldg: 11 Code Area: 92410 Stat Class: 108 Year Blt: 2008 Eff Year Blt: 2008 Sq.Ft: 0 % Complete: 100  
 Desc: Residential Other Improvements Dimensions: RMV: 42560  
 Func Obsc: 50 Econ %: 100 Other %: 100 Exception: 0 Adjust: Adjust RMV: 0

*NC*

**Floors**

Type	Class	Display Group	Floor Size	Beds	Baths	Yr Blt	Eff Yr Blt	Inventory	
No floor data available									

**Accessories**

Description	Class	Size SqFt	Eff Yr Blt	RMV	Quantity	
HOT TUB / SPA	1	120	2008	1395	1	Exception: Y N
SWIMMING POOL	1	1140	2008	33488	1	Exception: Y N

Bldg: 12 Code Area: 92410 Stat Class: 108 Year Blt: 2008 Eff Year Blt: 2008 Sq.Ft: 0 % Complete: 100  
 Desc: Residential Other Improvements Dimensions: RMV: 21960  
 Func Obsc: 100 Econ %: 100 Other %: 100 Exception: 0 Adjust: Adjust RMV: 0

*NC*

**Floors**

Type	Class	Display Group	Floor Size	Beds	Baths	Yr Blt	Eff Yr Blt	Inventory	
No floor data available									

**Accessories**

Description	Class	Size SqFt	Eff Yr Blt	RMV	Quantity	
MISCELLANEOUS	0	8215	2008	18000	1	Exception: Y N

Bldg: 13 Code Area: 92410 Stat Class: 108 Year Blt: 2008 Eff Year Blt: 2008 Sq.Ft: 0 % Complete: 100  
 Desc: Residential Other Improvements Dimensions: RMV: 14350  
 Func Obsc: 100 Econ %: 100 Other %: 100 Exception: 0 Adjust: Adjust RMV: 0

*NC*

**Floors**

Type	Class	Display Group	Floor Size	Beds	Baths	Yr Blt	Eff Yr Blt	Inventory	
No floor data available									

**Accessories**

Description	Class	Size SqFt	Eff Yr Blt	RMV	Quantity	
MISCELLANEOUS	0	0	2008	11760	1	Exception: Y N

Bldg: 15 Code Area: 92410 Stat Class: 158 Year Blt: 2018 Eff Year Blt: 2018 Sq.Ft: 0 % Complete: 100  
 Desc: Res other improvements Dimensions: RMV: 251810  
 Func Obsc: 100 Econ %: 100 Other %: 100 Exception: 0 Adjust: Adjust RMV: 0

*NC*

**Floors**

Type	Class	Display Group	Floor Size	Beds	Baths	Yr Blt	Eff Yr Blt	Inventory	
Garage Oversized Detached	5	Finished	2505	0	HB-1	2018	2018	BTH - 1, ROOF	Exception: Y N

**Accessories**

Description	Class	Size SqFt	Eff Yr Blt	RMV	Quantity	

Description	Class	Size SqFt	Eff Yr Blt	RMV	Quantity				
No accessory data available									
Bldg: 16 Code Area: 92410 Stat Class: 108 Year Blt: Eff Year Blt: 2007 Sq.Ft: 0 % Complete: 100 Desc: Residential Other Improvements Dimensions: RMV: 22650 Func Obsc: 100 Econ %: 100 Other %: 100 Exception: 0 Adjust: Adjust RMV: 0									
<b>Floors</b>									
<b>Type</b>	<b>Class</b>	<b>Display Group</b>	<b>Floor Size</b>	<b>Beds</b>	<b>Baths</b>	<b>Yr Blt</b>	<b>Eff Yr Blt</b>	<b>Inventory</b>	
No floor data available									
<b>Accessories</b>									
<b>Description</b>	<b>Class</b>	<b>Size SqFt</b>	<b>Eff Yr Blt</b>	<b>RMV</b>	<b>Quantity</b>				
ROOF EXTENSION OR PATIO COVER	1	696	2007	18569	0	Exception: Y N			

NC

**Improvements - Accessory Buildings**

Bldg: 3 Code Area: 92410 Stat Class: 341 Year Blt: 1995 Eff Year Blt: 1995 Sq.Ft: 64 % Complete: 100 Desc: Multi Purpose Shed (MP) Dimensions: 8x8 RMV: 110 Func Obsc: 100 Econ %: 100 Other %: 100 Exception: 0 Adjust: Adjust RMV: 0									
<b>Floors</b>									
<b>Type</b>	<b>Class</b>	<b>Display Group</b>	<b>Floor Size</b>	<b>Beds</b>	<b>Baths</b>	<b>Yr Blt</b>	<b>Eff Yr Blt</b>	<b>Inventory</b>	
Multi-Purpose Bldg	6	Finished	64	0	0	1995	1995	FAIR	Exception: Y N

NC

Description	Class	Size SqFt	Eff Yr Blt	RMV	Quantity
No accessory data available					

Bldg: 5 Code Area: 92410 Stat Class: 341 Year Blt: 1995 Eff Year Blt: 1995 Sq.Ft: 308 % Complete: 100 Desc: Multi Purpose Shed (MP) Dimensions: 28x11 RMV: 3260 Func Obsc: 100 Econ %: 100 Other %: 100 Exception: 0 Adjust: Adjust RMV: 0									
<b>Floors</b>									
<b>Type</b>	<b>Class</b>	<b>Display Group</b>	<b>Floor Size</b>	<b>Beds</b>	<b>Baths</b>	<b>Yr Blt</b>	<b>Eff Yr Blt</b>	<b>Inventory</b>	
Multi-Purpose Bldg	5	Finished	308	0	0	1995	1995	FAIR	Exception: Y N

NC

Description	Class	Size SqFt	Eff Yr Blt	RMV	Quantity
No accessory data available					

Bldg: 6 Code Area: 92410 Stat Class: 341 Year Blt: 1995 Eff Year Blt: 1995 Sq.Ft: 420 % Complete: 100 Desc: Multi Purpose Shed (MP) Dimensions: 21x20 RMV: 4220 Func Obsc: 100 Econ %: 100 Other %: 100 Exception: 0 Adjust: Adjust RMV: 0									
<b>Floors</b>									
<b>Type</b>	<b>Class</b>	<b>Display Group</b>	<b>Floor Size</b>	<b>Beds</b>	<b>Baths</b>	<b>Yr Blt</b>	<b>Eff Yr Blt</b>	<b>Inventory</b>	
Multi-Purpose Bldg	5	Finished	420	0	0	1995	1995	FAIR	Exception: Y N

NC

Description	Class	Size SqFt	Eff Yr Blt	RMV	Quantity
No accessory data available					

Bldg: 9 Code Area: 92410 Stat Class: 351 Year Blt: 2007 Eff Year Blt: 2007 Sq.Ft: 696 % Complete: 100 Desc: General Purpose Building (GB) Dimensions: RMV: 21900 Func Obsc: 100 Econ %: 100 Other %: 100 Exception: 0 Adjust: Adjust RMV: 0									
<b>Floors</b>									
<b>Type</b>	<b>Class</b>	<b>Display Group</b>	<b>Floor Size</b>	<b>Beds</b>	<b>Baths</b>	<b>Yr Blt</b>	<b>Eff Yr Blt</b>	<b>Inventory</b>	
General Purpose Bldg	6	Finished	696	0	0	2007	2007	GOOD	Exception: Y N

NC

Description	Class	Size SqFt	Eff Yr Blt	RMV	Quantity				
ROOF EXTENSION OR PATIO COVER	6	696	2007	4550	1	Exception: Y N			

# SKETCH/AREA TABLE ADDENDUM

## SUBJECT INFO

File No.: 528112 Parcel No.: 071W31 00900  
 Property Address: 9683 EDMUNSON DR SE  
 City: Salem County: Marion State: OR ZipCode: 97317  
 Owner:  
 Client: Client Address:  
 Appraiser Name: Inspection Date:

## SKETCH

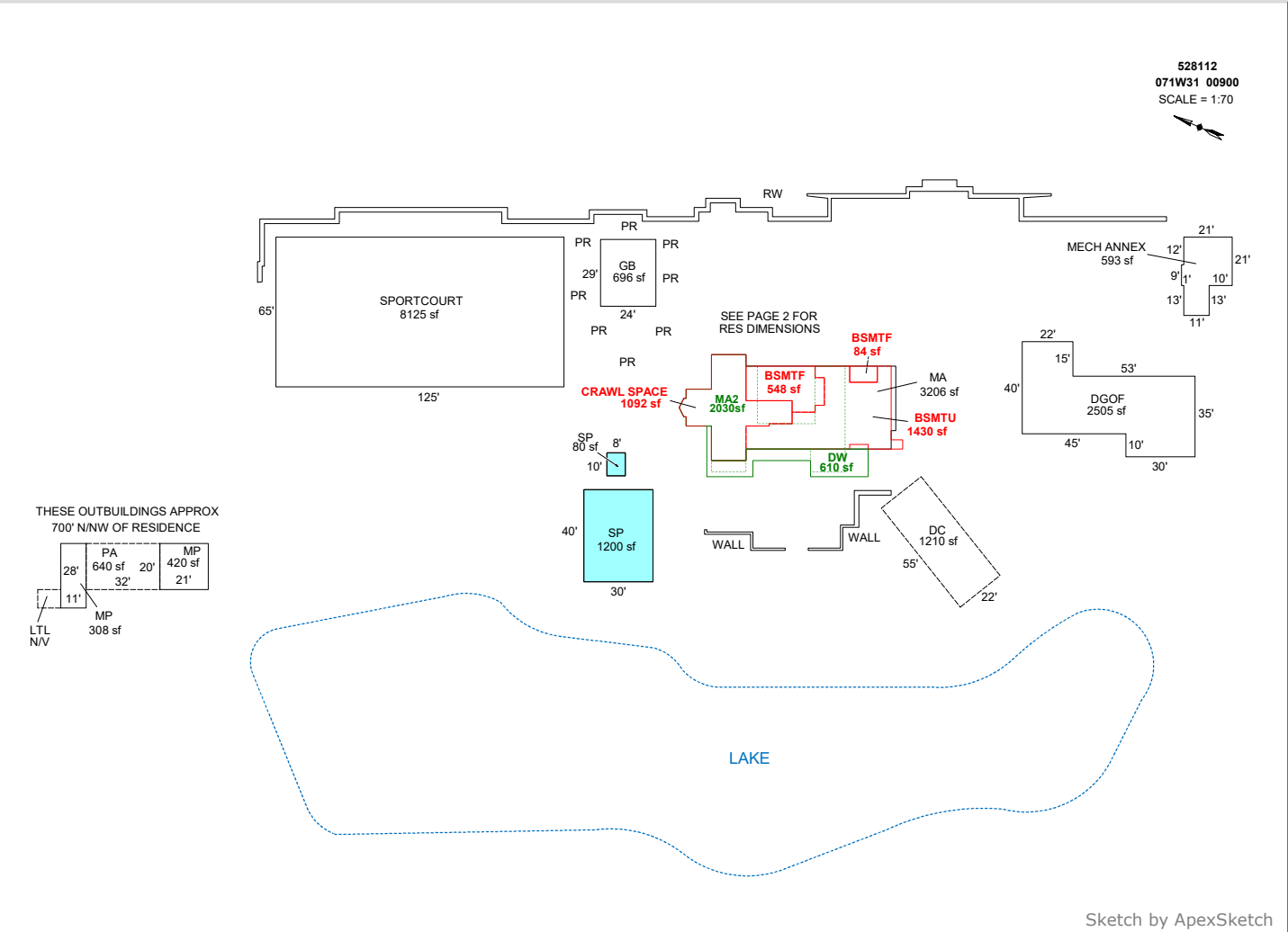

Sketch by ApexSketch

### AREA CALCULATIONS SUMMARY

Code	Description	Factor	Net Size	Perimeter	Net Totals
GBA1	MP	1.0	308.0	78.0	
	MP	1.0	420.0	82.0	728.0
GBA2	GB	1.0	696.0	106.0	696.0
GLA0	BSMTF	1.0	548.0	108.0	
	BSMTF	1.0	84.0	38.0	632.0
GLA1	MECH ANNEX	1.0	593.0	112.0	
	MA	1.0	3206.0	276.9	3799.0
GLA2	MA2	1.0	2030.0	312.9	2030.0
BSMT	BSMTU	1.0	1430.0	234.0	1430.0
GAR	DGOF	1.0	2505.0	250.0	
	DC	1.0	1210.0	154.0	3715.0
OTH	SP	1.0	1200.0	140.0	
	SP	1.0	80.0	36.0	
P/P	SPORTCOURT	1.0	8125.0	380.0	9405.0
	DW	1.0	610.0	208.0	
	PA	1.0	640.0	104.0	1250.0
	Net LIVABLE	cnt	3	(rounded)	6,461
	Net BUILDING	cnt	3	(rounded)	1,424

### COMMENT TABLE 1

APEX BY JH FROM PLANS 1-4-08  
 EDITED BY NRC 11/30/09 (PERMITS CANCELLED)  
 UPDATED BY JRONDEMA 3/8/16  
 UPDATED BY JRONDEMA 2/3/17  
 UPDATED BY JRONDEMA 4/2/19  
 UPDATED BY CJURAN 05/09/2023  
 UPDATED BY CLOBERG 09/13/24 24-004748 REV MA2

3.28.19 SR #94 TAGS  
 MLH 05/09/2023  
 Hence 12/2/24  
 TAGS 24

### COMMENT TABLE 2

### COMMENT TABLE 3

SV L4

# SKETCH/AREA TABLE ADDENDUM

## SUBJECT INFO

File No.: 528112 Parcel No.: 071W31 00900  
 Property Address: 9683 EDMUNSON DR SE  
 City: Salem County: Marion State: OR ZipCode: 97317  
 Owner:  
 Client: Client Address:  
 Appraiser Name: Inspection Date:

## SKETCH

528112  
071W31 00900  
SCALE = 1:20



SEE PAGE 1 FOR  
ALL BLDGS

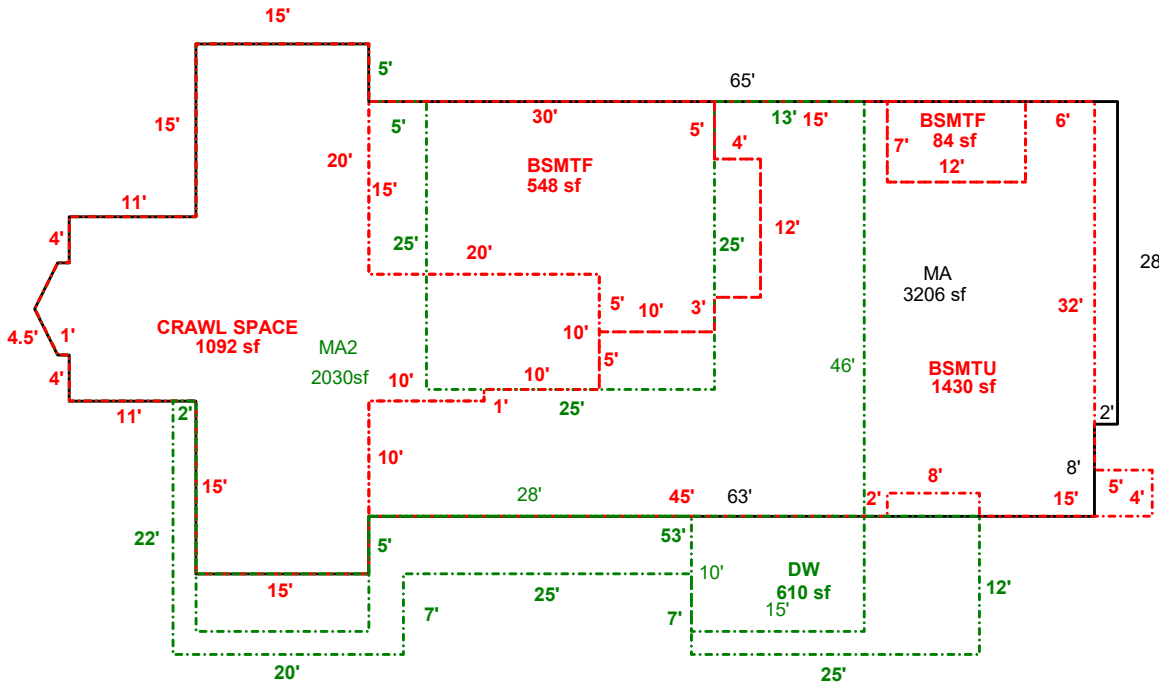

Sketch by ApexSketch

### AREA CALCULATIONS SUMMARY

Code	Description	Factor	Net Size	Perimeter	Net Totals
GLA0	BSMTF	1.0	84.0	38.0	
	BSMTF	1.0	548.0	108.0	632.0
GLA1	MA	1.0	3206.0	276.9	3206.0
GLA2	MA2	1.0	2030.0	312.9	2030.0
BSMT	BSMTU	1.0	1430.0	234.0	1430.0
P/P	DW	1.0	610.0	208.0	610.0

### COMMENT TABLE 1

APEX BY JH FROM PLANS 1-4-08  
 EDITED BY NRC 11/30/09 (PERMITS CANCELLED)  
 UPDATED BY JRONDEMA 3/8/16  
 UPDATED BY JRONDEMA 2/3/17  
 UPDATED BY JRONDEMA 4/2/19  
 UPDATED BY CJURAN 05/09/2023  
 UPDATED BY CLOBERG 09/13/24 24-004748 REV MA2

### COMMENT TABLE 2

3.28.19 SR #94 TAGS  
 MLH 05/09/2023

### COMMENT TABLE 3

SV L4

Net LIVABLE                      cnt                      2      (rounded)                      5,868