

Acct ID: 528672 MTL: 081W31C001900 Date: 9/26/24 Appr: MDL Prop Class: 401 RMV Prop Class: 401  
 Situs: 8825 HOLMQUIST RD SE AUMSVILLE OR 97325 MaSaNh: 07 06 000 Unit: 89874 Year: 2024  
 Last Date Appraised: 02/18/2021 Appraiser: MATT LORD Retag: Y (N) Tag info: 2025 - Tags/Permit (Alt Energy System)  
 Owner: CUEVAS, MAX J & CUEVAS, APRIL Roll Type: R  
 Cycle: (Tag) Sales Verification Other: \_\_\_\_\_ Inspection level: 1 2 (3) 4 LCB TTO INSP AV: 380370  
 RMV Land: 235120 RMV Imp: 500920 RMV Total: 736040 MAV: 380370 MSAV: 0 SAV: 0  
 Comment: 24=000104

**Notations** 25-26 TAB SOLAR \$14,700  
 No notation data available.

**OSDs**

Count	Code	Description	RMV	Code Area	Exception
1	MKTA	OSD - AVERAGE	45000	05555	0

**Land**  
 Site: 1 Code Area: 05555 Size: 2.09 Acres Use Code: 004 Zone: NREST SAV Use: Exception: 0  
 Class: HBD Value Source: Rural at MKT Description: RMV: 190120 Exception: Y N  
 Adjustment(s): Fire Patrol: Description:  
 Comments: 02-03: REAPP

**Improvements - Residence / Manufactured Structures**  
 Bldg: 1 Code Area: 05555 Stat Class: 142 Year Blt: 1979 Eff Year Blt: 1990 Sq.Ft: 3082 % Complete: 100  
 Desc: Multi Story above grade Dimensions: RMV: 432030  
 Func Obsc: 100 Econ %: 100 Other %: 100 Exception: 0 Adjust: Adjust RMV: 0

**Floors**

Type	Class	Display Group	Floor Size	Beds	Baths	Yr Blt	Eff Yr Blt	Inventory	Exception
First Floor	4	Finished	1792	2	FB-2	1979	1990	BATH - 2, KIT+, ROOF, HVAC+, FP - 2	Y N
Second Floor	4	Finished	1290	3	FB-1	1979	1990	BATH - 1, HVAC+	Y N

**Accessories** ABF 304 SQF 1979 1990  
ABF 480 " " " "

Description	Class	Size SqFt	Eff Yr Blt	RMV	Quantity	Exception
YARD IMPROVEMENTS GOOD	4	1	1979	29016	1	Y N

Bldg: 6 Code Area: 05555 Stat Class: 148 Year Blt: 1979 Eff Year Blt: 1979 Sq.Ft: 0 % Complete: 100  
 Desc: Res other improvements Dimensions: RMV: 23560  
 Func Obsc: 100 Econ %: 100 Other %: 100 Exception: 0 Adjust: Adjust RMV: 0

**Floors** ADD to MA

Type	Class	Display Group	Floor Size	Beds	Baths	Yr Blt	Eff Yr Blt	Inventory	Exception
<del>Carpport Attached</del> <u>ABF</u>	<del>4</del>	<del>Unfinished</del>	<del>480</del>	<del>0</del>	<del>0</del>	<del>1979</del>	<del>1979</del>	<del>ROOF</del>	<del>Y N</del>

**Accessories**

Description	Class	Size SqFt	Eff Yr Blt	RMV	Quantity
No accessory data available					

**Improvements - Accessory Buildings**  
 Bldg: 2 Code Area: 05555 Stat Class: 351 Year Blt: 1998 Eff Year Blt: 1998 Sq.Ft: 576 % Complete: 100  
 Desc: General Purpose Building (GB) Dimensions: 24x24 RMV: 8220  
 Func Obsc: 100 Econ %: 100 Other %: 100 Exception: 0 Adjust: Adjust RMV: 0

**Floors**

Type	Class	Display Group	Floor Size	Beds	Baths	Yr Blt	Eff Yr Blt	Inventory	Exception
General Purpose Bldg	6	Finished	576	0	0	1998	1998	FAIR	Y N

**Accessories**

Description	Class	Size SqFt	Eff Yr Blt	RMV	Quantity
No accessory data available					

Bldg: 3 Code Area: 05555 Stat Class: 351 Year Blt: 1995 Eff Year Blt: 1995 Sq.Ft: 1440 % Complete: 100  
 Desc: General Purpose Building (GB) Dimensions: 40x36 RMV: 11950  
 Func Obsc: 100 Econ %: 100 Other %: 100 Exception: 0 Adjust: Adjust RMV: 0

**Floors**

Type	Class	Display Group	Floor Size	Beds	Baths	Yr Blt	Eff Yr Blt	Inventory	Exception
No floor data available									

Type	Class	Display Group	Floor Size	Beds	Baths	Yr Blt	Eff Yr Blt	Inventory
General Purpose Bldg	5	Finished	1440	0	0	1995	1995	Fair Exception: Y N

**Accessories**

Description	Class	Size SqFt	Eff Yr Blt	RMV	Quantity
No accessory data available					

Bldg: 4 Code Area: 05555 Stat Class: 354 Year Blt: 1991 Eff Year Blt: 1991 Sq.Ft: 240 % Complete: 100  
 Desc: Lean-to Light (LTL) ✓ Dimensions: 10x24 RMV: 470  
 Func Obsc: 100 Econ %: 100 Other %: 100 Exception: 0 Adjust: Adjust RMV: 0

**Floors**

Type	Class	Display Group	Floor Size	Beds	Baths	Yr Blt	Eff Yr Blt	Inventory
Lean-to Light Duty	4	Finished	240	0	0	1991	1991	FAIR ✓ Exception: Y N

**Accessories**

Description	Class	Size SqFt	Eff Yr Blt	RMV	Quantity
No accessory data available					

Bldg: 5 Code Area: 05555 Stat Class: 341 Year Blt: 1991 Eff Year Blt: 1991 Sq.Ft: 224 % Complete: 100  
 Desc: Multi Purpose Shed (MP) Dimensions: 14x16 RMV: 2110  
 Func Obsc: 100 Econ %: 100 Other %: 100 Exception: 0 Adjust: Adjust RMV: 0

**Floors**

Type	Class	Display Group	Floor Size	Beds	Baths	Yr Blt	Eff Yr Blt	Inventory
Multi-Purpose Bldg	5	Finished	224	0	0	1991	1991	FAIR Exception: Y N

**Accessories**

Description	Class	Size SqFt	Eff Yr Blt	RMV	Quantity
No accessory data available					

Bldg: 7 Code Area: 05555 Stat Class: 353 Year Blt: 2000 Eff Year Blt: 2000 Sq.Ft: 2760 % Complete: 100  
 Desc: Machine Shed (MS) Dimensions: 30x92 RMV: 22580  
 Func Obsc: 100 Econ %: 100 Other %: 100 Exception: 0 Adjust: Adjust RMV: 0

**Floors**

Type	Class	Display Group	Floor Size	Beds	Baths	Yr Blt	Eff Yr Blt	Inventory
Machine Shed	5	Finished	2760	0	0	2000	2000	Fair Exception: Y N

**Accessories**

Description	Class	Size SqFt	Eff Yr Blt	RMV	Quantity
CONCRETE DRIVEWAY ✓	5	900	2010	3663	1

Handwritten notes:

- ABF 384 SQFT H Roof 1979 1990
- ABF 1480 SF H Roof 1979 1990

# SKETCH/AREA TABLE ADDENDUM

## SUBJECT INFO

File No.: 528672 Parcel No.: 081W31C 01900  
 Property Address: 8825 HOLMQUIST RD SE  
 City: AUMSVILLE County: MARION State: OR ZipCode: 97325  
 Owner:  
 Client: Client Address:  
 Appraiser Name: Inspection Date:

## SKETCH

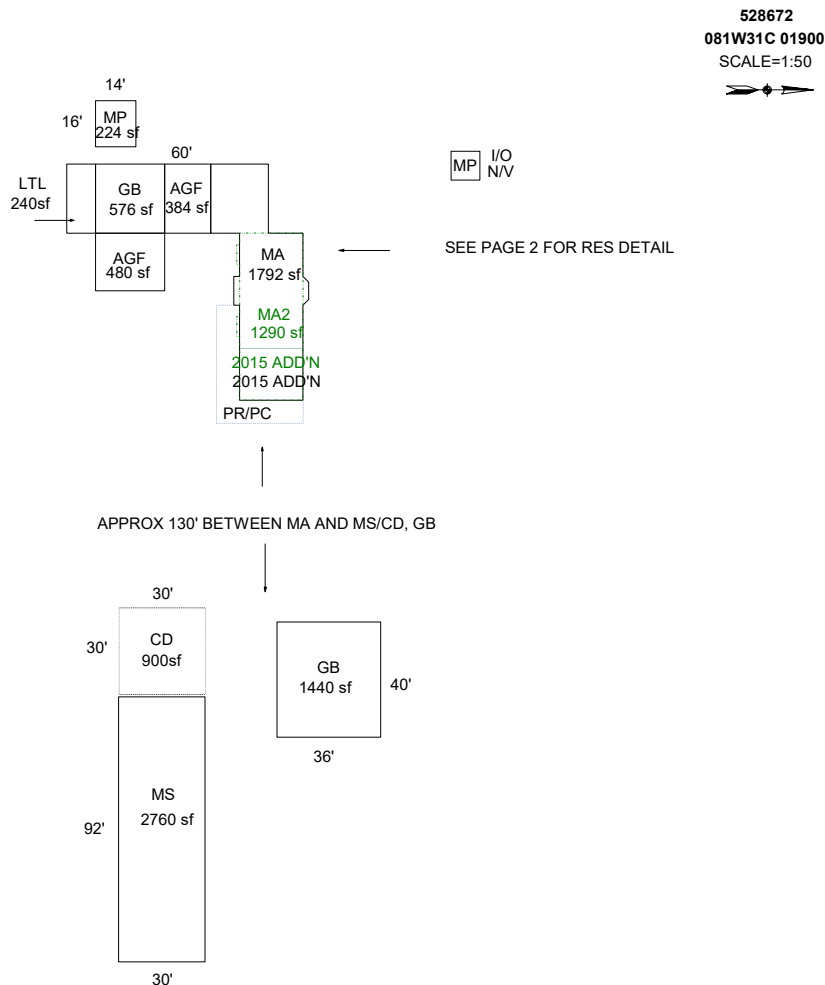

Sketch by ApexSketch

AREA CALCULATIONS SUMMARY						COMMENT TABLE 1	
Code	Description	Factor	Net Size	Perimeter	Net Totals		
GBA1	MP	1.0	224.0	60.0		DRAWN BY JRONDEMA 8/11/15 UPDATED BY JRONDEMA 4/12/17 UPD BY PHU 12.16.20: 555-20-004861 UPDATED BY CLOBERG 11/15/24	
	MS	1.0	2760.0	244.0			
	LTL	1.0	240.0	68.0	3224.0		
GBA2	GB	1.0	1440.0	152.0	1440.0		
GLA1	MA	1.0	1792.0	233.7			
	GB	1.0	576.0	96.0	2368.0		
GLA2	MA2	1.0	1290.0	164.0	1290.0		
GAR	AGF	1.0	384.0	80.0			
	AGF	1.0	480.0	88.0	864.0		
P/P	CD	1.0	900.0	120.0	900.0	<b>COMMENT TABLE 2</b>	<b>COMMENT TABLE 3</b>
						#36 DB 2.19.16 JS 29 3.21.16 MDL 09/26/24	TAGS SOLAR L4
	Net LIVABLE	cnt	0 (rounded)		3,658		
	Net BUILDING	cnt	4 (rounded)		4,664		

# SKETCH/AREA TABLE ADDENDUM

## SUBJECT INFO

File No.: 528672 Parcel No.: 081W31C 01900  
 Property Address: 8825 HOLMQUIST RD SE  
 City: AUMSVILLE County: MARION State: OR ZipCode: 97325  
 Owner:  
 Client: Client Address:  
 Appraiser Name: Inspection Date:

## SKETCH

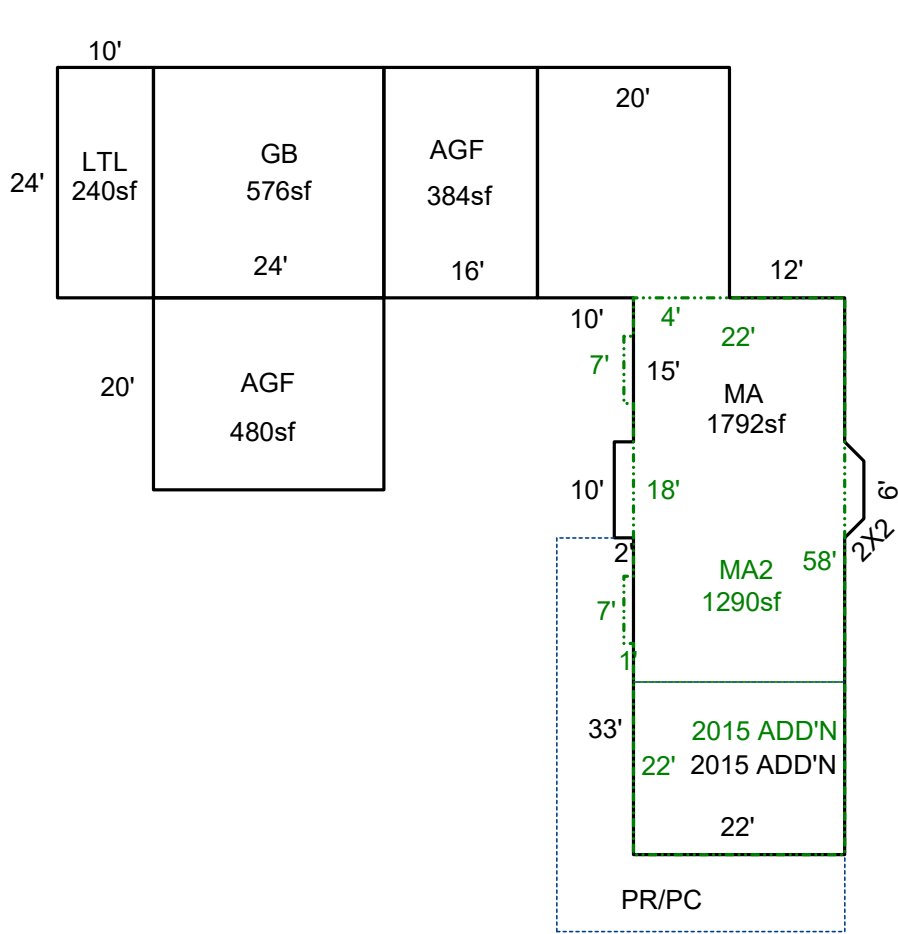

528672

081W31C 01900

SCALE=1:20



SEE PAGE 2 FOR ALL BLDGS

Sketch by ApexSketch

### AREA CALCULATIONS SUMMARY

Code	Description	Factor	Net Size	Perimeter	Net Totals
GBA1	LTL	1.0	240.0	68.0	240.0
GLA1	MA	1.0	1792.0	233.7	
	GB	1.0	576.0	96.0	2368.0
GLA2	MA2	1.0	1290.0	164.0	1290.0
GAR	AGF	1.0	480.0	88.0	
	AGF	1.0	384.0	80.0	864.0

### COMMENT TABLE 1

DRAWN BY JRONDEMA 8/11/15  
 UPDATED BY JRONDEMA 4/12/17  
 UPD BY PHU 12.16.20: 555-20-004861  
 UPDATED BY CLOBERG 11/15/24

### COMMENT TABLE 2

#36 DB 2.19.16  
 JS 29 3.21.16  
 MDL 09/26/24

### COMMENT TABLE 3

TAGS SOLAR L4

Net LIVABLE cnt 0 (rounded) 3,658  
 Net BUILDING cnt 1 (rounded) 240

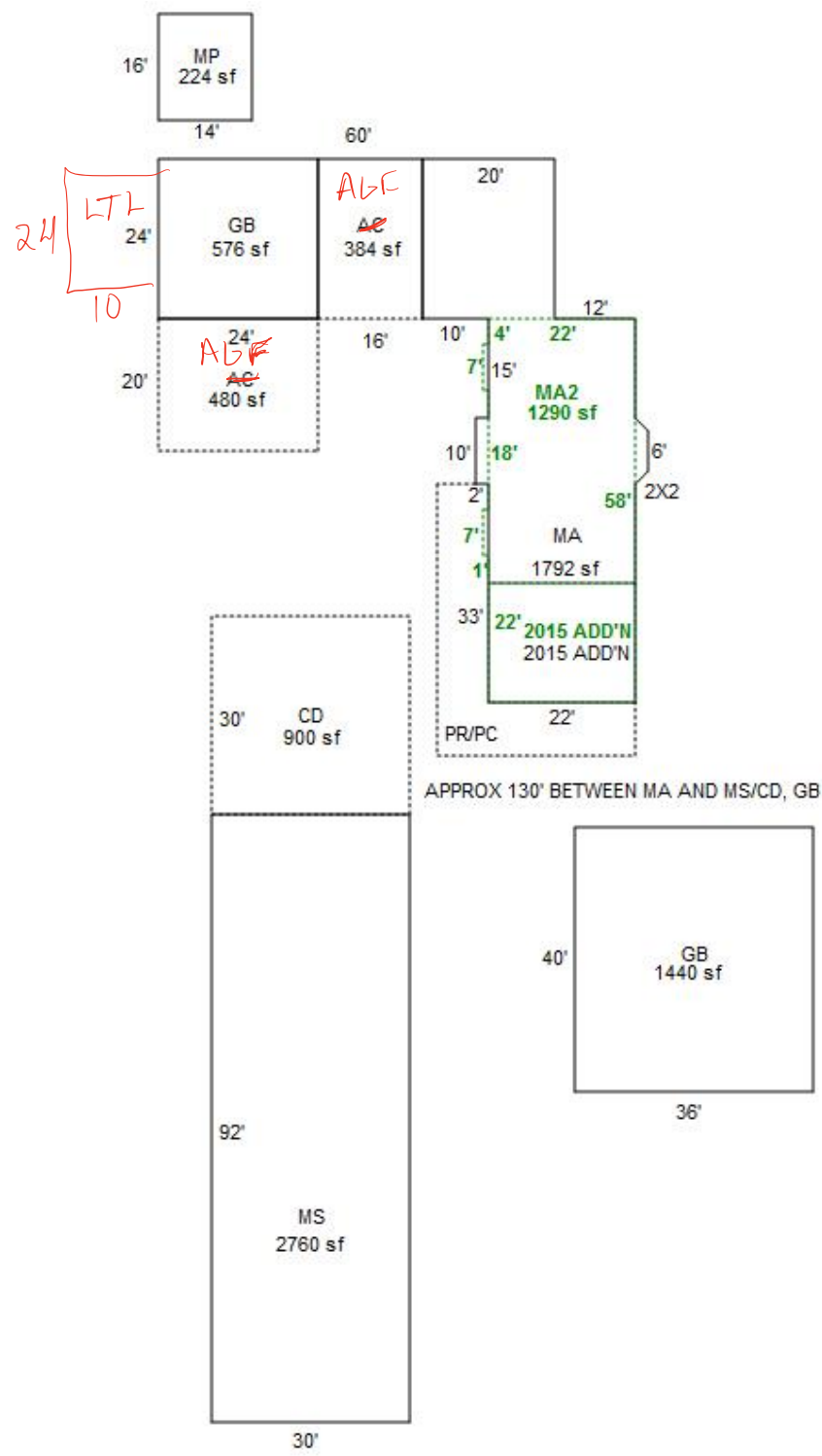

MP I/O N/V

R28672  
081W31C 01900  
SCALE=1:40



MDZ TAB  
L4 1/26/24



**3-21-17**

**R28672\_AC-GB**



**3-21-17**

**R28672\_GB\_40X36**



**3-21-17**

**R28672\_MA**



**3-21-17**

**R28672\_MS\_92X30**

