

**Summary** Lead Appr: \_\_\_\_\_ Clerk: **lak 1.21.25** Lead Clerk: **MBH 1/30/25** Appr: \_\_\_\_\_ Print Date: \_\_\_\_\_

Acct ID: 611155 MTL: 072W20BD00200P10 Date: **1/6/25** Appr: **02** ts **2-11-25** Prop Class: 019 RMV Prop Class: 019

Situs: 4915 SWEGLE RD NE # 69A SALEM, OR 97301 MaSaNh: 14 05 000 Unit: 149733 Year: 2025

Last Date Appraised: \_\_\_\_\_ Appraiser: THERESA SWEARINGEN Retag: Y **N** Tag info: 2025 - Tags/Permit (MS PLACEMENT)

Owner: A3436 Roll Type: MS

Cycle **Tag** Sales Verification Other: \_\_\_\_\_ Inspection level: 1 2 3 4 LCB TTO INSP AV: 0

RMV Land: 0 RMV Imp: 0 RMV Total: 0 MAV: 0 MSAV: 0 SAV: 0

Comment: \_\_\_\_\_

**Add new home**

**Notations**

No notation data available.

**OSDs**

No OSD data available.

**Land**

No land data available.

**Improvements - Residence / Manufactured Structures**

Bldg: 1 Code Area: 24620 Stat Class: 441 Year Blt: Eff Year Blt: Sq.Ft: 0 % Complete: 100

Desc: MANUF STRUCT, CLASS 4, 8'WIDE SINGLE Dimensions: RMV: 0

Func Obsc: 100 Econ %: 100 Other %: 100 Exception: 0 Adjust: Adjust RMV: 0

**Floors**

Type	Class	Display Group	Floor Size	Beds	Baths	Yr Blt	Eff Yr Blt	Inventory
------	-------	---------------	------------	------	-------	--------	------------	-----------

No floor data available

**Accessories**

Description	Class	Size SqFt	Eff Yr Blt	RMV	Quantity
-------------	-------	-----------	------------	-----	----------

No accessory data available

**Improvements - Accessory Buildings**

No improvement data available for all other stat class types.

**Askim  
141,995**

Prop ID # 611155  
 MTL 072W 70BD 00200  
 Tag? NO YES \_\_\_\_\_ Date 1-6-25

Prop Class 019 Pron Code 019  
 Situs 4915 SWEGLE RD NE # 69A SALEM, OR 97301  
 Brand: \_\_\_\_\_

Segment WVA State class 455  
 Roof: Roof + area 800  
 Heat: HVAC HVAC + \_\_\_\_\_  
 Plumbing: \_\_\_\_\_ Jettub \_\_\_\_\_ Grdntub \_\_\_\_\_  
 # of Fireplace(s): kit - / + \_\_\_\_\_  
 Interior comp: Cktp \_\_\_\_\_ Crng \_\_\_\_\_ Dsp \_\_\_\_\_ DW \_\_\_\_\_  
 H&F \_\_\_\_\_ Oven s/d \_\_\_\_\_ Micro \_\_\_\_\_ BIREF \_\_\_\_\_ Trash \_\_\_\_\_ Other \_\_\_\_\_  
 Bedrooms: \_\_\_\_\_ Qty 5  
 Yr Blt 2024 Eff Yr 2024 % Good \_\_\_\_\_  
 % Comp 100 Func \_\_\_\_\_ Econ \_\_\_\_\_  
 Except Code NEW Lump Sum \_\_\_\_\_  
 Comments \_\_\_\_\_

Segment \_\_\_\_\_ area \_\_\_\_\_  
 Roof: \_\_\_\_\_ Roof + \_\_\_\_\_  
 Heat: \_\_\_\_\_ HVAC + \_\_\_\_\_  
 Plumbing: \_\_\_\_\_ Jettub \_\_\_\_\_ Grdntub \_\_\_\_\_  
 # of Fireplace(s): \_\_\_\_\_  
 Interior comp: Cktp \_\_\_\_\_ Crng \_\_\_\_\_ Dsp \_\_\_\_\_ DW \_\_\_\_\_  
 H&F \_\_\_\_\_ Oven s/d \_\_\_\_\_ Micro \_\_\_\_\_ BIREF \_\_\_\_\_ Trash \_\_\_\_\_ Other \_\_\_\_\_  
 Bedrooms: \_\_\_\_\_ Qty \_\_\_\_\_  
 Yr Blt \_\_\_\_\_ Eff Yr \_\_\_\_\_ % Good \_\_\_\_\_  
 % Comp \_\_\_\_\_ Func \_\_\_\_\_ Econ \_\_\_\_\_  
 Except Code \_\_\_\_\_ Lump Sum \_\_\_\_\_  
 Comments \_\_\_\_\_

Segment MHSK Class \_\_\_\_\_ Lin FT 136  
 Skirting Wood Vinyl \_\_\_\_\_ Fbrgl \_\_\_\_\_ Metal \_\_\_\_\_  
 Skirting + \_\_\_\_\_ Cinder Block \_\_\_\_\_ Brick \_\_\_\_\_  
 Yr Blt 2024 Eff Yr 2024 % Good \_\_\_\_\_  
 % Comp 100 Func \_\_\_\_\_ Econ \_\_\_\_\_  
 Except Code new Lump Sum \_\_\_\_\_  
 Comments \_\_\_\_\_

Segment DW area 96  
 Roof: \_\_\_\_\_ Roof + \_\_\_\_\_  
 Heat: \_\_\_\_\_ HVAC + \_\_\_\_\_  
 Plumbing: \_\_\_\_\_ Jettub \_\_\_\_\_ Grdntub \_\_\_\_\_  
 # of Fireplace(s): \_\_\_\_\_  
 Interior comp: Cktp \_\_\_\_\_ Crng \_\_\_\_\_ Dsp \_\_\_\_\_ DW \_\_\_\_\_  
 H&F \_\_\_\_\_ Oven s/d \_\_\_\_\_ Micro \_\_\_\_\_ BIREF \_\_\_\_\_ Trash \_\_\_\_\_ Other \_\_\_\_\_  
 Bedrooms: \_\_\_\_\_ Qty \_\_\_\_\_  
 Yr Blt 2024 Eff Yr 2024 % Good \_\_\_\_\_  
 % Comp 100 Func \_\_\_\_\_ Econ \_\_\_\_\_  
 Except Code new Lump Sum \_\_\_\_\_  
 Comments \_\_\_\_\_

Segment	Class	Dimensions	Foundations	Exterior	Interior	Roof Co	Roof Sty	Flooring	Plumbing	Heat	Electric	Misc.	Year Built	Eff. Year	Condition	% Complete	Lump Sum	Exception Code
Account Number	Average_MS																	
Design	Beveled_MS																	
Siding	Front_only_MS																	
Trim	Average_on_1_or_2_sides																	
Overhang	Residential_Steel_MS																	
Windows & Doors	No_entry_MS																	
Entry	Multiple_Gables_MS																	
Roof																		

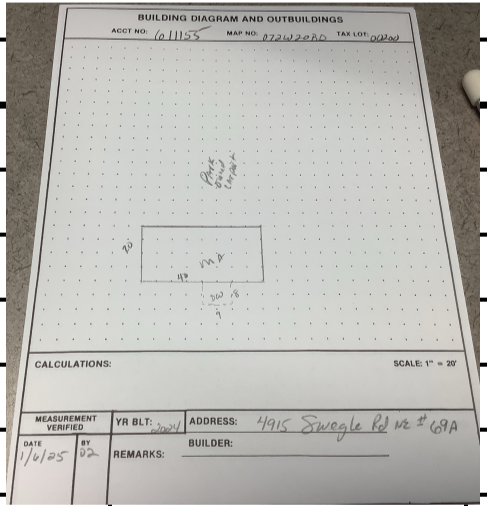

Land and/or OSD



Check other side ---->

Manufactured home

Red  
NTA  
2216670  
4 11

Account: 611155

Tag color \_\_\_\_\_

Exterior:

Overhang: Number of Sides: 1 2 3 4 Wide Average Narrow

Windows: Minimal Average Abundant

Recessed Entry: Y N Siding: T-111 Hardi Beveled with accents Hardi with masonry

Roof: Comp Arch Comp Metal Other Multiple Gables: 0 1 More

Doors: Res Steel Wooden Glass Slider Transom Sidelights

Trim: Front only All sides

Exterior Class: 4 5 6 7 + -

Heat: FA BB HP AC

Interior:

Walls: Panel T & T Gypsum Arches Plant shelves Built-ins \_\_\_\_\_ Extra rooms \_\_\_\_\_

Kitchen:

Island: Y N Cabinets: Wrapped vinyl Wood doors Wood

Pantry: Y N Counters: Granite Tile Laminate Other: \_\_\_\_\_

Components: Dishwasher Hood Fan Range Oven Microwave Cooktop Double oven Garbage Disposal

Floors: Vinyl Tile Wood Laminate Other: \_\_\_\_\_

Kitchen Class: 4 5 6 7 + -

Bath:

Number: \_\_\_\_\_

Master: Sinks: 1 2 Shower Tub Combo Cabinets: Y N Floors: Tile Vinyl Other \_\_\_\_\_

Other: Sinks: 1 2 Shower Tub Combo Cabinets: Y N Floors: Tile Vinyl Other \_\_\_\_\_

Bath Class: 4 5 6 7 + -

Utility: Cabinets Sink Other: \_\_\_\_\_

Overall Class: 4 5 6 7 + -

