

Acct ID: 524488 MTL: 072W33C000200 Date: **9-25-24** Appr: **Core** Prop Class: 551 RMV Prop Class: 551 **451**
 Situs: 930 CARMEL DR SE SALEM OR 97317 MaSaNh: 01 06 000 Unit: 146953 Year: 2024
 Last Date Appraised: 06/13/2016 Appraiser: CLINT LUKE Retag: Y **N** Tag info: 2025 - Tags/Permit (Alt Energy System)
 Owner: KERGIL, TOMMY L Roll Type: R
 Cycle: **Tag** Sales Verification Other: _____ Inspection level: 1 2 3 **4** LCB TTO INSP AV: 206454
 RMV Land: 466400 RMV Imp: 299110 RMV Total: 765510 MAV: 177760 MSAV: 28694 SAV: 70254
 Comment: _____

INPUT 11-20-24 Core

ADD NEW INVENTORY

Notations **23-010157 WITHDRAWN 24-001653 FINALED 5-7-24**

| RP/MS | Code | Description |
|-------|-------|----------------|
| RP | ZONED | FARM EFU ZONED |

\$6,000

OSDs

| Count | Code | Description | RMV | Code Area | Exception |
|-------|------|------------------|-------|-----------|-----------|
| 1 | SAA | SA OSD - AVERAGE | 45000 | 92410 | 0 |

Land

Chris 1/31/25 farm use ok - nursery stock

Site: 1 Code Area: 92410 Size: 1.00 Acres Use Code: 005 Zone: REST SAV Use: 011 Exception: 0
 Class: **2BD** Value Source: **Farm Homesite** Description: RMV: 39460 Exception: Y N
 Adjustment(s): GSOIL Fire Patrol: Description:
 Comments: Liability year - 2009 / 2400210// 09-10: DISQ HOMESITE AND OSD FROM SPEC ASSESS, PER #19- THIS IS A NON-QUALIFYING HOMESITE// 00-01; SEPERATED INCREMENT FROM HOMESITE 05-06: RECALC SETUP;#17 6/1/04

Site: 2 Code Area: 92410 Size: ~~6.98~~ Acres Use Code: **005** Zone: REST SAV Use: 011 Exception: 0
 Class: 2BD Value Source: Farm Use - EFU **7.98** Description: **TWO BENCH DRY** RMV: 303010 Exception: Y N
 Adjustment(s): GSOIL **6.92** Fire Patrol: Description:
 Comments: Liability year - 1981 / 02400210

Site: 4 Code Area: 92410 Size: ~~2.00~~ Acres Use Code: 005 Zone: REST SAV Use: 011 Exception: 0
 Class: 4BD Value Source: Farm Use - EFU **1.05** Description: FOUR BENCH DRY RMV: 78930 Exception: Y N
 Adjustment(s): **GSOIL** **2.06** Fire Patrol: Description:
 Comments: Liability year - 1981

Improvements - Residence / Manufactured Structures

Bldg: 1 Code Area: 92410 Stat Class: 141 Year Blt: 1981 Eff Year Blt: 1981 Sq.Ft: 1402 % Complete: 100
 Desc: One Story Only Dimensions: RMV: 291630
 Func Obsc: 100 Econ %: 100 Other %: 100 Exception: 0 Adjust: Adjust RMV: 0

Floors

| Type | Class | Display Group | Floor Size | Beds | Baths | Yr Blt | Eff Yr Blt | Inventory | Exception |
|-----------------|-------|---------------|------------|------|-------|--------|------------|----------------------------------|-----------|
| First Floor | 4 | Finished | 1402 | 3 | FB-2 | 1981 | 1981 | BATH - 2, KIT+, HVAC+, FP, ROOF+ | Y N |
| Garage Attached | 4 | Finished | 614 | 0 | 0 | 1981 | 1981 | ROOF+ | Y N |

AMV

Accessories

| Description | Class | Size SqFt | Eff Yr Blt | RMV | Quantity | Exception |
|---------------------------|-------|-----------|------------|-------|----------|-----------|
| YARD IMPROVEMENTS AVERAGE | 4 | 1 | 1981 | 22041 | 1 | Y N |

Improvements - Accessory Buildings

Bldg: 2 Code Area: 92410 Stat Class: 341 Year Blt: 2004 Eff Year Blt: 2004 Sq.Ft: 96 % Complete: 100
 Desc: Multi Purpose Shed (MP) Dimensions: 8x12 RMV: 0
 Func Obsc: 100 Econ %: 100 Other %: 100 Exception: 0 Adjust: Adjust RMV: 0

Floors

| Type | Class | Display Group | Floor Size | Beds | Baths | Yr Blt | Eff Yr Blt | Inventory | Exception |
|--------------------|-------|---------------|------------|------|-------|--------|------------|-----------|-----------|
| Multi-Purpose Bldg | 4 | Finished | 96 | 0 | 0 | 2004 | 2004 | | Y N |

NU

Accessories

| Description | Class | Size SqFt | Eff Yr Blt | RMV | Quantity |
|-----------------------------|-------|-----------|------------|-----|----------|
| No accessory data available | | | | | |

Bldg: 3 Code Area: 92410 Stat Class: 341 Year Blt: 2015 Eff Year Blt: 2015 Sq.Ft: 192 % Complete: 100
 Desc: Multi Purpose Shed (MP) Dimensions: 16x12 RMV: 3740
 Func Obsc: 100 Econ %: 100 Other %: 100 Exception: 0 Adjust: Adjust RMV: 0

Floors

| Type | Class | Display Group | Floor Size | Beds | Baths | Yr Blt | Eff Yr Blt | Inventory |
|--------------------|-------|---------------|------------|------|-------|--------|------------|-----------------------|
| Multi-Purpose Bldg | 6 | Finished | 192 | 0 | 0 | 2015 | 2015 | AVE Exception: Y N |

Accessories

| Description | Class | Size SqFt | Eff Yr Blt | RMV | Quantity |
|-----------------------------|-------|-----------|------------|-----|----------|
| No accessory data available | | | | | |

Bldg: 4 Code Area: 92410 Stat Class: 341 Year Blt: 2015 Eff Year Blt: 2015 Sq.Ft: 192 % Complete: 100
 Desc: Multi Purpose Shed (MP) Dimensions: 16x12 RMV: 3740
 Func Obsc: 100 Econ %: 100 Other %: 100 Exception: 0 Adjust: Adjust RMV: 0

Floors

| Type | Class | Display Group | Floor Size | Beds | Baths | Yr Blt | Eff Yr Blt | Inventory |
|--------------------|-------|---------------|------------|------|-------|--------|------------|----------------|
| Multi-Purpose Bldg | 5 | Finished | 192 | 0 | 0 | 2015 | 2015 | Exception: Y N |

Accessories

| Description | Class | Size SqFt | Eff Yr Blt | RMV | Quantity |
|-----------------------------|-------|-----------|------------|-----|----------|
| No accessory data available | | | | | |

HO 20x20 AVE 2020 NEW
 SOLAR \$6000 2024 EXTEND

SKETCH/AREA TABLE ADDENDUM

SUBJECT INFO

File No.: 524488 Parcel No.: 072W33C 00200
 Property Address: 930 CARMEL DR SE
 City: Salem County: Marion State: OR ZipCode: 97317
 Owner:
 Client: Client Address:
 Appraiser Name: Inspection Date:

SKETCH

524488
072W33C 00200
SCALE=1:20

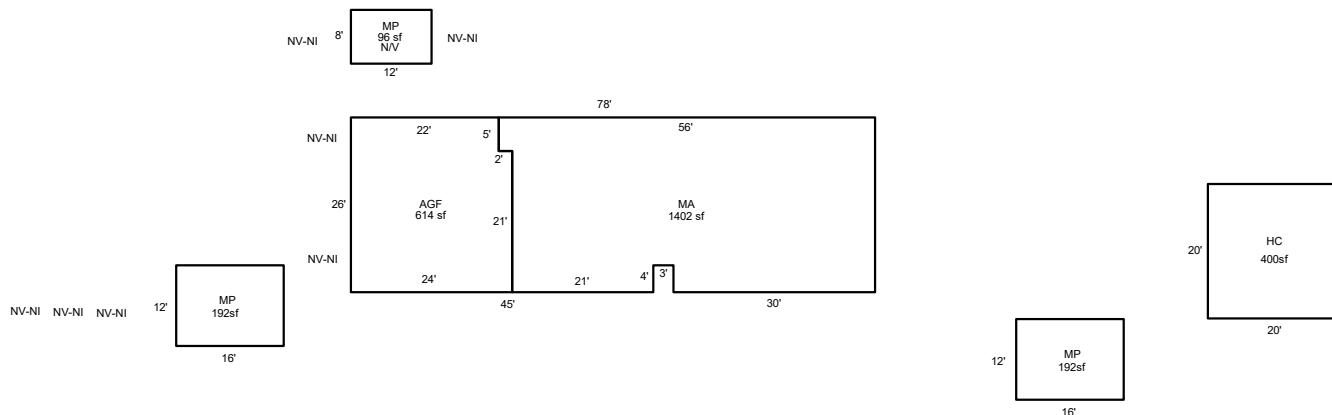

Sketch by ApexSketch

| AREA CALCULATIONS SUMMARY | | | | | | COMMENT TABLE 1 | |
|---------------------------|-------------|--------------|----------|-------------|------------|--|-----------------|
| Code | Description | Factor | Net Size | Perimeter | Net Totals | | |
| GBA1 | MP | 1.0 | 96.0 | 40.0 | | DRAWN BY JRONDEMA 7/11/16 UPDATED BY CLOBERG 10/28/24 | |
| | MP | 1.0 | 192.0 | 56.0 | | | |
| | MP | 1.0 | 192.0 | 56.0 | | | |
| | HC | 1.0 | 400.0 | 80.0 | 880.0 | | |
| GLA1 | MA | 1.0 | 1402.0 | 172.0 | 1402.0 | | |
| GAR | AGF | 1.0 | 614.0 | 100.0 | 614.0 | | |
| | | | | | | COMMENT TABLE 2 | COMMENT TABLE 3 |
| | | | | | | CLUKE 09/25/24 | TAGS SOLAR L4 |
| | | Net LIVABLE | cnt | 1 (rounded) | 1,402 | | |
| | | Net BUILDING | cnt | 4 (rounded) | 880 | | |