

Acct ID: 528542 MTL: 081W28C000100 Date: **12-3-24** Appr: **Luise** Prop Class: 551 RMV Prop Class: 451
 Situs: 11991 IRISH GLEN LN SE AUMSVILLE OR 97325 MaSaNh: 01 06 008 Unit: 83629 Year: 2024

INPUT 12-16-24 Luise

Last Date Appraised: 05/18/2012 Appraiser: CLINT LUKE Retag: Y **N** Tag info: 2025 - Tags/Permit (Addition)
 Owner: HAMMER, DOUGLAS G Roll Type: R
 Cycle: **Tag** Sales Verification Other: _____ Inspection level: 1 **2** 3 4 LCB **TTO** INSP AV: 179260
 RMV Land: 148280 RMV Imp: 278650 RMV Total: 426930 MAV: 120240 MSAV: 59020 SAV: 120110
 Comment:

Notations **24-002273 Primary Bld/BTH ADD + INT REMODEL**
 No notation data available.

Chris 2/7/25

FRAMING 7/10/24

OSDs

Count	Code	Description	RMV	Code Area	Exception
1	SAF	SA OSD - FAIR	35000	29588	0

Land SEASONAL LIVESTOCK ALONG WITH 528543

Site: 2 Code Area: 29588 Size: 1.00 Acres Use Code: 005 Zone: REST SAV Use: 011 Exception: 0
 Class: Value Source: Farm Homesite Description: RMV: 113280 Exception: Y N
 Adjustment(s): Fire Patrol: Description:
 Comments: Liability year - 2009 / 00-01; UPDATED MARKET VALUE, 2960180

Improvements - Residence / Manufactured Structures

Bldg: 1 Code Area: 29588 Stat Class: 107 Year Blt: Eff Year Blt: Sq.Ft: 0 % Complete: 100
 Desc: Yard Improvements Dimensions: RMV: 34040
 Func Obsc: 100 Econ %: 100 Other %: 100 Exception: 0 Adjust: Adjust RMV: 0

Floors

Type	Class	Display Group	Floor Size	Beds	Baths	Yr Blt	Eff Yr Blt	Inventory
------	-------	---------------	------------	------	-------	--------	------------	-----------

No floor data available

NC

Accessories

Description	Class	Size SqFt	Eff Yr Blt	RMV	Quantity
YARD IMPROVEMENTS GOOD	3	1	0	27900	1

Bldg: 4 Code Area: 29588 Stat Class: 131 + Year Blt: 2009 Eff Year Blt: 2009 Sq.Ft: 1052 % Complete: 100
 Desc: One Story Only Dimensions: RMV: 206810
 Func Obsc: 100 Econ %: 100 Other %: 100 Exception: 0 Adjust: Adjust RMV: 0

Floors

Type	Class	Display Group	Floor Size	Beds	Baths	Yr Blt	Eff Yr Blt	Inventory
------	-------	---------------	------------	------	-------	--------	------------	-----------

NO EXCEPTION

First Floor	4	Finished	1052	3	FB-1	2009	2009	BATH - 1, KIT, ROOF HVAC	Exception: Y N
Garage Attached	4	Finished	572	0	0	2009	2009	ROOF	Exception: Y N

ALL AVG

Accessories

Description	Class	Size SqFt	Eff Yr Blt	RMV	Quantity
-------------	-------	-----------	------------	-----	----------

1st Fl 4

721

BTH

2025

ALL AVG

NEW

No accessory data available

Improvements - Accessory Buildings

Bldg: 2 Code Area: 29588 Stat Class: 351 Year Blt: 1980 Eff Year Blt: 1988 Sq.Ft: 576 % Complete: 100
 Desc: General Purpose Building (GB) Dimensions: 36x16 RMV: 3510
 Func Obsc: 100 Econ %: 100 Other %: 100 Exception: 0 Adjust: Adjust RMV: 0

Floors

Type	Class	Display Group	Floor Size	Beds	Baths	Yr Blt	Eff Yr Blt	Inventory
------	-------	---------------	------------	------	-------	--------	------------	-----------

General Purpose Bldg	5	Finished	576	0	0	1980	1988	AVG	Exception: Y N
----------------------	---	----------	-----	---	---	------	------	------------	-----------------------

Accessories

Description	Class	Size SqFt	Eff Yr Blt	RMV	Quantity
-------------	-------	-----------	------------	-----	----------

No accessory data available

Bldg: 3 Code Area: 29588 Stat Class: 351 Year Blt: 2008 Eff Year Blt: 2008 Sq.Ft: 2400 % Complete: 100
 Desc: General Purpose Building (GB) Dimensions: 40x60 RMV: 34290
 Func Obsc: 100 Econ %: 100 Other %: 100 Exception: 0 Adjust: Adjust RMV: 0

Floors

Type	Class	Display Group	Floor Size	Beds	Baths	Yr Blt	Eff Yr Blt	Inventory	Exception: Y N
General Purpose Bldg	5	Finished	2400	0	0	2008	2008	FAIR	

Accessories

Description	Class	Size SqFt	Eff Yr Blt	RMV	Quantity
No accessory data available					



12/3/24



12/3/24



12/3/24

	A	B	C	D
1 Type		Single Family		Appraiser:
2 Year Built		2009		Date:
3 Roof		Updated		
4 Windows		Updated		
5 Siding		Updated		
6 Exterior Paint		Updated		
7 Door				
8 Floors		Updated		
9 Interior Paint		Updated		
10 Bathrooms		Updated		
11 Kitchen counters		Updated		
12 Kitchen cupboards		Updated		
13				
14 Suggested EYB		2009		
15				
16 Addition				
17 Original SF		996		
18 Add-on SF		721		
19 Suggested Blended EYB		2021		
20				

SKETCH/AREA TABLE ADDENDUM

SUBJECT INFO

File No.: 528542 Parcel No.: 081W28C 00100
 Property Address: 11991 IRISH GLEN LN
 City: Aumsville County: Marion State: OR ZipCode: 97325
 Owner:
 Client: Client Address:
 Appraiser Name: Inspection Date:

SKETCH

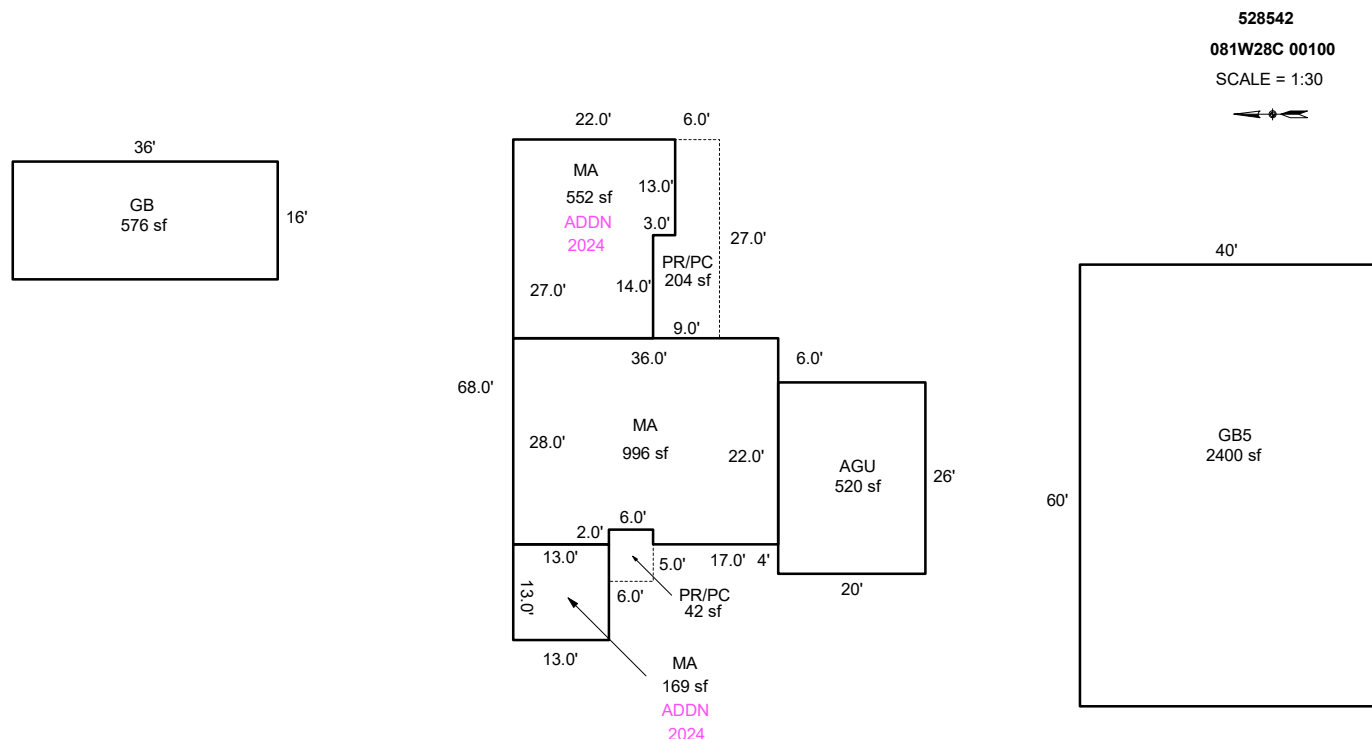

Sketch by ApexSketch

AREA CALCULATIONS SUMMARY						COMMENT TABLE 1	
Code	Description	Factor	Net Size	Perimeter	Net Totals		
GBA1	GB	1.0	576.0	104.0		DRAWN BY SH 10-15-08 UPDATED BY CLOBERG 06/18/2024 24-002273 AD	
	GB5	1.0	2400.0	200.0	2976.0		
GLA1	MA	1.0	169.0	52.0			
	MA	1.0	996.0	132.0			
	MA	1.0	552.0	98.0	1717.0		
GAR	AGU	1.0	520.0	92.0	520.0		
P/P	PR/PC	1.0	42.0	26.0			
	PR/PC	1.0	204.0	72.0	246.0		
						COMMENT TABLE 2	COMMENT TABLE 3
		Net LIVABLE	cnt	3 (rounded)	1,717		
		Net BUILDING	cnt	2 (rounded)	2,976		