

Acct ID: 535762 MTL: 092W28B000700 Date: 11/21/24 Appr: MDL Prop Class: 401 RMV Prop Class: 401
 Situs: 13024 MOUNTAIN VIEW LN SE TURNER OR 97392 MaSaNh: 07 06 000 Unit: 56020 Year: ~~2024~~ 2025
 Last Date Appraised: 02/24/2023 Appraiser: MATT LORD Retag: Y N Tag info: 2025 - NEW CONSTRUCTION (Completion)
 Owner: SCHNEPP, JEFFERY L & SCHNEPP, DONNA E Roll Type: R
 Cycle Tag Sales Verification Other: _____ Inspection level: 1 2 3 4 LCB TTO INSP AV: 293470
 RMV Land: 270270 RMV Imp: 302500 RMV Total: 572770 MAV: 275700 MSAV: 0 SAV: 0
 Comment: 24-25: L2 MDL 11.7.23 TAG 21-006883
 23-24: L2 2.24.23 CL
 22-23: LEVEL 2 CL 12.7.21

Notations 25-26 Addition 100% Exception
 No notation data available.

OSDs

Count	Code	Description	RMV	Code Area	Exception
1	MKTF	OSD - FAIR	35000	05530	0

Land ✓

Site: 1 Code Area: 05530 Size: 2.61 Acres Use Code: 004 Zone: NREST SAV Use: Exception: 0
 Class: 4HD Value Source: Rural at MKT Description: FOUR HILL DRY RMV: 235270 Exception: Y N
 Adjustment(s): VWGR Fire Patrol: Description:
 Comments: 19-20: PER #10, CHG OSD / 03-04: REAPP

Improvements - Residence / Manufactured Structures

Bldg: 1 Code Area: 05530 Stat Class: 131 Year Blt: 1979 Eff Year Blt: 1979 Sq.Ft: 3000 % Complete: 100
 Desc: One Story Only Dimensions: RMV: 274840
 Func Obsc: 100 Econ %: 100 Other %: 100 Exception: 17770 Adjust: Adjust RMV: 0

Floors

Type	Class	Display Group	Floor Size	Beds	Baths	Yr Blt	Eff Yr Blt	Inventory	Exception
First Floor	3	Finished	2400	3	FB-2	1979	<u>1987</u>	BATH - 2, KIT, ROOF, HVAC, FP - 1	Y N
First Floor	3	Finished	600	0	0	1979	<u>1979</u>		Y N

Accessories

Description	Class	Size SqFt	Eff Yr Blt	RMV	Quantity	Exception
YARD IMPROVEMENTS AVERAGE	3	0	1979	13057	1	Y N

Improvements - Accessory Buildings

Bldg: 2 Code Area: 05530 Stat Class: 351 Year Blt: 1995 Eff Year Blt: 1995 Sq.Ft: 1968 % Complete: 100
 Desc: General Purpose Building (GB) Dimensions: RMV: 25920
 Func Obsc: 100 Econ %: 100 Other %: 100 Exception: 0 Adjust: Adjust RMV: 0

Floors

Type	Class	Display Group	Floor Size	Beds	Baths	Yr Blt	Eff Yr Blt	Inventory	Exception
General Purpose Bldg	5	Finished	1968	0	FB-1	1995	1995	BATH - 1, GOOD	Y N

Accessories

Description	Class	Size SqFt	Eff Yr Blt	RMV	Quantity
No accessory data available					

Bldg: 3 Code Area: 05530 Stat Class: 341 Year Blt: 1998 Eff Year Blt: 1998 Sq.Ft: 120 % Complete: 100
 Desc: Multi Purpose Shed (MP) Dimensions: 10x12 RMV: 1740
 Func Obsc: 100 Econ %: 100 Other %: 100 Exception: 0 Adjust: Adjust RMV: 0

Floors

Type	Class	Display Group	Floor Size	Beds	Baths	Yr Blt	Eff Yr Blt	Inventory	Exception
Multi-Purpose Bldg	5	Finished	120	0	0	1998	1998	FAIR	Y N

Accessories

Description	Class	Size SqFt	Eff Yr Blt	RMV	Quantity
No accessory data available					

SKETCH/AREA TABLE ADDENDUM

SUBJECT INFO

File No.: 535762 Parcel No.: 092W28B 00700
 Property Address: 13024 MOUNTAIN VIEW LN SE
 City: TURNER County: State: OR ZipCode: 97392
 Owner:
 Client: Client Address:
 Appraiser Name: Inspection Date:

SKETCH

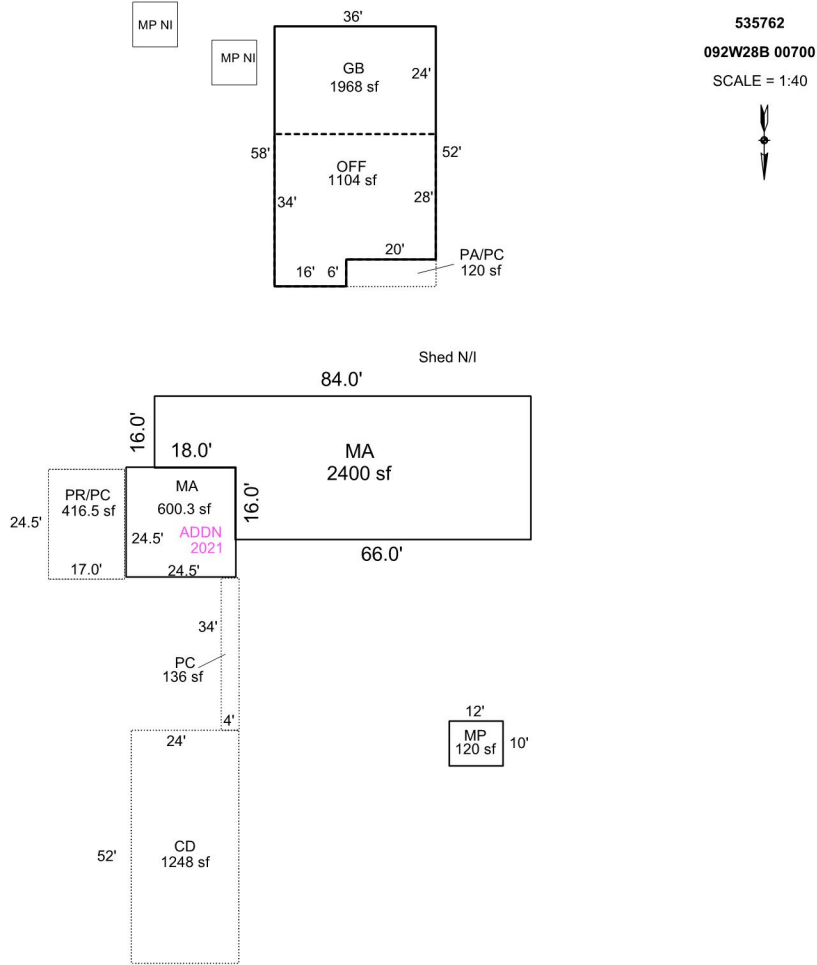

Sketch by ApexSketch

AREA CALCULATIONS SUMMARY

Code	Description	Factor	Net Size	Perimeter	Net Totals
GBA1	GB	1.0	1968.0	188.0	
	OFU	1.0	1104.0	140.0	
	MP	1.0	120.0	44.0	3192.0
GLA1	MA	1.0	2400.0	232.0	
	MA	1.0	600.3	98.0	3000.3
DW	PA/PC	1.0	120.0	52.0	
	PC	1.0	136.0	76.0	
	CD	1.0	1248.0	152.0	1504.0
P/P	PR/PC	1.0	416.5	83.0	416.5
	Net LIVABLE	cnt	2 (rounded)		3,000
	Net BUILDING	cnt	3 (rounded)		3,192

COMMENT TABLE 1

UPDATED BY CHRIS 5/9/19
 UPDATED BY CJURAN 09/15/2021 555-21-006883
 UPDATED BY WWILLIAMS 3/18/24

COMMENT TABLE 2

MDL 11.07.23

COMMENT TABLE 3

L2 TAGS

Acct ID: 535762 MTL: 092W28B000700 Date: 11/7/23 Appr: MDL Prop Class: 401 RMV Prop Class: 401
 Situs: 13024 MOUNTAIN VIEW LN SE TURNER OR 97392 MaSaNh: 07 06 000 Unit: 56020 Year: ~~2023~~ 2024
 Last Date Appraised: 02/24/2023 Appraiser: MATT LORD Retag: Y N Tag info: 2024 - Tags/Permit (Addition)
 Owner: SCHNEPP, JEFFERY L & SCHNEPP, DONNA E Roll Type: R
 Cycle: Tag Sales Verification Other: _____ Inspection level: 1 2 3 4 LCB TTO INSP AV: 267670
 RMV Land: 229760 RMV Imp: 301990 RMV Total: 531750 MAV: 267670 MSAV: 0 SAV: 0
 Comment: 23-24: L2 2.24.23 CL
 22-23: LEVEL 2 CL 12.7.21

Can't locate photo's

Notations 24-25 Addition (21-006883) 696BF Addition
 No notation data available.

OSDs

Count	Code	Description	RMV	Code Area	Exception
1	MKTF	OSD - FAIR	35000	05530	0

Land

Site: 1 Code Area: 05530 Size: 2.61 Acres Use Code: 004 Zone: NREST SAV Use: Exception: 0
 Class: 4HD Value Source: Rural at MKT Description: FOUR HILL DRY RMV: 194760 Exception: Y N
 Adjustment(s): VWGR Fire Patrol: Description:
 Comments: 19-20: PER #10, CHG OSD / 03-04: REAPP

Improvements - Residence / Manufactured Structures

Bldg: 1 Code Area: 05530 Stat Class: 131 Year Blt: 1979 Eff Year Blt: 1979 Sq.Ft: 2400 % Complete: 100
 Desc: One Story Only Dimensions: RMV: 266410
 Func Obsc: 100 Econ %: 100 Other %: 100 Exception: 0 Adjust: Adjust RMV: 0

Floors

Type	Class	Display Group	Floor Size	Beds	Baths	Yr Blt	Eff Yr Blt	Inventory	Exception
First Floor	3	Finished	2400	3	FB-2	1979	1979	KIT, HVAC, FP, ROOF, BATH - 2	Y N

Accessories

Description	Class	Size SqFt	Eff Yr Blt	RMV	Quantity	Exception
YARD IMPROVEMENTS GOOD <u>AVG</u>	3	0	1979	22397	1	Y N

Improvements - Accessory Buildings

Bldg: 2 Code Area: 05530 Stat Class: 351 Year Blt: 1995 Eff Year Blt: 1995 Sq.Ft: 2968 % Complete: 100
 Desc: General Purpose Building (GB) Dimensions: RMV: 33410
 Func Obsc: 100 Econ %: 100 Other %: 100 Exception: 0 Adjust: Adjust RMV: 0

Floors

Type	Class	Display Group	Floor Size	Beds	Baths	Yr Blt	Eff Yr Blt	Inventory	Exception
General Purpose Bldg	5	Finished	1968	0	FB-1	1995	1995	FAIR, BATH - 1	Y N
Unfinished Office	5	Finished	1000	0	0	2002	2002		Y N

GOOD PKB

Accessories

Description	Class	Size SqFt	Eff Yr Blt	RMV	Quantity
No accessory data available					

Bldg: 3 Code Area: 05530 Stat Class: 341 Year Blt: 1998 Eff Year Blt: 1998 Sq.Ft: 120 % Complete: 100
 Desc: Multi Purpose Shed (MP) Dimensions: 10x12 RMV: 2170
 Func Obsc: 100 Econ %: 100 Other %: 100 Exception: 0 Adjust: Adjust RMV: 0

Floors

Type	Class	Display Group	Floor Size	Beds	Baths	Yr Blt	Eff Yr Blt	Inventory	Exception
Multi-Purpose Bldg	5	Finished	120	0	0	1998	1998	FAIR	Y N

Accessories

Description	Class	Size SqFt	Eff Yr Blt	RMV	Quantity
No accessory data available					

ACCOUNT # 535762 DATE: 1/9/23 RMV CLASS 401 PROP CLASS 401
 MTL 92W 28B 700 APPR MY TAG Y N _____
 COMMENTS: _____

696 SF Addition

RESIDENCE / MANUFACTURED STRUCTURES

ACCESSORY IMPROVEMENTS / OUTBUILDINGS

STAT 3 QLTY + - FLOOR MA
 AREA 686 EFF AREA 686 BED _____
 ROOF + HVAC +
 BATH PKG: _____ BATH _____ BATH + _____ 1/2 BTH
 FIREPLACE: _____
 KITCHEN - +
 YR BLT 2023 EFF YR 2023 ECON _____
 % COMP 80 % GOOD _____ FUNC _____
 EXCEPT Y N LUMP SUM: _____
 MISC: _____
 YI CLASS _____ F G A E
 SKIRT + LIN FT _____
 COMMENT: Addition

STAT _____ QLTY + - FLOOR _____
 AREA _____ EFF AREA _____ BED _____
 ROOF + HVAC +
 BATH PKG: _____ BATH _____ BATH + _____ 1/2 BTH
 FIREPLACE: _____
 KITCHEN - +
 YR BLT _____ EFF YR _____ ECON _____
 % COMP _____ % GOOD _____ FUNC _____
 EXCEPT Y N LUMP SUM: _____
 MISC: _____
 YI CLASS _____ F G A E
 SKIRT + LIN FT _____
 COMMENT: _____

STAT _____ QLTY + - FLOOR _____
 AREA _____ EFF AREA _____ BED _____
 ROOF + HVAC +
 BATH PKG: _____ BATH _____ BATH + _____ 1/2 BTH
 FIREPLACE: _____
 KITCHEN - +
 YR BLT _____ EFF YR _____ ECON _____
 % COMP _____ % GOOD _____ FUNC _____
 EXCEPT Y N LUMP SUM: _____
 MISC: _____
 YI CLASS _____ F G A E
 SKIRT + LIN FT _____
 COMMENT: _____

TYPE _____
 STAT / CLASS _____
 SIZE _____
 FAIR
 AVERAGE
 GOOD
 EXCELLENT
 BATH _____
 YR BLT _____
 EFF YR _____
 % COMP _____
 EXCEPT Y N
 MISC: _____
 COMMENT: _____

TYPE _____
 STAT / CLASS _____
 SIZE _____
 FAIR
 AVERAGE
 GOOD
 EXCELLENT
 BATH _____
 YR BLT _____
 EFF YR _____
 % COMP _____
 EXCEPT Y N
 MISC: _____
 COMMENT: _____

TYPE _____
 STAT / CLASS _____
 SIZE _____
 FAIR
 AVERAGE
 GOOD
 EXCELLENT
 BATH _____
 YR BLT _____
 EFF YR _____
 % COMP _____
 EXCEPT Y N
 MISC: _____
 COMMENT: _____

TYPE _____
 STAT / CLASS _____
 SIZE _____
 FAIR
 AVERAGE
 GOOD
 EXCELLENT
 BATH _____
 YR BLT _____
 EFF YR _____
 % COMP _____
 EXCEPT Y N
 MISC: _____
 COMMENT: _____

Percent Complete Form

Account # 535762

Additions

New Homes

		No Basement		Basement	
% Item	% Sum	% Item	% Sum	% Item	% Sum
3%		Plans/Survey	3%		3%
2%	0%	Excavation	2%	0%	4%
3%		Foundation	3%		10%
35%	45%	Framing	14%	20%	16%
8%	50%	Trusses	7%	30%	7%
7%	60%	Roofing	7%	35%	7%
7%	65%	Windows/Ext Doors	7%	45%	6%
5%	70%	Siding	5%	50%	5%
4%	75%	Plumbing Rough-In	4%		3%
3%		Electrical Rough-In	3%	55%	2%
2%		Heating Rough-In	2%		1%
	80%	Heating Unit	1%	60%	1%
3%		Insulation	3%		2%
5%	85%	Drywall (Finished)	5%	65%	4%
2%	90%	Paint Interior	2%	70%	2%
2%		Paint Exterior	2%		2%
		Cabinets	6%	75%	5%
2%	95%	Electrical Fixtures	3%	80%	2%
2%		Plumbing Fixtures	4%	85%	3%
3%	100%	Floor Coverings & Countertops	7%	90%	6%
2%		Interior Trim Carpentry	7%	95%	6%
		Porch/Entry/Stoop	2%	100%	2%
		Finish Grade	1%		1%

APPR MDL Date 1/1/24 YR For 2425 % COMP 80
 APPR _____ Date _____ YR For _____ % COMP _____
 APPR _____ Date _____ YR For _____ % COMP _____
 APPR _____ Date _____ YR For _____ % COMP _____

Percent Complete Form

Account # _____

Gut & Remodels

Interior Trim Carpentry	7%	90%
Floor Coverings & Countertops	7%	85%
Plumbing Fixtures	4%	80%
Electrical Fixtures	3%	80%
Cabinets	6%	75%
Drywall (Finished)	5%	70%
Insulation	3%	65%

APPR _____ Date _____ YR For _____ % COMP _____
 APPR _____ Date _____ YR For _____ % COMP _____
 APPR _____ Date _____ YR For _____ % COMP _____
 APPR _____ Date _____ YR For _____ % COMP _____

Outbuilding Type: _____

	% Item	% Sum
Excavation/Foundation	10%	40%
Floor - Concrete/Wood	30%	
Walls - Framing	10%	65%
Walls - Covering/Siding	15%	
Roof - Framing/Trusses	15%	
Roof - Sheathing	5%	95%
Roof - Cover	10%	
Doors & Windows	5%	100%

APPR _____ Date _____ YR For _____ % COMP _____
 APPR _____ Date _____ YR For _____ % COMP _____
 APPR _____ Date _____ YR For _____ % COMP _____
 APPR _____ Date _____ YR For _____ % COMP _____



R35762 10x12 MP
4/29/2019



R35762 36x58 GB N Side W End-2
4/29/2019



R35762 MA Rear S Side W End
4/29/2019



R35762 36x58 GB N Side W End-1
4/29/2019



R35762 MA Front N Side
4/29/2019



R35762 24x52 GB PAD
4/29/2019



R35762 MA Front N Side W End
4/29/2019

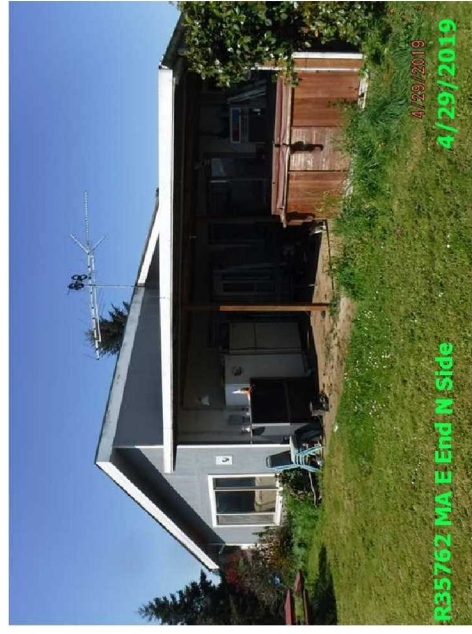

R35762 MA E End N Side
4/29/2019







