

Summary Lead Appr: ww 2.6.25 Clerk: _____ Lead Clerk: _____ Appr: MDL Input Print Date: 9/24/2024

Acct ID: 535548 MTL: 092W230000500 Date: 12/12/24 Appr: MDL Prop Class: 551 RMV Prop Class: 451
Situs: 8142 OKEY LN SE TURNER OR 97392 MaSaNh: 07 06 000 Unit: 57751 Year: 2024
2025

Last Date Appraised: 02/02/2024 Appraiser: MATT LORD Retag: Y N Tag info: 2025 - NEW CONSTRUCTION (Completion)

Owner: STRAWN, RANDALL DARIN Roll Type: R

Cycle Tag Sales Verification Other: _____ Inspection level: 1 2 3 4 LCB TTO INSP AV: 240424

RMV Land: 357610 RMV Imp: 397040 RMV Total: 754650 MAV: 123600 MSAV: 33624 SAV: 70543

Comment: 24-25: L3 MDL 2.2.24 23-003473 Addition Gated
LEVEL 2 1.28.21 CL10//

Notations 25-26 100% complete / Pull TAB / Exception

RP/MS	Code	Description
RP	ZONED	FARM EFU ZONED

OSDs Chris 2/20/25 L4 farm use ok - livestock

Count	Code	Description	RMV	Code Area	Exception
1	SAF	SA OSD - FAIR	35000	05545	0

Land

Site: 1 Code Area: 05545 Size: 1.00 Acres Use Code: 005 Zone: REST SAV Use: 011 Exception: 0
Class: 2BDS Value Source: Farm Homesite Description: TWO BENCH DRY SOUTH SPECIAL RMV: 26580 Exception: Y N
S

Adjustment(s): GSOIL, IRR Fire Patrol: Description:

Comments: Liability year - 2009 / 24-25 SOIL CORRECTIONS/UPDATES 18-19: SV #10 CHG OSD //2-16-07 (GW39): Change from 008 to 007.

Site: 2 Code Area: 05545 Size: 7.48 Acres Use Code: 005 Zone: REST SAV Use: 011 Exception: 0
Class: 2BISS Value Source: Farm Use - EFU Description: TWO BENCH IRR SOUTH SPECIAL RMV: 207810 Exception: Y N

Adjustment(s): GSOIL, IRR Fire Patrol: Description:

Comments: Liability year - 1980 / 550040 24-25 SOIL CORRECTIONS/UPDATES

Site: 3 Code Area: 05545 Size: 3.32 Acres Use Code: 005 Zone: REST SAV Use: 011 Exception: 0
Class: 2BDS Value Source: Farm Use - EFU Description: TWO BENCH DRY SOUTH SPECIAL RMV: 88220 Exception: Y N
S

Adjustment(s): GSOIL, IRR Fire Patrol: Description:

Comments: Liability year - 1980 / 550040 24-25 SOIL CORRECTIONS/UPDATES

Improvements - Residence / Manufactured Structures

Bldg: 1 Code Area: 05545 Stat Class: 141 Year Blt: 1948 Eff Year Blt: 1998 Sq.Ft: 2560 % Complete: 100
Desc: One Story Only Dimensions: RMV: 328300
Func Obsc: 100 Econ %: 100 Other %: 100 Exception: 83200 Adjust: Adjust RMV: 0

Floors

Type	Class	Display Group	Floor Size	Beds	Baths	Yr Blt	Eff Yr Blt	Inventory	Exception
First Floor	4	Finished	960	1	FB-2	1948	1998	BATH - 2, KIT-, ROOF, HVAC, FP - 1, BATH+	Y N
First Floor	4	Finished	1600	0	0	1948	1998		Y N

Accessories

Description	Class	Size SqFt	Eff Yr Blt	RMV	Quantity	Exception
YARD IMPROVEMENTS AVERAGE	4	0	1998	24552	1	Y N

Bldg: 5 Code Area: 05545 Stat Class: 138 Year Blt: 1948 Eff Year Blt: 2004 Sq.Ft: 0 % Complete: 100
Desc: Res other improvements Dimensions: RMV: 35600
Func Obsc: 100 Econ %: 100 Other %: 100 Exception: 0 Adjust: Adjust RMV: 0

Floors

Type	Class	Display Group	Floor Size	Beds	Baths	Yr Blt	Eff Yr Blt	Inventory	Exception
Garage Detached	3	Finished	484	0	0	1948	2004	ROOF	Y N

Accessories

Description	Class	Size SqFt	Eff Yr Blt	RMV	Quantity
No accessory data available					

Improvements - Accessory Buildings

Bldg: 4 Code Area: 05545 Stat Class: 341 Year Blt: 1971 Eff Year Blt: 1971 Sq.Ft: 0 % Complete: 100
Desc: Multi Purpose Shed (MP) Dimensions: 24x16 RMV: 0
Func Obsc: 0 Econ %: 100 Other %: 100 Exception: 0 Adjust: Adjust RMV: 0

Floors

Type	Class	Display Group	Floor Size	Beds	Baths	Yr Blt	Eff Yr Blt	Inventory	
Multi-Purpose Bldg	4	Finished	0	0	0	1971	1971	FAIR	Exception: Y N

Accessories

Description	Class	Size SqFt	Eff Yr Blt	RMV	Quantity
No accessory data available					

Bldg: 6 Code Area: 05545 Stat Class: 351 Year Blt: 2019 Eff Year Blt: 2019 Sq.Ft: 1728 % Complete: 100
 Desc: General Purpose Building (GB) Dimensions: 48x36 RMV: 33140
 Func Obsc: 100 Econ %: 100 Other %: 100 Exception: 0 Adjust: Adjust RMV: 0

Floors

Type	Class	Display Group	Floor Size	Beds	Baths	Yr Blt	Eff Yr Blt	Inventory	
General Purpose Bldg	5	Finished	1728	0	0	2019	2019	FAIR	Exception: Y N

Accessories

Description	Class	Size SqFt	Eff Yr Blt	RMV	Quantity
No accessory data available					

Bldg: 7 Code Area: 05545 Stat Class: 341 Year Blt: 1971 Eff Year Blt: 1971 Sq.Ft: 0 % Complete: 100
 Desc: Multi Purpose Shed (MP) Dimensions: 12x8 RMV: 0
 Func Obsc: 100 Econ %: 100 Other %: 100 Exception: 0 Adjust: Adjust RMV: 0

Floors

Type	Class	Display Group	Floor Size	Beds	Baths	Yr Blt	Eff Yr Blt	Inventory	
Multi-Purpose Bldg	4	Finished	0	0	0	1971	1971	FAIR	Exception: Y N

Accessories

Description	Class	Size SqFt	Eff Yr Blt	RMV	Quantity
No accessory data available					

SKETCH/AREA TABLE ADDENDUM

SUBJECT INFO

File No.: 535548 Parcel No.: 092W23 00500
 Property Address: 8142 OKEY LN SE
 City: TURNER County: MARION State: OR ZipCode: 97392
 Owner:
 Client: Client Address:
 Appraiser Name: Inspection Date:

SKETCH

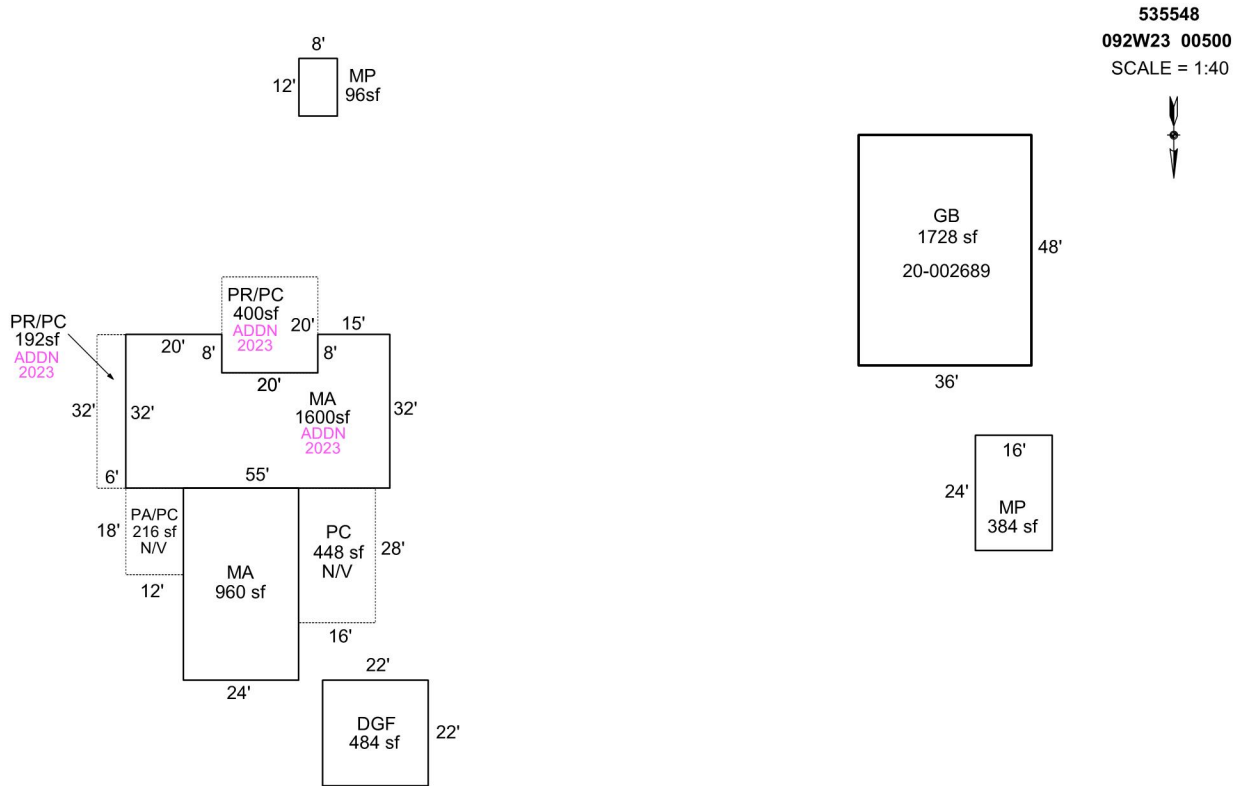

Sketch by Apex Sketch

AREA CALCULATIONS SUMMARY

Code	Description	Factor	Net Size	Perimeter	Net Totals
GBA1	DGF	1.0	484.0	88.0	
	MP	1.0	384.0	80.0	
	GB	1.0	1728.0	168.0	
	MP	1.0	96.0	40.0	2692.0
GLA1	MA	1.0	960.0	128.0	
	MA	1.0	1600.0	190.0	2560.0
P/P	PR/PC	1.0	192.0	76.0	
	PR/PC	1.0	400.0	80.0	592.0
	Net LIVABLE	cnt	2 (rounded)		2,560
	Net BUILDING	cnt	4 (rounded)		2,692

COMMENT TABLE 1

DRAWN BY JRONDEMA 6/7/18
 UPDATED BY JRONDEMA 8/15/18
 UPDATED BY JRONDEMA 4/1/19
 UPD BY PHU 10.08.20 / 20-002689
 UPDATED BY CJURAN 07/17/2023 555-23-003473
 UPDATED BY CJURAN 03/06/2024

COMMENT TABLE 2

12.02.19 CL #10: TAGS
 MDL 02/02/2024

COMMENT TABLE 3

TAGS L3



R35548 Horses-2

2/14/2019

02/14/19



R35548 22x32 MP N Side

2/14/2019

02/14/19



R35548 960-sg ft MA Front E Side

2/14/2019

02/14/19



R35548 Horses-1

2/14/2019

02/14/19



R35548 16x24 MP 16x24 NI LTL

2/14/2019

02/14/19

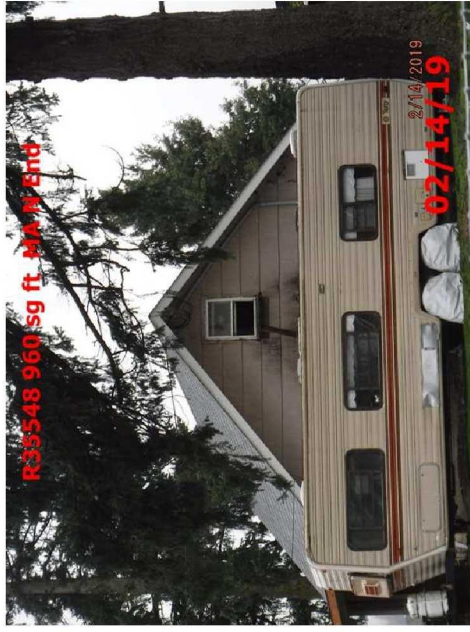

R35548 960-sg ft MA N End

2/14/2019

02/14/19



R35548 HORSE

2/14/2019

02/14/19



R35548 Locked Gate

2/14/2019

02/14/19



R35548 22x22 MP W Side N End

2/14/2019

02/14/19



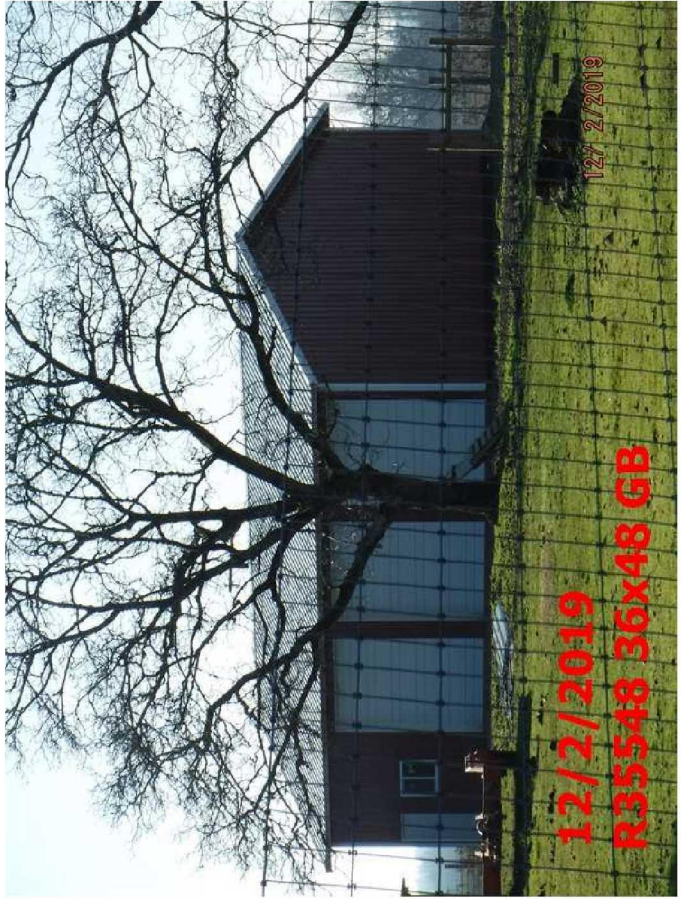

12/2/2019

R35548 36x48 GB

12/2/2019



R35548 MA-MP
2021-01-28 17

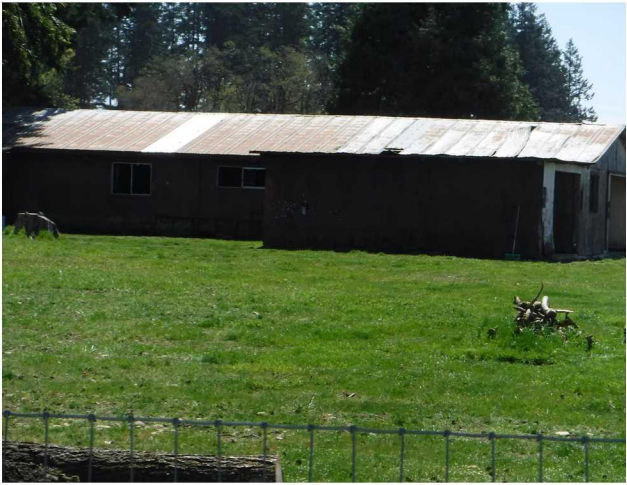
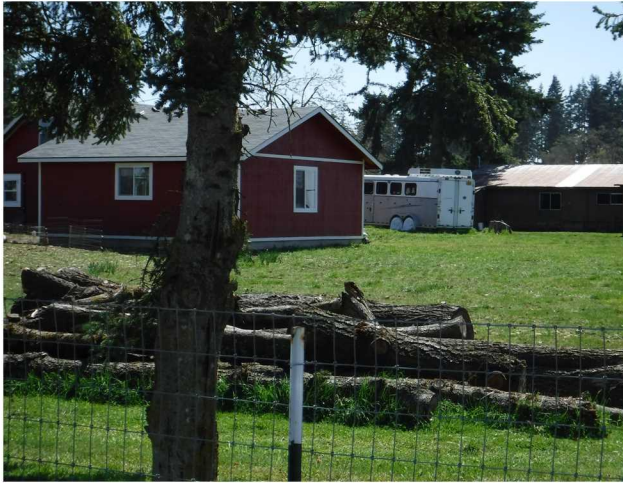

ACCOUNT # _____ DATE: 2/23 RMV CLASS _____ PROP CLASS _____
 MTL _____ APPR _____ TAG Y N _____
 COMMENTS: _____

RESIDENCE / MANUFACTURED STRUCTURES

ACCESSORY IMPROVEMENTS / OUTBUILDINGS

STAT 4 QLTY + - FLOOR MA
 AREA 1600 EFF AREA 1600 BED 1
 ROOF + HVAC +
 BATH PKG: 1 BATH _____ BATH + _____ 1/2 BTH
 FIREPLACE: 1
 KITCHEN - +
 YR BLT 2023 EFF YR 2023 ECON _____
 % COMP 75 % GOOD _____ FUNC _____
 EXCEPT Y N LUMP SUM: _____
 MISC: _____
 YI CLASS _____ F G A E
 SKIRT + LIN FT _____
 COMMENT: _____

STAT _____ QLTY + - FLOOR _____
 AREA _____ EFF AREA _____ BED _____
 ROOF + HVAC +
 BATH PKG: _____ BATH _____ BATH + _____ 1/2 BTH
 FIREPLACE: _____
 KITCHEN - +
 YR BLT _____ EFF YR _____ ECON _____
 % COMP _____ % GOOD _____ FUNC _____
 EXCEPT Y N LUMP SUM: _____
 MISC: _____
 YI CLASS _____ F G A E
 SKIRT + LIN FT _____
 COMMENT: _____

STAT _____ QLTY + - FLOOR _____
 AREA _____ EFF AREA _____ BED _____
 ROOF + HVAC +
 BATH PKG: _____ BATH _____ BATH + _____ 1/2 BTH
 FIREPLACE: _____
 KITCHEN - +
 YR BLT _____ EFF YR _____ ECON _____
 % COMP _____ % GOOD _____ FUNC _____
 EXCEPT Y N LUMP SUM: _____
 MISC: _____
 YI CLASS _____ F G A E
 SKIRT + LIN FT _____
 COMMENT: _____

TYPE MP
 STAT / CLASS H
 SIZE 96
822
 FAIR
AVERAGE
 GOOD
 EXCELLENT
 BATH _____
 YR BLT 1971
 EFF YR 1971
 % COMP _____
 EXCEPT Y N
 MISC: _____
 COMMENT: Inventory

TYPE _____
 STAT / CLASS _____
 SIZE _____
 FAIR
 AVERAGE
 GOOD
 EXCELLENT
 BATH _____
 YR BLT _____
 EFF YR _____
 % COMP _____
 EXCEPT Y N
 MISC: _____
 COMMENT: _____

TYPE _____
 STAT / CLASS _____
 SIZE _____
 FAIR
 AVERAGE
 GOOD
 EXCELLENT
 BATH _____
 YR BLT _____
 EFF YR _____
 % COMP _____
 EXCEPT Y N
 MISC: _____
 COMMENT: _____

TYPE _____
 STAT / CLASS _____
 SIZE _____
 FAIR
 AVERAGE
 GOOD
 EXCELLENT
 BATH _____
 YR BLT _____
 EFF YR _____
 % COMP _____
 EXCEPT Y N
 MISC: _____
 COMMENT: _____

Percent Complete Form

Account # _____

Additions

New Homes

		No Basement		Basement	
% Item	% Sum	% Item	% Sum	% Item	% Sum
3%		Plans/Survey	3%	3%	
2%	0%	Excavation	2%	4%	0%
3%		Foundation	3%	10%	
35%	45%	Framing	14%	20%	35%
8%	50%	Trusses	7%	30%	40%
7%	60%	Roofing	7%	35%	45%
7%	65%	Windows/Ext Doors	7%	45%	55%
5%	70%	Siding	5%	50%	60%
4%	75%	Plumbing Rough-In	4%	55%	65%
3%		Electrical Rough-In	3%	58%	
2%		Heating Rough-In	2%	60%	
	80%	Heating Unit	1%	61%	
3%		Insulation	3%	64%	
5%	85%	Drywall (Finished)	5%	69%	70%
2%	90%	Paint Interior	2%	71%	75%
2%		Paint Exterior	2%	73%	
		Cabinets	6%	79%	80%
2%		Electrical Fixtures	3%	82%	
2%	95%	Plumbing Fixtures	4%	86%	85%
3%		Floor Coverings & Countertops	7%	93%	90%
2%	100%	Interior Trim Carpentry	7%	100%	95%
		Porch/Entry/Stoop	2%	102%	100%
		Finish Grade	1%	103%	

APPR _____ Date 2/1/24 YR For 24-25 % COMP 75%
 APPR _____ Date 10/15/24 YR For 25-26 % COMP 100%
 APPR _____ Date _____ YR For _____ % COMP _____
 APPR _____ Date _____ YR For _____ % COMP _____

Percent Complete Form

Account # _____

Gut & Remodels

Interior Trim Carpentry	7%	90%
Floor Coverings & Countertops	7%	85%
Plumbing Fixtures	4%	80%
Electrical Fixtures	3%	80%
Cabinets	6%	75%
Drywall (Finished)	5%	70%
Insulation	3%	65%

APPR _____ Date _____ YR For _____ % COMP _____
 APPR _____ Date _____ YR For _____ % COMP _____
 APPR _____ Date _____ YR For _____ % COMP _____
 APPR _____ Date _____ YR For _____ % COMP _____

Outbuilding Type: _____

	% Item	% Sum
Excavation/Foundation	10%	40%
Floor - Concrete/Wood	30%	
Walls - Framing	10%	65%
Walls - Covering/Siding	15%	
Roof - Framing/Trusses	15%	
Roof - Sheathing	5%	95%
Roof - Cover	10%	
Doors & Windows	5%	100%

APPR _____ Date _____ YR For _____ % COMP _____
 APPR _____ Date _____ YR For _____ % COMP _____
 APPR _____ Date _____ YR For _____ % COMP _____
 APPR _____ Date _____ YR For _____ % COMP _____