

Acct ID: 529824 MTL: 082W15D001800 Date: 11/4/24 Appr: MDL Prop Class: 451 RMV Prop Class: 451  
 Situs: 7098 LIPSCOMB ST SE SALEM OR 97317 MaSaNh: 07 06 000 Unit: 86929 Year: 2025

Last Date Appraised: 07/22/2019 Appraiser: MATT LORD Retag: Y N Tag info: \_\_\_\_\_  
 Owner: WASSON, SEAN C Roll Type: R  
 Cycle Tag Sales Verification Other: \_\_\_\_\_ Inspection level: 1 2 3 4 LCB TTO INSP AV: 225760  
 RMV Land: 158880 RMV Imp: 303070 RMV Total: 461950 MAV: 225760 MSAV: 0 19 SAV: 0  
 Comment: \_\_\_\_\_ 8/12/24  
Estate sale

**Notations**

No notation data available.

**OSDs**

Count	Code	Description	RMV	Code Area	Exception
1	MKTA	OSD - AVERAGE	50000	05590	0

**Land**

Site: 1 Code Area: 05590 Size: 1.19 Acres Use Code: 005 Zone: REST SAV Use: \_\_\_\_\_ Exception: 0  
 Class: Value Source: Rural Restrictive Description: 4hd RMV: 108880 Exception: Y N  
 Adjustment(s): Fire Patrol: Description: \_\_\_\_\_  
 Comments: 2002-03 REAPPRAISAL; 2003-04 MODIFIED LAND TABLE KKB65 10/02

**Improvements - Residence / Manufactured Structures**

Bldg: 1 Code Area: 05590 Stat Class: 134 Year Blt: 1915 Eff Year Blt: 1960 Sq.Ft: 2592 % Complete: 100  
 Desc: Multi Story above grade with basement Dimensions: RMV: 262560  
 Func Obsc: 100 Econ %: 100 Other %: 100 Exception: 0 Adjust: Adjust RMV: 0

**Floors**

Type	Class	Display Group	Floor Size	Beds	Baths	Yr Blt	Eff Yr Blt	Inventory	Exception
First Floor	3	Finished	1678	1	FB-2	1915	1960	HVAC, FP - 1, KIT, BATH - 2, ROOF	Y N
Second Floor	3	Finished	504	1	FB-1	2000	1960	BATH - 1	Y N
Attic	3	Finished	410	2	0	1915	1960	HVAC	Y N
Basement	3	Unfinished	700	0	0	1915	1960		Y N

**Accessories**

Description	Class	Size SqFt	Eff Yr Blt	RMV	Quantity	Exception
<del>DECK</del> <u>YI 3F</u>	3	168	1960	2587	1	Y N

Bldg: 3 Code Area: 05590 Stat Class: 138 Year Blt: 1915 Eff Year Blt: 1960 Sq.Ft: 0 % Complete: 100  
 Desc: Res other improvements Dimensions: RMV: 36790  
 Func Obsc: 100 Econ %: 100 Other %: 100 Exception: 0 Adjust: Adjust RMV: 0

**Floors**

Type	Class	Display Group	Floor Size	Beds	Baths	Yr Blt	Eff Yr Blt	Inventory	Exception
Garage Detached	3	Unfinished	660	0	0	1915	1960	ROOF	Y N

**Accessories**

Description	Class	Size SqFt	Eff Yr Blt	RMV	Quantity
No accessory data available					

**Improvements - Accessory Buildings**

Bldg: 2 Code Area: 05590 Stat Class: 351 Year Blt: 1988 Eff Year Blt: 1988 Sq.Ft: 816 % Complete: 100  
 Desc: General Purpose Building (GB) Dimensions: 24x34 RMV: 3720  
 Func Obsc: 100 Econ %: 100 Other %: 100 Exception: 0 Adjust: Adjust RMV: 0

**Floors**

Type	Class	Display Group	Floor Size	Beds	Baths	Yr Blt	Eff Yr Blt	Inventory	Exception
General Purpose Bldg	4	Finished	816	0	0	1988	1988	FAIR ✓	Y N

**Accessories**

Description	Class	Size SqFt	Eff Yr Blt	RMV	Quantity
No accessory data available					



# SKETCH/AREA TABLE ADDENDUM

Parcel No **082W15D 01800**

File No **R29824**

SUBJECT

Property Address **7098 LIPSCOMB STREET SE**

City **SALEM**

County **MARION**

State **OR**

Zip **97317**

Owner

Client

Appraiser Name

IMPROVEMENTS SKETCH

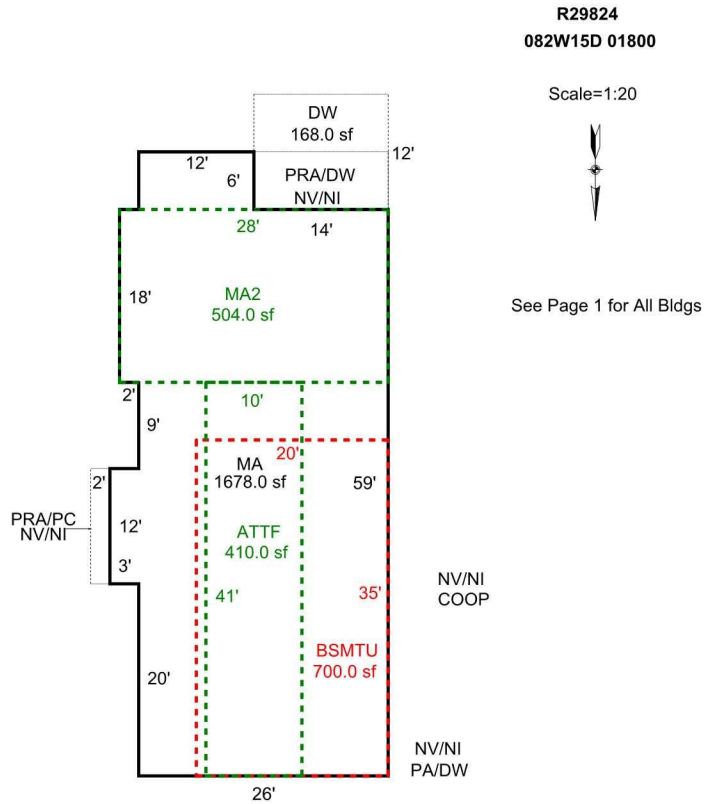

Scale: **1" = 40'**

AREA CALCULATIONS

### AREA CALCULATIONS SUMMARY

Code	Description	Factor	Net Size	Perimeter	Net Totals
GLA1	MA	1.00	1678.00	192.0	1678.00
GLA2	MA2	1.00	504.00	92.0	
	ATTF	1.00	410.00	102.0	914.00
BSMT	BSMTU	1.00	700.00	110.0	700.00
YI1	DW	1.00	168.00	52.0	
	PRA/DW	1.00	84.00	40.0	
	PRA/PC	1.00	24.00	28.0	276.00

#### Comment Table 1

3/7/17 BY CW  
UPD BY PH 12.18.19

#### Comment Table 2

07.22.19 CL #10

#### Comment Table 3

CYCLE

Net LIVABLE Area (rounded w/ factors) **2592**



R29824 Rear MA -1

7/12/2019



R29824 24x34 GB

7/12/2019



R29824 MA Rear-1

7/12/2019



R29824 22x31 DGU

7/12/2019



R29824 MA Front-2

7/12/2019



R29824 Rear MA -2

7/12/2019



R29824 MA Front-1

7/12/2019



FARMHOUSE

7/22/2019

R29824 MA Front-2



33  
7/12/2019

R29824 MA Front



R29824 MA Rear-1

7/12/2019



7/12/2019

R29824 Rear MA -1



achos

7/12/2019

R29824 22x31 DGU



7/12/2019

R29824 Rear MA - 2



R29824 24x34 GB

7/12/2019



12 22 '00



12 7 '99



12 7'99



12 7'99