

Summary

Lead Appr: \_\_\_\_\_ Clerk: \_\_\_\_\_ Lead Clerk: \_\_\_\_\_ Appr: \_\_\_\_\_

Print Date: 2/7/2025

Acct ID: 130049

MTL: 072W20BD00200P1

Date: 2/24/25 02

Appr: ts 3-14-25

Prop Class: 019

RMV Prop Class: 019

Situs: 4915 SWEGLE RD NE # 14 SALEM, OR 97301

MaSaNh: 14 05 000

Unit: 142090

Year: 2025

Last Date Appraised: 04/13/2021

Appraiser: THERESA SWEARINGEN

Retag: Y N

Tag info:

Owner: PHILLIPS, RICHARD W

Roll Type: MS

Cycle Tag Sales Verification Other: \_\_\_\_\_

Inspection level: 1 2 3 4

LCB TTO INSP

AV: 45440

RMV Land: 0

RMV Imp: 67440

RMV Total: 67440

MAV: 45440

MSAV: 0

SAV: 0

Comment: SUNSET VILLAGE M.P., SPACE #14, MS SERIAL # MH12808030702AB, X # X00183144, PERSONAL MS

Notations

No notation data available.

OSDs

No OSD data available.

Land

No land data available.

Improvements - Residence / Manufactured Structures

Bldg: 1

Code Area: 24620

Stat Class: 477

Year Blt: 1983

Eff Year Blt: 1983

Sq.Ft: 1404

% Complete: 100

Desc: MANUF STRUCT, CLASS 7, 26' THROUGH 28' WIDE DOUBLE

Dimensions: 52x27

RMV: 67440

Func Obsc: 100

Econ %: 100

Other %: 100

Exception: 0

Adjust:

Adjust RMV: 0

Floors

Type	Class	Display Group	Floor Size	Beds	Baths	Yr Blt	Eff Yr Blt	Inventory
First Floor	7	Finished	1404	2	FB-2	1983	1983	SKIRT, ROOF+, KIT+, FP - 1, BATH - 2, HVAC+ Exception: Y N

Accessories

Description	Class	Size SqFt	Eff Yr Blt	RMV	Quantity	
DECK	7	174	1983	1302	1	Exception: Y N
MULTI-PURPOSE BUILDING	6	80	1983	1077	0	Exception: Y N
ROOF EXTENSION OR PATIO COVER	7	307	1983	3027	0	Exception: Y N

Improvements - Accessory Buildings

No improvement data available for all other stat class types.

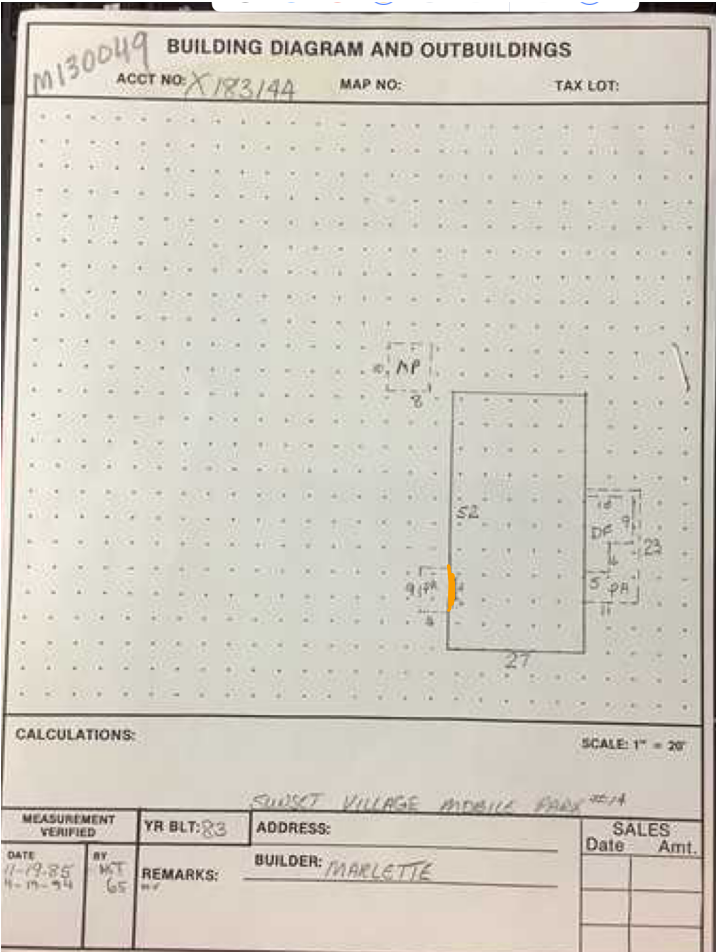

Photo Original Int w/m. new floors

Rebuilt. Corb mod. with seller - new window, etc PA



Marion County  
OREGON  
ASSESSOR'S OFFICE

Appraiser Sales Verification From

Primary Acct: 130049  
MTL: 072W20BD00200  
MaSaNh/P.Class: 1405000/019  
Appraiser: THERESA SWEARINGEN  
MS Acct: 130049

Date Printed: 2/6/2025

Situs: 4915 SWEGLE RD NE # 14 SALEM, OR 97301

Grantor: LEPIN, BARBARA A  
Grantee: PHILLIPS, RICHARD W

Sale ID: 31342  
Deed:  
Accts In Sale: 1  
Sale Date: 10/18/2024  
Sale Price: 80,000  
Condition Code: 00  
Tax Statement RMV  
Land & OSD: 0  
Imp: 64,270  
Total: 64,270  
Ratio (Cert. Total RMV/Sale Price): 80

Attempt	Date/Time	Reason
1 <sup>st</sup>		
2 <sup>nd</sup>		

Contact: Mrs. Dwyer Phone/email: WVMLS 816389 Realtor.com

1. Was the property listed on the open market? Days: \_\_\_\_\_ MLS: WVMLS 816389 Realtor.com Y N

2. Was property other than real estate included in the sale? Y N  
Describe: \_\_\_\_\_ Est. \$: \_\_\_\_\_

3. Did the seller pay closing costs or make other concessions? \$ ensure Y N

4. Was the sale between related parties? (business or family) Home warranty Inc Y N

5. Was this a distressed sale? E.g. foreclosure, short, court order, etc... Y N

6. Condition at time of sale: | Poor | Fair | Avg. | Good | Exc. | Y N  
Describe: \_\_\_\_\_  
\_\_\_\_\_  
\_\_\_\_\_

7. Have any improvements been made since the time of sale? Y N  
If yes, describe: \_\_\_\_\_  
\_\_\_\_\_  
\_\_\_\_\_  
\_\_\_\_\_

Comments: Fair price  
\_\_\_\_\_  
\_\_\_\_\_

Appraiser: 02 Date: 2/26/25

M130049072W20BD00200Appr #:02Date4/13/21Prop Class 019Franchise Code 02Year For: 2021-2022

Situs Address 4915 SWEGLE RD NE, #14

Owner VASGIEN,MARGARET J &

Tags CycleSales VerificationOther: update inv

Notes: 771062

RMV Imp: 32,220RMV Total: 32,220M50 Total: 32,220Nbh Code: A

Seg.Type MA    Seg. # 1.1    Method M04    Class 7D    Area 1404    Eff Area 1404    Length 52    Width 27

Make: MARLETTE    Model:    Intfinish: PANEL    Roof Cover ARCMP

Plumbing BATH2    Heat: AC    Fireplace:HRTH- Inter. Comp:CKTP;DW;DSP;OVEN-D, HTF    Bedrooms: 2

Year Built 1983    Eff.Year Built 1983    Cond. P F A G E

Adj Codes MSLCMD    Qlty 7    % Comp \_\_\_\_ Func \_\_\_\_    Econ \_\_\_\_    RMV: 30,020

Lump Sum \_\_\_\_    Except Code/Year \_\_\_\_    Comments \_\_\_\_

Accessory Improvements

Seg.Type PA    MFD STRUCT    Seg. # 1.3    Method: R05    Class    Area 307    Eff Area 307

Length    Width    Foundation    Ex. Wall    Roof Cover

Roof Style    Floor    Plumbing

Year Built    Eff. Year Built: 1983    Cond. P F A G E    % Comp \_\_\_\_ Econ \_\_\_\_    RMV: 1,440

Lump Sum \_\_\_\_    Except Code/Year \_\_\_\_    Comments \_\_\_\_

Seg.Type DP    MFD STRUCT    Seg. # 1.4    Method: R05    Class    Area 174    Eff Area 174

Length    Width    Foundation    Ex. Wall    Roof Cover

Roof Style    Floor    Plumbing

Year Built    Eff. Year Built: 1983    Cond. P F A G E    % Comp \_\_\_\_ Econ \_\_\_\_    RMV: 540

Lump Sum \_\_\_\_    Except Code/Year \_\_\_\_    Comments \_\_\_\_

Out Buildings and Skirting

Seg.Type MHSK    MFD STRUCT    Seg. # 1.2    Method: M04    Class    Area 158    Eff Area 158

Length    Width    Foundation    Ex. Wall METAL    Roof Cover

Roof Style    Floor    Plumbing

Heat    Int. Comp.    Elect.    Yr. Blt. 1983    Eff. Yr. Blt: 1983

Cond. P F A G E    Adj. Codes    % Comp \_\_\_\_ Func \_\_\_\_    Econ \_\_\_\_    RMV: 220

Lump Sum \_\_\_\_    Except Code/Year \_\_\_\_    Comments \_\_\_\_

Seg.Type MP    MULTI/MISC PURP    Seg. # 2.1    Method: F    Class 4    Area 80    Eff Area 80

Length 10    Width 8    Foundation    Ex. Wall    Roof Cover

Roof Style    Floor DIRT    Plumbing

Heat    Int. Comp.    Elect.    Yr. Blt.    Eff. Yr. Blt:

Cond. P F A G E    Adj. Codes FLCMCP    % Comp \_\_\_\_ Func \_\_\_\_    Econ \_\_\_\_    RMV: 0

Lump Sum \_\_\_\_    Except Code/Year \_\_\_\_    Comments \_\_\_\_



A window  
J. Stedley  
w.m.

new carpet  
new w.h.  
new roof

Picture  
B/I's  
Open F/P  
lots of cabinets  
cabinets in kitchen  
original interior  
clear

