

Summary

Lead Appr: _____ Clerk: **lak 1.23.25** Lead Clerk: **MBH 2/3/25** Appr: _____

Print Date: 12/11/2024

Acct ID: 611276

MTL: 083W10DD01900P8

Date: **1/13/24**

Appr: **02**

Prop Class: **707-019**

RMV Prop Class: **707-019**

Situs: 4940 SUNNYSIDE RD SE # G-20 SALEM, OR 97302

MaSaNh: 06 07 000

Unit: 149817

Year: 2025

Last Date Appraised: _____ Appraiser: _____

Retax: **Y** **N**

Tag info: 2025 - Tags/Permit (MS PLACEMENT)

ts 2-12-25

Owner: A3449

Roll Type: MS

Cycle **Tag** Sales Verification Other: _____

Inspection level: 1 **2** 3 4

LCB **Q** TTO INSP

AV: 0

RMV Land: 0

RMV Imp: 0

RMV Total: 0

MAV: 0

MSAV: 0

Re-tag for 1/1/26

SAV: 0

Comment:

correct Prop class + MASANTH

Add New mobile

Notations

No notation data available.

OSDs

No OSD data available.

Land

No land data available.

Improvements - Residence / Manufactured Structures

Bldg: 1	Code Area: 24010	Stat Class: 441	Year Blt:	Eff Year Blt:	Sq.Ft: 0	% Complete: 100
Desc: MANUF STRUCT, CLASS 4, 8'WIDE SINGLE					Dimensions:	RMV: 0
Func Obsc: 100	Econ %: 100	Other %: 100	Exception: 0	Adjust:	Adjust RMV: 0	

Floors

Type	Class	Display Group	Floor Size	Beds	Baths	Yr Blt	Eff Yr Blt	Inventory
No floor data available								

Accessories

Description	Class	Size SqFt	Eff Yr Blt	RMV	Quantity
No accessory data available					

Improvements - Accessory Buildings

No improvement data available for all other stat class types.

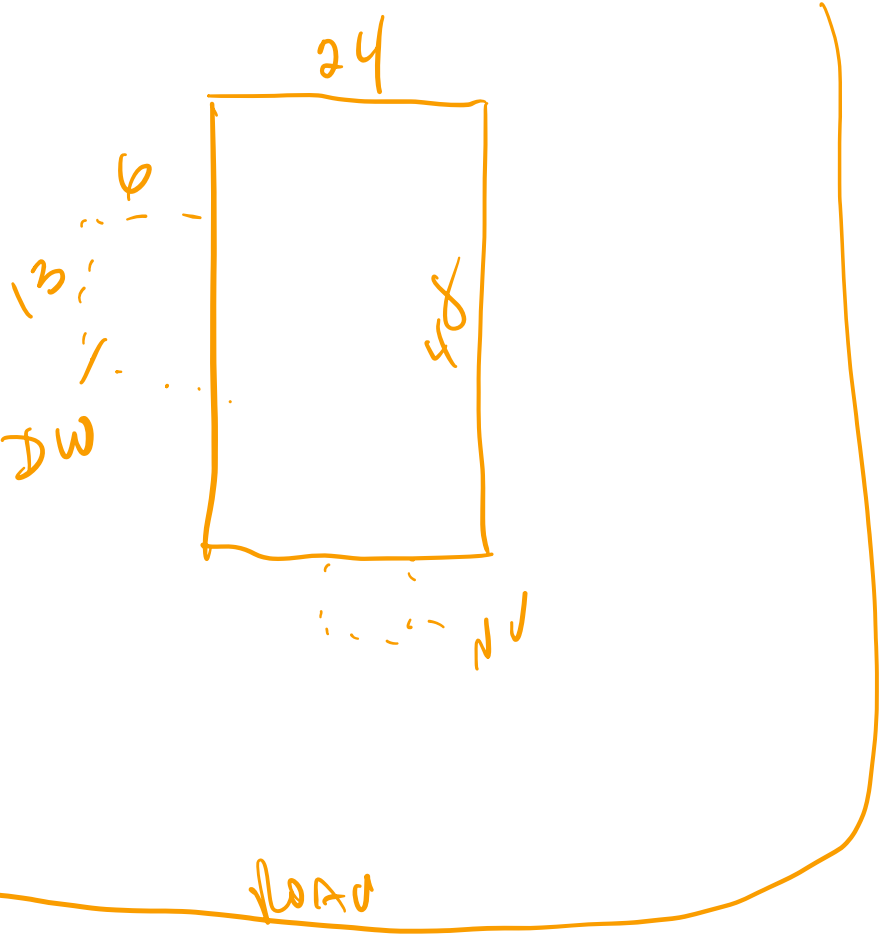

Prop ID # <u>611276</u>			Prop Class <u>019</u>			Prop Code <u>019</u>		
MTL <u>083W10DD01900P8</u>			Situs <u>S: 4940 SUNNYSIDE RD SE # G-20 SALEM, OR 97302</u>					
Tag? <u>NO</u> <u>YES</u> <u>Date</u> <u>1-13-25</u>			Brand: _____			: CMH _____		
						: 72TEM24483AH24 _____		
Segment <u>WA</u> State class <u>456</u>			Segment _____ area _____					
Roof: <u>Roof</u> <u>Roof +</u>			Roof			Roof +		
Heat: <u>HVAC</u> <u>HVAC +</u>			HVAC			HVAC +		
Plumbing: <u>2</u> Jettub _____ Grdntub _____			Plumbing: _____			Jettub _____ Grdntub _____		
# of Fireplace(s): _____			# of Fireplace(s): _____					
Interior comp: _____ Cktp _____ Crng _____ Dsp _____ DW _____			Interior comp: _____ Cktp _____ Crng _____ Dsp _____ DW _____					
H&F _____ Oven s/d _____ Micro _____ BIREF _____ Trash _____ Other _____			H&F _____ Oven s/d _____ Micro _____ BIREF _____ Trash _____ Other _____					
Bedrooms: <u>3</u> Qlty <u>5+</u>			Bedrooms: _____			Qlty _____		
Yr Blt <u>2024</u> Eff Yr <u>2024</u> % Good _____			Yr Blt _____ Eff Yr _____			% Good _____		
% Comp <u>100</u> Func _____ Econ _____			% Comp _____ Func _____			Econ _____		
Except Code <u>new</u> Lump Sum _____			Except Code _____			Lump Sum _____		
Comments _____			Comments _____					
Segment <u>MHSK</u> Class _____ Lin FT _____			Segment _____ area _____					
Skirting _____ Wood _____ Vinyl _____ Fbrgl _____ Metal _____			Roof: _____ Roof _____ Roof + _____			area _____		
Skirting + _____ Cinder Block _____ Brick _____			Heat: _____ HVAC _____ HVAC + _____					
			Plumbing: _____			Jettub _____ Grdntub _____		
			# of Fireplace(s): _____					
Yr Blt _____ Eff Yr _____ % Good _____			Interior comp: _____ Cktp _____ Crng _____ Dsp _____ DW _____					
% Comp _____ Func _____ Econ _____			H&F _____ Oven s/d _____ Micro _____ BIREF _____ Trash _____ Other _____					
Except Code _____ Lump Sum _____			Bedrooms: _____			Qlty _____		
Comments _____			Yr Blt _____ Eff Yr _____			% Good _____		
			% Comp _____ Func _____			Econ _____		
			Except Code _____			Lump Sum _____		
			Comments _____					
Segment _____			_____			Land and/or OSD _____		
Class _____			_____			_____		
Dimensions/Size _____			_____			_____		
Foundation _____			_____			_____		
Exterior Wall _____			_____			_____		
Interior Finish _____			_____			_____		
Roof Cover _____			_____			_____		
Roof Style _____			_____			_____		
Flooring _____			_____			_____		
Plumbing _____			_____			_____		
Heat _____			_____			_____		
Electric _____			_____			_____		
Misc. _____			_____			_____		
Year Built _____			_____			_____		
Eff. Year _____			_____			_____		
Condition _____			_____			Check other side ---->		
% Complete _____			_____			_____		
Lump Sum _____			_____			_____		
Exception Code _____			_____			_____		

Manufactured home

Account: 611276

Tag color

Red of E 565589

Exterior:

Overhang: Number of Sides: 1 2 3 4 Wide Average Narrow

Windows: Minimal Average Abundant

Recessed Entry: Y N Siding: T-111 Hardi Beveled with accents Hardi with masonry

Roof: Comp Arch Comp Metal Other Multiple Gables: 0 1 More

Doors: Res Steel Wooden Glass Slider Transom Sidelights

Trim: Front only All sides

Exterior Class: 4 5 6 7 + -

Heat: FA BB HP AC

Interior:

Walls: Panel T & T Gypsum Arches Plant shelves Built-ins Extra rooms

Kitchen:

Island: Y N Cabinets: Wrapped vinyl Wood doors Wood

Pantry: Y N Counters: Granite Tile Laminate Other:

Components: Dishwasher Hood Fan Range Oven Microwave Cooktop Double oven Garbage Disposal

Floors: Vinyl Tile Wood Laminate Other:

Kitchen Class: 4 5 6 7 + -

Bath:

Number:

Master: Sinks: 1 2 Shower Tub Combo Cabinets: Y N Floors: Tile Vinyl Other

Other: Sinks: 1 2 Shower Tub Combo Cabinets: Y N Floors: Tile Vinyl Other

Bath Class: 4 5 6 7 + -

Utility: Cabinets Sink Other:

Overall Class: 4 5 6 7 + -

4940 Sunnyside Rd SE, G-20

SECTION 1		NATURE OF FILING (check all that apply)					
<input type="checkbox"/> New home to MHODS	<input type="checkbox"/> Adding or removing a co-owner	<input type="checkbox"/> Demolition (Date: _____)					
<input type="checkbox"/> Used home sale	<input type="checkbox"/> Recording as real property	<input type="checkbox"/> Converted to storage					
<input type="checkbox"/> Security interest change	<input type="checkbox"/> Removing from real property status	<input checked="" type="checkbox"/> Trip Permit					
<input type="checkbox"/> Transfer by inheritance	<input type="checkbox"/> Other (please note): _____						
SECTION 2		APPLICANT INFORMATION (please print)					
<input checked="" type="checkbox"/> Dealer/Seller <input type="checkbox"/> Lender <input type="checkbox"/> Escrow/Title Agent <input type="checkbox"/> Owner/Buyer <input type="checkbox"/> Legal Representative							
Name: J&M Homes LLC (first, middle, last)				Phone: 541-928-1471			
Address: 33213 Hwy 34 SE							
City: Albany			State: OR		ZIP: 97322		
Email: lsimon@jandmhomes.com							
SECTION 3		HOME INFORMATION (information in bold is required)					
Home ID #:		OR No Home ID: <input checked="" type="checkbox"/> New Home <input type="checkbox"/> Out of state home <input type="checkbox"/> Leaving County Deed Records					
Manufacturer: CMH							
Model: 72TEM24483AH24				Year: 2024			
Serial Number(s)			HUD Label Number(s) *Required if new home				
ALB043821ORA							
ALB043821ORB							
# of Sections:	2	Sq. footage:	1152	Bedrooms:	3	Bathrooms:	2
Roofing type:	Architectural	Siding type:	Vertical Wood	Heating type:	Electric	Cooling type:	None
Date of sale: (if applicable)	7/7/24	Sale price:	114825	Includes land:	<input type="checkbox"/> Yes <input checked="" type="checkbox"/> No		
SECTION 4		DEALER INFORMATION (leave blank if no dealer)					
Name: J&M Homes LLC (first, middle, last)				License #: MSD155			
Address: 15850 S Pope Lane							
City: Oregon City				State: OR		ZIP: 97045	
Email: dasla@jandmhomes.com				Phone: 503-908-8166			
I hereby declare this manufactured structure is free and clear of all mortgages, deeds of trust, security interests, and liens. I have the legal right to sell this manufactured structure or my interest in it. The information listed is true to the best of my knowledge and belief, and I understand it can be used as evidence in court and is subject to a penalty of perjury.							
Signature: <i>Heri Simon</i>				Date: 11/20/24			
SECTION 5		HOME LOCATION					
Current Address: 2445 Pacific Blvd SW							
City: Albany			County: Linn		State: OR		Zip: 97321
Park Name: (if applicable)				<input type="checkbox"/> This is a dealer lot or storage facility			
<input checked="" type="checkbox"/> This home is being moved to a new location Complete the section below							
New Address: 4940 Sunnyside SE #20 G-20							
City: Salem			County: Marion		State: OR		Zip: 97302
Park Name: (if applicable) Sunnyside Mobile Homes				<input type="checkbox"/> This is a dealer lot or storage facility			
Transporter Name: J&M Homes LLC				Phone: 541-928-1471			
Address: 33213 Hwy 34 SE				City: Albany		State: OR	
Email: lsimon@jandmhomes.com							