

SKETCH/AREA TABLE ADDENDUM

SUBJECT INFO

File No.: 329645 Parcel No.: 072W28BD00101
 Property Address: 6040 ROSEMEADOW LN NE
 City: SALEM County: MARION State: OR ZipCode: 97317
 Owner:
 Client: Client Address:
 Appraiser Name: Inspection Date:

SKETCH

329645
072W28BD00101
SCALE=1:30

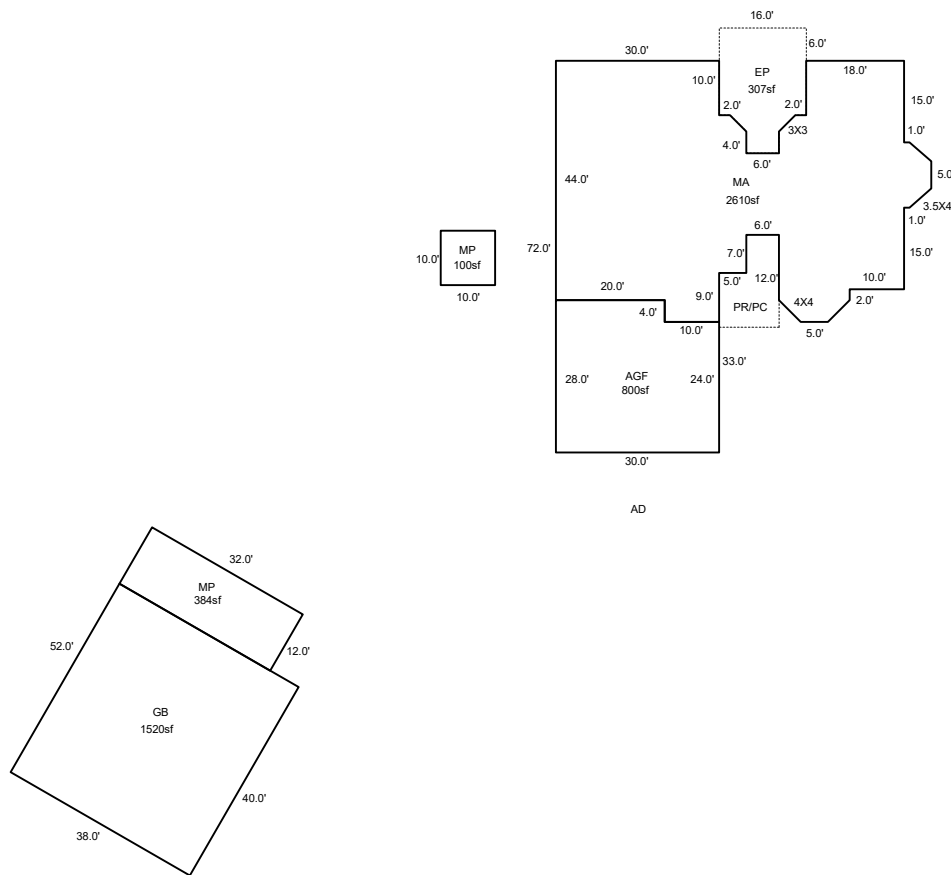

Sketch by ApexSketch

AREA CALCULATIONS SUMMARY						COMMENT TABLE 1	
Code	Description	Factor	Net Size	Perimeter	Net Totals		
GBA1	GB	1.0	1520.0	156.0		DRAWN BY JRONDEMA 12/28/17 UPDATED BY CLOBERG 03/24/25	
	MP	1.0	384.0	88.0			
	MP	1.0	100.0	40.0	2004.0		
GLA1	MA	1.0	2610.0	287.4	2610.0		
GAR	AGF	1.0	800.0	116.0	800.0		
P/P	EP	1.0	307.0	74.5	307.0		
						COMMENT TABLE 2	COMMENT TABLE 3
						MLH 03/18/25	SV L4
		Net LIVABLE	cnt	0 (rounded)	2,610		
		Net BUILDING	cnt	3 (rounded)	2,004		