

Summary Lead Appr: WW 2.18.25 Clerk: Lead Clerk: Appr: MDL Input Print Date: 9/24/2024

Acct ID: 531073 MTL: 082W29DC02700 Date: 12/17/25 Appr: MDL Prop Class: 541 RMV Prop Class: 401
Situs: 8062 WIPPER RD SE TURNER OR 97392 MaSaNh: 07 06 000 Unit: 34806 Year: 2024

Last Date Appraised: 01/02/2024 Appraiser: MATT LORD Retag: (Y) N Tag info: 2025 - NEW CONSTRUCTION (Completion)
Owner: EVERETTS, ANTHONY W & EVERETTS, SARA G Roll Type: R
Cycle: (Tag) Sales Verification Other: Inspection level: 1 2 (3) 4 LCB TTO INSP AV: 234158
RMV Land: 269600 RMV Imp: 428520 RMV Total: 698120 MAV: 201570 MSAV: 5608 SAV: 17630
Comment: 24-25: L2 MDL 1.2.24 24-003491 Cattle

Notations 25-26 N/C

RP/MS	Code	Description
RP	FUZ	FARM NON-EFU ZONED

OSDs

Count	Code	Description	RMV	Code Area	Exception
1	URBA	URBAN - AVERAGE	15000	05190	0

Land Chris 3/18/25

Site: 1 Code Area: 05190 Size: 1.00 Acres Use Code: 004 Zone: NREST SAV Use: Exception: 0
Class: 4BISS Value Source: Market Homesite Description: FOUR BENCH IRR SPECIAL SOUTH RMV: 40000 Exception: Y N
Adjustment(s): IRR Fire Patrol: Description:
Comments: 24-25: Update land class

00-01; SEPERATED INCREMENT FROM HOMESITE /02-03: REAPPRAISAL
Site: 2 Code Area: 05190 Size: 5.11 Acres Use Code: 004 Zone: NREST SAV Use: 011 Exception: 0
Class: 4BISS Value Source: Farm Use - Non EFU Description: FOUR BENCH IRR SPECIAL SOUTH RMV: 214600 Exception: Y N
Adjustment(s): IRR Fire Patrol: Description:
Comments: Liability year - 1972 / 519190

Improvements - Residence / Manufactured Structures

Bldg: 1 Code Area: 05190 Stat Class: 131 Year Blt: 1952 Eff Year Blt: 1987 Sq.Ft: 3168 % Complete: 100
Desc: One Story Only Dimensions: RMV: 373030
Func Obsc: 100 Econ %: 100 Other %: 100 Exception: 0 Adjust: Adjust RMV: 0

Floors

Type	Class	Display Group	Floor Size	Beds	Baths	Yr Blt	Eff Yr Blt	Inventory	Exception
First Floor	3	Finished	3168	2	FB-2	1952	1987	BATH - 2, KIT-, HVAC, FP - 1, ROOF	Y N
Garage Attached	3	Unfinished	864	0	0	2005	2005	ROOF	Y N

Accessories

Description	Class	Size SqFt	Eff Yr Blt	RMV	Quantity	Exception
YARD IMPROVEMENTS AVERAGE	3	1	1987	13727	1	Y N

Improvements - Accessory Buildings

Bldg: 2 Code Area: 05190 Stat Class: 351 Year Blt: 2023 Eff Year Blt: 2023 Sq.Ft: 2880 % Complete: 85 ✓
Desc: General Purpose Building (GB) Dimensions: 40x72 RMV: 55490
Func Obsc: 100 Econ %: 100 Other %: 100 Exception: 26980 Adjust: Adjust RMV: 0

Floors

Type	Class	Display Group	Floor Size	Beds	Baths	Yr Blt	Eff Yr Blt	Inventory	Exception
General Purpose Bldg	5	Finished	2880	0	0	2023	2023	AVG	Y N

Accessories

Description	Class	Size SqFt	Eff Yr Blt	RMV	Quantity
No accessory data available					

SKETCH/AREA TABLE ADDENDUM

SUBJECT INFO

File No.: 531073 Parcel No.: 082W29DC02700
 Property Address: 8062 WIPPER ROAD SE
 City: TURNER County: State: OR ZipCode: 97392
 Owner:
 Client: Client Address:
 Appraiser Name: Inspection Date:

SKETCH

534844
 091W16 00300
 SCALE = 1:30



REMEASURING 26-27

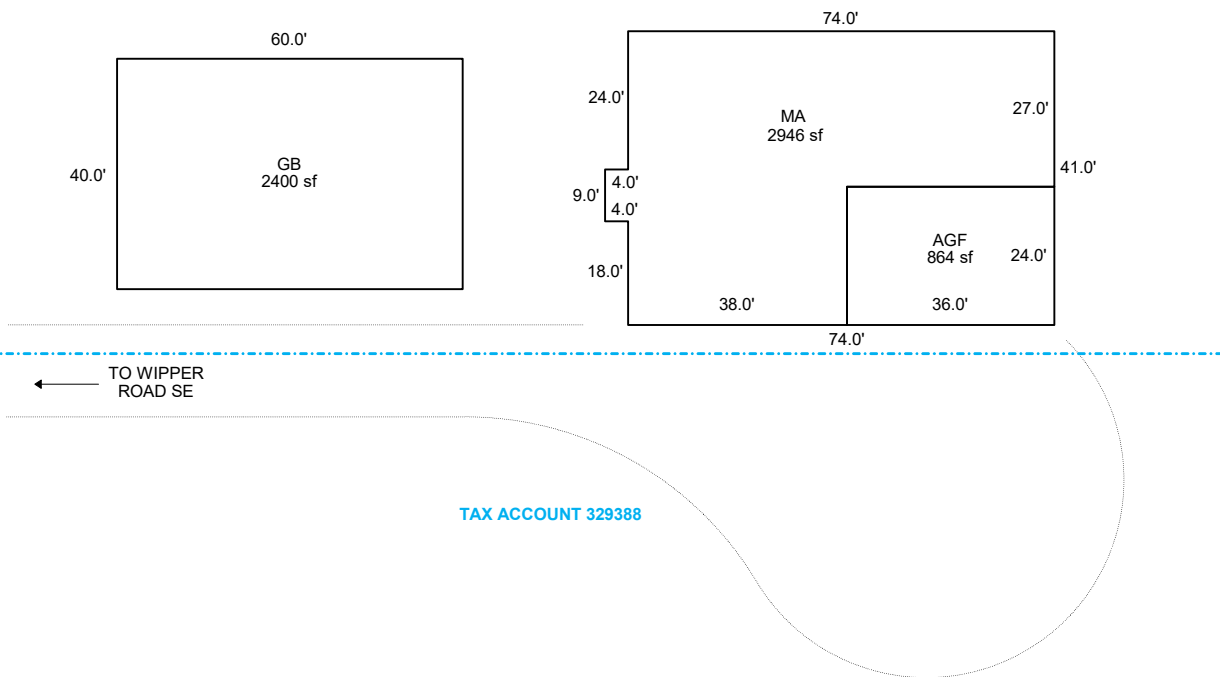

Sketch by ApexSketch

AREA CALCULATIONS SUMMARY						COMMENT TABLE 1	
Code	Description	Factor	Net Size	Perimeter	Net Totals		
GBA1	GB	1.0	2400.0	200.0	2400.0	UPDATED BY CJURAN 03/05/2024 UPDATED BY CLOBERG 02/12/25	
GLA1	MA	1.0	2946.0	258.0	2946.0		
GAR	AGF	1.0	864.0	120.0	864.0		
						COMMENT TABLE 2	COMMENT TABLE 3
						MDL 01/02/2024 MDL 12/17/24	TAGS L3 TAGS L3
Net LIVABLE		cnt	0	(rounded)	2,946		
Net BUILDING		cnt	1	(rounded)	2,400		

SKETCH/AREA TABLE ADDENDUM

SUBJECT INFO

File No.: 531073 Parcel No.: 082W29DC02700
 Property Address: 8062 WIPPER ROAD SE
 City: TURNER County: State: OR ZipCode: 97392
 Owner:
 Client: Client Address:
 Appraiser Name: Inspection Date:

SKETCH

534844
 091W16 00300
 SCALE = 1:30

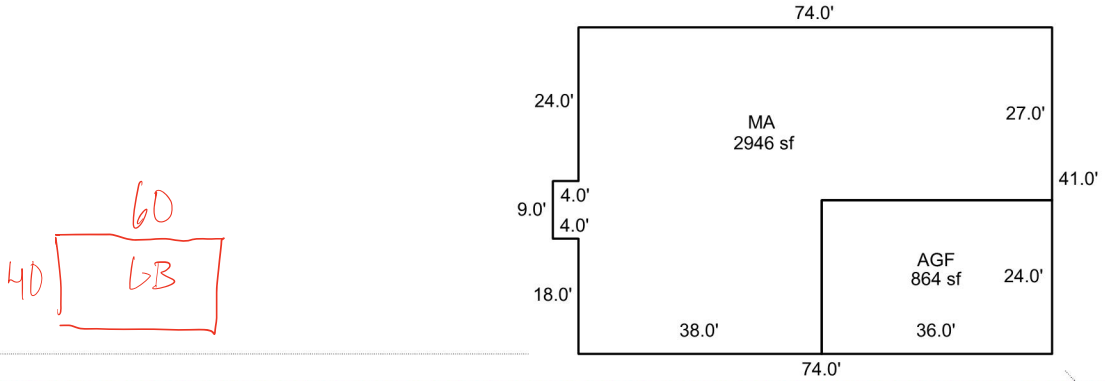

← TO WIPPER ROAD SE

TAX ACCOUNT 329388

Sketch by Apex Sketch

AREA CALCULATIONS SUMMARY

Code	Description	Factor	Net Size	Perimeter	Net Totals
GLA1	MA	1.0	2946.0	258.0	2946.0
GAR	AGF	1.0	864.0	120.0	864.0

COMMENT TABLE 1

UPDATED BY CJURAN 03/05/2024

COMMENT TABLE 2

MDL 01/02/2024

COMMENT TABLE 3

TAGS L3

Net LIVABLE cnt 1 (rounded) 2,946

Summary Lead Appr: _____ Clerk: _____ Lead Clerk: _____ Appr: **MDL** Print Date: 12/14/2023

Acct ID: 531073 MTL: 082W29DC02700 Date: **1/2/24** Appr: **MDL** Prop Class: **401** RMV Prop Class: 401
Situs: 8062 WIPPER RD SE TURNER OR 97392 MaSaNh: 07 06 000 Unit: 34806 Year: 2024

Last Date Appraised: 04/13/2010 Appraiser: MATT LORD Retag: **Y** N Tag info: 2025 - NEW CONSTRUCTION (Outbuilding)

Owner: EVERETTS, ANTHONY W & EVERETTS, SARA G Roll Type: R

Cycle **(Tag)** Sales Verification Other: _____ Inspection level: 1 **(2)** 3 4 LCB TTO INSP AV: 207178

RMV Land: 241360 RMV Imp: 307130 RMV Total: 548490 MAV: 201570 MSAV: 5608 SAV: 18473

Comment: **23-006874 40x72 GB**

Notations **85% complete ✓ 1/1/25**

RP/MS	Code	Description
RP	FUZ	FARM NON-EFU ZONED

OSDs

Count	Code	Description	RMV	Code Area	Exception
1	URBA	URBAN AVERAGE	15000	05190	0

OSDA

Land

Site: 1 Code Area: 05190 Size: 1.00 Acres Use Code: 004 Zone: NREST SAV Use: Exception: 0
 Class: 4BDS Value Source: Market Homesite Description: FOUR BENCH DRY SPECIAL SOUTH RMV: 35560 Exception: Y N
 Adjustment(s): IRR Fire Patrol: Description:
 Comments: 519190/00-01; SEPERATED INCREMENT FROM HOMESITE /02-03: REAPPRAISAL

Site: 2 Code Area: 05190 Size: 5.11 Acres Use Code: 004 Zone: NREST SAV Use: 011 Exception: 0
 Class: 4BISS Value Source: Farm Use - Non EFU Description: FOUR BENCH IRR SPECIAL SOUTH RMV: 190800 Exception: Y N
 Adjustment(s): IRR Fire Patrol: Description:
 Comments: Liability year - 1972 / 519190

Improvements - Residence / Manufactured Structures

Bldg: 1 Code Area: 05190 Stat Class: 131 Year Blt: 1952 Eff Year Blt: 1987 Sq.Ft: 3168 % Complete: 100
 Desc: One Story Only Dimensions: RMV: 307130
 Func Obsc: 100 Econ %: 100 Other %: 100 Exception: 0 Adjust: Adjust RMV: 0

Floors

Type	Class	Display Group	Floor Size	Beds	Baths	Yr Blt	Eff Yr Blt	Inventory	Exception
First Floor	3	Finished	3168	2	FB-2	1952	1987	ROOF, FP, HVAC, KIT-, BATH - 2	Y N
Garage Attached	3	Unfinished	864	0	0	2005	2005	ROOF	Y N

Accessories

Description	Class	Size SqFt	Eff Yr Blt	RMV	Quantity	Exception
YARD IMPROVEMENTS AVERAGE	3	1	1987	13727	1	Y N

Improvements - Accessory Buildings

No improvement data available for all other stat class types.

R31073

082W29DC02700



CD 47X22

L3 MDL
1/2/24
TAG

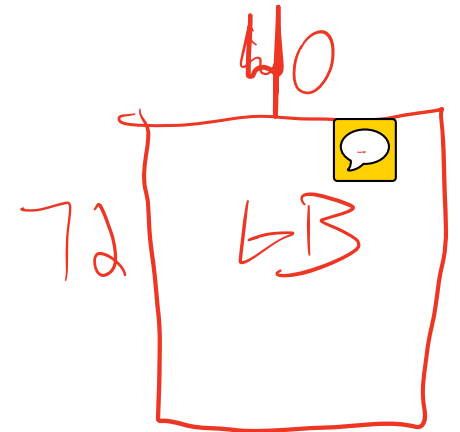





Percent Complete Form

Account # 531073 - New LB

Additions

New Homes

		No Basement		Basement	
% Item	% Sum	% Item	% Sum	% Item	% Sum
3%		Plans/Survey	3%		3%
2%	0%	Excavation	2%	0%	4%
3%		Foundation	3%		10%
35%	45%	Framing	14%	20%	16%
8%	50%	Trusses	7%	30%	7%
7%	60%	Roofing	7%	35%	7%
7%	65%	Windows/Ext Doors	7%	45%	6%
5%	70%	Siding	5%	50%	5%
4%	75%	Plumbing Rough-In	4%		3%
3%		Electrical Rough-In	3%	55%	2%
2%		Heating Rough-In	2%		1%
	80%	Heating Unit	1%	60%	1%
3%		Insulation	3%		2%
5%	85%	Drywall (Finished)	5%	65%	4%
2%	90%	Paint Interior	2%	70%	2%
2%		Paint Exterior	2%		2%
		Cabinets	6%	75%	5%
2%		Electrical Fixtures	3%	80%	2%
2%	95%	Plumbing Fixtures	4%	85%	3%
3%		Floor Coverings & Countertops	7%	90%	6%
2%	100%	Interior Trim Carpentry	7%	95%	6%
		Porch/Entry/Stoop	2%	100%	2%
		Finish Grade	1%		1%

APPR _____ Date _____ YR For _____ % COMP _____
 APPR _____ Date _____ YR For _____ % COMP _____
 APPR _____ Date _____ YR For _____ % COMP _____
 APPR _____ Date _____ YR For _____ % COMP _____

Percent Complete Form

Account # _____

Gut & Remodels

Interior Trim Carpentry	7%	90%
Floor Coverings & Countertops	7%	85%
Plumbing Fixtures	4%	80%
Electrical Fixtures	3%	80%
Cabinets	6%	75%
Drywall (Finished)	5%	70%
Insulation	3%	65%

APPR _____ Date _____ YR For _____ % COMP _____
 APPR _____ Date _____ YR For _____ % COMP _____
 APPR _____ Date _____ YR For _____ % COMP _____
 APPR _____ Date _____ YR For _____ % COMP _____

Outbuilding Type: LB

	% Item	% Sum
Excavation/Foundation	10%	40%
Floor - Concrete/Wood	30%	
Walls - Framing	10%	65%
Walls - Covering/Siding	15%	
Roof - Framing/Trusses	15%	
Roof - Sheathing	5%	95%
Roof - Cover	10%	
Doors & Windows	5%	100%

APPR MDL Date 1/9/24 YR For 24-25 % COMP 85%
 APPR MISL Date 1/1/25 YR For 25-26 % COMP 85%
 APPR _____ Date _____ YR For _____ % COMP _____
 APPR _____ Date _____ YR For _____ % COMP _____