

Acct ID: 532493 MTL: 083W19C000400 Date: **1/9/25** Appr: **GRH** Prop Class: 551 RMV Prop Class: 451  
 Situs: 6725 SKYLINE RD S SALEM OR 97302 MaSaNh: 06 06 000 Unit: 27987 Year: 2025

Last Date Appraised: 10/23/2019 Appraiser: GERARDO RAMIREZ HERNANDEZ Retag: Y N Tag info: 2025 - Tags/Permit (TAGS/PERMIT)

Owner: LEE, RONNY JASON Roll Type: R  
 Cycle **Tag** Sales Verification Other: \_\_\_\_\_ Inspection level: 1 2 3 4 LCB TTO INSP AV: 207594  
 RMV Land: 440070 RMV Imp: 397460 RMV Total: 837530 MAV: 173920 MSAV: 33674 SAV: 102411  
 Comment: 22-23: MDL LEVEL 4 06/02/22 UPDATED VIEW ADJ //

*New GB @ 100, update inv*

**Notations**

RP/MS	Code	Description
RP	PERM	PERMANENTLY DISQUALIFIED FROM FARM/FOREST
RP	ZONED	FARM EFU ZONED

**OSDs**

Count	Code	Description	RMV	Code Area	Exception
1	SAF	SA OSD - FAIR	40000	92430	0

*Disqualify Farm deferral - Appears no livestock since 2021*

**Land**

Site: 2	Code Area: 92430	Size: 1.00 Acres	Use Code: 005	Zone: REST	SAV Use: 011	Exception: 0
Class:	Value Source: Farm Homesite	Description: 4hd			RMV: 85380	Exception: Y N
Adjustment(s):	VWGR, GSOIL		Fire Patrol:	Description:		
Comments:	Liability year - 2009 / 2400230: 01-02: REAPPRAISAL					
Site: 3	Code Area: 92430	Size: 4.94 Acres	Use Code: 005	Zone: REST	SAV Use: 011	Exception: 0
Class: 4HD	Value Source: Farm Use - EFU	Description: FOUR HILL DRY			RMV: 248850	Exception: Y N
Adjustment(s):	VWGR, GSOIL		Fire Patrol:	Description:		
Comments:	Liability year - 1990 / 08-09: EIGHT BENCH PROJ - CHG FROM EIGHT HILL TO FOUR HILL DRY// 2400230: 01-02; CHANGED SOIL CLASS FROM 3 HILL DRY TO 4 HILL DRY /01-02: REAPPRAISAL					
Site: 4	Code Area: 92430	Size: 1.17 Acres	Use Code: 005	Zone: REST	SAV Use: 011	Exception: 0
Class: 2HD	Value Source: Farm Use - EFU	Description: TWO HILL DRY			RMV: 64830	Exception: Y N
Adjustment(s):	VWGR, GSOIL		Fire Patrol:	Description:		
Comments:	Liability year - 1990 / 08-09: EIGHT BENCH PROJ - CHG FROM EIGHT HILL TO TWO HILL DRY// 2400230: 01-02: REAPPRAISAL					
Site: 5	Code Area: 92430	Size: 0.02 Acres	Use Code: 005	Zone: REST	SAV Use:	Exception: 0
Class:	Value Source: Permanently Disqualified	Description: 4hd			RMV: 1010	Exception: Y N
Adjustment(s):	VWGR, GSOIL		Fire Patrol:	Description:		
Comments:						

**Improvements - Residence / Manufactured Structures**

Bldg: 1	Code Area: 92430	Stat Class: 143	Year Blt: 1937	Eff Year Blt: 1985	Sq.Ft: 1620	% Complete: 100
Desc:	One Story with basement		Dimensions:	RMV: 344790		
Func Obsc: 100	Econ %: 100	Other %: 100	Exception: 0	Adjust:	Adjust RMV: 0	

**Floors**

Type	Class	Display Group	Floor Size	Beds	Baths	Yr Blt	Eff Yr Blt	Inventory	Exception
First Floor	4	Finished	1620	3	FB-1	1937	1985	FP - 1, HVAC+, ROOF, KIT+, BATH - 1	Y N
Basement	4	Unfinished	864	0	0	1937	1964		Y N
Garage Attached	4	<del>Unfinished</del> <b>Finished</b>	792	0	0	1972	1985	ROOF	Y N

**Accessories**

Description	Class	Size SqFt	Eff Yr Blt	RMV	Quantity	Exception
<del>CONCRETE DRIVEWAY</del>	<del>4</del>	<del>1160</del>	<del>1972</del>	<del>2790</del>	<del>1</del>	<del>Exception: Y N</del>
<del>PATIO</del>	<del>4</del>	<del>378</del>	<del>1985</del>	<del>1684</del>	<del>1</del>	<del>Exception: Y N</del>
<del>PATIO</del>	<del>4</del>	<del>1224</del>	<del>1985</del>	<del>5453</del>	<del>1</del>	<del>Exception: Y N</del>
<del>ROOF EXTENSION OR PATIO COVER</del>	<del>4</del>	<del>288</del>	<del>1985</del>	<del>6765</del>	<del>1</del>	<del>Exception: Y N</del>

*4 Aug YI*

Bldg: 5	Code Area: 92430	Stat Class: 108	Year Blt: 1999	Eff Year Blt: 1999	Sq.Ft: 0	% Complete: 100
Desc:	Residential Other Improvements		Dimensions:	RMV: 5420		
Func Obsc: 100	Econ %: 100	Other %: 100	Exception: 0	Adjust:	Adjust RMV: 0	

*N/C*

**Floors**

Type	Class	Display Group	Floor Size	Beds	Baths	Yr Blt	Eff Yr Blt	Inventory
No floor data available								

**Accessories**

Description	Class	Size SqFt	Eff Yr Blt	RMV	Quantity	
ASPHALT DRIVEWAY	1	2054	1999	5423	1	Exception: Y N

**Improvements - Accessory Buildings**

Bldg: 2 Code Area: 92430 Stat Class: 351 Year Blt: 1993 Eff Year Blt: 1993 Sq.Ft: 880 % Complete: 100  
 Desc: General Purpose Building (GB) Dimensions: 40x22 RMV: 7700  
 Func Obsc: 100 Econ %: 100 Other %: 100 Exception: 0 Adjust: Adjust RMV: 0

*1999 I/O 2009 m/m interior updates*

*Interior update L4 shows*

**Floors**

Type	Class	Display Group	Floor Size	Beds	Baths	Yr Blt	Eff Yr Blt	Inventory	Exception:
General Purpose Bldg	5	Finished	880	0	0	1993	1993	FAIR	Y N

*1 Avg m/m*

**Accessories**

Description	Class	Size SqFt	Eff Yr Blt	RMV	Quantity
No accessory data available					

Bldg: 3 Code Area: 92430 Stat Class: 301 Year Blt: 1990 Eff Year Blt: 1990 Sq.Ft: 54 % Complete: 100  
 Desc: Accessory Improvements & Misc. Dimensions: 9x6 RMV: 0  
 Func Obsc: 100 Econ %: 100 Other %: 100 Exception: 0 Adjust: Adjust RMV: 0

**Floors**

Type	Class	Display Group	Floor Size	Beds	Baths	Yr Blt	Eff Yr Blt	Inventory	Exception:
Pump House	0	Finished	54	0	0	1990	1990		Y N

**Accessories**

Description	Class	Size SqFt	Eff Yr Blt	RMV	Quantity
No accessory data available					

Bldg: 4 Code Area: 92430 Stat Class: 351 Year Blt: 1990 Eff Year Blt: 1990 Sq.Ft: 576 % Complete: 100  
 Desc: General Purpose Building (GB) Dimensions: 24x24 RMV: 3000  
 Func Obsc: 100 Econ %: 100 Other %: 100 Exception: 0 Adjust: Adjust RMV: 0

*1999 I/O*

*Condition Fair.*

*I/O*

**Floors**

Type	Class	Display Group	Floor Size	Beds	Baths	Yr Blt	Eff Yr Blt	Inventory	Exception:
General Purpose Bldg	5	Finished	576	0	0	1990	1990	FAIR	Y N

*5 I/O*

*0*

**Accessories**

Description	Class	Size SqFt	Eff Yr Blt	RMV	Quantity
No accessory data available					

Bldg: 6 Code Area: 92430 Stat Class: 356 Year Blt: 1990 Eff Year Blt: 1990 Sq.Ft: 288 % Complete: 100  
 Desc: Lean-to Excellent (LTE) Dimensions: 12x24 RMV: 1000  
 Func Obsc: 100 Econ %: 100 Other %: 100 Exception: 0 Adjust: Adjust RMV: 0

*N/C*

**Floors**

Type	Class	Display Group	Floor Size	Beds	Baths	Yr Blt	Eff Yr Blt	Inventory	Exception:
Lean-to Excellent	4	Finished	288	0	0	1990	1990		Y N

**Accessories**

Description	Class	Size SqFt	Eff Yr Blt	RMV	Quantity
No accessory data available					

Bldg: 7 Code Area: 92430 Stat Class: 351 Year Blt: 2017 Eff Year Blt: 2017 Sq.Ft: 2184 % Complete: 100  
 Desc: General Purpose Building (GB) Dimensions: 52x36 RMV: 35550  
 Func Obsc: 100 Econ %: 100 Other %: 100 Exception: 0 Adjust: Adjust RMV: 0

*I/O*

**Floors**

Type	Class	Display Group	Floor Size	Beds	Baths	Yr Blt	Eff Yr Blt	Inventory	Exception:
Loft	5	Finished	312	0	0	0	0		Y N
General Purpose Bldg	5	Finished	1872	0	0	2017	2017	FAIR	Y N

*1 Avg*

*0*

**Accessories**

Description	Class	Size SqFt	Eff Yr Blt	RMV	Quantity
No accessory data available					

ACCOUNT # 532493 DATE: 11/9/25 RMV CLASS SS1 PROP CLASS 451  
 MTL \_\_\_\_\_ APPR GRH TAG Y N \_\_\_\_\_  
 COMMENTS: \_\_\_\_\_

RESIDENCE / MANUFACTURED STRUCTURES

ACCESSORY IMPROVEMENTS OUTBUILDINGS

STAT \_\_\_\_\_ QLTY + - FLOOR \_\_\_\_\_  
 AREA \_\_\_\_\_ EFF AREA \_\_\_\_\_ BED \_\_\_\_\_  
 ROOF + HVAC +  
 BATH PKG: \_\_\_\_\_ BATH \_\_\_\_\_ BATH + \_\_\_\_\_ 1/2 BTH  
 FIREPLACE: \_\_\_\_\_  
 KITCHEN - +  
 YR BLT \_\_\_\_\_ EFF YR \_\_\_\_\_ ECON \_\_\_\_\_  
 % COMP \_\_\_\_\_ % GOOD \_\_\_\_\_ FUNC \_\_\_\_\_  
 EXCEPT Y N LUMP SUM: \_\_\_\_\_  
 MISC: \_\_\_\_\_  
 YI CLASS \_\_\_\_\_ F G A E  
 SKIRT + LIN FT \_\_\_\_\_  
 COMMENT: \_\_\_\_\_

STAT \_\_\_\_\_ QLTY + - FLOOR \_\_\_\_\_  
 AREA \_\_\_\_\_ EFF AREA \_\_\_\_\_ BED \_\_\_\_\_  
 ROOF + HVAC +  
 BATH PKG: \_\_\_\_\_ BATH \_\_\_\_\_ BATH + \_\_\_\_\_ 1/2 BTH  
 FIREPLACE: \_\_\_\_\_  
 KITCHEN - +  
 YR BLT \_\_\_\_\_ EFF YR \_\_\_\_\_ ECON \_\_\_\_\_  
 % COMP \_\_\_\_\_ % GOOD \_\_\_\_\_ FUNC \_\_\_\_\_  
 EXCEPT Y N LUMP SUM: \_\_\_\_\_  
 MISC: \_\_\_\_\_  
 YI CLASS \_\_\_\_\_ F G A E  
 SKIRT + LIN FT \_\_\_\_\_  
 COMMENT: \_\_\_\_\_

STAT \_\_\_\_\_ QLTY + - FLOOR \_\_\_\_\_  
 AREA \_\_\_\_\_ EFF AREA \_\_\_\_\_ BED \_\_\_\_\_  
 ROOF + HVAC +  
 BATH PKG: \_\_\_\_\_ BATH \_\_\_\_\_ BATH + \_\_\_\_\_ 1/2 BTH  
 FIREPLACE: \_\_\_\_\_  
 KITCHEN - +  
 YR BLT \_\_\_\_\_ EFF YR \_\_\_\_\_ ECON \_\_\_\_\_  
 % COMP \_\_\_\_\_ % GOOD \_\_\_\_\_ FUNC \_\_\_\_\_  
 EXCEPT Y N LUMP SUM: \_\_\_\_\_  
 MISC: \_\_\_\_\_  
 YI CLASS \_\_\_\_\_ F G A E  
 SKIRT + LIN FT \_\_\_\_\_  
 COMMENT: \_\_\_\_\_

TYPE GB  
 STAT / CLASS 5  
 SIZE 36x90  
 FAIR 24x12  
AVERAGE (2) excellent  
 GOOD 12x12 utility  
 EXCELLENT Good room  
 BATH I.F.B pkg  
 YR BLT 2024  
 EFF YR 2024  
 % COMP 100  
 EXCEPT Y N  
 MISC: \_\_\_\_\_  
 COMMENT: \_\_\_\_\_

TYPE \_\_\_\_\_  
 STAT / CLASS \_\_\_\_\_  
 SIZE \_\_\_\_\_  
 FAIR \_\_\_\_\_  
 AVERAGE \_\_\_\_\_  
 GOOD \_\_\_\_\_  
 EXCELLENT \_\_\_\_\_  
 BATH \_\_\_\_\_  
 YR BLT \_\_\_\_\_  
 EFF YR \_\_\_\_\_  
 % COMP \_\_\_\_\_  
 EXCEPT Y N  
 MISC: \_\_\_\_\_  
 COMMENT: \_\_\_\_\_

TYPE \_\_\_\_\_  
 STAT / CLASS \_\_\_\_\_  
 SIZE \_\_\_\_\_  
 FAIR \_\_\_\_\_  
 AVERAGE \_\_\_\_\_  
 GOOD \_\_\_\_\_  
 EXCELLENT \_\_\_\_\_  
 BATH \_\_\_\_\_  
 YR BLT \_\_\_\_\_  
 EFF YR \_\_\_\_\_  
 % COMP \_\_\_\_\_  
 EXCEPT Y N  
 MISC: \_\_\_\_\_  
 COMMENT: \_\_\_\_\_

TYPE \_\_\_\_\_  
 STAT / CLASS \_\_\_\_\_  
 SIZE \_\_\_\_\_  
 FAIR \_\_\_\_\_  
 AVERAGE \_\_\_\_\_  
 GOOD \_\_\_\_\_  
 EXCELLENT \_\_\_\_\_  
 BATH \_\_\_\_\_  
 YR BLT \_\_\_\_\_  
 EFF YR \_\_\_\_\_  
 % COMP \_\_\_\_\_  
 EXCEPT Y N  
 MISC: \_\_\_\_\_  
 COMMENT: \_\_\_\_\_

TYPE \_\_\_\_\_  
 STAT / CLASS \_\_\_\_\_  
 SIZE \_\_\_\_\_  
 FAIR \_\_\_\_\_  
 AVERAGE \_\_\_\_\_  
 GOOD \_\_\_\_\_  
 EXCELLENT \_\_\_\_\_  
 BATH \_\_\_\_\_  
 YR BLT \_\_\_\_\_  
 EFF YR \_\_\_\_\_  
 % COMP \_\_\_\_\_  
 EXCEPT Y N  
 MISC: \_\_\_\_\_  
 COMMENT: \_\_\_\_\_

TYPE \_\_\_\_\_  
 STAT / CLASS \_\_\_\_\_  
 SIZE \_\_\_\_\_  
 FAIR \_\_\_\_\_  
 AVERAGE \_\_\_\_\_  
 GOOD \_\_\_\_\_  
 EXCELLENT \_\_\_\_\_  
 BATH \_\_\_\_\_  
 YR BLT \_\_\_\_\_  
 EFF YR \_\_\_\_\_  
 % COMP \_\_\_\_\_  
 EXCEPT Y N  
 MISC: \_\_\_\_\_  
 COMMENT: \_\_\_\_\_

# SKETCH/AREA TABLE ADDENDUM

## SUBJECT INFO

File No.: 532493 Parcel No.: 083W19C 00400  
 Property Address: 6725 SKYLINE RD S  
 City: SALEM County: Marion State: OR ZipCode: 97306  
 Owner:  
 Client: Client Address:  
 Appraiser Name: Inspection Date:

## SKETCH

532493  
083W19C 00400  
SCALE=1:20

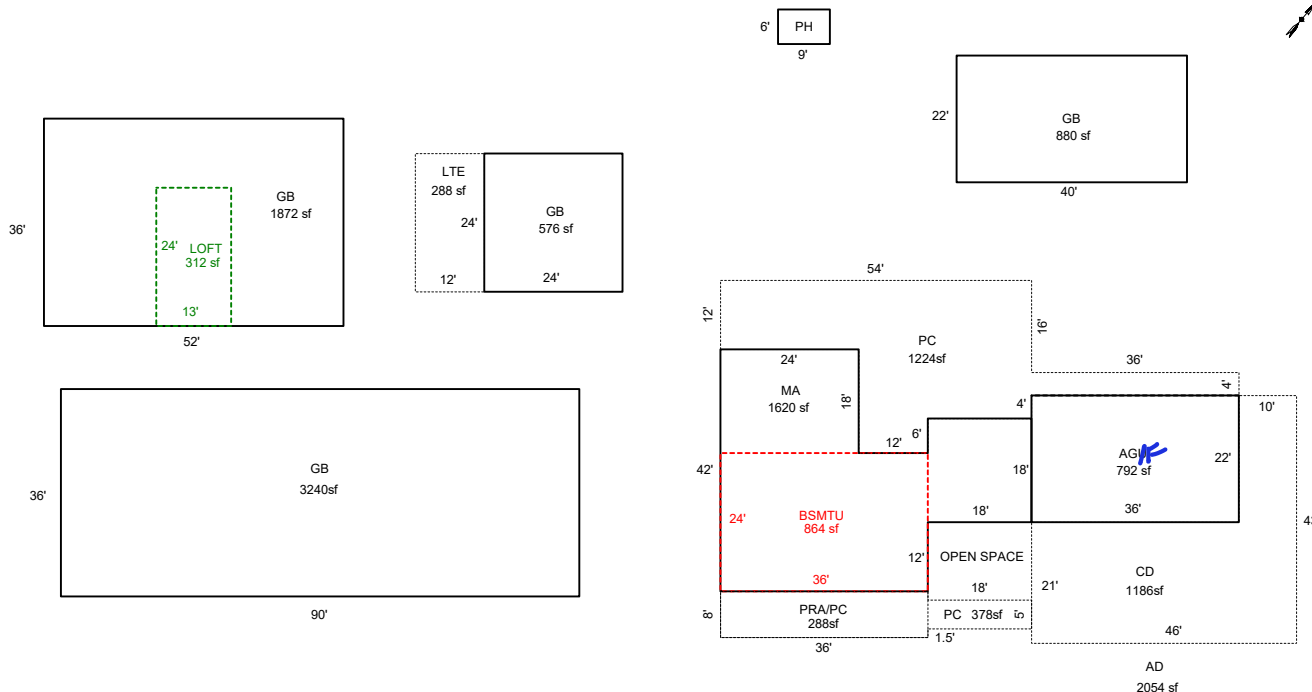

Sketch by ApexSketch

### AREA CALCULATIONS SUMMARY

Code	Description	Factor	Net Size	Perimeter	Net Totals
GBA1	GB	1.0	880.0	124.0	
	GB	1.0	576.0	96.0	
	PH	1.0	54.0	30.0	
	LTE	1.0	288.0	72.0	
	GB	1.0	1872.0	176.0	
	GB	1.0	3240.0	252.0	6910.0
GBA2	LOFT	1.0	312.0	74.0	312.0
GLA1	MA	1.0	1620.0	204.0	1620.0
BSMT	BSMTU	1.0	864.0	120.0	864.0
GAR	AGU	1.0	792.0	116.0	792.0
P/P	PC	1.0	1224.0	240.0	
	CD	1.0	1186.0	178.0	
	PC	1.0	378.0	124.0	
	PRA/PC	1.0	288.0	88.0	3076.0
	Net LIVABLE	cnt	0	(rounded)	1,620
	Net BUILDING	cnt	7	(rounded)	7,222

### COMMENT TABLE 1

APEX by AC 2/27/13  
 UPDATED BY JRONDEMA 7/12/16  
 UPDATED BY JRONDEMA 3/1/17  
 UPDATED BY JRONDEMA 1/10/18  
 UPD BY PHU 06.10.20  
 UPDATED BY CLOBERG 11/20/24 24-002785 REV GB

### COMMENT TABLE 2

10.23.19 NM #35: S.V.

*GRH 1/12/25*

### COMMENT TABLE 3

*TAGS L2*

