

Acct ID: 523709 MTL: 072W26A000300 Date: 4/16/25 Appr: MLH Prop Class: 551 RMV Prop Class: 451
Situs: 673 HOWELL PRAIRIE RD NE SALEM OR 97317 MaSaNh: 03 06 000 Unit: 65695 Year: 2025

Last Date Appraised: 10/08/2014 Appraiser: MATTHEW HAMILTON Retag: Y N Tag info:
Owner: WANTZ, PAULINE M Roll Type: R
Cycle Tag Sales Verification Other: vet disqual Inspection level: 1 2 3 4 LCB TTO INSP AV: 191370
RMV Land: 310050 RMV Imp: 322090 RMV Total: 632140 MAV: 162010 MSAV: 29360 SAV: 69882
Comment: MLS 821148

update inventory

Input MLH 4/30/25

Farm Seed

Notations

Table with 3 columns: RP/MS, Code, Description. Row 1: RP, ZONED, FARM EFU ZONED

OSDs

Table with 6 columns: Count, Code, Description, RMV, Code Area, Exception. Row 1: 1, SAA, SA OSD - AVERAGE, 50000, 40410, 0

Land

Site: 2 Code Area: 40410 Size: 1.00 Acres Use Code: 005 Zone: REST SAV Use: 011 Exception: 0
Class: Value Source: Farm Homesite Description: RMV: 36140 Exception: Y N
Adjustment(s): GSOIL, IRR Fire Patrol: Description:
Comments: Liability year - 2009 / 400210
Site: 3 Code Area: 40410 Size: 4.84 Acres Use Code: 005 Zone: REST SAV Use: 011 Exception: 0
Class: 2BI Value Source: Farm Use - EFU Description: TWO BENCH IRR RMV: 201150 Exception: Y N
Adjustment(s): GSOIL, IRR Fire Patrol: Description:
Comments: Liability year - 1974 / 400210
Site: 4 Code Area: 40410 Size: 0.60 Acres Use Code: 005 Zone: REST SAV Use: 011 Exception: 0
Class: 4BI Value Source: Farm Use - EFU Description: FOUR BENCH IRR RMV: 22760 Exception: Y N
Adjustment(s): GSOIL, IRR Fire Patrol: Description:
Comments: Liability year - 1974 / 400210//01-02; CHANGED SOIL CLASS FROM 3 BENCH IRR TO 4 BENCH IRR

Improvements - Residence / Manufactured Structures

Bldg: 1 Code Area: 40410 Stat Class: 142 Year Blt: 1930 Eff Year Blt: 1978 Sq.Ft: 1611 % Complete: 100
Desc: Multi Story above grade Dimensions: RMV: 269320
Func Obsc: 100 Econ %: 100 Other %: 100 Exception: 0 Adjust: Adjust RMV: 0

Floors

Table with 10 columns: Type, Class, Display Group, Floor Size, Beds, Baths, Yr Blt, Eff Yr Blt, Inventory, Exception. Rows for First Floor, Attic, and Carport Detached.

Accessories

Table with 6 columns: Description, Class, Size SqFt, Eff Yr Blt, RMV, Quantity. Row: YARD IMPROVEMENTS GOOD

Bldg: 2 Code Area: 40410 Stat Class: 148 Year Blt: 1951 Eff Year Blt: 1962 Sq.Ft: 0 % Complete: 100
Desc: Res other improvements Dimensions: RMV: 43620
Func Obsc: 100 Econ %: 100 Other %: 100 Exception: 0 Adjust: Adjust RMV: 0

Floors

Table with 10 columns: Type, Class, Display Group, Floor Size, Beds, Baths, Yr Blt, Eff Yr Blt, Inventory, Exception. Row: Garage Detached

Accessories

Table with 6 columns: Description, Class, Size SqFt, Eff Yr Blt, RMV, Quantity. Row: No accessory data available

Improvements - Accessory Buildings

Bldg: 3 Code Area: 40410 Stat Class: 341 Year Blt: 1995 Eff Year Blt: 1995 Sq.Ft: 140 % Complete: 100
Desc: Multi Purpose Shed (MP) Dimensions: 14x10 RMV: 1700
Func Obsc: 100 Econ %: 100 Other %: 100 Exception: 0 Adjust: Adjust RMV: 0

Floors

Type	Class	Display Group	Floor Size	Beds	Baths	Yr Blt	Eff Yr Blt	Inventory	
Multi-Purpose Bldg	5	Finished	140	0	0	1995	1995	FAIR	Exception: Y N

**Accessories**

Description	Class	Size SqFt	Eff Yr Blt	RMV	Quantity
No accessory data available					

Bldg: 4 Code Area: 40410 Stat Class: 341 Year Blt: 1995 Eff Year Blt: 1995<sup>2009</sup> Sq.Ft: 110 % Complete: 100  
 Desc: Multi Purpose Shed (MP) Dimensions: 11x10 RMV: 1340  
 Func Obsc: 100 Econ %: 100 Other %: 100 Exception: 0 Adjust: Adjust RMV: 0 I/O

**Floors**

Type	Class	Display Group	Floor Size	Beds	Baths	Yr Blt	Eff Yr Blt	Inventory	
Multi-Purpose Bldg	5	Finished	110	0	0	1995	1995	FAIR	Exception: Y N

**Accessories**

Description	Class	Size SqFt	Eff Yr Blt	RMV	Quantity
No accessory data available					

Bldg: 5 Code Area: 40410 Stat Class: 312 Year Blt: 1995 Eff Year Blt: 1995<sup>2009</sup> Sq.Ft: 660 % Complete: 100  
 Desc: Loft Barn (LB) Dimensions: 30x22 RMV: 6110  
 Func Obsc: 50 Econ %: 100 Other %: 100 Exception: 0 Adjust: Adjust RMV: 0 I/O

**Floors**

Type	Class	Display Group	Floor Size	Beds	Baths	Yr Blt	Eff Yr Blt	Inventory	
Loft Barn	6	Finished	660	0	0	1995	1995	FAIR	Exception: Y N

**Accessories**

Description	Class	Size SqFt	Eff Yr Blt	RMV	Quantity
No accessory data available					

# SKETCH/AREA TABLE ADDENDUM

## SUBJECT INFO

File No.: 523709 Parcel No.: 072W26A 00300  
 Property Address: 673 HOWELL PRAIRIE RD NE  
 City: SALEM County: MARION State: OR ZipCode: 97317  
 Owner:  
 Client: Client Address:  
 Appraiser Name: Inspection Date:

## SKETCH

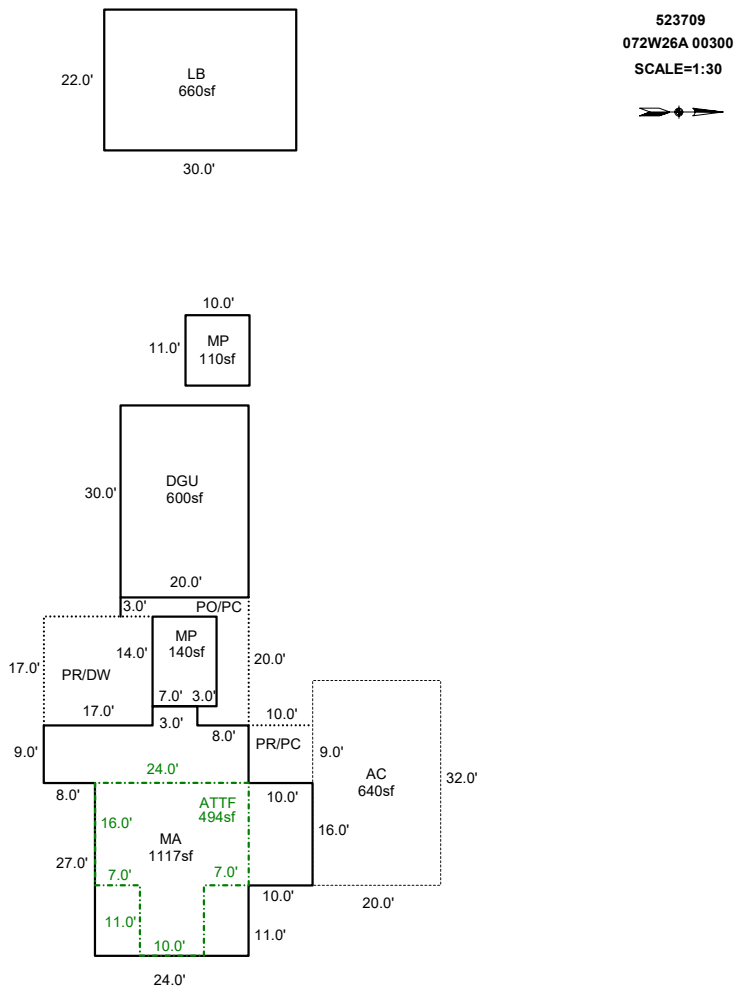

### AREA CALCULATIONS SUMMARY

Code	Description	Factor	Net Size	Perimeter	Net Totals
GBA1	MP	1.0	110.0	42.0	
	MP	1.0	140.0	48.0	
	LB	1.0	660.0	104.0	910.0
GLA1	MA	1.0	1117.0	162.0	1117.0
GLA2	ATTF	1.0	494.0	102.0	494.0
GAR	AC	1.0	640.0	104.0	
	DGU	1.0	600.0	100.0	1240.0
	Net LIVABLE	cnt	0 (rounded)		1,611
	Net BUILDING	cnt	3 (rounded)		910

### COMMENT TABLE 1

DRAWN BY JRONDEMA 12/14/17  
 UPDATED BY CLOBERG 04/30/25

### COMMENT TABLE 2

MLH 04/16/25

### COMMENT TABLE 3

VET DQ L3

# SKETCH/AREA TABLE ADDENDUM

Parcel No 072W26A 00300

File No R23709

Property Address 673 HOWELL PRAIRIE RD NE

City SALEM

County MARION

State OR

Zip 97317

Owner

Client

Appraiser Name

SUBJECT

IMPROVEMENTS SKETCH

R23709  
072W26A 00300  
SCALE=1:30

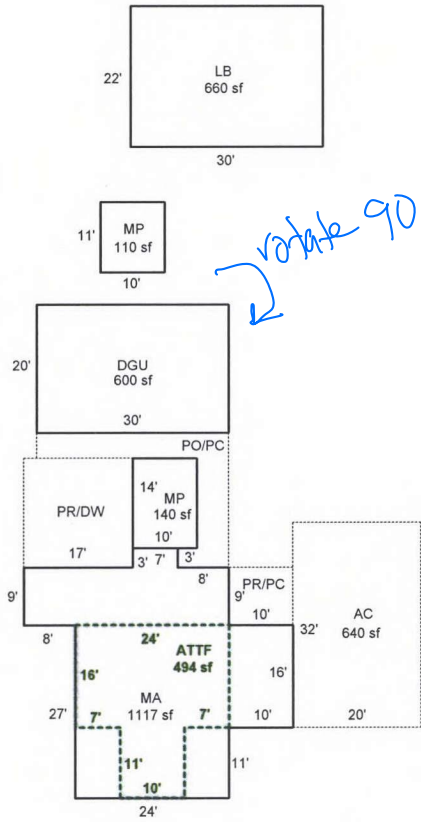

Scale: 1" = 30'

AREA CALCULATIONS

### AREA CALCULATIONS SUMMARY

Code	Description	Factor	Net Size	Perimeter	Net Totals
GLA1	MA	1.00	1117	162	1117
GLA2	ATTF	1.00	494	102	494
GBA1	MP	1.00	110	42	
	MP	1.00	140	48	
GAR	LB	1.00	660	104	910
	AC	1.00	640	104	
	DGU	1.00	600	100	1240
Net LIVABLE Area (rounded w/ factors)					1611
Net BUILDING Area (rounded w/ factors)					910

#### Comment Table 1

DRAWN BY JRONDEMA 12/14/17

#### Comment Table 2

4/16/25 MCH

#### Comment Table 3

ref ds equal L3



















2004  
2004









R23709

LB

10/8/14



R23709

DGV and MP

10/8/14



R23709

PO/PC between Res + DGU

10/8/14



R23709

MP 14x10

10/8/14



R23709

DC

10/8/14



R23709

MA-rear PR/DW

10/8/14



R23709

MA

10/8/14