

Summary

Lead Appr: \_\_\_\_\_ Clerk: \_\_\_\_\_ Lead Clerk: \_\_\_\_\_ Appr: \_\_\_\_\_

Print Date:

4/16/2025

Acct ID: 528122 MTL: 081W070001300 Date: 4/28/25 Appr: MLH Prop Class: 551 RMV Prop Class: 551 451  
Situs: 9771 JORDAN ST SE AUMSVILLE OR 97325 MaSaNh: 01 06 000 Unit: 30679 Year: 2025

Last Date Appraised: 05/09/2017 Appraiser: CLINT LUKE Retag: Y N Tag info:

Owner: WIPLG1 LLC Roll Type: R

Cycle Tag Sales Verification Other: Clean up Inspection level: 1 2 3 4 LCB TTO INSP AV: 296413

RMV Land: 76190 RMV Imp: 456430 RMV Total: 532620 MAV: 286520 MSAV: 9893 SAV: 18471

Comment:

update inventory

Input MLH 4/28/25

Notations

RP/MS	Code	Description
RP	ZONED	FARM EFU ZONED

Farm vineyard

OSDs

Count	Code	Description	RMV	Code Area	Exception
1	SAA	SA OSD - AVERAGE	50000	05558	0

Land

Site: 2 Code Area: 05558 Size: 1.00 Acres Use Code: 005 Zone: REST SAV Use: 011 Exception: 0  
 Class: Value Source: Farm Homesite Description: RMV: 7190 Exception: Y N  
 Adjustment(s): GSOIL, WASTE, IRR Fire Patrol: Description:  
 Comments: Liability year - 2009 / 00560050 /01-02: update of pt information and value.

Site: 3 Code Area: 05558 Size: 1.82 Acres Use Code: 005 Zone: REST SAV Use: 011 Exception: 0  
 Class: 4HI Value Source: Farm Use - EFU Description: FOUR HILL IRR RMV: 13740 Exception: Y N  
 Adjustment(s): GSOIL, WASTE, IRR Fire Patrol: Description:  
 Comments: Liability year - 1974 / 05600050 /01-02; CHANGED SOIL CLASS FROM 3 HILL DRY TO 4 HILL DRY.

Site: 4 Code Area: 05558 Size: 0.60 Acres Use Code: 005 Zone: REST SAV Use: 011 Exception: 0  
 Class: 2HI Value Source: Farm Use - EFU Description: TWO HILL IRR RMV: 4970 Exception: Y N  
 Adjustment(s): GSOIL, WASTE, IRR Fire Patrol: Description:  
 Comments: Liability year - 1980 / 00560050

Site: 5 Code Area: 05558 Size: 0.50 Acres Use Code: 005 Zone: REST SAV Use: 011 Exception: 0  
 Class: WST Value Source: Farm Use - EFU Description: Rural WASTELAND RMV: 290 Exception: Y N  
 Adjustment(s): GSOIL, WASTE, IRR Fire Patrol: Description:  
 Comments: Liability year - 1980 / 0560050

Improvements - Residence / Manufactured Structures

Bldg: 1 Code Area: 05558 Stat Class: 144 Year Blt: 1966 Eff Year Blt: 1966 Sq.Ft: 3652 % Complete: 100  
 Desc: Multi Story above grade with basement Dimensions: RMV: 445130  
 Func Obsc: 100 Econ %: 100 Other %: 100 Exception: 0 Adjust: Adjust RMV: 0

Floors

Type	Class	Display Group	Floor Size	Beds	Baths	Yr Blt	Eff Yr Blt	Inventory	Exception
First Floor	4	Finished	1342	1	FB-1	1966	1966	BATH - 1, KIT+, HVAC, FP - 2, ROOF	Y N
Second Floor	4	Finished	968	2	FB-2	1966	1966	BATH - 2, HVAC	Y N
Basement	4	Finished	1342	1	FB-1	1966	1966	BATH - 1, HVAC	Y N
Carport Attached	4	Unfinished	528	0	0	1966	1966	ROOF	Y N

Accessories

Description	Class	Size SqFt	Eff Yr Blt	RMV	Quantity	Exception
YARD IMPROVEMENTS AVERAGE	4	1	1966	23112	1	Y N

Bldg: 2 Code Area: 05558 Stat Class: 108 Year Blt: 1966 Eff Year Blt: 1966 Sq.Ft: 0 % Complete: 100  
 Desc: Residential Other Improvements Dimensions: RMV: 10800  
 Func Obsc: 100 Econ %: 100 Other %: 100 Exception: 0 Adjust: Adjust RMV: 0

Floors

Type	Class	Display Group	Floor Size	Beds	Baths	Yr Blt	Eff Yr Blt	Inventory
No floor data available								

Accessories

Description	Class	Size SqFt	Eff Yr Blt	RMV	Quantity	Exception
ASPHALT DRIVEWAY	1	6000	1966	10800	1	Y N

Improvements - Accessory Buildings

Bldg: 3 Code Area: 05558 Stat Class: 301 Year Blt: Eff Year Blt: 1966 Sq.Ft: 196 % Complete: 100

Desc: Accessory Improvements & Misc.

Dimensions: 14x14 RMV: 500

Func Obsc: 100

Econ %: 100

Other %: 100

Exception: 0

Adjust:

Adjust RMV: 0

**Floors** 092200, Part of XI move MAD

Type	Class	Display Group	Floor Size	Beds	Baths	Yr Blt	Eff Yr Blt	Inventory
Building Structure	4	Finished	196	0	0	0	1966	Exception: Y N

**Accessories**

Description	Class	Size SqFt	Eff Yr Blt	RMV	Quantity
No accessory data available					

R28122  
081W07 01300  
SCALE=1:20

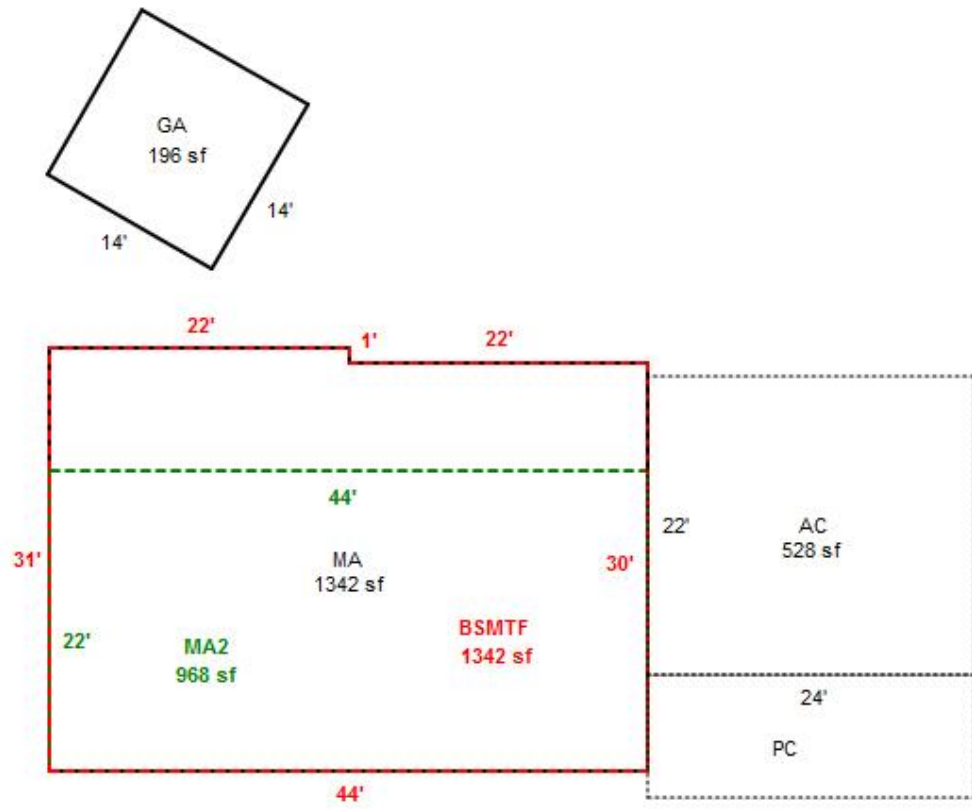

4/28/25 MLH Clean Up L4

R28122  
081W07 01300  
SCALE=1:20

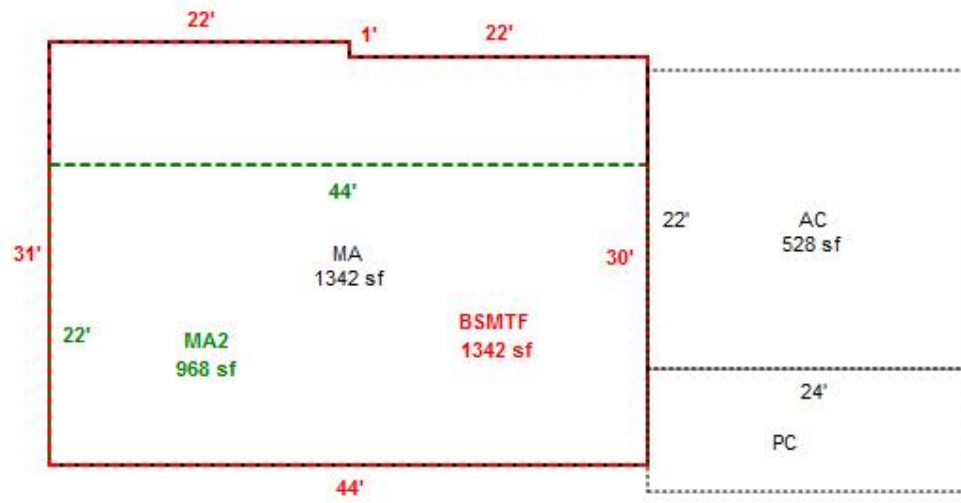
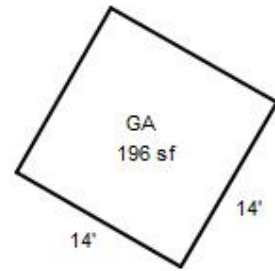



R28122

MA, MA2, AC

5/9/17



R28122

MA, MA2, AC

NE SIDE

5/9/17



R28122

GA

5/9/17

A two-story house with beige horizontal siding and a dark brown deck. The house has a gabled roof with a white downspout. There are several windows, some with white frames. The house is surrounded by green trees and a lawn. The text is overlaid in red on the left side of the image.

R28122

MA, MA2, BSM TF

SW SIDE

5/9/17