

Acct ID: 534765 MTL: 091W12D000100 Date: 3-26-25 Appr: Luca Prop Class: 551 RMV Prop Class: 551
 Situs: 15134 OLD MEHAMA RD SE STAYTON OR 97383 MaSaNh: 01 06 000 Unit: 39143 **IMPOT 4-8-25 Luca** Year: 2025
 Last Date Appraised: 09/12/2012 Appraiser: CLINT LUKE Retag: Y Tag info: _____
 Owner: WILSON, CHASE T & WILSON, CASSANDRA Roll Type: R
 Cycle Tag Sales Verification Other: _____ Inspection level: 1 2 3 4 LCB TTO INSP AV: 232379
 RMV Land: 422380 RMV Imp: 314530 RMV Total: 736910 MAV: 206820 MSAV: 25559 SAV: 70547
 Comment: _____

Notations

RP/MS	Code	Description
MS	ZONED	FARM EFU ZONED

OSDs

Count	Code	Description	RMV	Code Area	Exception
2	SAF	SA OSD - FAIR	40000	29540	0

Land

Carroll + Horses
 Site: 1 Code Area: 29540 Size: 1.00 Acres Use Code: 005 Zone: REST SAV Use: 011 Exception: 0
 Class: Value Source: Farm Homesite Description: RMV: 25790 Exception: Y N
 Adjustment(s): GSOIL, IRR, WASTE Fire Patrol: SA004 Description: FIRE PATROL

Comments: Liability year - 2009 / 20-21: UPDATE PART TOTALS / 13-14: PER #36, CHG OSD FROM AVG TO FAIR / 02900040: 02-03: REAPPRAISAL - REMOVED 2ND OSD AS MANUF STRUCTURE HAS BEEN REMOVED FROM THE PROPERTY

Site: 2 Code Area: 29540 Size: 11.50 Acres Use Code: 005 Zone: REST SAV Use: 011 Exception: 0
 Class: 2BISS Value Source: Farm Use - EFU Description: TWO BENCH IRR SOUTH SPECIAL RMV: 341110 Exception: Y N
 Adjustment(s): GSOIL, IRR, WASTE Fire Patrol: SA004 Description: FIRE PATROL

Comments: Liability year - 1980

Site: 3 Code Area: 29540 Size: 7.50 Acres Use Code: 005 Zone: REST SAV Use: 011 Exception: 0
 Class: WST Value Source: Farm Use - EFU Description: Rural WASTELAND RMV: 15480 Exception: Y N
 Adjustment(s): GSOIL, IRR, WASTE Fire Patrol: SA004 Description: FIRE PATROL

Comments: Liability year - 1980 / 20-21: UPDATE PART TOTALS / 16-17: PER #36, SOIL CLASS CHGS / 2900000; 01-02; CONVERTED 16.50 ACRES OF WASTELAND INTO WOODLOT .02-03: F01-541 MAP CORRECTION .

Improvements - Residence / Manufactured Structures

Bldg: 1 Code Area: 29540 Stat Class: 144 - Year Blt: 1950 Eff Year Blt: 1950 Sq.Ft: 1836 % Complete: 100
 Desc: Multi Story above grade with basement Dimensions: RMV: 259390
 Func Obsc: 100 Econ %: 100 Other %: 100 Exception: 0 Adjust: Adjust RMV: 0

Floors

Type	Class	Display Group	Floor Size	Beds	Baths	Yr Blt	Eff Yr Blt	Inventory	Exception
First Floor	4 -	Finished	1224	1	FB-1	1950	1950	KIT, HVAC, ROOF, BATH - 1	Y N
Attic	4 -	Finished	612	3	FB-1	1950	1950	HVAC, BATH - 1	Y N
Basement	4 -	Unfinished	1224	0	0	1950	1950		Y N

All Avg

Accessories

Description	Class	Size SqFt	Eff Yr Blt	RMV	Quantity	Exception
YARD IMPROVEMENTS AVERAGE	4	1	1950	21186	1	Y N

Bldg: 2 Code Area: 29540 Stat Class: 148 Year Blt: 1950 Eff Year Blt: 1950 Sq.Ft: 484 % Complete: 100
 Desc: Res other improvements Dimensions: 22x22 RMV: 37330
 Func Obsc: 100 Econ %: 100 Other %: 100 Exception: 0 Adjust: Adjust RMV: 0

Floors

Type	Class	Display Group	Floor Size	Beds	Baths	Yr Blt	Eff Yr Blt	Inventory	Exception
Garage Detached	4	Finished	484	0	0	1950	1950	ROOF	Y N

Accessories

Description	Class	Size SqFt	Eff Yr Blt	RMV	Quantity
No accessory data available					

Improvements - Accessory Buildings

Bldg: 3 Code Area: 29540 Stat Class: 353 Year Blt: 1979 Eff Year Blt: 1979 Sq.Ft: 1872 % Complete: 100
 Desc: Machine Shed (MS) Dimensions: 78x24 RMV: 5530
 Func Obsc: 100 Econ %: 100 Other %: 100 Exception: 0 Adjust: Adjust RMV: 0

Floors

old

Type	Class	Display Group	Floor Size	Beds	Baths	Yr Blt	Eff Yr Blt	Inventory	Exception: Y N
Machine Shed	5	Finished	1872	0	0	1979	1979	FAIR	Y N

Accessories

Description	Class	Size SqFt	Eff Yr Blt	RMV	Quantity
No accessory data available					

Bldg: 4 Code Area: 29540 Stat Class: 353 Year Blt: 1990 Eff Year Blt: 1990 Sq.Ft: 2400 % Complete: 100
 Desc: Machine Shed (MS) Dimensions: 60x40 RMV: 11070
 Func Obsc: 100 Econ %: 100 Other %: 100 Exception: 0 Adjust: Adjust RMV: 0

Floors

Type	Class	Display Group	Floor Size	Beds	Baths	Yr Blt	Eff Yr Blt	Inventory	Exception: Y N
Machine Shed	5	Finished	2400	0	0	1990	1990	FAIR	Y N

Accessories

Description	Class	Size SqFt	Eff Yr Blt	RMV	Quantity
No accessory data available					

Bldg: 5 Code Area: 29540 Stat Class: 353 Year Blt: 2005 Eff Year Blt: 2005 Sq.Ft: 168 % Complete: 100
 Desc: Machine Shed (MS) Dimensions: 12x14 RMV: 1210
 Func Obsc: 100 Econ %: 100 Other %: 100 Exception: 0 Adjust: Adjust RMV: 0

Floors

Type	Class	Display Group	Floor Size	Beds	Baths	Yr Blt	Eff Yr Blt	Inventory	Exception: Y N
Machine Shed	4	Finished	168	0	0	2005	2005		Y N

Accessories

Description	Class	Size SqFt	Eff Yr Blt	RMV	Quantity
No accessory data available					

SKETCH/AREA TABLE ADDENDUM

SUBJECT INFO

File No.: 534765 Parcel No.: 091W12D 00100
 Property Address: 15134 OLD MEHAMA RD SE
 City: SALEM County: Marion State: OR ZipCode:
 Owner:
 Client: Client Address:
 Appraiser Name: Dave Bernards Inspection Date: 2012

SKETCH

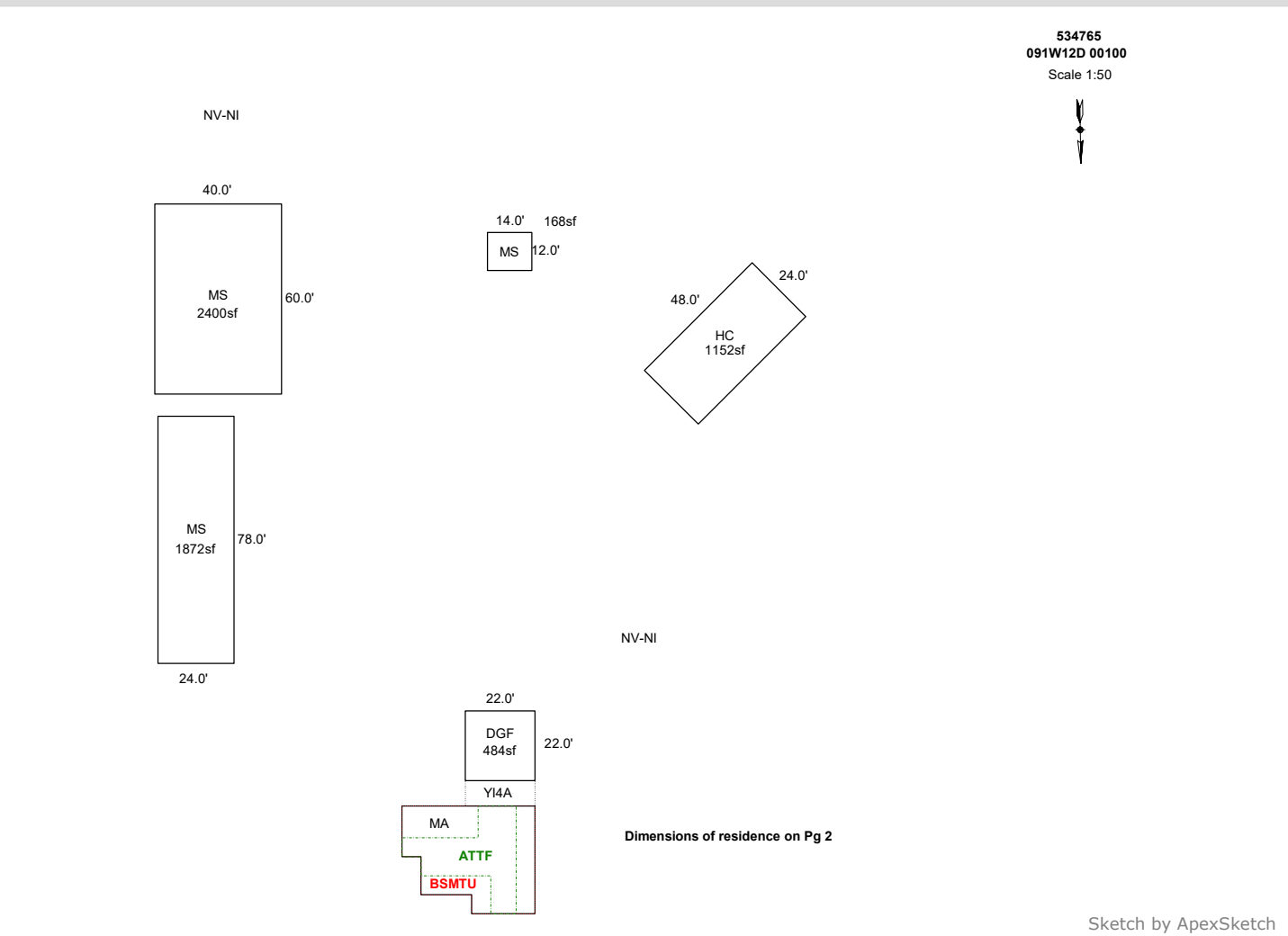

AREA CALCULATIONS SUMMARY						COMMENT TABLE 1	
Code	Description	Factor	Net Size	Perimeter	Net Totals		
GBA1	MS	1.0	1872.0	204.0		APEX by AC 1/2/13 UPDATED BY CLOBERG 03/31/25	
	MS	1.0	2400.0	200.0			
	MS	1.0	168.0	52.0			
	HC	1.0	1152.0	144.0	5592.0		
GLA1	MA	1.0	1224.0	152.0	1224.0		
GLA2	ATTF	1.0	612.0	140.0	612.0		
BSMTU	BSMTU	1.0	1224.0	152.0	1224.0		
DGF	DGF	1.0	484.0	88.0	484.0		
YI	YI4A	1.0	176.0	60.0	176.0		
						COMMENT TABLE 2	COMMENT TABLE 3
						CLUKE 03/26/25	CYCLE L4
		Net LIVABLE	cnt	0 (rounded)	1,836		
		Net BUILDING	cnt	4 (rounded)	5,592		

SKETCH/AREA TABLE ADDENDUM

SUBJECT INFO

File No.: 534765 Parcel No.: 091W12D 00100
 Property Address: 15134 OLD MEHAMA RD SE
 City: SALEM County: Marion State: OR ZipCode:
 Owner:
 Client: Client Address:
 Appraiser Name: Dave Bernards Inspection Date: 2012

SKETCH

534765
091W12D 00100

Layout of all bldgs on Pg 1

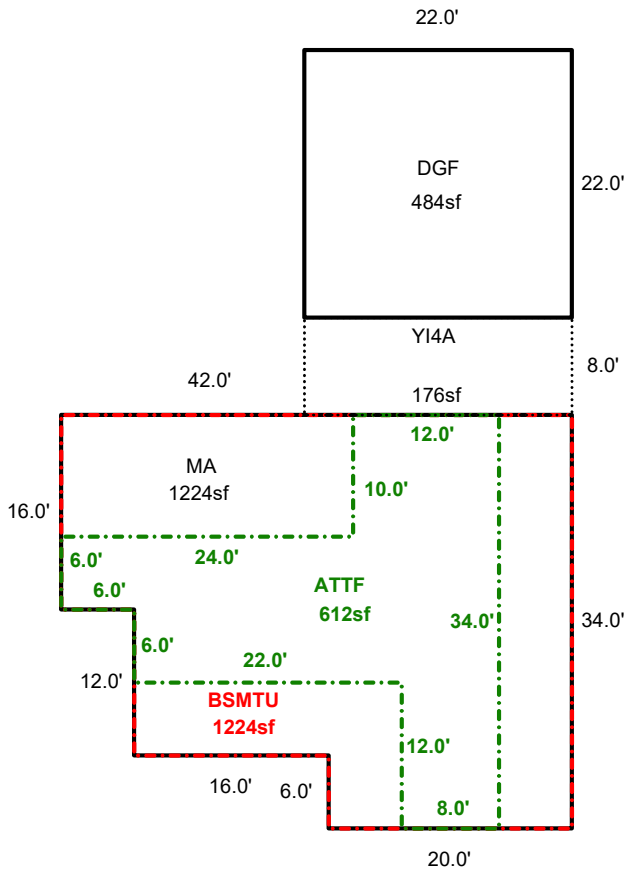

Sketch by ApexSketch

AREA CALCULATIONS SUMMARY

Code	Description	Factor	Net Size	Perimeter	Net Totals
GLA1	MA	1.0	1224.0	152.0	1224.0
GLA2	ATTF	1.0	612.0	140.0	612.0
BSMTU	BSMTU	1.0	1224.0	152.0	1224.0
DGF	DGF	1.0	484.0	88.0	484.0
YI	YI4A	1.0	176.0	60.0	176.0

COMMENT TABLE 1

APEX by AC 1/2/13
 UPDATED BY CLOBERG 03/31/25

COMMENT TABLE 2

CLUKE 03/26/25

COMMENT TABLE 3

CYCLE L4

Net LIVABLE cnt 0 (rounded) 1,836