

Acct ID: 532520 MTL: 083W20D000300 Date: 5/28/25 Appr: GRH Prop Class: 641 RMV Prop Class: 401
 Situs: 2352 Jony hill MaSaNh: 06 06 000 Unit: 30995 Year: 2025
 Last Date Appraised: 12/03/2024 Appraiser: GERARDO RAMIREZ HERNANDEZ Retag: N Tag info: 2026 - Tags/Permit (Completion)
 Owner: HIEBERT LT Roll Type: R
 Cycle Tag Sales Verification Other: Forest check Inspection level: 1 2 3 4 LCB TTO INSP AV: 390008
 RMV Land: 441400 RMV Imp: 349430 RMV Total: 790830 MAV: 0 MSAV: 5578 SAV: 10814
 Comment: 25-26: L2 12.03.24 GRH
 23-24 L4 03.16.23 WW

Notations

No notation data available.

Forest ok - replanted.

OSDs

Count	Code	Description	RMV	Code Area	Exception
1	MKTN	OSD - NO LANDSCAPE	35000	92430	35000

Land

DQ 1 ac for home site

Site: 1 Code Area: 92430 Size: 9.74 Acres Use Code: 005 Zone: REST SAV Use: 011 Exception: 0
 Class: FTLC Value Source: Designated Forest Land Description: DFL Class C RMV: 406400 Exception: Y N
 Adjustment(s): Fire Patrol: Description:
 Comments: Liability year - 2025 (was 1981)

13-14: UPDATED PART TOTALS / 2400230: 01-02; CHANGED SOIL CLASS FROM 3 HILL DRY TO 4 HILL DRY /01-02; REAPPRAISAL //05-06: ROLLOVER FROM FARM TO FOREST

Improvements - Residence / Manufactured Structures

Bldg: 1 Code Area: 92430 Stat Class: 152 Year Blt: 2024 Eff Year Blt: 2024 Sq.Ft: 5926 % Complete: 30
 Desc: Multi Story above grade Dimensions: RMV: 349430
 Func Obsc: 100 Econ %: 100 Other %: 100 Exception: 349430 Adjust: Adjust RMV: 0

Floors

Type	Class	Display Group	Floor Size	Beds	Baths	Yr Blt	Eff Yr Blt	Inventory	Exception
First Floor	5	Finished	4032	2	FB-2/ HB-1	2024	2024	BATH+, KIT+, FP - 3, BTH - 1, BATH - 2, ROOF, HVAC+	Exception: Y N
Second Floor	5	Finished	1894	4	FB-2	2024	2024	HVAC+, BATH - 2	Exception: Y N
Garage Attached	5	Finished	998	0	0	2024	2024	ROOF	Exception: Y N

Accessories

Description	Class	Size SqFt	Eff Yr Blt	RMV	Quantity	Exception
YARD IMPROVEMENTS AVERAGE	5	0	2024	13380	1	Exception: Y N

Improvements - Accessory Buildings

No improvement data available for all other stat class types.



SKETCH/AREA TABLE ADDENDUM

SUBJECT INFO

File No.: 532520 Parcel No.: 083W20D000300
 Property Address: 2352 JORY HILL RD S
 City: Salem County: Marion State: OR ZipCode: 97306
 Owner:
 Client: Client Address:
 Appraiser Name: Inspection Date:

SKETCH

532520
083W20D000300
SCALE = 1:30

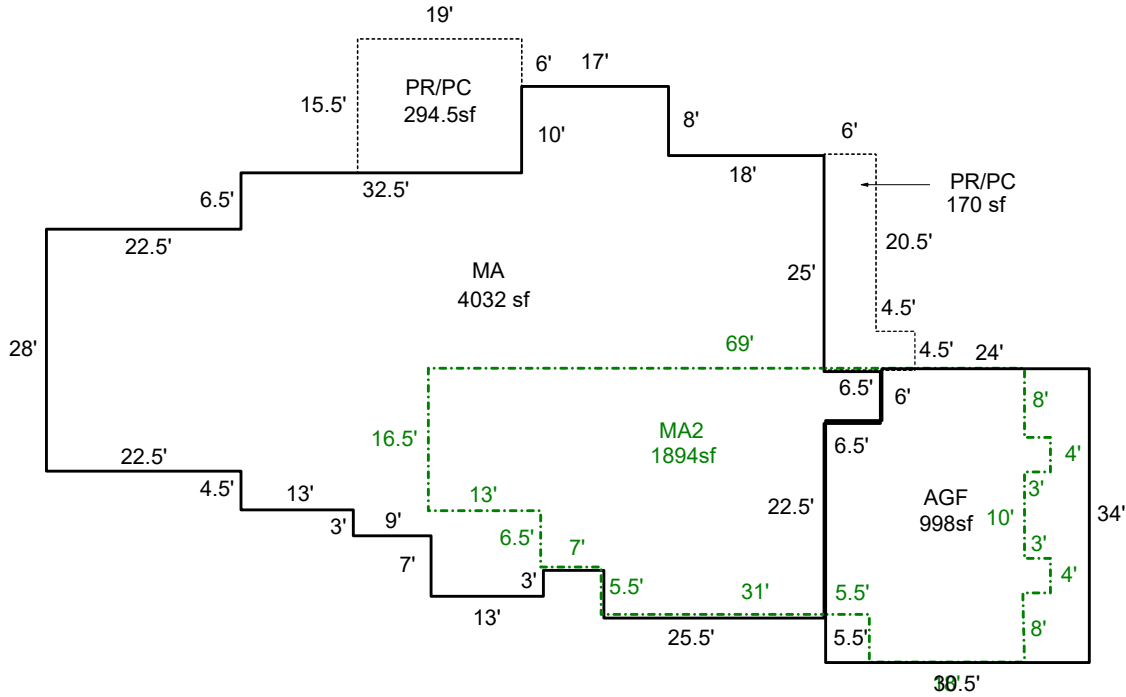

Sketch by ApexSketch

AREA CALCULATIONS SUMMARY

Code	Description	Factor	Net Size	Perimeter	Net Totals
GLA1	MA	1.0	4032.3	322.0	4032.3
GLA2	MA2	1.0	1894.0	218.2	1894.0
GAR	AGF	1.0	998.0	129.0	998.0
P/P	PR/PC	1.0	294.5	69.0	
	PR/PC	1.0	170.3	71.0	464.8

COMMENT TABLE 1

APEX BY CLOBERG 08/12/24 24-000890 MA
 UPDATED BY CLOBERG 10/14/24 2ND FLOOR MA
 UPDATED BY CLOBERG 02/05/25

COMMENT TABLE 2

GRH 12/03/24
GRH sks/25

COMMENT TABLE 3

TAGS L2
Forest L2

Net LIVABLE cnt 0 (rounded) 5,926