

Acct ID: 535034 MTL: 092W01B000100 Date: 6/16/25 Appr: MDL Prop Class: 559 RMV Prop Class: 459  
 Situs: 8983 WEST STAYTON RD SE AUMSVILLE OR 97325 MaSaNh: 07 06 000 Unit: 28156 Year: 2025

Last Date Appraised: 01/13/2025 Appraiser: MATT LORD Retag: Y (N) Tag info: 2026 - Tags/Permit (Demolished)

Owner: STORMS, KEITH Roll Type: R

Cycle Tag Sales Verification Other: FARM CHECK Inspection level: 1 2 (3) 4 LCB TTO INSP AV: 528282

RMV Land: 162460 RMV Imp: 505740 RMV Total: 668200 MAV: 21470 MSAV: 22542 SAV: 41398

Comment: 25-26: L3 MDL 1.13.25 TAG  
 24-25 L4 3.28.24 MDL  
 24-25 L4 2.7.24 MDL

✓ For mobile Removal / AS OF 4/24/25 still on property  
 ✓ HAYING / live stock / 2-3 cows

Notations 25-26: 2-3 cows 1/1/25 New House

RP/MS	Code	Description
MS	ZONED	FARM EFU ZONED
MS	ZONED	FARM EFU ZONED
MS	ZONED	FARM EFU ZONED

OSDs

Count	Code	Description	RMV	Code Area	Exception
1	SAF	SA OSD - FAIR ✓	40000	05555	0

Land

Site: 2	Code Area: 05555	Size: 1.00 Acres	Use Code: 005	Zone: REST	SAV Use: 011	Exception: 0
Class: 4BDS S	Value Source: Farm Homesite	Description: FOUR BENCH DRY SPECIAL SOUTH	RMV: 23550	Exception: Y N		
Adjustment(s): IRR	Comments: Liability year - 2009 24-25: Update land classes	Fire Patrol:	Description:			

Site: 3	Code Area: 05555	Size: 4.00 Acres	Use Code: 005	Zone: REST	SAV Use: 011	Exception: 0
Class: 4BISS	Value Source: Farm Use - EFU	Description: FOUR BENCH IRR SPECIAL SOUTH	RMV: 98910	Exception: Y N		
Adjustment(s): IRR	Comments: Liability year - 1982 25-26: Land classes ok	Fire Patrol:	Description:			

Improvements - Residence / Manufactured Structures

Bldg: 1	Code Area: 05555	Stat Class: 444	Year Blt: 1975	Eff Year Blt: 1975	Sq.Ft: 1164	% Complete: 100
Desc: MANUF STRUCT, CLASS 4, 14' WIDE SINGLE	Dimensions: 66x14	RMV: 0				
Func Obsc: 100	Econ %: 100	Other %: 100	Exception: 0	Adjust:	Adjust RMV: 0	

Floors

Type	Class	Display Group	Floor Size	Beds	Baths	Yr Blt	Eff Yr Blt	Inventory	Exception
First Floor	4	Finished	1164	3	FB-1/ HB-1	1975	1975	ROOF, HVAC, SKIRT, KIT-, BTH - 1, BATH - 1	Y N

Accessories

Description	Class	Size SqFt	Eff Yr Blt	RMV	Quantity
No accessory data available					

Bldg: 2	Code Area: 05555	Stat Class: 141	Year Blt: 2024	Eff Year Blt: 2024	Sq.Ft: 2658	% Complete: 100
Desc: One Story Only	Dimensions:	RMV: 495500				
Func Obsc: 100	Econ %: 100	Other %: 100	Exception: 495500	Adjust:	Adjust RMV: 0	

Floors

Type	Class	Display Group	Floor Size	Beds	Baths	Yr Blt	Eff Yr Blt	Inventory	Exception
First Floor	4	Finished	2658	3	FB-2/ HB-1	2024	2024	HVAC, KIT, ROOF, BATH - 2, BTH - 1, FP - 1	Y N
Garage Attached	4	Finished	816	0	0	2024	2024	ROOF	Y N

Accessories

Description	Class	Size SqFt	Eff Yr Blt	RMV	Quantity
YARD IMPROVEMENTS AVERAGE	4	0	2024	32100	1
Exception: Y N					

Improvements - Accessory Buildings

Bldg: 1	Code Area: 05555	Stat Class: 351	Year Blt: 1992	Eff Year Blt: 1992	Sq.Ft: 1920	% Complete: 100
Desc: General Purpose Building (GB)	Dimensions: 60x32	RMV: 10240				
Func Obsc: 100	Econ %: 100	Other %: 100	Exception: 0	Adjust:	Adjust RMV: 0	

Floors

Type	Class	Display Group	Floor Size	Beds	Baths	Yr Blt	Eff Yr Blt	Inventory	Exception: Y N
General Purpose Bldg	4	Finished	1920	0	0	1992	1992	FAIR ✓	

**Accessories**

Description	Class	Size SqFt	Eff Yr Blt	RMV	Quantity
No accessory data available					

# SKETCH/AREA TABLE ADDENDUM

## SUBJECT INFO

File No.: 535034 Parcel No.: 092W01B 00100  
 Property Address: 8983 West Stayton Rd SE  
 City: Aumsville County: Marion State: OR ZipCode: 97325  
 Owner:  
 Client: Client Address:  
 Appraiser Name: Inspection Date:

## SKETCH

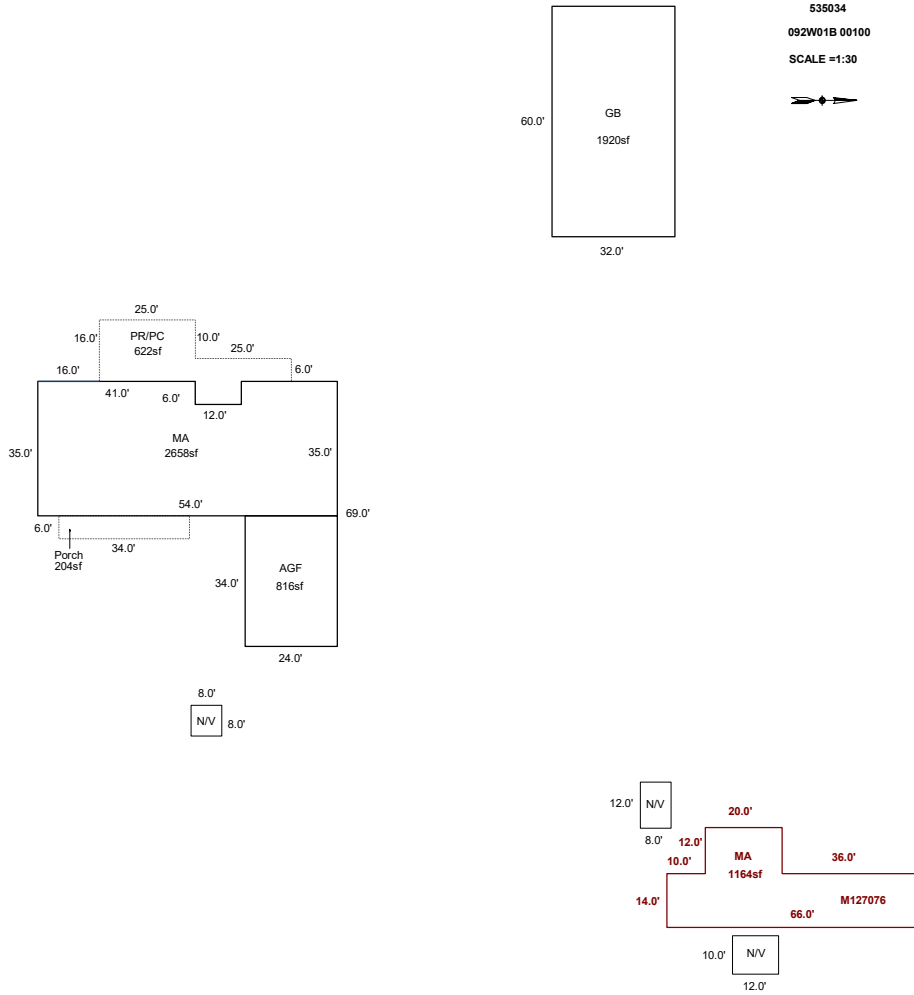

### AREA CALCULATIONS SUMMARY

Code	Description	Factor	Net Size	Perimeter	Net Totals
GBA1	GB	1.0	1920.0	184.0	1920.0
GLA1	MA	1.0	1164.0	184.0	
	MA	1.0	2658.0	238.0	3822.0
GAR	AGF	1.0	816.0	116.0	816.0
P/P	Porch	1.0	204.0	80.0	
	PR/PC	1.0	622.0	144.0	826.0

### COMMENT TABLE 1

Apex by RW 05/29/08  
 UPDATED BY JRONDEMA 11/2/16  
 UPDATED BY WWILLIAMS 4/11/24  
 UPDATED BY CLOBERG 07/08/2024 24-003422 MA  
 UPDATED BY CLOBERG 01/30/25

### COMMENT TABLE 2

#36 DB 10/14/16  
 JJS 2.7.24  
 MDL 01/13/25

### COMMENT TABLE 3

TAGS L4  
 TAGS L2

Net LIVABLE cnt 0 (rounded) 3,822  
 Net BUILDING cnt 1 (rounded) 1,920







Acct ID: 535034 MTL: 092W01B000100 Date: 1/13/25 Appr: MNL Prop Class: 559 RMV Prop Class: 459  
 Situs: 8983 WEST STAYTON RD SE AUMSVILLE OR 97325 MaSaNh: 07 06 000 Unit: 28156 Year: ~~2024~~ 2025  
 Last Date Appraised: 03/28/2024 Appraiser: MATT LORD Retag: Y (N) Tag info: 2025 - NEW RESIDENCE (Residence)  
 Owner: STORMS, KEITH Roll Type: R  
 Cycle (Tag) Sales Verification Other: \_\_\_\_\_ Inspection level: 1 (2) 3 4 LCB TTO INSP AV: 45430  
 RMV Land: 135510 RMV Imp: 40630 RMV Total: 176140 MAV: 23420 MSAV: 22010 SAV: 38746  
 Comment: 24-25 L4 3.28.24 MDL 24-003422  
 24-25 L4 2.7.24 MDL

Chris 2/20/25

25-26: New SFD/RePlace MFH 100% complete

RP/MS	Code	Description
MS	ZONED	FARM EFU ZONED
MS	ZONED	FARM EFU ZONED
MS	ZONED	FARM EFU ZONED

OSDs

Count	Code	Description	RMV	Code Area	Exception
1	SAF	SA OSD - FAIR	35000	05555	0

Land

Site: 2	Code Area: 05555	Size: 1.00 Acres	Use Code: 005	Zone: REST	SAV Use: 011	Exception: 0
Class: 4BDS S	Value Source: Farm Homesite	Description: FOUR BENCH DRY SPECIAL SOUTH	RMV: 20100	Exception: Y	N	
Adjustment(s):	Comments: Liability year - 2009 24-25: Update land classes	Fire Patrol:	Description:			
Site: 3	Code Area: 05555	Size: 4.00 Acres	Use Code: 005	Zone: REST	SAV Use: 011	Exception: 0
Class: 4BISS	Value Source: Farm Use - <u>EFU</u>	Description: FOUR BENCH IRR SPECIAL SOUTH	RMV: 80410	Exception: Y	N	
Adjustment(s):	Comments: Liability year - 1982 / 550050	Fire Patrol:	Description:			

Improvements - Residence / Manufactured Structures

Bldg: 1	Code Area: 05555	Stat Class: 444	Year Blt: 1975	Eff Year Blt: 1975	Sq.Ft: 1164	% Complete: 100
Desc: MANUF STRUCT, CLASS 4, 14' WIDE SINGLE	Func Obsc: 100	Econ %: 100	Other %: 100	Exception: 0	Adjust: Adjust RMV: 0	Dimensions: 66x14 RMV: 26590

Floors

Type	Class	Display Group	Floor Size	Beds	Baths	Yr Blt	Eff Yr Blt	Inventory	Exception
First Floor	4	Finished	1164	3	FB-1/ HB-1	1975	1975	BATH - 1, BTH - 1, KIT-, SKIRT, HVAC, ROOF	Y N

Accessories

In Process of Being Demord / Hope to be gone by MAY

Description	Class	Size SqFt	Eff Yr Blt	RMV	Quantity
No accessory data available					

Improvements - Accessory Buildings

Bldg: 1	Code Area: 05555	Stat Class: 351	Year Blt: 1992	Eff Year Blt: 1992	Sq.Ft: 1920	% Complete: 100
Desc: General Purpose Building (GB)	Func Obsc: 100	Econ %: 100	Other %: 100	Exception: 0	Adjust: Adjust RMV: 0	Dimensions: 60x32 RMV: 10810

Floors

Type	Class	Display Group	Floor Size	Beds	Baths	Yr Blt	Eff Yr Blt	Inventory	Exception
General Purpose Bldg	4	Finished	1920	0	0	1992	1992	FAIR ✓	Y N

Accessories

Description	Class	Size SqFt	Eff Yr Blt	RMV	Quantity
No accessory data available					

Bldg: 2	Code Area: 05555	Stat Class: 341	Year Blt: 1986	Eff Year Blt: 1986	Sq.Ft: 432	% Complete: 100
Desc: Multi Purpose Shed (MP)	Func Obsc: 100	Econ %: 100	Other %: 100	Exception: 0	Adjust: Adjust RMV: 0	Dimensions: 24x18 RMV: 2220

Floors

Type	Class	Display Group	Floor Size	Beds	Baths	Yr Blt	Eff Yr Blt	Inventory	Exception
Multi-Purpose Bldg	4	Finished	432	0	0	1986	1986	FAIR	Y N

Accessories

Description	Class	Size SqFt	Eff Yr Blt	RMV	Quantity
No accessory data available					

Bldg: 3    Code Area: 05555    Stat Class: 355    Year Blt: 1986    Eff Year Blt: 1986    Sq.Ft: 576    % Complete: 100  
 Desc: Lean-to Heavy (LTH)    Dimensions: 36x16    RMV: 1010  
 Func Obsc: 100    Econ %: 100    Other %: 100    Exception: 0    Adjust:    Adjust RMV: 0

**Floors**

Type	Class	Display Group	Floor Size	Beds	Baths	Yr Blt	Eff Yr Blt	Inventory
Lean-to Heavy Duty	4	Finished	576	0	0	1986	1986	Exception: Y N

**Accessories**

Description	Class	Size SqFt	Eff Yr Blt	RMV	Quantity
No accessory data available					

ACCOUNT # 535034 DATE: \_\_\_\_\_ RMV CLASS \_\_\_\_\_ PROP CLASS \_\_\_\_\_  
 MTL \_\_\_\_\_ APPR MISL TAG Y N \_\_\_\_\_  
 COMMENTS: \_\_\_\_\_

RESIDENCE / MANUFACTURED STRUCTURES

ACCESSORY IMPROVEMENTS / OUTBUILDINGS

STAT 141 QLTY + - FLOOR MA  
 AREA 2658 EFF AREA 2658 BED 3  
 ROOF + AVL HVAC +  
 2.5 BATH PKG: 2 BATH \_\_\_\_\_ BATH + 1 1/2 BTH  
 FIREPLACE: 1  
 KITCHEN - +  
 YR BLT 2024 EFF YR 2024 ECON \_\_\_\_\_  
 % COMP 100 % GOOD \_\_\_\_\_ FUNC \_\_\_\_\_  
 EXCEPT Y N LUMP SUM: \_\_\_\_\_  
 MISC: \_\_\_\_\_  
 YI CLASS \_\_\_\_\_ F G A E  
 SKIRT + LIN FT \_\_\_\_\_  
 COMMENT: \_\_\_\_\_

TYPE ABF  
 STAT / CLASS 141  
 SIZE 816  
 FAIR  
AVERAGE Roof  
 GOOD  
 EXCELLENT  
 BATH \_\_\_\_\_  
 YR BLT 2024  
 EFF YR 2024  
 % COMP 100  
 EXCEPT Y N  
 MISC: \_\_\_\_\_  
 COMMENT: \_\_\_\_\_

TYPE \_\_\_\_\_  
 STAT / CLASS \_\_\_\_\_  
 SIZE \_\_\_\_\_  
 FAIR  
 AVERAGE  
 GOOD  
 EXCELLENT  
 BATH \_\_\_\_\_  
 YR BLT \_\_\_\_\_  
 EFF YR \_\_\_\_\_  
 % COMP \_\_\_\_\_  
 EXCEPT Y N  
 MISC: \_\_\_\_\_  
 COMMENT: \_\_\_\_\_

STAT \_\_\_\_\_ QLTY + - FLOOR \_\_\_\_\_  
 AREA \_\_\_\_\_ EFF AREA \_\_\_\_\_ BED \_\_\_\_\_  
 ROOF + HVAC +  
 BATH PKG: \_\_\_\_\_ BATH \_\_\_\_\_ BATH + \_\_\_\_\_ 1/2 BTH  
 FIREPLACE: \_\_\_\_\_  
 KITCHEN - +  
 YR BLT \_\_\_\_\_ EFF YR \_\_\_\_\_ ECON \_\_\_\_\_  
 % COMP \_\_\_\_\_ % GOOD \_\_\_\_\_ FUNC \_\_\_\_\_  
 EXCEPT Y N LUMP SUM: \_\_\_\_\_  
 MISC: \_\_\_\_\_  
 YI CLASS \_\_\_\_\_ F G A E  
 SKIRT + LIN FT \_\_\_\_\_  
 COMMENT: \_\_\_\_\_

TYPE \_\_\_\_\_  
 STAT / CLASS \_\_\_\_\_  
 SIZE \_\_\_\_\_  
 FAIR  
 AVERAGE  
 GOOD  
 EXCELLENT  
 BATH \_\_\_\_\_  
 YR BLT \_\_\_\_\_  
 EFF YR \_\_\_\_\_  
 % COMP \_\_\_\_\_  
 EXCEPT Y N  
 MISC: \_\_\_\_\_  
 COMMENT: \_\_\_\_\_

TYPE \_\_\_\_\_  
 STAT / CLASS \_\_\_\_\_  
 SIZE \_\_\_\_\_  
 FAIR  
 AVERAGE  
 GOOD  
 EXCELLENT  
 BATH \_\_\_\_\_  
 YR BLT \_\_\_\_\_  
 EFF YR \_\_\_\_\_  
 % COMP \_\_\_\_\_  
 EXCEPT Y N  
 MISC: \_\_\_\_\_  
 COMMENT: \_\_\_\_\_

STAT \_\_\_\_\_ QLTY + - FLOOR \_\_\_\_\_  
 AREA \_\_\_\_\_ EFF AREA \_\_\_\_\_ BED \_\_\_\_\_  
 ROOF + HVAC +  
 BATH PKG: \_\_\_\_\_ BATH \_\_\_\_\_ BATH + \_\_\_\_\_ 1/2 BTH  
 FIREPLACE: \_\_\_\_\_  
 KITCHEN - +  
 YR BLT \_\_\_\_\_ EFF YR \_\_\_\_\_ ECON \_\_\_\_\_  
 % COMP \_\_\_\_\_ % GOOD \_\_\_\_\_ FUNC \_\_\_\_\_  
 EXCEPT Y N LUMP SUM: \_\_\_\_\_  
 MISC: \_\_\_\_\_  
 YI CLASS \_\_\_\_\_ F G A E  
 SKIRT + LIN FT \_\_\_\_\_  
 COMMENT: \_\_\_\_\_

TYPE \_\_\_\_\_  
 STAT / CLASS \_\_\_\_\_  
 SIZE \_\_\_\_\_  
 FAIR  
 AVERAGE  
 GOOD  
 EXCELLENT  
 BATH \_\_\_\_\_  
 YR BLT \_\_\_\_\_  
 EFF YR \_\_\_\_\_  
 % COMP \_\_\_\_\_  
 EXCEPT Y N  
 MISC: \_\_\_\_\_  
 COMMENT: \_\_\_\_\_

TYPE \_\_\_\_\_  
 STAT / CLASS \_\_\_\_\_  
 SIZE \_\_\_\_\_  
 FAIR  
 AVERAGE  
 GOOD  
 EXCELLENT  
 BATH \_\_\_\_\_  
 YR BLT \_\_\_\_\_  
 EFF YR \_\_\_\_\_  
 % COMP \_\_\_\_\_  
 EXCEPT Y N  
 MISC: \_\_\_\_\_  
 COMMENT: \_\_\_\_\_



1/13/25